

BAVARIA CRUISER 46

Santiago (2020)

Sailing yacht **Bavaria Cruiser 46 Santiago**, built in **2020** is anchored in the **Fethiye, Yacht Classic Hotel Marina, Aegean, Turkey**. It has **4 cabins**, can accommodate **8 people** and has **3 toilets**. Bed linen and kitchen equipment are included in the price.

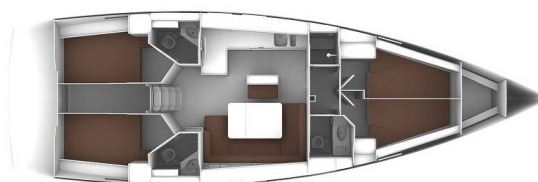

YACHT SPECIFICATIONS

Yacht Base

**Fethiye, Yacht Classic Hotel Marina,
Turkey**

Yacht ID

2794

Brands

Bavaria

Yacht name

Santiago

Production year

2020

Length

47 ft

Cabins

4

Berths

8

Max Persons

8

WC

3

Engine

1 x 51 HP

Fuel tank

210 l



WEBSITE

www.plujeme.cz



PHONE

+420 720 755 085



MOBILE

+420 777 170 276



E-MAIL

info@plujeme.cz



PLUJEME RÁDI S.R.O.

Dlouhá 730/35, 11000 Praha 1 – Staré Město, Czech Republic

STANDARD YACHT EQUIPMENT

Comfort	Cockpit cushions
Deck	Anchor, Anchor with chain, Bathing platform, Bimini top, Dinghy, Electric anchor windlass, Gangway, Outboard engine, Sprayhood, Swimming ladder, Teak cockpit
Entertainment	Bluetooth player
Galley	Hot water, Refrigerator
Interior	Barometer, Thermometer
Navigation	Autopilot, Bow thruster, GPS chart plotter - cockpit, Nautical charts, Navigation (Nautical) charts and nautical guide, Pilot book, Wind/speed/depth instruments
Safety	Automatic Inflatable Life Jacket, Life jacket (children), Liferaft, VHF radio
Yacht electrics	Heating, Inverter, Shore connection 220 V, Solar panels



WEBSITE

www.plujeme.cz



E-MAIL

info@plujeme.cz



PHONE

+420 720 755 085



MOBILE

+420 777 170 276



PLUJEME RÁDI S.R.O.

Dlouhá 730/35, 11000 Praha 1 – Staré Město, Czech Republic

SERVICES

SELECTED SERVICES	OBLIGATORY	PAYMENT TYPE	PRICE
Charter package (Payable at the base) Season: 2026. Includes: Transit log, Cleaning, LPG Gas Bottle, Inverter, Bed linen, Blanket, Towels, Salt, Black Paper, Thyme, Chili Paper, Liquid Hand Soap, Dish soap, WC Paper;	Yes	per booking	400,00 €
Early Check in (Payable at the base) Season: 2026.	No	per booking	150,00 €
Extra cleaning (Payable at the base) Season: 2026.	No	per booking	70,00 €
Hostess/Cook (Payable at the base) Season: 2026. + cabin	No	per day + food	150,00 €
Provisioning (Payable at the base) Season: 2026. On Request	No	per booking	0,00 €
Refuel service (Payable at the base) Season: 2026. + cost of diesel	No	per service	50,00 €
Skipper (Payable at the base) Season: 2026. + cabin	No	per day + food	185,00 €
Smaller safety deposit (Payable at the base) Season: 2026. Security deposit can be reduced to 20% (of it's original value) with a non-refundable payment of 10% of deposit. Does not cover: dinghy, outboard, anchor, chain and sails.	No	per booking	0,00 €
Transfer (Payable at the base) Season: 2026. DALAMAN-GÖÇEK (1-6 pax)	No	one-way	70,00 €
Transfer (Payable at the base) Season: 2026. DALAMAN-FETHİYE (1-6 pax)	No	one-way	75,00 €
Transfer (Payable at the base) Season: 2026. DALAMAN-ÖLÜDENİZ (1-6 pax)	No	one-way	85,00 €
Transfer (Payable at the base) Season: 2026. DALAMAN-MARMARİS (1-6 pax)	No	one-way	95,00 €

Transfer (Payable at the base) Season: 2026. DALAMAN-GÖÇEK (7-13 pax)	No	one-way	100,00 €
Transfer (Payable at the base) Season: 2026. DALAMAN-FETHİYE (7-13 pax)	No	one-way	120,00 €
Transfer (Payable at the base) Season: 2026. DALAMAN-ÖLÜDENİZ (7-13 pax)	No	one-way	120,00 €
Transfer (Payable at the base) Season: 2026. DALAMAN-MARMARİS (7-13 pax)	No	one-way	150,00 €
Transfer (Payable at the base) Season: 2026. FETHİYE - MARMARİS (1-6 pax)	No	one-way	180,00 €
Transfer (Payable at the base) Season: 2026. DALAMAN - KAŞ (1-6 pax)	No	one-way	180,00 €
Transfer (Payable at the base) Season: 2026. DALAMAN - D MARİS (1-6 pax)	No	one-way	200,00 €
Transfer (Payable at the base) Season: 2026. ANTALYA-FETHİYE (1-6 pax)	No	one-way	230,00 €
Transfer (Payable at the base) Season: 2026. DALAMAN - KEKOVA (1-6 pax)	No	one-way	230,00 €
Transfer (Payable at the base) Season: 2026. FETHİYE - MARMARİS (7-13 pax)	No	one-way	230,00 €
Transfer (Payable at the base) Season: 2026. DALAMAN - BOZBURUN (1-6 pax)	No	one-way	240,00 €
Transfer (Payable at the base) Season: 2026. BODRUM Airport - FETHİYE (1-6 pax)	No	one-way	240,00 €
Transfer (Payable at the base) Season: 2026. DALAMAN - KAŞ (7-13 pax)	No	one-way	270,00 €
Transfer (Payable at the base) Season: 2026. DALAMAN - D MARİS (7-13 pax)	No	one-way	280,00 €
Transfer (Payable at the base) Season: 2026. BODRUM Center - FETHİYE (1-6 pax)	No	one-way	290,00 €

Transfer (Payable at the base) Season: 2026. DALAMAN - KEKOVA (7-13 pax)	No	one-way	300,00 €
Transfer (Payable at the base) Season: 2026. FETHİYE - SİDE/KEMER (1-6 pax)	No	one-way	300,00 €
Transfer (Payable at the base) Season: 2026. FETHİYE - PAMUKKALE (1-6 pax)	No	one-way	300,00 €
Transfer (Payable at the base) Season: 2026. DALAMAN - BOZBURUN (7-13 pax)	No	one-way	300,00 €
Transfer (Payable at the base) Season: 2026. İZMİR Airport - FETHİYE (1-6 pax)	No	one-way	350,00 €
Transfer (Payable at the base) Season: 2026. ANTALYA-FETHİYE (7-13 pax)	No	one-way	350,00 €
Transfer (Payable at the base) Season: 2026. BODRUM Airport - FETHİYE (7-13 pax)	No	one-way	350,00 €
Transfer (Payable at the base) Season: 2026. FETHİYE - PAMUKKALE (7-13 pax)	No	one-way	390,00 €
Transfer (Payable at the base) Season: 2026. İZMİR Airport - FETHİYE (7-13 pax)	No	one-way	400,00 €
Transfer (Payable at the base) Season: 2026. FETHİYE - SİDE/KEMER (7-13 pax)	No	one-way	400,00 €
Transfer (Payable at the base) Season: 2026. BODRUM Center - FETHİYE (7-13 pax)	No	one-way	400,00 €
Transitlog to Greece (Payable at the base) Season: 2026.	No	per booking	300,00 €
WI-FI Internet connection on boat (Payable at the base) Season: 2026. 50Gb	No	per service	50,00 €
WI-FI Internet connection on boat (Payable at the base) Season: 2026. unlimited	No	per week	100,00 €



WEBSITE
www.plujeme.cz



PHONE
+420 720 755 085



MOBILE
+420 777 170 276



E-MAIL
info@plujeme.cz



PLUJEME RÁDI S.R.O.
Dlouhá 730/35, 11000 Praha 1 - Staré Město, Czech Republic

ADDITIONAL EXTRAS

EXTRA	OBLIGATORY	PAYMENT TYPE	PRICE
Additional gas bottle (Payable at the base) Season: 2026. Payable at the base	No	per bottle	10,00 €
Coffee capsules (Payable at the base) Season: 2026. Ask for yacht compatibility. - Payable at the base	No	per booking	60,00 €
Electrical filter coffee maker (Payable at the base) Season: 2026. Ask for yacht compatibility. - Payable at the base	No	per booking	30,00 €
Extra bedlinen (Payable at the base) Season: 2026. Payable at the base	No	per set	10,00 €
Extra towels (Payable at the base) Season: 2026. Payable at the base	No	per set	5,00 €
Railing net (Safety net) (Payable at the base) Season: 2026. Payable at the base	No	per booking	100,00 €
Sea Scooter (Payable at the base) Season: 2026. Payable at the base	No	per week	150,00 €
Stand up paddle (SUP) (Payable at the base) Season: 2026. Payable at the base	No	per week	100,00 €



WEBSITE

www.plujeme.cz



E-MAIL

info@plujeme.cz



PHONE

+420 720 755 085



MOBILE

+420 777 170 276



PLUJEME RÁDI S.R.O.

Dlouhá 730/35, 11000 Praha 1 – Staré Město, Czech Republic

PRICE AND AVAILABILITY

25.04. - 02.05.2026 NOT AVAILABLE	02.05. - 09.05.2026 NOT AVAILABLE	09.05. - 16.05.2026 3.592 € 4.490 €	16.05. - 23.05.2026 NOT AVAILABLE
23.05. - 30.05.2026 NOT AVAILABLE	30.05. - 06.06.2026 4.490 €	06.06. - 13.06.2026 NOT AVAILABLE	13.06. - 20.06.2026 4.790 €
20.06. - 27.06.2026 3.114 € 4.790 €	27.06. - 04.07.2026 3.114 € 4.790 €	04.07. - 11.07.2026 3.114 € 4.790 €	11.07. - 18.07.2026 3.114 € 4.790 €
18.07. - 25.07.2026 3.114 € 4.790 €	25.07. - 01.08.2026 3.114 € 4.790 €	01.08. - 08.08.2026 3.114 € 4.790 €	08.08. - 15.08.2026 3.114 € 4.790 €
15.08. - 22.08.2026 3.244 € 4.990 €	22.08. - 29.08.2026 3.244 € 4.990 €	29.08. - 05.09.2026 3.244 € 4.990 €	05.09. - 12.09.2026 NOT AVAILABLE
12.09. - 19.09.2026 NOT AVAILABLE	19.09. - 26.09.2026 NOT AVAILABLE	26.09. - 03.10.2026 NOT AVAILABLE	03.10. - 10.10.2026 NOT AVAILABLE
10.10. - 17.10.2026 NOT AVAILABLE	17.10. - 24.10.2026 NOT AVAILABLE	24.10. - 31.10.2026 4.990 €	31.10. - 07.11.2026 3.090 €
07.11. - 14.11.2026 3.090 €	14.11. - 21.11.2026 3.090 €	21.11. - 28.11.2026 3.090 €	28.11. - 05.12.2026 3.090 €



WEBSITE

www.plujeme.cz



E-MAIL

info@plujeme.cz



PHONE

+420 720 755 085



MOBILE

+420 777 170 276



PLUJEME RÁDI S.R.O.

Dlouhá 730/35, 11000 Praha 1 – Staré Město, Czech Republic

PRICE AND AVAILABILITY

05.12. - 12.12.2026

3.090 €

12.12. - 19.12.2026

3.090 €

19.12. - 26.12.2026

3.090 €



WEBSITE

www.plujeme.cz



E-MAIL

info@plujeme.cz



PHONE

+420 720 755 085



MOBILE

+420 777 170 276



PLUJEME RÁDI S.R.O.

Dlouhá 730/35, 11000 Praha 1 – Staré Město, Czech Republic