

# OCEANIS 51.1

Babakita (2020)

Sailing yacht Oceanis 51.1 Babakita, built in 2020 is anchored in the **Corfu, Gouvia Marina, Ionian Islands, Greece**. It has **5 + 1 cabins**, can accommodate **10 + 1 people** and has **3 + 1 toilets**. Bed linen and kitchen equipment are included in the price.

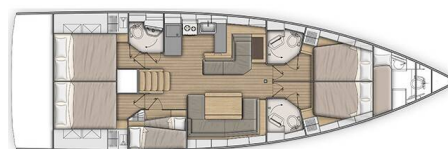

## YACHT SPECIFICATIONS

Yacht Base

**Corfu, Gouvia Marina, Greece**

Yacht ID

**2777**

Brands

**Beneteau**

Yacht name

**Babakita**

Production year

**2020**

Length

**52 ft**

Cabins

**5 + 1**

Berths

**10 + 1**

WC

**3 + 1**

Engine

**1 x 0 HP**

Fuel tank

**0 l**



**WEBSITE**

[www.plujeme.cz](http://www.plujeme.cz)



**PHONE**

+420 720 755 085



**MOBILE**

+420 777 170 276



**E-MAIL**

[info@plujeme.cz](mailto:info@plujeme.cz)



**PLUJEME RÁDI S.R.O.**

Dlouhá 730/35, 11000 Praha 1 – Staré Město, Czech Republic

## STANDARD YACHT EQUIPMENT

Comfort	<b>Cockpit cushions</b>
Deck	<b>Anchor, Anchor with chain, Bathing platform, Bimini top, Dinghy, Dinghy with outboard engine, Fenders, Gangway, Main anchor, Mooring ropes, Outboard engine, Spare anchor (Reserve, Auxiliary anchor), Sprayhood</b>
Entertainment	<b>CD/MP3, USB, AUX input, Indoor speakers, Outdoor speakers, Radio</b>
Galley	<b>Freezer</b>
Interior	<b>Convertible table in salon, Electric fans, Electric fans in cabins, Electric toilet</b>
Navigation	<b>Autopilot, Binoculars, Bow thruster, GPS chart plotter, GPS chart plotter - cockpit</b>
Safety	<b>EPIRB-Distress radio beacons, First aid kit, Liferaft</b>
Sails	<b>Electric winch</b>
Yacht electrics	<b>220V socket, Air Conditioning, Batteries, Battery charger, Generator, Heating, Inverter, Service batteries, Solar panels, USB sockets</b>



**WEBSITE**

[www.plujeme.cz](http://www.plujeme.cz)



**PHONE**

+420 720 755 085



**MOBILE**

+420 777 170 276



**E-MAIL**

[info@plujeme.cz](mailto:info@plujeme.cz)



**PLUJEME RÁDI S.R.O.**

Dlouhá 730/35, 11000 Praha 1 – Staré Město, Czech Republic

## SERVICES

SELECTED SERVICES	OBLIGATORY	PAYMENT TYPE	PRICE
<b>Security Deposit Waiver</b> (Payable at the base) <b>Season: 2026.</b> 200 EUR credit voucher for the next charter in case of no damage/loss upon redelivery. No cash refund.	Yes	per booking	<b>450,00 €</b>
<b>Standard Charter Pack</b> (Payable at the base) <b>Season: 2026.</b> Welcome kit	Yes	per booking	<b>280,00 €</b>
<b>Beach towel</b> (Payable at the base) <b>Season: 2026.</b>	No	per booking	<b>10,00 €</b>
<b>Berth cost</b> (Payable at the base) <b>Season: 2026.</b> Berthing fees for first & last night at the marina/port	No	per booking	<b>0,00 €</b>
<b>Cabin conversion</b> (Payable at the base) <b>Season: 2026.</b> If possible on yacht. Contact fleet operator for more information.	No	per booking	<b>150,00 €</b>
<b>Cook</b> (Payable at the base) <b>Season: 2026.</b> Crew provisioning to be provided by Charterer in arrangement with crew. If monetary compensation shall be agreed, then it shall be of no less than €30 per crew member per day. Charterer shall provide crew with sleeping cabin/berth and shower/toilet use to be designated to them onboard.	No	per day + food	<b>215,00 €</b>
<b>Family pack</b> (Payable at the base) <b>Season: 2026.</b> Safety net, SUP, junior life jackets, normal foam type	No	per booking	<b>350,00 €</b>
<b>Fast Track pack</b> (Payable at the base) <b>Season: 2026.</b> Access to the yacht by 14:00h on embarkation day, only IF feasible	No	per booking	<b>200,00 €</b>
<b>Hostess</b> (Payable at the base) <b>Season: 2026.</b> Crew provisioning to be provided by Charterer in arrangement with crew. If monetary compensation shall be agreed, then it shall be of no less than €30 per crew member per day. Charterer shall provide crew with sleeping cabin/berth and shower/toilet use to be designated to them onboard.	No	per day + food	<b>180,00 €</b>

<b>Internet pack</b> (Payable at the base) <b>Season: 2026.</b> Wi-Fi router for Internet aboard (subject to GSM coverage up to 10GB/week)	No	per week	<b>50,00 €</b>
<b>One way fee</b> (Payable at the base) <b>Season: 2026.</b> Volos-Skiathos	No	per booking	<b>300,00 €</b>
<b>One way fee</b> (Payable at the base) <b>Season: 2026.</b> Preveza-Lefkas	No	per booking	<b>300,00 €</b>
<b>One way fee</b> (Payable at the base) <b>Season: 2026.</b> Athens-Lavrion	No	per booking	<b>500,00 €</b>
<b>One way fee</b> (Payable at the base) <b>Season: 2026.</b> Athens-Cyclades/Sporades	No	per booking	<b>1.000,00 €</b>
<b>One way fee</b> (Payable at the base) <b>Season: 2026.</b> Athens-Dodecanese	No	per booking	<b>1.200,00 €</b>
<b>One way fee</b> (Payable at the base) <b>Season: 2026.</b> Kos-Rhodos	No	per booking	<b>600,00 €</b>
<b>One way fee</b> (Payable at the base) <b>Season: 2026.</b> Lefkas/Preveza-Corfu	No	per booking	<b>600,00 €</b>
<b>One way fee</b> (Payable at the base) <b>Season: 2026.</b> Athens-Lefkas-Preveza	No	per booking	<b>1.200,00 €</b>
<b>One way fee</b> (Payable at the base) <b>Season: 2026.</b> Athens-Corfu	No	per booking	<b>1.400,00 €</b>
<b>Overnight on board</b> (Payable at the base) <b>Season: 2026.</b> Embarkation on yacht & overnight stay the day before charter starts, check-in by 13:00h on charter start day. Subject to last minute availability of yacht on previous day.	No	per booking	<b>180,00 €</b>
<b>Pet on board</b> (Payable at the base) <b>Season: 2026.</b> up to 7 kg	No	per booking	<b>200,00 €</b>
<b>Skipper</b> (Payable at the base) <b>Season: 2026.</b> Crew provisioning to be provided by Charterer in arrangement with crew. If monetary compensation shall be agreed, then it shall be of no less than €30 per crew member per day. Charterer shall provide crew with sleeping cabin/berth and shower/toilet use to be designated to them onboard. Skippered charters come obligatorily with: Security deposit waiver, non refundable, EUR 400	No	per day + food	<b>215,00 €</b>

**Stand up paddle (SUP)** (Payable at the base)

No

per week

**100,00 €**

**Season: 2026.**

---

**VIP Pack** (Payable at the base)

No

per booking

**300,00 €**

**Season: 2026.** Airport/Local Base welcome & pickup, transfer to the yacht, welcome pack with sparkling wine & fruits, departure transfer to the local airport



**WEBSITE**

[www.plujeme.cz](http://www.plujeme.cz)



**E-MAIL**

[info@plujeme.cz](mailto:info@plujeme.cz)



**PHONE**

+420 720 755 085



**MOBILE**

+420 777 170 276



**PLUJEME RÁDI S.R.O.**

Dlouhá 730/35, 11000 Praha 1 – Staré Město, Czech Republic

## ADDITIONAL EXTRAS

EXTRA	OBLIGATORY	PAYMENT TYPE	PRICE
<b>Automatic Inflatable Life Jacket</b> (Payable at the base) <i>Season: 2026. Payable at the base</i>	No	per week/ person	<b>20,00 €</b>
<b>Beach towel</b> (Payable at the base) <i>Season: 2026. Payable at the base</i>	No	per piece	<b>10,00 €</b>
<b>Blister</b> (Payable at the base) <i>Season: 2026. + extra security deposit 500 EUR (refundable) - Payable at the base</i>	No	per week	<b>250,00 €</b>
<b>Extra bedlinen</b> (Payable at the base) <i>Season: 2026. Payable at the base</i>	No	per set	<b>10,00 €</b>
<b>Fishing equipment</b> (Payable at the base) <i>Season: 2026. fishing rod &amp; reel - Payable at the base</i>	No	per week	<b>30,00 €</b>
<b>Gennaker</b> (Payable at the base) <i>Season: 2026. + extra security deposit 500 EUR (refundable) - Payable at the base</i>	No	per week	<b>200,00 €</b>
<b>Grill/Barbecue/Plancha</b> (Payable at the base) <i>Season: 2026. portable, 1x gas bottle included - Payable at the base</i>	No	per week	<b>80,00 €</b>
<b>Kayak</b> (Payable at the base) <i>Season: 2026. Payable at the base</i>	No	per week	<b>100,00 €</b>
<b>Railing net (Safety net)</b> (Payable at the base) <i>Season: 2026. installed - Payable at the base</i>	No	per booking	<b>200,00 €</b>
<b>Stand up paddle (SUP)</b> (Payable at the base) <i>Season: 2026. Payable at the base</i>	No	per week	<b>100,00 €</b>



**WEBSITE**  
www.plujeme.cz



**PHONE**  
+420 720 755 085



**MOBILE**  
+420 777 170 276



**E-MAIL**  
info@plujeme.cz



**PLUJEME RÁDI S.R.O.**  
Dlouhá 730/35, 11000 Praha 1 – Staré Město, Czech Republic

## PRICE AND AVAILABILITY

13.06. - 20.06.2026 NOT AVAILABLE	20.06. - 27.06.2026 <b>5.040 €</b> 7.200 €	27.06. - 11.07.2026 NOT AVAILABLE	11.07. - 25.07.2026 NOT AVAILABLE
25.07. - 01.08.2026 NOT AVAILABLE	01.08. - 08.08.2026 NOT AVAILABLE	08.08. - 15.08.2026 NOT AVAILABLE	15.08. - 22.08.2026 NOT AVAILABLE
22.08. - 29.08.2026 <b>6.375 €</b> 7.500 €	29.08. - 12.09.2026 NOT AVAILABLE	12.09. - 26.09.2026 NOT AVAILABLE	26.09. - 03.10.2026 <b>5.310 €</b> 5.900 €
03.10. - 10.10.2026 <b>4.770 €</b> 5.300 €	10.10. - 17.10.2026 <b>4.770 €</b> 5.300 €	17.10. - 24.10.2026 NOT AVAILABLE	24.10. - 31.10.2026 <b>3.600 €</b> 4.000 €
31.10. - 07.11.2026 <b>3.600 €</b> 4.000 €	07.11. - 14.11.2026 <b>3.600 €</b> 4.000 €	14.11. - 21.11.2026 <b>3.600 €</b> 4.000 €	21.11. - 31.12.2026 NOT AVAILABLE
02.01. - 09.01.2027 <b>2.250 €</b> 2.500 €	09.01. - 16.01.2027 <b>2.250 €</b> 2.500 €	16.01. - 23.01.2027 <b>2.250 €</b> 2.500 €	23.01. - 30.01.2027 <b>2.250 €</b> 2.500 €
30.01. - 06.02.2027 <b>2.250 €</b> 2.500 €			



WEBSITE

[www.plujeme.cz](http://www.plujeme.cz)



E-MAIL

[info@plujeme.cz](mailto:info@plujeme.cz)



PHONE

+420 720 755 085



MOBILE

+420 777 170 276



PLUJEME RÁDI S.R.O.

Dlouhá 730/35, 11000 Praha 1 – Staré Město, Czech Republic

## PRICE AND AVAILABILITY

06.02. - 13.02.2027 <b>2.250 €</b> 2.500 €	13.02. - 20.02.2027 <b>2.250 €</b> 2.500 €	20.02. - 27.02.2027 <b>2.250 €</b> 2.500 €	27.02. - 06.03.2027 <b>2.250 €</b> 2.500 €
06.03. - 13.03.2027 <b>2.250 €</b> 2.500 €	13.03. - 20.03.2027 <b>2.250 €</b> 2.500 €	20.03. - 27.03.2027 <b>2.250 €</b> 2.500 €	27.03. - 03.04.2027 <b>2.250 €</b> 2.500 €
03.04. - 10.04.2027 <b>2.250 €</b> 2.500 €	10.04. - 17.04.2027 <b>2.250 €</b> 2.500 €	17.04. - 24.04.2027 <b>2.250 €</b> 2.500 €	24.04. - 01.05.2027 <b>3.330 €</b> 3.700 €
01.05. - 08.05.2027 <b>3.330 €</b> 3.700 €	08.05. - 15.05.2027 <b>3.870 €</b> 4.300 €	15.05. - 22.05.2027 <b>3.870 €</b> 4.300 €	22.05. - 29.05.2027 <b>5.490 €</b> 6.100 €
29.05. - 12.06.2027 NOT AVAILABLE	12.06. - 19.06.2027 <b>6.030 €</b> 6.700 €	19.06. - 26.06.2027 <b>6.480 €</b> 7.200 €	26.06. - 03.07.2027 <b>6.480 €</b> 7.200 €
03.07. - 10.07.2027 <b>6.480 €</b> 7.200 €	10.07. - 17.07.2027 <b>6.480 €</b> 7.200 €	17.07. - 24.07.2027 <b>6.480 €</b> 7.200 €	24.07. - 31.07.2027 <b>6.480 €</b> 7.200 €
31.07. - 07.08.2027 <b>7.380 €</b> 8.200 €	07.08. - 14.08.2027 <b>7.380 €</b> 8.200 €	14.08. - 21.08.2027 <b>7.380 €</b> 8.200 €	21.08. - 28.08.2027 <b>6.750 €</b> 7.500 €
28.08. - 04.09.2027 <b>6.750 €</b> 7.500 €	04.09. - 11.09.2027 <b>6.750 €</b> 7.500 €	11.09. - 18.09.2027 <b>6.750 €</b> 7.500 €	18.09. - 25.09.2027 <b>6.750 €</b> 7.500 €
25.09. - 02.10.2027 <b>5.310 €</b> 5.900 €			



WEBSITE

[www.plujeme.cz](http://www.plujeme.cz)



E-MAIL

[info@plujeme.cz](mailto:info@plujeme.cz)



PHONE

+420 720 755 085



MOBILE

+420 777 170 276



PLUJEME RÁDI S.R.O.

Dlouhá 730/35, 11000 Praha 1 – Staré Město, Czech Republic

## PRICE AND AVAILABILITY

02.10. - 09.10.2027 <b>4.770 €</b> 5.300 €	09.10. - 16.10.2027 <b>4.770 €</b> 5.300 €	16.10. - 23.10.2027 <b>3.600 €</b> 4.000 €	23.10. - 30.10.2027 <b>3.600 €</b> 4.000 €
30.10. - 06.11.2027 <b>3.600 €</b> 4.000 €	06.11. - 13.11.2027 <b>3.600 €</b> 4.000 €	13.11. - 20.11.2027 <b>3.600 €</b> 4.000 €	20.11. - 27.11.2027 <b>3.600 €</b> 4.000 €
27.11. - 04.12.2027 <b>3.600 €</b> 4.000 €	04.12. - 11.12.2027 <b>3.600 €</b> 4.000 €	11.12. - 18.12.2027 <b>3.600 €</b> 4.000 €	18.12. - 25.12.2027 <b>3.600 €</b> 4.000 €



### WEBSITE

[www.plujeme.cz](http://www.plujeme.cz)



### E-MAIL

[info@plujeme.cz](mailto:info@plujeme.cz)



### PHONE

+420 720 755 085



### MOBILE

+420 777 170 276



### PLUJEME RÁDI S.R.O.

Dlouhá 730/35, 11000 Praha 1 – Staré Město, Czech Republic