

BAVARIA CRUISER 51

Ivolga (2020)

Sailing yacht **Bavaria Cruiser 51 Ivolga**, built in **2020** is anchored in the **ACI Marina Trogir, Split region, Croatia**. It has **5 cabins**, can accommodate **10 + 2 people** and has **3 toilets**. Bed linen and kitchen equipment are included in the price.

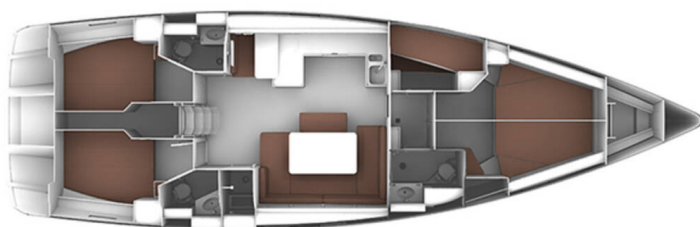

YACHT SPECIFICATIONS

Yacht Base

ACI Marina Trogir, Croatia

Yacht ID

2761

Brands

Bavaria

Yacht name

Ivolga

Production year

2020

Length

51 ft

Cabins

5

Berths

10 + 2

WC

3

Engine

1 x 75 HP

Fuel tank

430 l



WEBSITE

www.plujeme.cz



PHONE

+420 720 755 085



MOBILE

+420 777 170 276



E-MAIL

info@plujeme.cz



PLUJEME RÁDI S.R.O.

Dlouhá 730/35, 11000 Praha 1 – Staré Město, Czech Republic

STANDARD YACHT EQUIPMENT

Deck	Bathing platform, Bimini top, Dinghy, Electric anchor windlass, Gangway, Sprayhood
Entertainment	Radio CD mp3 player
Galley	Refrigerator
Interior	Convertible from 5 into 4 cabins
Navigation	Autopilot, Binoculars, Bow thruster, Echosounder/Depthsounder, GPS chart plotter - cockpit, Harbour guides, Log/speed instrument, Nautical charts, Navigation set, Radar reflector, Wind instrument/Anemometer
Safety	Distress flare box, Fire extinguisher, First aid kit, Fog horn, Horseshoe lifebuoy, Life belts (Safety harness), Life buoy + Flashing light, Life jackets, Liferaft, VHF radio
Yacht electrics	Batteries, Battery charger, Heating, Shore connection 220 V, Solar panels



WEBSITE

www.plujeme.cz



E-MAIL

info@plujeme.cz



PHONE

+420 720 755 085



MOBILE

+420 777 170 276



PLUJEME RÁDI S.R.O.

Dlouhá 730/35, 11000 Praha 1 – Staré Město, Czech Republic

SERVICES

SELECTED SERVICES	OBLIGATORY	PAYMENT TYPE	PRICE
Basic package for accommodation (Payable at the base) Season: 2026. BASIC PACKAGE FOR ACCOMMODATION V End cleaning, 2x cooking gas bottle at the departure, linen equipment for each crew member, 1x towel (100cm*50cm) deposit insurance, outboard engine+outboard fuel 5l, Unlimited Wi-Fi Reduces security deposit to 0€ Additional surcharge fort two weeks 100 Eur, in two weeks charter big towels included Obligatory to be paid with second advance payment	Yes	per booking	600,00 €
Non refundable deposit/ insurance (Payable at the base) Season: 2026. Reduces deposit to 0€ (already included in basic package)	Yes	per booking	0,00 €
TIP for employees (Payable at the base) Season: 2026. payable in base	Yes	per booking	35,00 €
Cabin conversion (Payable at the base) Season: 2026.	No	per booking	200,00 €
Early boarding/check-in (Payable at the base) Season: 2026. at 13:00 h, not guaranteed, payable on the check-in	No	per booking	150,00 €
Skipper (Payable at the base) Season: 2026.	No	per day + food	200,00 €



WEBSITE

www.plujeme.cz



PHONE

+420 720 755 085



MOBILE

+420 777 170 276



E-MAIL

info@plujeme.cz



PLUJEME RÁDI S.R.O.

Dlouhá 730/35, 11000 Praha 1 – Staré Město, Czech Republic

ADDITIONAL EXTRAS

EXTRA	OBLIGATORY	PAYMENT TYPE	PRICE
Automatic Inflatable Life Jacket (Payable at the base) <i>Season: 2026. Payable at the base</i>	No	per piece	15,00 €
Extra bedlinen (Payable at the base) <i>Season: 2026. Payable at the base</i>	No	per person	12,00 €
Gennaker (Payable at the base) <i>Season: 2026. Roll; + 1.000€ deposit - Payable at the base</i>	No	per week	200,00 €
Kayak (Payable at the base) <i>Season: 2026. Payable at the base</i>	No	per week	120,00 €
Railing net (Safety net) (Payable at the base) <i>Season: 2026. with installation - Payable at the base</i>	No	per booking	80,00 €
Snorkeling equipment (Payable at the base) <i>Season: 2026. per week - Payable at the base</i>	No	per set	30,00 €
Stand up paddle (SUP) (Payable at the base) <i>Season: 2026. Payable at the base</i>	No	per week	100,00 €
Towels (Payable at the base) <i>Season: 2026. 100*150 cm - Payable at the base</i>	No	per piece	8,00 €



WEBSITE
www.plujeme.cz



E-MAIL
info@plujeme.cz



PHONE
+420 720 755 085



PLUJEME RÁDI S.R.O.
Dlouhá 730/35, 11000 Praha 1 – Staré Město, Czech Republic



MOBILE
+420 777 170 276

PRICE AND AVAILABILITY

13.06. - 20.06.2026 NOT AVAILABLE	20.06. - 27.06.2026 NOT AVAILABLE	27.06. - 04.07.2026 NOT AVAILABLE	04.07. - 11.07.2026 NOT AVAILABLE
11.07. - 18.07.2026 NOT AVAILABLE	18.07. - 25.07.2026 NOT AVAILABLE	25.07. - 01.08.2026 NOT AVAILABLE	01.08. - 08.08.2026 NOT AVAILABLE
08.08. - 15.08.2026 NOT AVAILABLE	15.08. - 22.08.2026 3.363 € 5.900 €	22.08. - 29.08.2026 NOT AVAILABLE	29.08. - 05.09.2026 NOT AVAILABLE
05.09. - 12.09.2026 NOT AVAILABLE	12.09. - 19.09.2026 NOT AVAILABLE	19.09. - 26.09.2026 NOT AVAILABLE	26.09. - 03.10.2026 NOT AVAILABLE
03.10. - 10.10.2026 NOT AVAILABLE	10.10. - 24.10.2026 NOT AVAILABLE	24.10. - 31.10.2026 1.200 € 2.000 €	31.10. - 07.11.2026 1.200 € 2.000 €
07.11. - 14.11.2026 960 € 2.000 €	14.11. - 21.11.2026 1.600 € 2.000 €	21.11. - 28.11.2026 1.600 € 2.000 €	28.11. - 05.12.2026 1.600 € 2.000 €
05.12. - 12.12.2026 1.600 € 2.000 €	12.12. - 19.12.2026 1.600 € 2.000 €	19.12. - 26.12.2026 1.600 € 2.000 €	



WEBSITE

www.plujeme.cz



E-MAIL

info@plujeme.cz



PHONE

+420 720 755 085



MOBILE

+420 777 170 276



PLUJEME RÁDI S.R.O.

Dlouhá 730/35, 11000 Praha 1 – Staré Město, Czech Republic