

BALI 4.1

Avaler (2020)

Catamaran Bali 4.1 Avaler, built in 2020 is anchored in the Dubrovnik, Komolac, ACI Marina Dubrovnik, Dubrovnik region, Croatia. It has 4 cabins, can accommodate 8 + 2 people and has 4 toilets. Bed linen and kitchen equipment are included in the price.

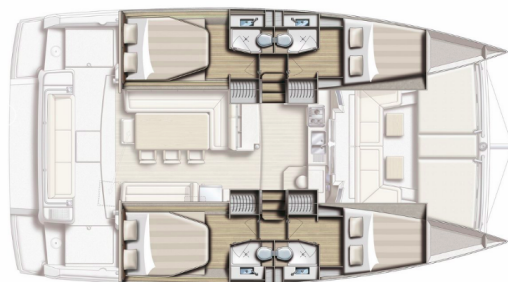

YACHT SPECIFICATIONS

Yacht Base

**Dubrovnik, Komolac, ACI Marina
Dubrovnik, Croatia**

Yacht ID

2708

Brands

Catana

Yacht name

Avaler

Production year

2020

Length

41 ft

Cabins

4

Berths

8 + 2

Max Persons

10

WC

4

Engine

2 x 40 HP

Fuel tank

400 l



WEBSITE

www.plujeme.cz



PHONE

+420 720 755 085



MOBILE

+420 777 170 276



E-MAIL

info@plujeme.cz



PLUJEME RÁDI S.R.O.

Dlouhá 730/35, 11000 Praha 1 – Staré Město, Czech Republic

STANDARD YACHT EQUIPMENT

Comfort	Bed linen, Cockpit cushions, Sun mattresses
Deck	Bathing platform, Bimini top, Cockpit table, Cockpit/stern, outside shower, Dinghy, Flybridge, Forward cockpit
Entertainment	Outdoor speakers, Radio CD player
Galley	Freezer, Hot water, Kitchen utensils (Galley equipment, cutlery), Oven, Refrigerator, Stove
Navigation	Autopilot, GPS chart plotter, Navigation (Nautical) charts and nautical guide, Pilot book, Tridata
Safety	VHF radio
Sails	Electric primary winch
Yacht electrics	Battery charger, Inverter



WEBSITE

www.plujeme.cz



E-MAIL

info@plujeme.cz



PHONE

+420 720 755 085



MOBILE

+420 777 170 276



PLUJEME RÁDI S.R.O.

Dlouhá 730/35, 11000 Praha 1 – Staré Město, Czech Republic

SERVICES

SELECTED SERVICES	OBLIGATORY	PAYMENT TYPE	PRICE
Charter pack (Payable at the base) Season: 2026. includes final cleaning, bedlinen, towels - 1 set/person, cooking gas	Yes	per booking	390,00 €
Outboard engine (Payable at the base) Season: 2026. Free of charge for bookings in May	Yes	per booking	0,00 €
Comfort Pack (Payable at the base) Season: 2026. includes outboard 2,5 HP, WiFi routers	No	per week	105,00 €
Deposit insurance (Payable at the base) Season: 2026. + 400 EUR refundable deposit	No	per booking	320,00 €
Early Check in (Payable at the base) Season: 2026. Saturdays between 13hr - 14hr. Early check in can be confirmed only on embarkation day in the charter base.	No	per booking	200,00 €
Flexible booking (Payable now) Season: 2026. allows you to cancel or rebook your charter up to 30 days before the embarkation for no specific reason. You can reschedule your holiday at no cost for unlimited number of times or use a credit note if you are uncertain of new charter dates. With our FLEX PLAN your rebooking costs are completely eliminated while cancellation costs with refund option are reduced to a minimum (15% of the charter fee, min 350 EUR). Extra bonus: free cancellation and FULL REFUND granted in case of closed state borders within 7 days before the embarkation. Notes: FLEX PLAN costs 7% of the final charter price, can be added to booking up to 72hr after booking confirmation and is not available for bookings confirmed within 30 days before the embarkation.	No	per booking	0,00 €
Hostess (Payable now) Season: 2026. + own cabin 50% cancellation fee in case of cancellation up to 15 days prior to embarkation 100% cancellation fee in case of cancellation within 14 days prior to embarkation	No	per day + food	220,00 €
Late check out (Payable at the base) Season: 2026. Saturdays till 10hr Late check-out can be confirmed only on Friday before the embarkation day.	No	per booking	300,00 €

One way fee (Payable at the base)	No	per booking	480,00 €
Season: 2026. Du - Kas / Seg On request only. One-way conditions: one way fee + skipper service obligatory for the whole booking period + mooring fee in port of disembarkation/embarkation			
Pet on board (Payable at the base)	No	per booking	150,00 €
Season: 2026. Small or medium pet, up to 25 kg			
Provisioning (Payable now)	No	per booking	0,00 €
Season: 2026. upon request + price of groceries, to be done online			
Skipper (Payable now)	No	per day + food	220,00 €
Season: 2026. + own cabin 50% cancellation fee in case of cancellation up to 15 days prior to embarkation 100% cancellation fee in case of cancellation within 14 days prior to embarkation			



WEBSITE

www.plujeme.cz



E-MAIL

info@plujeme.cz



PHONE

+420 720 755 085



MOBILE

+420 777 170 276



PLUJEME RÁDI S.R.O.

Dlouhá 730/35, 11000 Praha 1 – Staré Město, Czech Republic

ADDITIONAL EXTRAS

EXTRA	OBLIGATORY	PAYMENT TYPE	PRICE
Beach towel (Payable at the base) Season: 2026. Payable at the base	No	per piece	8,00 €
Extra bedlinen (Payable at the base) Season: 2026. Payable at the base	No	per set	15,00 €
Floating Water Hammock (Payable at the base) Season: 2026. Partyzone - Payable at the base	No	per week	220,00 €
Kayak (Payable at the base) Season: 2026. 2 pax - Payable at the base	No	per week	150,00 €
Outboard engine 2,5 HP (Payable at the base) Season: 2026. Payable at the base	No	per week	100,00 €
Outboard engine 5 HP (Payable at the base) Season: 2026. on request - Payable at the base	No	per week	150,00 €
Railing net (Safety net) (Payable at the base) Season: 2026. Rental without mounting - Payable at the base	No	per booking	20,00 €
Snorkeling equipment (Payable at the base) Season: 2026. Payable at the base	No	per week	10,00 €
Stand up paddle (SUP) (Payable at the base) Season: 2026. Payable at the base	No	per week	120,00 €
Towels (Payable at the base) Season: 2026. 2 psc/set (1 x 50x100cm + 1 x 70x140cm) - Payable at the base	No	per set	8,00 €
Wi-Fi Internet (Payable at the base) Season: 2026. Payable at the base	No	per week	25,00 €



WEBSITE
www.plujeme.cz



PHONE
+420 720 755 085



MOBILE
+420 777 170 276



E-MAIL
info@plujeme.cz



PLUJEME RÁDI S.R.O.
Dlouhá 730/35, 11000 Praha 1 – Staré Město, Czech Republic

PRICE AND AVAILABILITY

25.04. - 02.05.2026 1.584 € 1.980 €	02.05. - 09.05.2026 1.584 € 1.980 €	09.05. - 16.05.2026 1.776 € 2.220 €	16.05. - 23.05.2026 2.352 € 2.940 €
23.05. - 30.05.2026 2.736 € 3.420 €	30.05. - 06.06.2026 NOT AVAILABLE	06.06. - 13.06.2026 NOT AVAILABLE	13.06. - 20.06.2026 NOT AVAILABLE
20.06. - 27.06.2026 NOT AVAILABLE	27.06. - 04.07.2026 NOT AVAILABLE	04.07. - 11.07.2026 NOT AVAILABLE	11.07. - 18.07.2026 5.744 € 7.180 €
18.07. - 25.07.2026 5.984 € 7.480 €	25.07. - 01.08.2026 5.984 € 7.480 €	01.08. - 08.08.2026 NOT AVAILABLE	08.08. - 15.08.2026 5.776 € 7.220 €
15.08. - 22.08.2026 NOT AVAILABLE	22.08. - 29.08.2026 ON OPTION	29.08. - 05.09.2026 5.456 € 6.820 €	05.09. - 19.09.2026 NOT AVAILABLE
19.09. - 26.09.2026 NOT AVAILABLE	26.09. - 03.10.2026 3.216 € 4.020 €	03.10. - 10.10.2026 NOT AVAILABLE	10.10. - 17.10.2026 NOT AVAILABLE
17.10. - 24.10.2026 1.472 € 1.840 €	24.10. - 31.10.2026 1.472 € 1.840 €	31.10. - 07.11.2026 1.472 € 1.840 €	07.11. - 14.11.2026 1.472 € 1.840 €
14.11. - 21.11.2026 1.472 € 1.840 €	21.11. - 28.11.2026 1.472 € 1.840 €	28.11. - 05.12.2026 1.472 € 1.840 €	



WEBSITE

www.plujeme.cz



E-MAIL

info@plujeme.cz



PHONE

+420 720 755 085



MOBILE

+420 777 170 276



PLUJEME RÁDI S.R.O.

Dlouhá 730/35, 11000 Praha 1 – Staré Město, Czech Republic

PRICE AND AVAILABILITY

05.12. - 12.12.2026

1.472 € 1.840 €

12.12. - 19.12.2026

1.472 € 1.840 €

19.12. - 26.12.2026

1.472 € 1.840 €



WEBSITE

www.plujeme.cz



E-MAIL

info@plujeme.cz



PHONE

+420 720 755 085



MOBILE

+420 777 170 276



PLUJEME RÁDI S.R.O.

Dlouhá 730/35, 11000 Praha 1 – Staré Město, Czech Republic