

# BAVARIA CRUISER 46 STYLE

Sunshine (2020)

Sailing yacht Bavaria Cruiser 46 Style Sunshine, built in 2020 is anchored in the **Trogir, Marina Trogir (ex.SCT), Split region, Croatia**. It has **4 cabins**, can accommodate **8 + 1 people** and has **3 toilets**. Bed linen and kitchen equipment are included in the price.

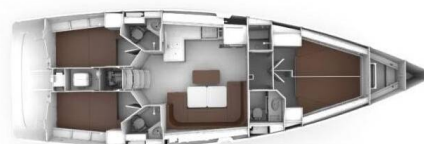

## YACHT SPECIFICATIONS

Yacht Base

**Trogir, Marina Trogir (ex.SCT),  
Croatia**

Yacht ID

**2653**

Brands

**Bavaria**

Yacht name

**Sunshine**

Production year

**2020**

Length

**47 ft**

Cabins

**4**

Berths

**8 + 1**

Max Persons

**9**

WC

**3**

Engine

**1 x 55 HP**

Fuel tank

**210 l**



**WEBSITE**

[www.plujeme.cz](http://www.plujeme.cz)



**PHONE**

+420 720 755 085



**MOBILE**

+420 777 170 276



**E-MAIL**

[info@plujeme.cz](mailto:info@plujeme.cz)



**PLUJEME RÁDI S.R.O.**

Dlouhá 730/35, 11000 Praha 1 – Staré Město, Czech Republic

## STANDARD YACHT EQUIPMENT

Comfort	<b>Cockpit cushions</b>
Deck	<b>Anchor line, Anchor swivel, Bathing platform, Bimini top, Black ball, Black conus, Boat hook, Bosun's chair (Safe seat) (boatswain's chair), Canister for water, Cockpit table, Cockpit/stern, outside shower, Dinghy, Dinghy (byboat) pump, Electric anchor windlass, Fenders, Gangway, Hawser, Impeller, V-belt, oilfilter, Jerry cans for diesel, Main anchor, Mooring ropes, Plastic bucket, Repair box for dinghy, Round/globular fender, Spare anchor (Reserve, Auxiliary anchor), Spotlight / Headlights, Sprayhood, Spring line, Teak cockpit, Water hose</b>
Entertainment	<b>Outdoor speakers, Radio, Underwater lights</b>
Galley	<b>Coffee machine, Dishwasher, Gas bottles, Hot water, Kitchen utensils (Galley equipment, cutlery), Microwave, Refrigerator</b>
Interior	<b>Barometer, Clock, Electric toilet</b>
Navigation	<b>Autopilot, Bow thruster, GPS chart plotter - cockpit, Harbour guides, Logge/Lot/Speed/Wind, Navigation (Nautical) charts and nautical guide, Navigation set, Radar reflector, Spyglass with bearing compass</b>
Safety	<b>Distress signals, Fire extinguisher, First aid kit, Flashlight, Fog horn, Life belts (Safety harness), Life buoy + Flashing light, Life jackets, Liferaft, Set of tools, VHF radio, Wire (shroud cutter)</b>
Yacht electrics	<b>12V Socket, Air Conditioning, Batteries, Battery charger, Generator, Heating, Inverter, Lithium battery, Shore connection 220 V, Solar panels, USB sockets</b>



**WEBSITE**

[www.plujeme.cz](http://www.plujeme.cz)



**PHONE**

+420 720 755 085



**MOBILE**

+420 777 170 276



**E-MAIL**

[info@plujeme.cz](mailto:info@plujeme.cz)



**PLUJEME RÁDI S.R.O.**

Dlouhá 730/35, 11000 Praha 1 – Staré Město, Czech Republic

## SERVICES

SELECTED SERVICES	OBLIGATORY	PAYMENT TYPE	PRICE
<b>Charter package</b> (Payable at the base) <b>Season: 2026.</b> incl. Permit, outboard engine, Wi-Fi Internet (5 GB), bed linen (1 set/ person)	Yes	per booking	<b>375,00 €</b>
<b>Early afternoon boarding/check-in</b> (Payable at the base) <b>Season: 2026.</b> -> 2.00 pm – 4.00 pm, max. 5 yachts	No	per booking	<b>75,00 €</b>
<b>Early boarding/check-in</b> (Payable at the base) <b>Season: 2026.</b> -> 12.30 pm – 2.00 pm, max 5 yachts	No	per booking	<b>200,00 €</b>
<b>Extra cleaning</b> (Payable at the base) <b>Season: 2026.</b>	No	per booking	<b>200,00 €</b>
<b>Hostess</b> (Payable at the base) <b>Season: 2026.</b> + own cabin; external service provider, direct billing	No	per day + food	<b>200,00 €</b>
<b>Pet on board</b> (Payable at the base) <b>Season: 2026.</b>	No	per pet	<b>200,00 €</b>
<b>Regatta charge</b> (Payable at the base) <b>Season: 2026.</b> ON REQUEST	No	per booking	<b>0,00 €</b>
<b>Skipper</b> (Payable at the base) <b>Season: 2026.</b> + own cabin; external service provider	No	per day + food	<b>200,00 €</b>
<b>WI-FI Internet connection on boat</b> (Payable at the base) <b>Season: 2026.</b> unlimited / depending on the network reception (5 GB are included in the Charter package)	No	per week	<b>30,00 €</b>



**WEBSITE**

[www.plujeme.cz](http://www.plujeme.cz)



**PHONE**

+420 720 755 085



**MOBILE**

+420 777 170 276



**E-MAIL**

[info@plujeme.cz](mailto:info@plujeme.cz)



**PLUJEME RÁDI S.R.O.**

Dlouhá 730/35, 11000 Praha 1 – Staré Město, Czech Republic

## ADDITIONAL EXTRAS

EXTRA	OBLIGATORY	PAYMENT TYPE	PRICE
<b>Extra bedlinen</b> (Payable at the base) <b>Season: 2026.</b> 1 set/ person is included in the charter package - Payable at the base	No	per set	<b>10,00 €</b>
<b>Flexible bulkhead system</b> (Payable at the base) <b>Season: 2026.</b> Payable at the base	No	per booking	<b>180,00 €</b>
<b>Glass bottom dinghy</b> (Payable at the base) <b>Season: 2026.</b> Formentera 270 PC + approx. 3 HP ePropulsion engine, max. 3 persons, in 8,5 h fully loaded with 12 V - Payable at the base	No	per week	<b>220,00 €</b>
<b>Grill/Barbecue/Plancha</b> (Payable at the base) <b>Season: 2026.</b> Payable at the base	No	per booking	<b>65,00 €</b>
<b>Ice box</b> (Payable at the base) <b>Season: 2026.</b> Mobile Cooler Box (no power connection): approx. 52L, limited availability, For drinks and ice only. Box must be returned clean and undamaged. Ice cubes are not included. Max. 3 yachts. - Payable at the base	No	per booking	<b>30,00 €</b>
<b>Ice maker</b> (Payable at the base) <b>Season: 2026.</b> operating with - shorepower or - Inverter min. 2.000 W or - Generator - Payable at the base	No	per booking	<b>45,00 €</b>
<b>NESPRESSO coffee machine</b> (Payable at the base) <b>Season: 2026.</b> operating with - shorepower or - Inverter min. 2000 W or - Generator - Payable at the base	No	per booking	<b>45,00 €</b>
<b>Railing net (Safety net)</b> (Payable at the base) <b>Season: 2026.</b> incl. mounting and unmounting - Payable at the base	No	per booking	<b>180,00 €</b>
<b>Railing net (Safety net)</b> (Payable at the base) <b>Season: 2026.</b> To be mounted / unmounted by the client (Net and mounting material must be returned by the crew after the charter) - Payable at the base	No	per booking	<b>35,00 €</b>
<b>Stand up paddle (SUP)</b> (Payable at the base) <b>Season: 2026.</b> Payable at the base	No	per week	<b>100,00 €</b>
<b>Towels</b> (Payable at the base) <b>Season: 2026.</b> Payable at the base	No	per set	<b>10,00 €</b>

 **WEBSITE**  
[www.plujeme.cz](http://www.plujeme.cz)

 **PHONE**  
 +420 720 755 085

 **MOBILE**  
 +420 777 170 276

 **E-MAIL**  
[info@plujeme.cz](mailto:info@plujeme.cz)

 **PLUJEME RÁDI S.R.O.**  
 Dlouhá 730/35, 11000 Praha 1 – Staré Město, Czech Republic

## PRICE AND AVAILABILITY

25.04. - 02.05.2026 NOT AVAILABLE	02.05. - 06.05.2026 NOT AVAILABLE	06.05. - 09.05.2026 NOT AVAILABLE	09.05. - 16.05.2026 NOT AVAILABLE
16.05. - 23.05.2026 <b>1.720 €</b> 2.150 €	23.05. - 30.05.2026 NOT AVAILABLE	30.05. - 06.06.2026 NOT AVAILABLE	06.06. - 13.06.2026 NOT AVAILABLE
13.06. - 17.06.2026 NOT AVAILABLE	17.06. - 24.06.2026 NOT AVAILABLE	24.06. - 01.07.2026 NOT AVAILABLE	01.07. - 08.07.2026 NOT AVAILABLE
08.07. - 11.07.2026 ON OPTION	11.07. - 18.07.2026 NOT AVAILABLE	18.07. - 25.07.2026 <b>3.352 €</b> 4.190 €	25.07. - 01.08.2026 NOT AVAILABLE
01.08. - 08.08.2026 <b>3.352 €</b> 4.190 €	08.08. - 15.08.2026 NOT AVAILABLE	15.08. - 22.08.2026 <b>3.560 €</b> 4.450 €	22.08. - 29.08.2026 <b>3.160 €</b> 3.950 €
29.08. - 05.09.2026 NOT AVAILABLE	05.09. - 12.09.2026 NOT AVAILABLE	12.09. - 19.09.2026 NOT AVAILABLE	19.09. - 26.09.2026 NOT AVAILABLE
26.09. - 03.10.2026 NOT AVAILABLE	03.10. - 10.10.2026 <b>1.800 €</b> 2.250 €	10.10. - 17.10.2026 <b>1.752 €</b> 2.190 €	17.10. - 24.10.2026 <b>1.560 €</b> 1.950 €
24.10. - 31.10.2026 <b>1.400 €</b> 1.750 €	31.10. - 07.11.2026 <b>1.400 €</b> 1.750 €	07.11. - 14.11.2026 <b>1.320 €</b> 1.650 €	14.11. - 21.11.2026 <b>1.320 €</b> 1.650 €
22.11. - 31.12.2026 NOT AVAILABLE			



**WEBSITE**  
www.plujeme.cz



**E-MAIL**  
info@plujeme.cz



**PHONE**  
+420 720 755 085



**MOBILE**  
+420 777 170 276



**PLUJEME RÁDI S.R.O.**  
Dlouhá 730/35, 11000 Praha 1 – Staré Město, Czech Republic