

SUN ODYSSEY 490

Pileas (2020)

Sailing yacht Sun Odyssey 490 Pileas, built in 2020 is anchored in the **Corfu, Gouvia Marina, Ionian Islands, Greece**. It has **5 + 1 cabins**, can accommodate **10 + 2 people** and has **3 toilets**. Bed linen and kitchen equipment are included in the price.

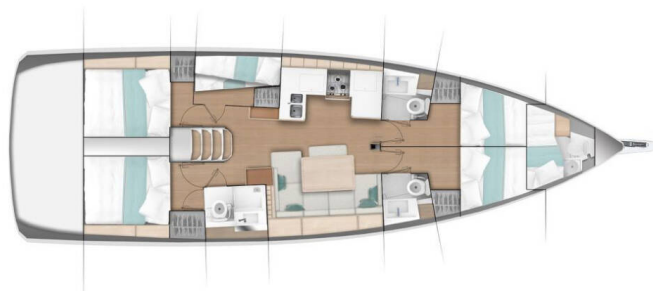

YACHT SPECIFICATIONS

Yacht Base

Corfu, Gouvia Marina, Greece

Yacht ID

2565

Brands

Jeanneau

Yacht name

Pileas

Production year

2020

Length

47 ft

Cabins

5 + 1

Berths

10 + 2

WC

3

Engine

1 x 0 HP

Fuel tank

01



WEBSITE

www.plujeme.cz



PHONE

+420 720 755 085



MOBILE

+420 777 170 276



E-MAIL

info@plujeme.cz



PLUJEME RÁDI S.R.O.

Dlouhá 730/35, 11000 Praha 1 – Staré Město, Czech Republic

STANDARD YACHT EQUIPMENT

Comfort

Cockpit cushions

Deck

Bathing platform, Bimini top, Dinghy with outboard engine, Gangway, Sprayhood

Entertainment

Radio

Interior

Electric fans in cabins, Electric toilet

Navigation

Autopilot, Bow thruster, GPS chart plotter

Sails

Electric winch

Yacht electrics

Solar panels



WEBSITE

www.plujeme.cz



E-MAIL

info@plujeme.cz



PHONE

+420 720 755 085



MOBILE

+420 777 170 276



PLUJEME RÁDI S.R.O.

Dlouhá 730/35, 11000 Praha 1 – Staré Město, Czech Republic

SERVICES

| SELECTED SERVICES | OBLIGATORY | PAYMENT TYPE | PRICE |
|---|------------|----------------|-----------------|
| Security Deposit Waiver (Payable at the base) Season: 2026. 200 EUR credit voucher for the next charter in case of no damage/loss upon redelivery. No cash refund. | Yes | per booking | 450,00 € |
| Standard Charter Pack (Payable at the base) Season: 2026. Welcome kit | Yes | per booking | 280,00 € |
| Beach towel (Payable at the base) Season: 2026. | No | per booking | 10,00 € |
| Berth cost (Payable at the base) Season: 2026. Berthing fees for first & last night at the marina/port | No | per booking | 0,00 € |
| Cabin conversion (Payable at the base) Season: 2026. If possible on yacht. Contact fleet operator for more information. | No | per booking | 150,00 € |
| Cook (Payable at the base) Season: 2026. Crew provisioning to be provided by Charterer in arrangement with crew. If monetary compensation shall be agreed, then it shall be of no less than €30 per crew member per day. Charterer shall provide crew with sleeping cabin/berth and shower/toilet use to be designated to them onboard. | No | per day + food | 215,00 € |
| Family pack (Payable at the base) Season: 2026. Safety net, SUP, junior life jackets, normal foam type | No | per booking | 350,00 € |
| Fast Track pack (Payable at the base) Season: 2026. Access to the yacht by 14:00h on embarkation day, only IF feasible | No | per booking | 200,00 € |
| Hostess (Payable at the base) Season: 2026. Crew provisioning to be provided by Charterer in arrangement with crew. If monetary compensation shall be agreed, then it shall be of no less than €30 per crew member per day. Charterer shall provide crew with sleeping cabin/berth and shower/toilet use to be designated to them onboard. | No | per day + food | 180,00 € |

| | | | |
|---|----|----------------|-------------------|
| Internet pack (Payable at the base) Season: 2026. Wi-Fi router for Internet aboard (subject to GSM coverage up to 10GB/week) | No | per week | 50,00 € |
| One way fee (Payable at the base) Season: 2026. Volos-Skiathos | No | per booking | 300,00 € |
| One way fee (Payable at the base) Season: 2026. Preveza-Lefkas | No | per booking | 300,00 € |
| One way fee (Payable at the base) Season: 2026. Athens-Lavrion | No | per booking | 500,00 € |
| One way fee (Payable at the base) Season: 2026. Athens-Cyclades/Sporades | No | per booking | 1.000,00 € |
| One way fee (Payable at the base) Season: 2026. Athens-Dodecanese | No | per booking | 1.200,00 € |
| One way fee (Payable at the base) Season: 2026. Kos-Rhodos | No | per booking | 600,00 € |
| One way fee (Payable at the base) Season: 2026. Lefkas/Preveza-Corfu | No | per booking | 600,00 € |
| One way fee (Payable at the base) Season: 2026. Athens-Lefkas-Preveza | No | per booking | 1.200,00 € |
| One way fee (Payable at the base) Season: 2026. Athens-Corfu | No | per booking | 1.400,00 € |
| Overnight on board (Payable at the base) Season: 2026. Embarkation on yacht & overnight stay the day before charter starts, check-in by 13:00h on charter start day. Subject to last minute availability of yacht on previous day. | No | per booking | 180,00 € |
| Pet on board (Payable at the base) Season: 2026. up to 7 kg | No | per booking | 200,00 € |
| Skipper (Payable at the base) Season: 2026. Crew provisioning to be provided by Charterer in arrangement with crew. If monetary compensation shall be agreed, then it shall be of no less than €30 per crew member per day. Charterer shall provide crew with sleeping cabin/berth and shower/toilet use to be designated to them onboard. Skippered charters come obligatorily with: Security deposit waiver, non refundable, EUR 400 | No | per day + food | 215,00 € |

Stand up paddle (SUP) (Payable at the base)

No

per week

100,00 €

Season: 2026.

VIP Pack (Payable at the base)

No

per booking

300,00 €

Season: 2026. Airport/Local Base welcome & pickup, transfer to the yacht, welcome pack with sparkling wine & fruits, departure transfer to the local airport



WEBSITE

www.plujeme.cz



E-MAIL

info@plujeme.cz



PHONE

+420 720 755 085



MOBILE

+420 777 170 276



PLUJEME RÁDI S.R.O.

Dlouhá 730/35, 11000 Praha 1 – Staré Město, Czech Republic

ADDITIONAL EXTRAS

| EXTRA | OBLIGATORY | PAYMENT TYPE | PRICE |
|---|------------|------------------|-----------------|
| Automatic Inflatable Life Jacket (Payable at the base) <i>Season: 2026. Payable at the base</i> | No | per week/ person | 20,00 € |
| Beach towel (Payable at the base) <i>Season: 2026. Payable at the base</i> | No | per piece | 10,00 € |
| Extra bedlinen (Payable at the base) <i>Season: 2026. Payable at the base</i> | No | per set | 10,00 € |
| Grill/Barbecue/Plancha (Payable at the base) <i>Season: 2026. portable, 1 x gas bottle included - Payable at the base</i> | No | per week | 80,00 € |
| Kayak (Payable at the base) <i>Season: 2026. Payable at the base</i> | No | per week | 100,00 € |
| Railing net (Safety net) (Payable at the base) <i>Season: 2026. installed - Payable at the base</i> | No | per booking | 200,00 € |
| Stand up paddle (SUP) (Payable at the base) <i>Season: 2026. Payable at the base</i> | No | per week | 100,00 € |



WEBSITE
www.plujeme.cz



E-MAIL
info@plujeme.cz



PHONE
+420 720 755 085



MOBILE
+420 777 170 276



PLUJEME RÁDI S.R.O.
Dlouhá 730/35, 11000 Praha 1 – Staré Město, Czech Republic

PRICE AND AVAILABILITY

| | | | |
|--|--|--|--|
| 20.06. - 27.06.2026 3.900 € 6.000 € | 27.06. - 04.07.2026 NOT AVAILABLE | 04.07. - 11.07.2026 NOT AVAILABLE | 11.07. - 18.07.2026 3.900 € 6.000 € |
| 18.07. - 25.07.2026 4.800 € 6.000 € | 25.07. - 01.08.2026 NOT AVAILABLE | 01.08. - 08.08.2026 5.760 € 7.200 € | 08.08. - 15.08.2026 5.760 € 7.200 € |
| 15.08. - 22.08.2026 NOT AVAILABLE | 22.08. - 29.08.2026 5.360 € 6.700 € | 29.08. - 05.09.2026 5.695 € 6.700 € | 05.09. - 12.09.2026 NOT AVAILABLE |
| 12.09. - 19.09.2026 NOT AVAILABLE | 19.09. - 26.09.2026 NOT AVAILABLE | 26.09. - 03.10.2026 NOT AVAILABLE | 03.10. - 10.10.2026 NOT AVAILABLE |
| 10.10. - 17.10.2026 4.320 € 4.800 € | 17.10. - 24.10.2026 3.330 € 3.700 € | 24.10. - 31.10.2026 3.330 € 3.700 € | 31.10. - 07.11.2026 3.330 € 3.700 € |
| 07.11. - 14.11.2026 3.330 € 3.700 € | 14.11. - 21.11.2026 3.330 € 3.700 € | 21.11. - 31.12.2026 NOT AVAILABLE | 02.01. - 09.01.2027 2.250 € 2.500 € |
| 09.01. - 16.01.2027 2.250 € 2.500 € | 16.01. - 23.01.2027 2.250 € 2.500 € | 23.01. - 30.01.2027 2.250 € 2.500 € | 30.01. - 06.02.2027 2.250 € 2.500 € |



WEBSITE

www.plujeme.cz



E-MAIL

info@plujeme.cz



PHONE

+420 720 755 085



MOBILE

+420 777 170 276



PLUJEME RÁDI S.R.O.

Dlouhá 730/35, 11000 Praha 1 – Staré Město, Czech Republic

PRICE AND AVAILABILITY

| | | | |
|---|---|---|---|
| 06.02. - 13.02.2027 2.250 € 2.500 € | 13.02. - 20.02.2027 2.250 € 2.500 € | 20.02. - 27.02.2027 2.250 € 2.500 € | 27.02. - 06.03.2027 2.250 € 2.500 € |
| 06.03. - 13.03.2027 2.250 € 2.500 € | 13.03. - 20.03.2027 2.250 € 2.500 € | 20.03. - 27.03.2027 2.250 € 2.500 € | 27.03. - 03.04.2027 2.250 € 2.500 € |
| 03.04. - 10.04.2027 2.250 € 2.500 € | 10.04. - 17.04.2027 2.250 € 2.500 € | 17.04. - 24.04.2027 2.250 € 2.500 € | 24.04. - 01.05.2027 3.060 € 3.400 € |
| 01.05. - 08.05.2027 3.060 € 3.400 € | 08.05. - 15.05.2027 3.690 € 4.100 € | 15.05. - 22.05.2027 3.690 € 4.100 € | 22.05. - 29.05.2027 4.680 € 5.200 € |
| 29.05. - 05.06.2027 4.680 € 5.200 € | 05.06. - 12.06.2027 4.680 € 5.200 € | 12.06. - 19.06.2027 4.680 € 5.200 € | 19.06. - 26.06.2027 5.400 € 6.000 € |
| 26.06. - 03.07.2027 5.400 € 6.000 € | 03.07. - 10.07.2027 5.400 € 6.000 € | 10.07. - 17.07.2027 5.400 € 6.000 € | 17.07. - 24.07.2027 5.400 € 6.000 € |
| 24.07. - 31.07.2027 5.400 € 6.000 € | 31.07. - 07.08.2027 6.480 € 7.200 € | 07.08. - 14.08.2027 6.480 € 7.200 € | 14.08. - 21.08.2027 6.480 € 7.200 € |
| 21.08. - 28.08.2027 6.030 € 6.700 € | 28.08. - 04.09.2027 6.030 € 6.700 € | 04.09. - 11.09.2027 6.030 € 6.700 € | 11.09. - 18.09.2027 5.850 € 6.500 € |
| 18.09. - 25.09.2027 5.850 € 6.500 € | 25.09. - 02.10.2027 4.770 € 5.300 € | | |



WEBSITE

www.plujeme.cz



E-MAIL

info@plujeme.cz



PHONE

+420 720 755 085



MOBILE

+420 777 170 276



PLUJEME RÁDI S.R.O.

Dlouhá 730/35, 11000 Praha 1 – Staré Město, Czech Republic

PRICE AND AVAILABILITY

| | | | |
|---|---|---|---|
| 02.10. - 09.10.2027 4.590 € 5.100 € | 09.10. - 16.10.2027 4.320 € 4.800 € | 16.10. - 23.10.2027 3.330 € 3.700 € | 23.10. - 30.10.2027 3.330 € 3.700 € |
| 30.10. - 06.11.2027 3.330 € 3.700 € | 06.11. - 13.11.2027 3.330 € 3.700 € | 13.11. - 20.11.2027 3.330 € 3.700 € | 20.11. - 27.11.2027 3.330 € 3.700 € |
| 27.11. - 04.12.2027 3.330 € 3.700 € | 04.12. - 11.12.2027 3.330 € 3.700 € | 11.12. - 18.12.2027 3.330 € 3.700 € | 18.12. - 25.12.2027 3.330 € 3.700 € |



WEBSITE

www.plujeme.cz



E-MAIL

info@plujeme.cz



PHONE

+420 720 755 085



MOBILE

+420 777 170 276



PLUJEME RÁDI S.R.O.

Dlouhá 730/35, 11000 Praha 1 – Staré Město, Czech Republic