

SUN LOFT 47

Asti (2020)

Sailing yacht Sun Loft 47 Asti, built in 2020 is anchored in the Trogir, Yachtclub Seget (Marina Baotić), Split region, Croatia . It has 6 + 1 cabins, can accommodate 12 + 1 people and has 4 + 1 toilets. Bed linen and kitchen equipment are included in the price.

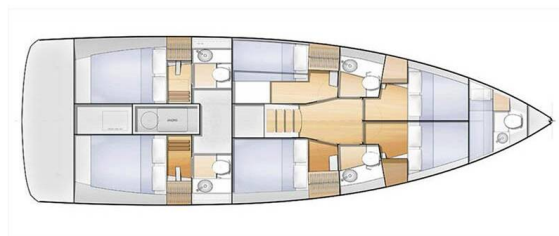

YACHT SPECIFICATIONS

Yacht Base

Trogir, Yachtclub Seget (Marina Baotić), Croatia

Yacht ID

2507

Brands

Jeanneau

Yacht name

Asti

Production year

2020

Length

47 ft

Cabins

6 + 1

Berths

12 + 1

Max Persons

13

WC

4 + 1

Engine

1 x 80 HP

Fuel tank

240 l



WEBSITE

www.plujeme.cz



PHONE

+420 720 755 085



MOBILE

+420 777 170 276



E-MAIL

info@plujeme.cz



PLUJEME RÁDI S.R.O.

Dlouhá 730/35, 11000 Praha 1 – Staré Město, Czech Republic

STANDARD YACHT EQUIPMENT

Additional	Flag
Comfort	Blankets, Cockpit cushions, Mattresses, Pillows, Sheets, Sun mattresses
Deck	Anchor with chain, Bilge pump - Mechanic, Bimini top, Boat hook, Bosun's chair (Safe seat) (boatswain's chair), Cockpit fridge, Cockpit grill, Cockpit table, Cockpit/stern, outside shower, Deck brush, Deck lights, Diesel filter, Dinghy with outboard engine, Fenders, Fuel funnel, Galley in cockpit, Gangway, Hot water in cockpit, Jerry cans for fuel, Plastic bucket, Round/globular fender, Spare anchor (Reserve, Auxiliary anchor), Sponge, Sprayhood, Swimming ladder, Water hose
Entertainment	Fusion radio
Galley	Gas bottles, Kitchen towel, Kitchen utensils (Galley equipment, cutlery), Refrigerator, Sink, Water pump
Interior	Clothes hangers, Electric fans in cabins, LED interior lights, Toilet brush
Navigation	Binoculars, Bow thruster, Compass, GPS chart plotter, Log, Nautical charts, Navigation set, Navigation/position Lights, Radar reflector, Raymarine navsystem (Tridata, Echo, Wind)
Safety	Distress flare box, Emergency tiller, Engine spare parts, Fire extinguisher, First aid kit, Flashlight, Fog horn, Inflatable life raft, Life belts (Safety harness), Liferaft, Set of tools, Torch, Wire (shroud) cutter
Sails	Self tacking jib, Winch
Yacht electrics	Batteries, Battery charger, Bilge pump - Electric, Inverter, Motor hours counter, Service batteries, Shore connection 220 V, Shore power cable, USB sockets, Water heater



WEBSITE

www.plujeme.cz



PHONE

+420 720 755 085



MOBILE

+420 777 170 276



E-MAIL

info@plujeme.cz



PLUJEME RÁDI S.R.O.

Dlouhá 730/35, 11000 Praha 1 - Staré Město, Czech Republic

SERVICES

SELECTED SERVICES	OBLIGATORY	PAYMENT TYPE	PRICE
Handling fees (Payable now) Season: 2026 New.	Yes	per booking	20,00 €
Preparation fee (Payable now) Season: 2026 New. INCLUDED: Welcome pack // final cleaning // 1 set of bed sheets / cabin & 1 set of towels / pax, dinghy, outboard engine & initial supply of fuel, gas and water tanks // 1st & last night in the marina // NOT INCLUDED: refuelling, gas & water consumption at end of charter, taxes if any, handling fees & additional equipment deposit.	Yes	per booking	335,00 €
Tourist tax (Payable at the base) Season: 2026 New.	Yes	per guest/day	1,33 €
Adrenalin pack (Payable now) Season: 2026 New. * upon request - + 300 EUR deposit - includes 2 donuts, 1 wake board, 1 pair of water skis, bigger rib (4,70m) with outboard engine 50 HP in Trogir and 40 HP in Dubrovnik. **Important note: The bigger rib is to be towed and can not be used in Italian water territories! Surcharge for a skipper if clients book an adrenalin pack - 200 EURO ***CANNOT BE USED ON ONE-WAY CHARTERS***	No	per booking	1.050,00 €
Cook (Payable now) Season: 2026 New. +provisioning ; Crew on board must have their own toilets/ showers. If either a skipper or a hostess/cook is on board, 1 double cabin will be required for him/her. If both a skipper and a hostess/cook are on board, 1 double cabin and 1 forepeak cabin will be required for them. Exceptions exists for specific layouts, Sales Agents will provide more details about the different boat models. Cooking breakfast, lunch, 5 dinners a week, supply, keeping the kitchen clean (not the rest of the boat, not the cabins).	No	per week + food	1.890,00 €
Crew change (Payable now) Season: 2026 New. Any crew change during the charter is subject to € 250.- additional cost. The charge includes administration cost, change of bed linen and towels and one night at NY ponton (marina fee included only if the same base than start base). It doesn't include cleaning, nor new transit log where applicable.	No	per booking	250,00 €

Crew surcharge early check in (Payable now)	No	per booking	125,00 €
Season: 2026 New. VIP crew surcharge 125€ per crew member. *** (ONLY APPLIED WHEN VIP PACK AND A CREW MEMBER ARE BOOKED)***			
Damage waiver (Payable now)	No	per night	50,00 €
Season: 2026 New. Damage waiver limits your liability to the reduced Security Deposit . Mandatory when skipper is added. Price is per night of the charter (minimum value of 7 nights & a maximum value of 21 nights) Not applicable for 4+ weeks charters , nor Regattas/Races.			
Extra cleaning (Payable now)	No	per booking	290,00 €
Season: 2026 New. Optional Additional cleaning			
Extra set of linen (choose how many) (Payable now)	No	per booking	15,00 €
Season: 2026 New. Extra set of linen : 15 € 1 set of linen (2 sheets & 2 pillow case) - to be updated manually			
Extra set of towels (choose how many) (Payable now)	No	per booking	10,00 €
Season: 2026 New. Extra set of towels: 10 € 1 set of towels (1 face & 1 bath towel) - to be updated manually			
Full board 1-4 pax (number of guests to update manually) (Payable now)	No	per guest/day	60,00 €
Season: 2026 New. only available if cook is booked on board as the cook will do the provisioning based on client's preference. Includes breakfast, lunch & dinner + the crew's food. Does not included alcoholic drinks			
Full board 5-12 pax (number of guests to update manually) (Payable now)	No	per guest/day	55,00 €
Season: 2026 New. only available if cook is booked on board as the cook will do the provisioning based on client's preference. Includes breakfast, lunch & dinner + the crew's food. Does not included alcoholic drinks			
Gritchen cancellation insurance (Payable now)	No	per booking	0,00 €
Season: 2026 New. with Covid coverage (4% of client's Total price)- European clients Only			
Half board 1-4 pax (number of guests to update manually) (Payable now)	No	per guest/day	50,00 €
Season: 2026 New. only available if cook is booked on board as the cook will do the provisioning based on client's preference. Includes breakfast & lunch OR dinner + the crew's food. Does not included alcoholic drinks			
Half board 5-12 pax (number of guests to update manually) (Payable now)	No	per guest/day	45,00 €
Season: 2026 New. only available if cook is booked on board as the cook will do the provisioning based on client's preference. Includes breakfast & lunch OR dinner + the crew's food. Does not included alcoholic drinks			

<p>Hostess (Payable now)</p> <p>Season: 2026 New. +provisioning ; Crew on board must have their own toilets/ showers. If either a skipper or a hostess/cook is on board, 1 double cabin will be required for him/her. If both a skipper and a hostess/cook are on board, 1 double cabin and 1 forepeak cabin will be required for them. Exceptions exists for specific layouts, Sales Agents will provide more details about the different boat models. Breakfast, light lunch, keeping the boat and toilet clean.</p>	No	per week + food	1.330,00 €
<p>Hostess (Payable now)</p> <p>Season: 2026 New. +provisioning ; Crew on board must have their own toilets/ showers. If either a skipper or a hostess/cook is on board, 1 double cabin will be required for him/her. If both a skipper and a hostess/cook are on board, 1 double cabin and 1 forepeak cabin will be required for them. Exceptions exists for specific layouts, Sales Agents will provide more details about the different boat models. Breakfast, light lunch, keeping the boat and toilet clean.</p>	No	per week + food	1.330,00 €
<p>Hostess (Payable now)</p> <p>Season: 2026 New. +provisioning ; Crew on board must have their own toilets/ showers. If either a skipper or a hostess/cook is on board, 1 double cabin will be required for him/her. If both a skipper and a hostess/cook are on board, 1 double cabin and 1 forepeak cabin will be required for them. Exceptions exists for specific layouts, Sales Agents will provide more details about the different boat models. Breakfast, light lunch, keeping the boat and toilet clean.</p>	No	per week + food	1.465,00 €
<p>Parking (Payable now)</p> <p>Season: 2026 New. Navigare parking Special slots within the Baotic Marina, only for Navigare clients. Price is per week, per vehicle. UPON REQUEST, LIMITED NUMBER</p>	No	per day	10,00 €
<p>Sailing Instructor (Payable now)</p> <p>Season: 2026 New. Sailing Instructor: price per week - food (Skippering with the basic school of sailing and manoevring)</p>	No	per week + food	1.960,00 €
<p>Skipper (Payable now)</p> <p>Season: 2026 New. +provisioning ; Crew on board must have their own toilets/ showers. If either a skipper or a hostess/cook is on board, 1 double cabin will be required for him/her. If both a skipper and a hostess/cook are on board, 1 double cabin and 1 forepeak cabin will be required for them. Exceptions exists for specific layouts, Sales Agents will provide more details about the different boat models. ***NOTE: Skipper details will be available 3 days before the charter.</p>	No	per week + food	1.400,00 €

Skipper (Payable now)	No	per week + food	1.400,00 €
Season: 2026 New. +provisioning ; Crew on board must have their own toilets/ showers. If either a skipper or a hostess/cook is on board, 1 double cabin will be required for him/her. If both a skipper and a hostess/cook are on board, 1 double cabin and 1 forepeak cabin will be required for them. Exceptions exists for specific layouts, Sales Agents will provide more details about the different boat models. ***NOTE: Skipper details will be available 3 days before the charter.			
Skipper (Payable now)	No	per week + food	1.540,00 €
Season: 2026 New. +provisioning ; Crew on board must have their own toilets/ showers. If either a skipper or a hostess/cook is on board, 1 double cabin will be required for him/her. If both a skipper and a hostess/cook are on board, 1 double cabin and 1 forepeak cabin will be required for them. Exceptions exists for specific layouts, Sales Agents will provide more details about the different boat models. ***NOTE: Skipper details will be available 3 days before the charter.			
Transfer (Payable now)	No	one-way	65,00 €
Season: 2026 New. OW - Split Airport - Marina Baotic / Up to 3 persons			
Transfer (Payable now)	No	one-way	75,00 €
Season: 2026 New. OW - Split, town - Marina Baotic Up to 3 persons			
Transfer (Payable now)	No	one-way	75,00 €
Season: 2026 New. OW - Split Airport - Marina Baotic Up to 8 persons			
Transfer (Payable now)	No	one-way	80,00 €
Season: 2026 New. OW - Split, town - Marina Baotic Up to 8 persons			
Transfer (Payable now)	No	one-way	330,00 €
Season: 2026 New. OW - Zadar, town - Marina Baotic Up to 3 persons			
Transfer (Payable now)	No	one-way	350,00 €
Season: 2026 New. OW - Zadar, town - Marina Baotic Up to 8 persons			
Transfer (Payable now)	No	one-way	495,00 €
Season: 2026 New. OW - Dubrovnik, town - Marina Baotic Up to 3 persons			
Transfer (Payable now)	No	one-way	550,00 €
Season: 2026 New. OW - Dubrovnik, town - Marina Baotic Up to 8 persons			
VIP Pack (Payable now)	No	per booking	250,00 €
Season: 2026 New. VIP PACK Sailing yachts (fast track service on arrival and access to the yacht at 13.00 pm + a luxurious drink welcome pack)			

WI-FI Internet connection on boat (Payable now)

No

per week

32,00 €

Season: 2026 New.



WEBSITE

www.plujeme.cz



E-MAIL

info@plujeme.cz



PHONE

+420 720 755 085



MOBILE

+420 777 170 276



PLUJEME RÁDI S.R.O.

Dlouhá 730/35, 11000 Praha 1 – Staré Město, Czech Republic

ADDITIONAL EXTRAS

EXTRA	OBLIGATORY	PAYMENT TYPE	PRICE
Donut (Payable now) Season: 2026 New. includes 1 donut - Payable now	No	per week	65,00 €
Extra bedlinen and towels (Payable now) Season: 2026 New. Payable now	No	per person	15,00 €
Inflatable lifejacket (Payable now) Season: 2026 New. Inflatable life vests and Jackstay - Payable now	No	per booking	65,00 €
Kayak (Payable now) Season: 2026 New. Payable now	No	per booking	285,00 €
Railing net (Safety net) (Payable now) Season: 2026 New. Railing net - mounting not included. Clients must mount the railing net (safety net) by themselves - Payable now	No	per booking	110,00 €
Stand up paddle (SUP) (Payable now) Season: 2026 New. Price per day - Payable now	No	per night	15,00 €

**WEBSITE**www.plujeme.cz**E-MAIL**info@plujeme.cz**PHONE**

+420 720 755 085

**MOBILE**

+420 777 170 276

**PLUJEME RÁDI S.R.O.**

Dlouhá 730/35, 11000 Praha 1 – Staré Město, Czech Republic

PRICE AND AVAILABILITY

25.04. - 02.05.2026 1.460 €	02.05. - 09.05.2026 1.200 € 1.460 €	09.05. - 16.05.2026 1.200 € 1.640 €	16.05. - 23.05.2026 NOT AVAILABLE
23.05. - 30.05.2026 NOT AVAILABLE	30.05. - 06.06.2026 NOT AVAILABLE	06.06. - 20.06.2026 NOT AVAILABLE	20.06. - 27.06.2026 NOT AVAILABLE
27.06. - 04.07.2026 NOT AVAILABLE	04.07. - 11.07.2026 NOT AVAILABLE	11.07. - 18.07.2026 NOT AVAILABLE	18.07. - 25.07.2026 NOT AVAILABLE
25.07. - 01.08.2026 NOT AVAILABLE	01.08. - 08.08.2026 NOT AVAILABLE	08.08. - 15.08.2026 NOT AVAILABLE	15.08. - 22.08.2026 NOT AVAILABLE
22.08. - 29.08.2026 NOT AVAILABLE	29.08. - 05.09.2026 NOT AVAILABLE	05.09. - 12.09.2026 NOT AVAILABLE	12.09. - 19.09.2026 NOT AVAILABLE
19.09. - 26.09.2026 NOT AVAILABLE	26.09. - 03.10.2026 NOT AVAILABLE	03.10. - 10.10.2026 NOT AVAILABLE	10.10. - 17.10.2026 1.790 €
17.10. - 24.10.2026 1.700 €	24.10. - 31.10.2026 1.454 € 1.615 €	31.10. - 07.11.2026 1.454 € 1.615 €	07.11. - 14.11.2026 1.454 € 1.615 €
20.11. - 12.03.2027 NOT AVAILABLE			



WEBSITE

www.plujeme.cz



E-MAIL

info@plujeme.cz



PHONE

+420 720 755 085



MOBILE

+420 777 170 276



PLUJEME RÁDI S.R.O.

Dlouhá 730/35, 11000 Praha 1 – Staré Město, Czech Republic

PRICE AND AVAILABILITY

13.03. - 20.03.2027 1.323 € 1.470 €	20.03. - 27.03.2027 1.323 € 1.470 €	27.03. - 03.04.2027 1.440 € 1.600 €	03.04. - 10.04.2027 1.521 € 1.690 €
10.04. - 17.04.2027 1.697 € 1.885 €	17.04. - 24.04.2027 1.697 € 1.885 €	24.04. - 01.05.2027 1.904 € 2.115 €	01.05. - 08.05.2027 1.904 € 2.115 €
08.05. - 15.05.2027 2.025 € 2.250 €	15.05. - 22.05.2027 2.273 € 2.525 €	22.05. - 29.05.2027 2.696 € 2.995 €	29.05. - 05.06.2027 3.024 € 3.360 €
05.06. - 12.06.2027 3.285 € 3.650 €	12.06. - 19.06.2027 3.668 € 4.075 €	19.06. - 26.06.2027 3.969 € 4.410 €	26.06. - 03.07.2027 4.392 € 4.880 €
03.07. - 10.07.2027 4.613 € 5.125 €	10.07. - 17.07.2027 4.613 € 5.125 €	17.07. - 24.07.2027 4.662 € 5.180 €	24.07. - 31.07.2027 4.712 € 5.235 €
31.07. - 07.08.2027 4.865 € 5.405 €			



WEBSITE
www.plujeme.cz



E-MAIL
info@plujeme.cz



PHONE
+420 720 755 085



PLUJEME RÁDI S.R.O.
Dlouhá 730/35, 11000 Praha 1 – Staré Město, Czech Republic



MOBILE
+420 777 170 276

PRICE AND AVAILABILITY

07.08. - 14.08.2027 4.883 € 5.425 €	14.08. - 21.08.2027 4.748 € 5.275 €	21.08. - 28.08.2027 4.239 € 4.710 €	28.08. - 04.09.2027 4.199 € 4.665 €
04.09. - 11.09.2027 4.325 € 4.805 €	11.09. - 18.09.2027 4.109 € 4.565 €	18.09. - 25.09.2027 3.938 € 4.375 €	25.09. - 02.10.2027 2.988 € 3.320 €
02.10. - 09.10.2027 2.241 € 2.490 €	09.10. - 16.10.2027 1.692 € 1.880 €	16.10. - 23.10.2027 1.607 € 1.785 €	23.10. - 30.10.2027 1.530 € 1.700 €
30.10. - 06.11.2027 1.454 € 1.615 €	06.11. - 13.11.2027 1.454 € 1.615 €	13.11. - 20.11.2027 1.454 € 1.615 €	20.11. - 27.11.2027 1.454 € 1.615 €
01.12. - 31.12.2098 NOT AVAILABLE			



WEBSITE

www.plujeme.cz



E-MAIL

info@plujeme.cz



PHONE

+420 720 755 085



MOBILE

+420 777 170 276



PLUJEME RÁDI S.R.O.

Dlouhá 730/35, 11000 Praha 1 – Staré Město, Czech Republic