

ELAN 394 IMPRESSION

Thalia (2011)

Sailing yacht **Elan 394 Impression Thalia**, built in **2011** is anchored in the **Corfu, Gouvia Marina, Ionian Islands, Greece**. It has **3 cabins**, can accommodate **6 + 2 people** and has **2 toilets**. Bed linen and kitchen equipment are included in the price.

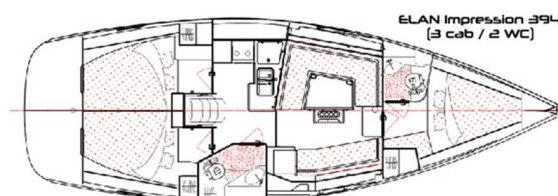

YACHT SPECIFICATIONS

Yacht Base

Corfu, Gouvia Marina, Greece

Yacht ID

230

Brands

Elan Marine

Yacht name

Thalia

Production year

2011

Length

39 ft

Cabins

3

Berths

6 + 2

Max Persons

8

WC

2

Engine

1 x 39 HP

Fuel tank

165 l



WEBSITE

www.plujeme.cz



PHONE

+420 720 755 085



MOBILE

+420 777 170 276



E-MAIL

info@plujeme.cz



PLUJEME RÁDI S.R.O.

Dlouhá 730/35, 11000 Praha 1 – Staré Město, Czech Republic

STANDARD YACHT EQUIPMENT

Deck	Bimini top, Cockpit/stern, outside shower, Dinghy with outboard engine, Folding cockpit table, Hydraulic lifting swimming platform, Sprayhood
Entertainment	CD/MP3/USB player, Outdoor speakers
Galley	Hot water, Refrigerator
Interior	Lowerable salon table
Navigation	Autopilot, GPS chart plotter, Wind instrument/Anemometer
Safety	Black Water Tank
Yacht electrics	12V Socket, 220V socket, Batteries, Shore connection 220 V, Shore power cable, Solar panels



WEBSITE

www.plujeme.cz



E-MAIL

info@plujeme.cz



PHONE

+420 720 755 085



MOBILE

+420 777 170 276



PLUJEME RÁDI S.R.O.

Dlouhá 730/35, 11000 Praha 1 – Staré Město, Czech Republic

SERVICES

SELECTED SERVICES	OBLIGATORY	PAYMENT TYPE	PRICE
Service Pack (Payable at the base) Season: 2026. final cleaning of the boat, cleaning for bed linen and towels, 2 gas bottles, 5lt of petrol for the outboard engine, full tank of water, snorkeling gear	Yes	per booking	160,00 €
Crew change (Payable at the base) Season: 2026. skipper does not change Price includes: Port authorities formalities, linen/towels Crew change during the charter is allowed up to 50% of the initial crew number. In case of a crew change of more than 50%, then it is considered as a new charter.	No	per crew change	250,00 €
Damage waiver (Payable at the base) Season: 2026. + refundable deposit 500 €	No	per week	250,00 €
Damage waiver / skippered charter (Payable at the base) Season: 2026. Mandatory in case of a skippered charter. + refundable deposit 700 €. Not available for regattas & races.	No	per week	350,00 €
Early boarding/check-in (Payable at the base) Season: 2026. at 14:00 pm, upon request & subject to no damages from the previous client	No	per booking	150,00 €
Hostess (Payable at the base) Season: 2026. + own cabin	No	per day + food	180,00 €
One way fee (Payable at the base) Season: 2026. Athens - Lavrion	No	one-way	400,00 €
One way fee (Payable at the base) Season: 2026. In between Dodecanese or Ionian or Cyclades	No	one-way	500,00 €
One way fee (Payable at the base) Season: 2026. Athens - Cyclades	No	one-way	700,00 €
One way fee (Payable at the base) Season: 2026. Athens - Dodecanese	No	one-way	1.000,00 €
One way fee (Payable at the base) Season: 2026. Athens - Ionian	No	one-way	1.100,00 €

Pet on board (Payable at the base) Season: 2026. up to 6kg	No	per booking	200,00 €
Skipper (Payable at the base) Season: 2026. + own cabin. For all skippered charters, damage waiver is mandatory 350 € plus a refundable deposit 700 €.	No	per day + food	200,00 €
Sunday Check-in (Payable at the base) Season: 2026.	No	per booking	150,00 €
WI-FI Internet connection on boat (Payable at the base) Season: 2026. up to 10 GB	No	per booking	80,00 €



WEBSITE
www.plujeme.cz



E-MAIL
info@plujeme.cz



PHONE
+420 720 755 085



MOBILE
+420 777 170 276



PLUJEME RÁDI S.R.O.
Dlouhá 730/35, 11000 Praha 1 – Staré Město, Czech Republic

ADDITIONAL EXTRAS

EXTRA	OBLIGATORY	PAYMENT TYPE	PRICE
Blister (Payable at the base) Season: 2026. + 500€ refundable deposit - Payable at the base	No	per week	200,00 €
Extra bedlinen (Payable at the base) Season: 2026. 2 sheets, 2 towels, 1 pillow case - Payable at the base	No	per person	10,00 €
Gennaker (Payable at the base) Season: 2026. + 500 EUR refundable deposit - Payable at the base	No	per week	200,00 €
Railing net (Safety net) (Payable at the base) Season: 2026. Payable at the base	No	per booking	150,00 €
Stand up paddle (SUP) (Payable at the base) Season: 2026. Payable at the base	No	per week	150,00 €



WEBSITE

www.plujeme.cz



E-MAIL

info@plujeme.cz



PHONE

+420 720 755 085



MOBILE

+420 777 170 276



PLUJEME RÁDI S.R.O.

Dlouhá 730/35, 11000 Praha 1 – Staré Město, Czech Republic

PRICE AND AVAILABILITY

25.04. - 02.05.2026 1.710 € 1.900 €	02.05. - 09.05.2026 1.710 € 1.900 €	09.05. - 16.05.2026 1.710 € 1.900 €	16.05. - 23.05.2026 1.710 € 1.900 €
23.05. - 30.05.2026 2.340 € 2.600 €	30.05. - 06.06.2026 2.340 € 2.600 €	06.06. - 13.06.2026 2.340 € 2.600 €	13.06. - 20.06.2026 2.340 € 2.600 €
20.06. - 27.06.2026 2.700 € 3.000 €	27.06. - 04.07.2026 2.700 € 3.000 €	04.07. - 11.07.2026 2.700 € 3.000 €	11.07. - 18.07.2026 2.700 € 3.000 €
18.07. - 25.07.2026 2.700 € 3.000 €	25.07. - 01.08.2026 2.700 € 3.000 €	01.08. - 08.08.2026 3.150 € 3.500 €	08.08. - 15.08.2026 3.150 € 3.500 €
15.08. - 22.08.2026 3.150 € 3.500 €	22.08. - 29.08.2026 2.700 € 3.000 €	29.08. - 05.09.2026 2.700 € 3.000 €	05.09. - 12.09.2026 2.700 € 3.000 €
12.09. - 19.09.2026 2.340 € 2.600 €	19.09. - 26.09.2026 2.340 € 2.600 €	26.09. - 03.10.2026 1.710 € 1.900 €	03.10. - 10.10.2026 1.710 € 1.900 €
10.10. - 17.10.2026 1.710 € 1.900 €	17.10. - 24.10.2026 1.395 € 1.550 €	24.10. - 31.10.2026 1.395 € 1.550 €	31.10. - 07.11.2026 1.395 € 1.550 €
07.11. - 14.11.2026 1.395 € 1.550 €	14.11. - 21.11.2026 1.395 € 1.550 €	21.11. - 28.11.2026 1.395 € 1.550 €	28.11. - 05.12.2026 1.395 € 1.550 €



WEBSITE

www.plujeme.cz



E-MAIL

info@plujeme.cz



PHONE

+420 720 755 085



MOBILE

+420 777 170 276



PLUJEME RÁDI S.R.O.

Dlouhá 730/35, 11000 Praha 1 – Staré Město, Czech Republic

PRICE AND AVAILABILITY

05.12. - 12.12.2026

1.395 € 1.550 €

12.12. - 19.12.2026

1.395 € 1.550 €

19.12. - 26.12.2026

1.395 € 1.550 €



WEBSITE

www.plujeme.cz



E-MAIL

info@plujeme.cz



PHONE

+420 720 755 085



MOBILE

+420 777 170 276



PLUJEME RÁDI S.R.O.

Dlouhá 730/35, 11000 Praha 1 – Staré Město, Czech Republic