

BAVARIA CRUISER 46

Dea (2014)

Sailing yacht **Bavaria Cruiser 46 Dea**, built in **2014** is anchored in the **Marina Losinj, Mali Losinj, Kvarner, Croatia**. It has **4 cabins**, can accommodate **8 + 1 people** and has **3 toilets**. Bed linen and kitchen equipment are included in the price.

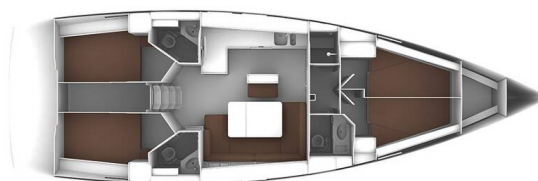

YACHT SPECIFICATIONS

Yacht Base

Marina Losinj, Mali Losinj, Croatia

Yacht ID

206

Brands

Bavaria

Yacht name

Dea

Production year

2014

Length

47 ft

Cabins

4

Berths

8 + 1

WC

3

Engine

1 x 55 HP

Fuel tank

210 l



WEBSITE

www.plujeme.cz



PHONE

+420 720 755 085



MOBILE

+420 777 170 276



E-MAIL

info@plujeme.cz



PLUJEME RÁDI S.R.O.

Dlouhá 730/35, 11000 Praha 1 – Staré Město, Czech Republic

STANDARD YACHT EQUIPMENT

Comfort	Bed linen, Cockpit cushions, Mattresses, Salon cushions
Deck	Bathing platform, Bimini top, Bosun's chair (Safe seat) (boatswain's chair), Cockpit/stern, outside shower, Dinghy, Electric anchor windlass, Fenders, Main anchor, Main Deck Compass, Spare anchor (Reserve, Auxiliary anchor), Sprayhood
Entertainment	Indoor speakers, Radio CD player
Galley	Gas bottles, Gas cookers, Hot water, Oven, Refrigerator, Sink
Interior	Inside shower
Navigation	Autopilot, Bow thruster, GPS chart plotter, GPS chart plotter - cockpit, Hand bearing compass, Log, Speed, Depth- echo sounder, Navigation (Nautical) charts and nautical guide, Navigation set, Radar reflector
Safety	Black Water Tank, Distress flare box, Emergency tiller, Extra water tank, Fire extinguisher, First aid kit, Horseshoe lifebuoy, Life belts (Safety harness), Life jackets, Liferaft, Set of tools, VHF radio
Yacht electrics	Batteries, Service batteries, Shore connection 220 V, Shore power cable



WEBSITE

www.plujeme.cz



E-MAIL

info@plujeme.cz



PHONE

+420 720 755 085



MOBILE

+420 777 170 276



PLUJEME RÁDI S.R.O.

Dlouhá 730/35, 11000 Praha 1 – Staré Město, Czech Republic

SERVICES

SELECTED SERVICES	OBLIGATORY	PAYMENT TYPE	PRICE
Transit log (Payable at the base) Season: 2026. Includes: final cleaning, divers inspection on Friday 6 PM, bed linen for each crew member, made-up beds, Wi-Fi router up to 80GB/week, dinghy, cooking gas.	Yes	per booking	290,00 €
Comfort pack (Payable at the base) Season: 2026. outboard engine 2,5 HP, towels (set/2pcs)/person	No	per week	150,00 €
Comfort pack PLUS (Payable at the base) Season: 2026. outboard engine 2,5 HP, towels (set/2pcs)/person, early check-in at 14:00 h	No	per week	290,00 €
Deposit insurance (Payable at the base) Season: 2026. Non-refundable + 312,50 EUR refundable The deposit insurance policy does not include damage to the sails, damages to or loss of inflatable boat and outboard engine. The security deposit as well as the deposit paid in case of its insurance covers only one damage.	No	per booking	312,50 €
Early boarding/check-in (Payable at the base) Season: 2026. at 02:00 PM	No	per booking	200,00 €
Hostess (Payable at the base) Season: 2026.	No	per day + food	180,00 €
Late check out (Payable at the base) Season: 2026.	No	per booking	250,00 €
One way (Payable at the base) Season: 2026. On request	No	one-way	0,00 €
One way (Payable at the base) Season: 2026. M.Lošinj-Primošten / Primošten-M.Lošinj	No	per booking	850,00 €
One way (Payable at the base) Season: 2026. Pula-Primošten / Primošten-Pula	No	one-way	950,00 €
Pet on board (Payable at the base) Season: 2026.	No	per booking	200,00 €

Refuel service (Payable at the base)

No

per service

100,00 €

Season: 2026.

Skipper (Payable at the base)

No

per day + food

200,00 €

Season: 2026.



WEBSITE

www.plujeme.cz



PHONE

+420 720 755 085



MOBILE

+420 777 170 276



E-MAIL

info@plujeme.cz



PLUJEME RÁDI S.R.O.

Dlouhá 730/35, 11000 Praha 1 – Staré Město, Czech Republic

ADDITIONAL EXTRAS

EXTRA	OBLIGATORY	PAYMENT TYPE	PRICE
e-SUP (Payable at the base) Season: 2026. on request - Payable at the base	No	per week	270,00 €
Extra bedlinen (Payable at the base) Season: 2026. Payable at the base	No	per set	10,00 €
Railing net (Safety net) (Payable at the base) Season: 2026. without assembly - Payable at the base	No	per week	30,00 €
Self inflating life vest (Payable at the base) Season: 2026. Payable at the base	No	per week	35,00 €

**WEBSITE**www.plujeme.cz**E-MAIL**info@plujeme.cz**PHONE**

+420 720 755 085

**MOBILE**

+420 777 170 276

**PLUJEME RÁDI S.R.O.**

Dlouhá 730/35, 11000 Praha 1 – Staré Město, Czech Republic

PRICE AND AVAILABILITY

16.05. - 23.05.2026 1.590 € 2.650 €	23.05. - 30.05.2026 1.800 € 3.000 €	30.05. - 06.06.2026 1.885 € 2.900 €	11.06. - 15.06.2026 NOT AVAILABLE
20.06. - 27.06.2026 2.310 € 3.300 €	27.06. - 04.07.2026 2.363 € 3.150 €	04.07. - 11.07.2026 NOT AVAILABLE	11.07. - 18.07.2026 2.933 € 3.450 €
18.07. - 25.07.2026 3.060 € 3.400 €	25.07. - 01.08.2026 NOT AVAILABLE	01.08. - 08.08.2026 2.450 € 3.500 €	08.08. - 15.08.2026 2.415 € 3.450 €
15.08. - 22.08.2026 NOT AVAILABLE	22.08. - 29.08.2026 2.275 € 3.250 €	29.08. - 05.09.2026 2.310 € 3.300 €	05.09. - 12.09.2026 2.475 € 3.300 €
12.09. - 19.09.2026 2.345 € 3.350 €	19.09. - 26.09.2026 1.918 € 2.950 €	26.09. - 02.10.2026 ON OPTION	03.10. - 31.12.2026 NOT AVAILABLE



WEBSITE

www.plujeme.cz



E-MAIL

info@plujeme.cz



PHONE

+420 720 755 085



MOBILE

+420 777 170 276



PLUJEME RÁDI S.R.O.

Dlouhá 730/35, 11000 Praha 1 – Staré Město, Czech Republic