

OCEANIS 51.1

Grey Goose (2019)

Sailing yacht Oceanis 51.1 Grey Goose, built in 2019 is anchored in the **Sukosan, D-Marin Dalmacija Marina, Zadar region, Croatia**. It has **4 + 1 cabins**, can accommodate **8 + 2 + 1 people** and has **4 toilets**. Bed linen and kitchen equipment are included in the price.

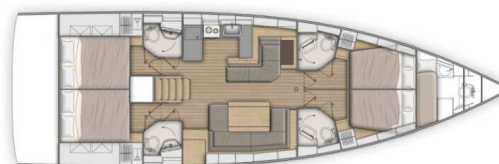

YACHT SPECIFICATIONS

Yacht Base

**Sukosan, D-Marin Dalmacija Marina,
Croatia**

Yacht ID

1722

Brands

Beneteau

Yacht name

Grey Goose

Production year

2019

Length

52 ft

Cabins

4 + 1

Berths

8 + 2 + 1

WC

4

Engine

1 x 110 HP

Fuel tank

400 l



WEBSITE

www.plujeme.cz



PHONE

+420 720 755 085



MOBILE

+420 777 170 276



E-MAIL

info@plujeme.cz



PLUJEME RÁDI S.R.O.

Dlouhá 730/35, 11000 Praha 1 – Staré Město, Czech Republic

STANDARD YACHT EQUIPMENT

Comfort	Mosquito nets
Deck	Bimini top, Cockpit table, Dinghy, Electric anchor windlass, Sprayhood, Teak cockpit
Entertainment	Outdoor speakers, TV
Galley	Ice maker, Microwave, Refrigerator
Interior	Electric fans in cabins, Electric toilet, LED lights
Navigation	AIS, Autopilot, Bow thruster, Echosounder/Depthsounder, GPS chart plotter - cockpit, Helm station, Log/speed instrument, Nautical charts, Wind instrument/Anemometer, Windex
Safety	VHF radio
Yacht electrics	Air Conditioning, Generator, Inverter, Service batteries



WEBSITE

www.plujeme.cz



E-MAIL

info@plujeme.cz



PHONE

+420 720 755 085



MOBILE

+420 777 170 276



PLUJEME RÁDI S.R.O.

Dlouhá 730/35, 11000 Praha 1 – Staré Město, Czech Republic

SERVICES

SELECTED SERVICES	OBLIGATORY	PAYMENT TYPE	PRICE
Transit log (Payable at the base) Season: 2026. final cleaning/bed linen/towels/WiFi/outboard	Yes	per booking	400,00 €
Alternative deposit (Payable at the base) Season: 2026. + fix deposit 500 EUR	No	per booking	250,00 €
Extra cleaning (Payable at the base) Season: 2026.	No	per week	300,00 €
Hostess (Payable at the base) Season: 2026. Availability only on request! Meals excluded. A separate cabin and toilet must be provided for accommodation unless located in the front peak)	No	per day + food	1.540,00 €
Pet on board (Payable at the base) Season: 2026.	No	per week	100,00 €
Skipper (Payable at the base) Season: 2026. Availability only on request! Meals excluded. A separate cabin and toilet must be provided for accommodation unless located in the front peak	No	per week	1.750,00 €

**WEBSITE**www.plujeme.cz**E-MAIL**info@plujeme.cz**PHONE**

+420 720 755 085

**MOBILE**

+420 777 170 276

**PLUJEME RÁDI S.R.O.**

Dlouhá 730/35, 11000 Praha 1 – Staré Město, Czech Republic

ADDITIONAL EXTRAS

EXTRA	OBLIGATORY	PAYMENT TYPE	PRICE
Beach towel (Payable at the base) Season: 2026. Payable at the base	No	per piece	10,00 €
NESPRESSO coffee machine (Payable at the base) Season: 2026. Payable at the base	No	per week	50,00 €
Railing net (Safety net) (Payable at the base) Season: 2026. no installation - Payable at the base	No	per booking	50,00 €
Railing net (Safety net) (Payable at the base) Season: 2026. with installation, not compatible with priority boarding - Payable at the base	No	per booking	150,00 €
Snorkeling equipment (Payable at the base) Season: 2026. no fins - Payable at the base	No	per week/ person	10,00 €
Stand up paddle (SUP) (Payable at the base) Season: 2026. Payable at the base	No	per week	150,00 €



WEBSITE
www.plujeme.cz



E-MAIL
info@plujeme.cz



PHONE
+420 720 755 085



MOBILE
+420 777 170 276



PLUJEME RÁDI S.R.O.
Dlouhá 730/35, 11000 Praha 1 – Staré Město, Czech Republic

PRICE AND AVAILABILITY

25.04. - 02.05.2026 2.275 € 3.500 €	02.05. - 09.05.2026 2.275 € 3.500 €	09.05. - 16.05.2026 2.275 € 3.500 €	16.05. - 23.05.2026 2.600 € 4.000 €
23.05. - 30.05.2026 3.120 € 4.800 €	30.05. - 06.06.2026 4.400 € 5.500 €	06.06. - 13.06.2026 3.990 € 5.700 €	13.06. - 20.06.2026 3.900 € 6.000 €
20.06. - 27.06.2026 4.095 € 6.300 €	27.06. - 04.07.2026 NOT AVAILABLE	04.07. - 11.07.2026 5.040 € 7.200 €	11.07. - 18.07.2026 4.875 € 7.500 €
18.07. - 25.07.2026 5.005 € 7.700 €	25.07. - 01.08.2026 5.390 € 7.700 €	01.08. - 08.08.2026 5.250 € 7.500 €	08.08. - 15.08.2026 5.040 € 7.200 €
15.08. - 22.08.2026 NOT AVAILABLE	22.08. - 29.08.2026 4.950 € 6.600 €	29.08. - 05.09.2026 3.965 € 6.100 €	05.09. - 12.09.2026 4.350 € 5.800 €
12.09. - 19.09.2026 4.250 € 5.000 €	19.09. - 26.09.2026 3.680 € 4.600 €	26.09. - 03.10.2026 3.400 € 4.000 €	03.10. - 10.10.2026 2.880 € 3.600 €
10.10. - 17.10.2026 2.720 € 3.400 €	17.10. - 24.10.2026 NOT AVAILABLE	24.10. - 31.10.2026 2.640 € 3.300 €	31.10. - 07.11.2026 2.640 € 3.300 €
07.11. - 31.12.2026 NOT AVAILABLE			



WEBSITE
www.plujeme.cz



E-MAIL
info@plujeme.cz



PHONE
+420 720 755 085



MOBILE
+420 777 170 276



PLUJEME RÁDI S.R.O.
Dlouhá 730/35, 11000 Praha 1 – Staré Město, Czech Republic