

HANSE 508

Hamam (2019)

Sailing yacht Hanse 508 Hamam, built in 2019 is anchored in the **Göcek/D-Marin, Aegean, Turkey**. It has **5 + 1 cabins**, can accommodate **10 + 1 people** and has **3 + 1 toilets**. Bed linen and kitchen equipment are included in the price.

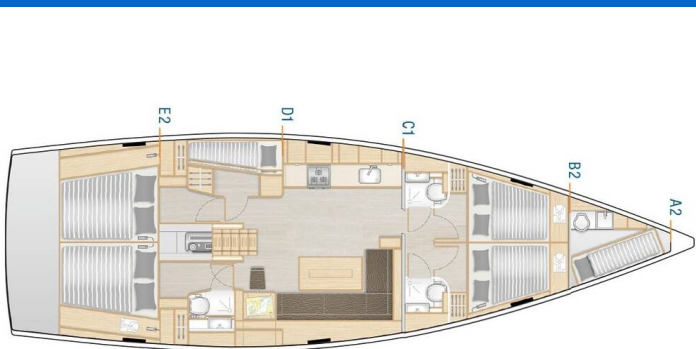

YACHT SPECIFICATIONS

Yacht Base

Göcek/D-Marin, Turkey

Yacht ID

1662

Brands

Hanse Yachts

Yacht name

Hamam

Production year

2019

Length

51 ft

Cabins

5 + 1

Berths

10 + 1

Max Persons

11

WC

3 + 1

Engine

1 x 80 HP

Fuel tank

280 l



WEBSITE

www.plujeme.cz



PHONE

+420 720 755 085



MOBILE

+420 777 170 276



E-MAIL

info@plujeme.cz



PLUJEME RÁDI S.R.O.

Dlouhá 730/35, 11000 Praha 1 – Staré Město, Czech Republic

STANDARD YACHT EQUIPMENT

Deck	Bathing platform, Bimini top, Cockpit table, Cockpit/stern, outside shower, Dinghy, Electric anchor windlass, Sprayhood, Teak cockpit
Entertainment	Outdoor speakers, Radio CD player, TV
Galley	Gas cookers, Hot water, Kitchen utensils (Galley equipment, cutlery), Oven, Refrigerator
Navigation	Autopilot, Bow thruster, GPS chart plotter - cockpit, Nautical charts, Pilot book, Tridata
Safety	Set of tools, VHF radio
Sails	Electric primary winch
Yacht electrics	Battery charger, Heating, Inverter



WEBSITE

www.plujeme.cz



E-MAIL

info@plujeme.cz



PHONE

+420 720 755 085



MOBILE

+420 777 170 276



PLUJEME RÁDI S.R.O.

Dlouhá 730/35, 11000 Praha 1 – Staré Město, Czech Republic

SERVICES

SELECTED SERVICES	OBLIGATORY	PAYMENT TYPE	PRICE
Charter package (Payable at the base) Season: 2026. includes transit log, final cleaning, bedlinen, cooking gas, towels - 1 set p/p, 1 snorkeling set	Yes	per booking	420,00 €
Comfort pack (Payable at the base) Season: 2026. outboard 3,5 HP, WiFi router, cockpit cushions	No	per week	140,00 €
Comfort pack PREMIUM (Payable at the base) Season: 2026. includes outboard 3,5 hp, WiFi router, cockpit cushions, early check-in	No	per week	290,00 €
Comfort pack XL (Payable at the base) Season: 2026. Includes: outboard 3,5 HP, WiFi router, beach towels, toiletries	No	per week	200,00 €
Comfort pack XL PREMIUM (Payable at the base) Season: 2026. Includes: outboard 3,5 HP, WiFi router, beach towels, toiletries, early check-in	No	per week	340,00 €
Early Check in (Payable at the base) Season: 2026. at 13:00hr ** Early check in can be confirmed only on embarkation day in the charter base.	No	per booking	200,00 €
Flexible booking (Payable now) Season: 2026. allows you to cancel or rebook your charter up to 30 days before the embarkation for no specific reason. You can reschedule your holiday at no cost for unlimited number of times or use a credit note if you are uncertain of new charter dates. With our FLEX PLAN your rebooking costs are completely eliminated while cancellation costs with refund option are reduced to a minimum (15% of the charter fee, min 350 EUR). Extra bonus: free cancellation and FULL REFUND granted in case of closed state borders within 7 days before the embarkation. Notes: FLEX PLAN costs 10% of the final charter price, can be added to booking up to 72hr after booking confirmation and is not available for bookings confirmed within 30 days before the embarkation.	No	per booking	0,00 €
Hostess (Payable at the base) Season: 2026. +food	No	per day	130,00 €

Late check out (Payable at the base) Season: 2026. Saturdays till 10am	No	per booking	350,00 €
One way (Payable at the base) Season: 2026. One way Fethiye – Marmaris, check-out on Friday until 12:00hr, (berth charge in the port of disembarkation is not included in the fee and should be paid separately) Return at the base should be at least 1hour before disembarkation time	No	one-way	400,00 €
One way (Payable at the base) Season: 2026. One way Fethiye – Kas , check-out on Friday until 12:00hr, (berth charge in the port of disembarkation is not included in the fee and should be paid separately) Return at the base should be at least 1hour before disembarkation time	No	one-way	400,00 €
One way (Payable at the base) Season: 2026. One way Fethiye – Bodrum, check-out on Friday until 09:00hr, (berth charge in the port of disembarkation is not included in the fee and should be paid separately) Return at the base should be at least 1hour before disembarkation time	No	one-way	615,00 €
Pet on board (Payable at the base) Season: 2026. on request	No	per booking	60,00 €
Regatta charge (Payable at the base) Season: 2026.	No	per booking	400,00 €
Skipper (Payable at the base) Season: 2026.	No	per day + food	170,00 €
Transit log (Payable at the base) Season: 2026. Obligatory charge for crew changes	No	per booking	50,00 €
WI-FI Internet connection on boat (Payable at the base) Season: 2026. unlimited	No	per week	70,00 €



WEBSITE
www.plujeme.cz



PHONE
+420 720 755 085



MOBILE
+420 777 170 276



E-MAIL
info@plujeme.cz



PLUJEME RÁDI S.R.O.
Dlouhá 730/35, 11000 Praha 1 – Staré Město, Czech Republic

ADDITIONAL EXTRAS

EXTRA	OBLIGATORY	PAYMENT TYPE	PRICE
Beach towel (Payable at the base) Season: 2026. Payable at the base	No	per piece	8,00 €
Bed linen (Payable at the base) Season: 2026. Payable at the base	No	per set	10,00 €
Cockpit cushions (Payable at the base) Season: 2026. Payable at the base	No	per week	30,00 €
Gennaker (Payable at the base) Season: 2026. + 750 EUR deposit raise - Payable at the base	No	per week	300,00 €
Outboard engine (Payable at the base) Season: 2026. 3,5 HP - Payable at the base	No	per week	90,00 €
Railing net (Safety net) (Payable at the base) Season: 2026. mounting/dismounting - Payable at the base	No	per booking	70,00 €
Stand up paddle (SUP) (Payable at the base) Season: 2026. Payable at the base	No	per week	120,00 €
Sundeck cushions (Payable at the base) Season: 2026. Payable at the base	No	per week	90,00 €
Towels (Payable at the base) Season: 2026. 2 pcs - Payable at the base	No	per booking	8,00 €



WEBSITE
www.plujeme.cz



E-MAIL
info@plujeme.cz



PHONE
+420 720 755 085



PLUJEME RÁDI S.R.O.
Dlouhá 730/35, 11000 Praha 1 – Staré Město, Czech Republic



MOBILE
+420 777 170 276

PRICE AND AVAILABILITY

02.05. - 09.05.2026 NOT AVAILABLE	09.05. - 16.05.2026 3.536 € 4.420 €	16.05. - 23.05.2026 NOT AVAILABLE	23.05. - 30.05.2026 4.064 € 5.080 €
30.05. - 06.06.2026 NOT AVAILABLE	06.06. - 13.06.2026 4.736 € 5.920 €	13.06. - 27.06.2026 NOT AVAILABLE	27.06. - 04.07.2026 NOT AVAILABLE
04.07. - 11.07.2026 4.416 € 5.520 €	11.07. - 18.07.2026 4.416 € 5.520 €	18.07. - 25.07.2026 4.416 € 5.520 €	25.07. - 01.08.2026 4.416 € 5.520 €
01.08. - 08.08.2026 4.416 € 5.520 €	08.08. - 15.08.2026 4.416 € 5.520 €	15.08. - 22.08.2026 4.576 € 5.720 €	22.08. - 29.08.2026 NOT AVAILABLE
29.08. - 05.09.2026 4.976 € 6.220 €	05.09. - 12.09.2026 4.976 € 6.220 €	12.09. - 19.09.2026 NOT AVAILABLE	19.09. - 26.09.2026 ON OPTION
26.09. - 03.10.2026 NOT AVAILABLE	03.10. - 10.10.2026 NOT AVAILABLE	10.10. - 17.10.2026 4.896 € 6.120 €	17.10. - 24.10.2026 NOT AVAILABLE
24.10. - 31.10.2026 4.336 € 5.420 €	31.10. - 07.11.2026 3.856 € 4.820 €	07.11. - 14.11.2026 3.536 € 4.420 €	14.11. - 21.11.2026 3.536 € 4.420 €
21.11. - 28.11.2026 3.536 € 4.420 €	28.11. - 05.12.2026 3.536 € 4.420 €	05.12. - 12.12.2026 3.536 € 4.420 €	12.12. - 19.12.2026 3.536 € 4.420 €
19.12. - 26.12.2026 3.536 € 4.420 €			



WEBSITE
www.plujeme.cz



E-MAIL
info@plujeme.cz



PHONE
+420 720 755 085



PLUJEME RÁDI S.R.O.
Dlouhá 730/35, 11000 Praha 1 – Staré Město, Czech Republic



MOBILE
+420 777 170 276