

OCEANIS 38.1

Summer Breeze 1 (2019)

Sailing yacht Oceanis 38.1 Summer Breeze 1, built in 2019 is anchored in the **Göcek, Aegean, Turkey**. It has **2 cabins**, can accommodate **4 people** and has **1 toilets**. Bed linen and kitchen equipment are included in the price.

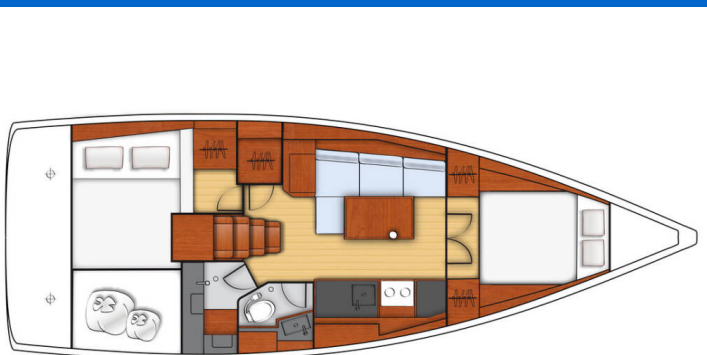

YACHT SPECIFICATIONS

Yacht Base

Göcek, Turkey

Yacht ID

1558

Brands

Beneteau

Yacht name

Summer Breeze 1

Production year

2019

Length

38 ft

Cabins

2

Berths

4

Max Persons

6

WC

1

Engine

1 x 40 HP

Fuel tank

130 l



WEBSITE

www.plujeme.cz



PHONE

+420 720 755 085



MOBILE

+420 777 170 276



E-MAIL

info@plujeme.cz



PLUJEME RÁDI S.R.O.

Dlouhá 730/35, 11000 Praha 1 – Staré Město, Czech Republic

STANDARD YACHT EQUIPMENT

Comfort	Blankets, Cockpit cushions, Pillows
Deck	Anchor with chain, Bilge pump – Mechanic, Bimini top, Boat hook, Canister for water, Cockpit light, Cockpit table, Cockpit/stern, outside shower, Deck brush, Dinghy, Dinghy (byboat) pump, Electric anchor windlass, Fenders, Fuel funnel, Gangway, Impeller, V-belt, oilfilter, Jerry cans for diesel, Jerry cans for fuel, Mooring ropes, Plastic bucket, Repair box for dinghy, Reserve motor oil, Round/globular fender, Spare anchor (Reserve, Auxiliary anchor), Sponge, Sprayhood, Spring line, Sun tent/cover, Swimming ladder, Teak cockpit, Water hose, Winch handles
Entertainment	Mobile phone, Outdoor speakers, Radio CD player, AUX input, Snorkeling equipment
Galley	Gas bottles, Gas cookers, Hot water, Kitchen utensils (Galley equipment, cutlery), Oven, Refrigerator, Sink
Interior	Barometer, Clock, Convertible table
Navigation	Autopilot, Binoculars, Bow thruster, Compass, GPS chart plotter, Hand bearing compass, Log, Nautical charts, Navigation set, Pilot book, Radar reflector, Wind/speed/depth instruments, Windex
Safety	Black Water Tank, Distress signals, Emergency tiller, Fire blanket, Fire extinguisher, First aid kit, Fog horn, Life belts (Safety harness), Life buoy + Flashing light, Life jacket (children), Life jackets, Liferaft, Oars (Paddles), Repair kit, Search light, Set of tools, Sos Dan Buoy, Torch, VHF radio, Wire (shroud) cutter
Yacht electrics	Batteries, Battery charger, Bilge pump – Electric, Heating, Inverter, Plug 220V, 12 V, Service batteries, Solar panels, Start battery



WEBSITE

www.plujeme.cz



PHONE

+420 720 755 085



MOBILE

+420 777 170 276



E-MAIL

info@plujeme.cz



PLUJEME RÁDI S.R.O.

Dlouhá 730/35, 11000 Praha 1 – Staré Město, Czech Republic

SERVICES

SELECTED SERVICES	OBLIGATORY	PAYMENT TYPE	PRICE
Standard package (Payable at the base) Season: 2026. Includes : Transitlog, final cleaning, bed linen & towels, outboard engine & fuel, Turkish mobile phone for emergency calls to the base, other E.G.G. Yachts and bay restaurants / marinas. Only local calls, with the option to receive international calls.	Yes	per booking	350,00 €
Cook (Payable at the base) Season: 2026.	No	per day + food	170,00 €
Damage waiver (Payable at the base) Season: 2026. All damages are covered (except any damage or loss of outboard & dinghy)	No	per booking	300,00 €
Deckhand/ Marinero (Payable at the base) Season: 2026.	No	per day + food	170,00 €
Early Check in (Payable at the base) Season: 2026. at 13.00 hr (limited with 3 bookings / week)	No	per booking	150,00 €
Exclusive package (Payable at the base) Season: 2026. Includes : Standard package + Damage waiver (except total loss of outboard & dingy)+ 20 GB Wi-Fi internet on board	No	per booking	600,00 €
Final cleaning (Payable at the base) Season: 2026. for boats up to 41ft	No	per booking	80,00 €
Hostess/Cook (Payable at the base) Season: 2026.	No	per day + food	170,00 €
Regatta (Payable at the base) Season: 2026. + 2x Security Deposit; Race Preparations Fees	No	per booking	150,00 €
Skipper (Payable at the base) Season: 2026.	No	per day + food	180,00 €
Transfer (Payable at the base) Season: 2026. Transfer up to 3 pax, Dalaman Airport to Göcek Base/MUCEV or reverse.	No	one-way	50,00 €

Transfer (Payable at the base)	No	one-way	70,00 €
Season: 2026. Transfer up to 6 pax with Minibus, Dalaman Airport to Göcek Base/MUCEV or reverse			
Transfer (Payable at the base)	No	one-way	90,00 €
Season: 2026. Transfer up to 14 pax with Minibus, Dalaman Airport to Göcek Base/MUCEV or reverse			
Wireless Internet Router (Payable at the base)	No	per booking	50,00 €
Season: 2026. 20 GB			
Wireless Internet Router (Payable at the base)	No	per booking	100,00 €
Season: 2026. Limitless			



WEBSITE

www.plujeme.cz



E-MAIL

info@plujeme.cz



PHONE

+420 720 755 085



MOBILE

+420 777 170 276



PLUJEME RÁDI S.R.O.

Dlouhá 730/35, 11000 Praha 1 – Staré Město, Czech Republic

ADDITIONAL EXTRAS

EXTRA	OBLIGATORY	PAYMENT TYPE	PRICE
Bed linen (Payable at the base) Season: 2026. Payable at the base	No	per set	5,00 €
Comfort seats (Payable at the base) Season: 2026. + deposit - Payable at the base	No	per week	30,00 €
Comfort seats (Payable at the base) Season: 2026. for pair / week & boat +deposit - Payable at the base	No	per week	50,00 €
Gennaker (Payable at the base) Season: 2026. security deposit 1000 EUR - Payable at the base	No	per week	400,00 €
Outboard engine (Payable at the base) Season: 2026. Payable at the base	No	per week	75,00 €
Railing net (Safety net) (Payable at the base) Season: 2026. mounting and dismounting - Payable at the base	No	per booking	150,00 €
Stand up paddle (SUP) (Payable at the base) Season: 2026. + deposit 600 EUR - Payable at the base	No	per week	150,00 €
Towels (Payable at the base) Season: 2026. Payable at the base	No	per set	5,00 €



WEBSITE

www.plujeme.cz



E-MAIL

info@plujeme.cz



PHONE

+420 720 755 085



MOBILE

+420 777 170 276



PLUJEME RÁDI S.R.O.

Dlouhá 730/35, 11000 Praha 1 – Staré Město, Czech Republic

PRICE AND AVAILABILITY

02.05. - 09.05.2026 NOT AVAILABLE	09.05. - 16.05.2026 2.175 € 2.900 €	16.05. - 23.05.2026 2.175 € 2.900 €	23.05. - 30.05.2026 ON OPTION
30.05. - 06.06.2026 2.925 € 3.250 €	06.06. - 13.06.2026 3.150 € 3.500 €	13.06. - 20.06.2026 3.150 € 3.500 €	20.06. - 27.06.2026 3.150 € 3.500 €
27.06. - 04.07.2026 2.610 € 2.900 €	04.07. - 11.07.2026 2.610 € 2.900 €	11.07. - 18.07.2026 2.610 € 2.900 €	18.07. - 08.08.2026 NOT AVAILABLE
08.08. - 15.08.2026 2.925 € 3.250 €	15.08. - 22.08.2026 2.925 € 3.250 €	22.08. - 29.08.2026 2.925 € 3.250 €	29.08. - 05.09.2026 3.150 € 3.500 €
05.09. - 12.09.2026 3.150 € 3.500 €	12.09. - 19.09.2026 3.420 € 3.800 €	19.09. - 26.09.2026 3.420 € 3.800 €	26.09. - 10.10.2026 NOT AVAILABLE
10.10. - 17.10.2026 3.420 € 3.800 €	17.10. - 24.10.2026 3.420 € 3.800 €	24.10. - 31.10.2026 2.925 € 3.250 €	31.10. - 07.11.2026 2.925 € 3.250 €
07.11. - 14.11.2026 2.070 € 2.300 €	14.11. - 21.11.2026 ON OPTION	21.11. - 28.11.2026 2.070 € 2.300 €	28.11. - 05.12.2026 2.070 € 2.300 €



WEBSITE

www.plujeme.cz



E-MAIL

info@plujeme.cz



PHONE

+420 720 755 085



MOBILE

+420 777 170 276



PLUJEME RÁDI S.R.O.

Dlouhá 730/35, 11000 Praha 1 – Staré Město, Czech Republic

PRICE AND AVAILABILITY

05.12. - 12.12.2026

2.070 € 2.300 €

12.12. - 19.12.2026

2.070 € 2.300 €

19.12. - 26.12.2026

2.070 € 2.300 €



WEBSITE

www.plujeme.cz



E-MAIL

info@plujeme.cz



PHONE

+420 720 755 085



MOBILE

+420 777 170 276



PLUJEME RÁDI S.R.O.

Dlouhá 730/35, 11000 Praha 1 – Staré Město, Czech Republic