

FOUNTAINÉ PAJOT LUCIA 40

Shanti (2019)

Catamaran Fountaine Pajot Lucia 40 Shanti, built in 2019 is anchored in the **Trogir, Yachtclub Seget (Marina Baotic), Split region, Croatia**. It has **4 cabins**, can accommodate **8 + 2 people** and has **4 toilets**. Bed linen and kitchen equipment are included in the price.

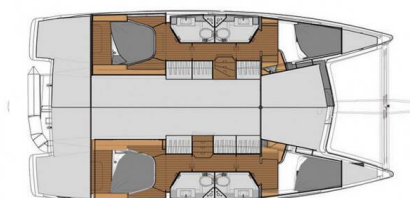

Lucia 40 4-cabin layout

YACHT SPECIFICATIONS

Yacht Base

Trogir, Yachtclub Seget (Marina Baotic), Croatia

Yacht ID

1536

Brands

Fountaine Pajot

Yacht name

Shanti

Production year

2019

Length

38 ft

Cabins

4

Berths

8 + 2

Max Persons

10

WC

4

Engine

2 x 30 HP

Fuel tank

300 l



WEBSITE

www.plujeme.cz



PHONE

+420 720 755 085



MOBILE

+420 777 170 276



E-MAIL

info@plujeme.cz



PLUJEME RÁDI S.R.O.

Dlouhá 730/35, 11000 Praha 1 – Staré Město, Czech Republic

STANDARD YACHT EQUIPMENT

| | |
|-----------------|---|
| Comfort | Outside cushions, Towels |
| Deck | Anchor Delta, Bathing platform, Bimini top, Cockpit table, Cockpit/stern, outside shower, Dinghy with outboard engine, Electric anchor windlass, Foredeck sunbathing area, Rail openings both sides, Spring cleats, Teak cockpit |
| Galley | Gas bottles, Gas cookers, Ice box, Kitchen utensils (Galley equipment, cutlery), Refrigerator |
| Interior | Electric fans in cabins |
| Navigation | Autopilot, Compass, GPS chart plotter, Navigation (Nautical) charts and nautical guide, Navigation/position Lights, Tridata, Wind instrument/Anemometer |
| Safety | VHF radio |
| Sails | Electric winch, Lazy bag, Lazy jacks, Winch |
| Yacht electrics | Batteries, Bilge pump - Electric, DSC station, Heating, Inverter, Service batteries, USB sockets, Water heater |



WEBSITE

www.plujeme.cz



E-MAIL

info@plujeme.cz



PHONE

+420 720 755 085



MOBILE

+420 777 170 276



PLUJEME RÁDI S.R.O.

Dlouhá 730/35, 11000 Praha 1 – Staré Město, Czech Republic

SERVICES

| SELECTED SERVICES | OBLIGATORY | PAYMENT TYPE | PRICE |
|---|------------|-----------------|-------------------|
| Handling fees (Payable now) Season: 2026 New. | Yes | per booking | 20,00 € |
| Preparation fee (Payable now) Season: 2026 New. LUDED: Welcome pack // final cleaning // 1 set of bed sheets / cabin & 1 set of towels / pax, dinghy, outboard engine & initial supply of fuel, gas and water tanks // 1st & last night in the marina // NOT INCLUDED: refuelling, gas & water consumption at end of charter, taxes if any, handling fees & additional equipment deposit. | Yes | per booking | 355,00 € |
| Tourist tax (Payable at the base) Season: 2026 New. | Yes | per guest/day | 1,33 € |
| Adrenalin pack (Payable now) Season: 2026 New. * upon request - + 300 EUR deposit - includes 2 donuts, 1 wake board, 1 pair of water skis, bigger rib (4,70m) with outboard engine 50 HP in Trogir and 40 HP in Dubrovnik. **Important note: The bigger rib is to be towed and can not be used in Italian water territories! Surcharge for a skipper if clients book an adrenalin pack - 200 EURO ***CANNOT BE USED ON ONE-WAY CHARTERS*** | No | per booking | 1.050,00 € |
| Cook (Payable now) Season: 2026 New. +provisioning ; Crew on board must have their own toilets/ showers. If either a skipper or a hostess/cook is on board, 1 double cabin will be required for him/her. If both a skipper and a hostess/cook are on board, 1 double cabin and 1 forepeak cabin will be required for them. Exceptions exists for specific layouts, Sales Agents will provide more details about the different boat models. Cooking breakfast, lunch, 5 dinners a week, supply, keeping the kitchen clean (not the rest of the boat, not the cabins). | No | per week + food | 1.890,00 € |
| Crew change (Payable now) Season: 2026 New. Any crew change during the charter is subject to € 250.- additional cost. The charge includes administration cost, change of bed linen and towels and one night at NY ponton (marina fee included only if the same base than start base). It doesn't include cleaning, nor new transit log where applicable. | No | per booking | 250,00 € |

| | | | |
|--|----|---------------|-----------------|
| Crew surcharge early check in (Payable now) | No | per booking | 125,00 € |
| Season: 2026 New. VIP crew surcharge 125€ per crew member. *** (ONLY APPLIED WHEN VIP PACK AND A CREW MEMBER ARE BOOKED)*** | | | |
| Damage waiver (Payable now) | No | per night | 45,00 € |
| Season: 2026 New. Damage waiver limits your liability to the reduced Security Deposit . Mandatory when skipper is added. Price is per night of the charter (minimum value of 7 nights & a maximum value of 21 nights) Not applicable for 4+ weeks charters , nor Regattas/Races. | | | |
| Extra cleaning (Payable now) | No | per booking | 285,00 € |
| Season: 2026 New. Optional Additional cleaning | | | |
| Extra set of linen (choose how many) (Payable now) | No | per booking | 15,00 € |
| Season: 2026 New. Extra set of linen : 15 € 1 set of linen (2 sheets & 2 pillow case) - to be updated manually | | | |
| Extra set of towels (choose how many) (Payable now) | No | per booking | 10,00 € |
| Season: 2026 New. Extra set of towels: 10 € 1 set of towels (1 face & 1 bath towel) - to be updated manually | | | |
| Full board 1-4 pax (number of guests to update manually) (Payable now) | No | per guest/day | 60,00 € |
| Season: 2026 New. only available if cook is booked on board as the cook will do the provisioning based on client's preference. Includes breakfast, lunch & dinner + the crew's food. Does not included alcoholic drinks | | | |
| Full board 5-12 pax (number of guests to update manually) (Payable now) | No | per guest/day | 55,00 € |
| Season: 2026 New. only available if cook is booked on board as the cook will do the provisioning based on client's preference. Includes breakfast, lunch & dinner + the crew's food. Does not included alcoholic drinks | | | |
| Gritchen cancellation insurance (Payable now) | No | per booking | 0,00 € |
| Season: 2026 New. with Covid coverage (4% of client's Total price)- European clients Only | | | |
| Half board 1-4 pax (number of guests to update manually) (Payable now) | No | per guest/day | 50,00 € |
| Season: 2026 New. only available if cook is booked on board as the cook will do the provisioning based on client's preference. Includes breakfast & lunch OR dinner + the crew's food. Does not included alcoholic drinks | | | |
| Half board 5-12 pax (number of guests to update manually) (Payable now) | No | per guest/day | 45,00 € |
| Season: 2026 New. only available if cook is booked on board as the cook will do the provisioning based on client's preference. Includes breakfast & lunch OR dinner + the crew's food. Does not included alcoholic drinks | | | |

| | | | |
|---|----|-----------------|-------------------|
| <p>Hostess (Payable now)</p> <p>Season: 2026 New. +provisioning ; Crew on board must have their own toilets/ showers. If either a skipper or a hostess/cook is on board, 1 double cabin will be required for him/her. If both a skipper and a hostess/cook are on board, 1 double cabin and 1 forepeak cabin will be required for them. Exceptions exists for specific layouts, Sales Agents will provide more details about the different boat models. Breakfast, light lunch, keeping the boat and toilet clean.</p> | No | per week + food | 1.330,00 € |
| <p>Hostess (Payable now)</p> <p>Season: 2026 New. +provisioning ; Crew on board must have their own toilets/ showers. If either a skipper or a hostess/cook is on board, 1 double cabin will be required for him/her. If both a skipper and a hostess/cook are on board, 1 double cabin and 1 forepeak cabin will be required for them. Exceptions exists for specific layouts, Sales Agents will provide more details about the different boat models. Breakfast, light lunch, keeping the boat and toilet clean.</p> | No | per week + food | 1.330,00 € |
| <p>Hostess (Payable now)</p> <p>Season: 2026 New. +provisioning ; Crew on board must have their own toilets/ showers. If either a skipper or a hostess/cook is on board, 1 double cabin will be required for him/her. If both a skipper and a hostess/cook are on board, 1 double cabin and 1 forepeak cabin will be required for them. Exceptions exists for specific layouts, Sales Agents will provide more details about the different boat models. Breakfast, light lunch, keeping the boat and toilet clean.</p> | No | per week + food | 1.465,00 € |
| <p>Parking (Payable now)</p> <p>Season: 2026 New. Navigare parking Special slots within the Baotic Marina, only for Navigare clients. Price is per week, per vehicle. UPON REQUEST, LIMITED NUMBER</p> | No | per day | 10,00 € |
| <p>Sailing Instructor (Payable now)</p> <p>Season: 2026 New. Sailing Instructor: price per week - food (Skippering with the basic school of sailing and manoevring)</p> | No | per week + food | 1.960,00 € |
| <p>Skipper (Payable now)</p> <p>Season: 2026 New. +provisioning ; Crew on board must have their own toilets/ showers. If either a skipper or a hostess/cook is on board, 1 double cabin will be required for him/her. If both a skipper and a hostess/cook are on board, 1 double cabin and 1 forepeak cabin will be required for them. Exceptions exists for specific layouts, Sales Agents will provide more details about the different boat models. ***NOTE: Skipper details will be available 3 days before the charter.</p> | No | per week | 1.575,00 € |

| | | | |
|--|----|-------------|-------------------|
| Skipper (Payable now) | No | per week | 1.575,00 € |
| Season: 2026 New. +provisioning ; Crew on board must have their own toilets/ showers. If either a skipper or a hostess/cook is on board, 1 double cabin will be required for him/her. If both a skipper and a hostess/cook are on board, 1 double cabin and 1 forepeak cabin will be required for them. Exceptions exists for specific layouts, Sales Agents will provide more details about the different boat models. ***NOTE: Skipper details will be available 3 days before the charter. | | | |
| Skipper (Payable now) | No | per week | 1.730,00 € |
| Season: 2026 New. +provisioning ; Crew on board must have their own toilets/ showers. If either a skipper or a hostess/cook is on board, 1 double cabin will be required for him/her. If both a skipper and a hostess/cook are on board, 1 double cabin and 1 forepeak cabin will be required for them. Exceptions exists for specific layouts, Sales Agents will provide more details about the different boat models. ***NOTE: Skipper details will be available 3 days before the charter. | | | |
| Transfer (Payable now) | No | one-way | 65,00 € |
| Season: 2026 New. OW - Split Airport - Marina Baotic / Up to 3 persons | | | |
| Transfer (Payable now) | No | one-way | 75,00 € |
| Season: 2026 New. OW - Split, town - Marina Baotic Up to 3 persons | | | |
| Transfer (Payable now) | No | one-way | 75,00 € |
| Season: 2026 New. OW - Split Airport - Marina Baotic Up to 8 persons | | | |
| Transfer (Payable now) | No | one-way | 80,00 € |
| Season: 2026 New. OW - Split, town - Marina Baotic Up to 8 persons | | | |
| Transfer (Payable now) | No | one-way | 330,00 € |
| Season: 2026 New. OW - Zadar, town - Marina Baotic Up to 3 persons | | | |
| Transfer (Payable now) | No | one-way | 350,00 € |
| Season: 2026 New. OW - Zadar, town - Marina Baotic Up to 8 persons | | | |
| Transfer (Payable now) | No | one-way | 495,00 € |
| Season: 2026 New. OW - Dubrovnik, town - Marina Baotic Up to 3 persons | | | |
| Transfer (Payable now) | No | one-way | 550,00 € |
| Season: 2026 New. OW - Dubrovnik, town - Marina Baotic Up to 8 persons | | | |
| VIP Pack (Payable now) | No | per booking | 450,00 € |
| Season: 2026 New. VIP PACK Catamaran (fast track service on arrival and access to the yacht at 13.00 pm + a luxurious drink welcome pack) | | | |

WI-FI Internet connection on boat (Payable now)

No

per week

32,00 €

Season: 2026 New.



WEBSITE

www.plujeme.cz



E-MAIL

info@plujeme.cz



PHONE

+420 720 755 085



MOBILE

+420 777 170 276



PLUJEME RÁDI S.R.O.

Dlouhá 730/35, 11000 Praha 1 – Staré Město, Czech Republic

ADDITIONAL EXTRAS

| EXTRA | OBLIGATORY | PAYMENT TYPE | PRICE |
|--|------------|--------------|-----------------|
| Donut (Payable now) Season: 2026 New. includes 1 donut - Payable now | No | per week | 65,00 € |
| Extra bedlinen and towels (Payable now) Season: 2026 New. Payable now | No | per person | 15,00 € |
| Inflatable lifejacket (Payable now) Season: 2026 New. Inflatable life vests and Jackstay - Payable now | No | per booking | 65,00 € |
| Kayak (Payable now) Season: 2026 New. Payable now | No | per booking | 285,00 € |
| Railing net (Safety net) (Payable now) Season: 2026 New. Railing net - mounting not included. Clients must mount the railing net (safety net) by themselves - Payable now | No | per booking | 110,00 € |
| Stand up paddle (SUP) (Payable now) Season: 2026 New. Price per day - Payable now | No | per night | 15,00 € |



WEBSITE

www.plujeme.cz



E-MAIL

info@plujeme.cz



PHONE

+420 720 755 085



MOBILE

+420 777 170 276



PLUJEME RÁDI S.R.O.

Dlouhá 730/35, 11000 Praha 1 – Staré Město, Czech Republic

PRICE AND AVAILABILITY

| | | | |
|--|--|--|--|
| 25.04. - 02.05.2026 1.500 € 1.820 € | 02.05. - 16.05.2026 NOT AVAILABLE | 16.05. - 23.05.2026 2.250 € 2.310 € | 23.05. - 30.05.2026 NOT AVAILABLE |
| 30.05. - 06.06.2026 NOT AVAILABLE | 06.06. - 13.06.2026 NOT AVAILABLE | 13.06. - 20.06.2026 NOT AVAILABLE | 20.06. - 27.06.2026 NOT AVAILABLE |
| 27.06. - 04.07.2026 NOT AVAILABLE | 04.07. - 11.07.2026 4.384 € 5.480 € | 11.07. - 18.07.2026 NOT AVAILABLE | 18.07. - 25.07.2026 4.888 € 6.110 € |
| 25.07. - 01.08.2026 NOT AVAILABLE | 01.08. - 08.08.2026 5.196 € 6.495 € | 08.08. - 15.08.2026 ON OPTION | 15.08. - 22.08.2026 4.424 € 5.205 € |
| 22.08. - 29.08.2026 4.310 € 5.070 € | 29.08. - 05.09.2026 NOT AVAILABLE | 05.09. - 03.10.2026 NOT AVAILABLE | 03.10. - 10.10.2026 2.255 € |
| 10.10. - 17.10.2026 1.830 € | 17.10. - 24.10.2026 1.750 € | 24.10. - 31.10.2026 1.575 € 1.750 € | 31.10. - 07.11.2026 1.575 € 1.750 € |
| 07.11. - 14.11.2026 1.575 € 1.750 € | 20.11. - 29.11.2026 NOT AVAILABLE | | |



WEBSITE

www.plujeme.cz



E-MAIL

info@plujeme.cz



PHONE

+420 720 755 085



MOBILE

+420 777 170 276



PLUJEME RÁDI S.R.O.

Dlouhá 730/35, 11000 Praha 1 – Staré Město, Czech Republic