

# BAVARIA CRUISER 46

Amaryllis (2019)

Sailing yacht Bavaria Cruiser 46 Amaryllis, built in 2019 is anchored in the **Athens, Alimos marina, Athens area/Saronic/Peloponese, Greece**. It has **4 cabins**, can accommodate **8 + 2 people** and has **3 toilets**. Bed linen and kitchen equipment are included in the price.

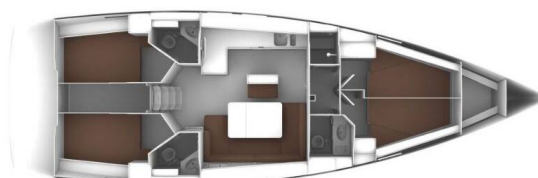

## YACHT SPECIFICATIONS

Yacht Base

**Athens, Alimos marina, Greece**

Yacht ID

**1505**

Brands

**Bavaria**

Yacht name

**Amaryllis**

Production year

**2019**

Length

**47 ft**

Cabins

**4**

Berths

**8 + 2**

Max Persons

**10**

WC

**3**

Engine

**1 x 50 HP**

Fuel tank

**210 l**



**WEBSITE**

[www.plujeme.cz](http://www.plujeme.cz)



**PHONE**

+420 720 755 085



**MOBILE**

+420 777 170 276



**E-MAIL**

[info@plujeme.cz](mailto:info@plujeme.cz)



**PLUJEME RÁDI S.R.O.**

Dlouhá 730/35, 11000 Praha 1 – Staré Město, Czech Republic

## STANDARD YACHT EQUIPMENT

Additional	<b>Flag</b>
Comfort	<b>Blankets, Pillows</b>
Deck	<b>Anchor with chain, Bathing platform, Bimini top, Boat hook, Bosun's chair (Safe seat) (boatswain's chair), Cockpit/stern, outside shower, Dinghy, Electric anchor windlass, Floating rope, Gangway, Inox Boarding Ladder, Main anchor, Main Deck Compass, Mooring ropes, Repair box for dinghy, Reserve motor oil, Spare anchor (Reserve, Auxiliary anchor), Sprayhood</b>
Entertainment	<b>Fins, Indoor speakers, Mask, Outdoor speakers, Radio CD player</b>
Galley	<b>Gas bottles, Gas cookers, Hot water, Kitchen utensils (Galley equipment, cutlery), Oven, Refrigerator, Sink</b>
Interior	<b>Barometer, Clock, Convertible table, Coolbox, Electric toilet, Hand water pump</b>
Navigation	<b>Autopilot, Binoculars, Bow thruster, Depthsounder, Divider, nautic chart, Echosounder/Depthsounder, GPS chart plotter, GPS chart plotter - cockpit, Log/speed instrument, Nautical charts, Navigation (Nautical) charts and nautical guide, Navigation set, Parallel ruler, Speedometer (Speed log)</b>
Safety	<b>Distress flare box, Engine spare parts, Fire extinguisher, First aid kit, Fog horn, Horseshoe lifebuoy, Life belts (Safety harness), Life jackets, Liferaft, Oars (Paddles), Repair kit, Set of tools, Torch, VHF radio, Wire (shroud) cutter</b>
Yacht electrics	<b>Batteries, Bilge pump - Electric, Inverter, Service batteries, Shore power cable, Solar panels, Start battery</b>



**WEBSITE**

[www.plujeme.cz](http://www.plujeme.cz)



**PHONE**

+420 720 755 085



**MOBILE**

+420 777 170 276



**E-MAIL**

[info@plujeme.cz](mailto:info@plujeme.cz)



**PLUJEME RÁDI S.R.O.**

Dlouhá 730/35, 11000 Praha 1 – Staré Město, Czech Republic

## SERVICES

SELECTED SERVICES	OBLIGATORY	PAYMENT TYPE	PRICE
<b>Standard Charter Pack</b> (Payable at the base) <b>Season: 2026.</b> Includes: End cleaning, full water tanks, 2 gas bottles, mooring fees first & last night at our base; Linen / towels not included; payable in cash at base, prior to embarkation	Yes	per booking	<b>180,00 €</b>
<b>Conversion of two separate cabins into one</b> (Payable at the base) <b>Season: 2026.</b> where possible	No	per booking	<b>120,00 €</b>
<b>Crew change</b> (Payable at the base) <b>Season: 2026.</b> Obligatory is that the skipper remains the same; Cleaning & new linen cost as per Price List.	No	per crew change	<b>170,00 €</b>
<b>Damage waiver</b> (Payable now) <b>Season: 2026.</b> + refundable 1000 €	No	per booking	<b>350,00 €</b>
<b>Early access/pick up</b> (Payable at the base) <b>Season: 2026.</b> the latest by 13.00; In case of delay despite our efforts, full refund	No	per booking	<b>150,00 €</b>
<b>Late Check in</b> (Payable at the base) <b>Season: 2026.</b> Access to the yacht after sunset / Check in procedures after sunset; Obligatory when client's arrival at base is after sunset.	No	per booking	<b>120,00 €</b>
<b>One way</b> (Payable at the base) <b>Season: 2026.</b> Athens - Ionian	No	one-way	<b>1.200,00 €</b>
<b>One way</b> (Payable at the base) <b>Season: 2026.</b> Athens - Dodecanese	No	one-way	<b>1.200,00 €</b>
<b>Overnight on board</b> (Payable at the base) <b>Season: 2026.</b> Embarkation & overnight stay the night before charter starts; Plus obligatory early access fee of 150,00 €, including check-in on charter's start day by 11:00 the latest	No	per person / night	<b>25,00 €</b>
<b>Pet on board</b> (Payable at the base) <b>Season: 2026.</b>	No	per booking	<b>150,00 €</b>
<b>Provisioning</b> (Payable at the base) <b>Season: 2026.</b> + the cost of the provisions ordered through our provisioning list	No	per service	<b>30,00 €</b>

**Sunday Check-in** (Payable at the base)

No

per booking

**120,00 €**

**Season: 2026.** Access to the yacht on Sunday / Check in procedures on Sunday; Obligatory when client's arrival at base is on Sunday.

**Wireless Internet Router** (Payable at the base)

No

per week

**50,00 €**

**Season: 2026.** 50GB



**WEBSITE**

[www.plujeme.cz](http://www.plujeme.cz)



**PHONE**

+420 720 755 085



**MOBILE**

+420 777 170 276



**E-MAIL**

[info@plujeme.cz](mailto:info@plujeme.cz)



**PLUJEME RÁDI S.R.O.**

Dlouhá 730/35, 11000 Praha 1 – Staré Město, Czech Republic

## ADDITIONAL EXTRAS

EXTRA	OBLIGATORY	PAYMENT TYPE	PRICE
<b>Automatic Inflatable Life Jacket</b> (Payable at the base) <b>Season: 2026.</b> 170 Newton - Payable at the base	No	per week/ person	<b>20,00 €</b>
<b>Beach towel</b> (Payable at the base) <b>Season: 2026.</b> Payable at the base	No	per piece	<b>5,00 €</b>
<b>Bedlinen and towels</b> (Payable at the base) <b>Season: 2026.</b> includes 1 bath towel / 1 face towel / 2 bed linen / 1 pillow case - Payable at the base	No	per set	<b>10,00 €</b>
<b>Blister</b> (Payable at the base) <b>Season: 2026.</b> + 600 EUR security deposit - Payable at the base	No	per week	<b>200,00 €</b>
<b>Kayak</b> (Payable at the base) <b>Season: 2026.</b> + 250 EUR refundable security deposit - Payable at the base	No	per week	<b>120,00 €</b>
<b>Life jacket (children)</b> (Payable at the base) <b>Season: 2026.</b> one already included in the yacht's equipment; for children under 25kg - Payable at the base	No	per week/ person	<b>10,00 €</b>
<b>Railing net (Safety net)</b> (Payable at the base) <b>Season: 2026.</b> Installed - Payable at the base	No	per booking	<b>250,00 €</b>
<b>Stand up paddle (SUP)</b> (Payable at the base) <b>Season: 2026.</b> + 250 EUR refundable security deposit - Payable at the base	No	per week	<b>120,00 €</b>



**WEBSITE**  
www.plujeme.cz



**PHONE**  
+420 720 755 085



**MOBILE**  
+420 777 170 276



**E-MAIL**  
info@plujeme.cz



**PLUJEME RÁDI S.R.O.**  
Dlouhá 730/35, 11000 Praha 1 – Staré Město, Czech Republic

## PRICE AND AVAILABILITY

25.04. - 26.04.2026 NOT AVAILABLE	02.05. - 09.05.2026 2.046 € 3.300 €	09.05. - 16.05.2026 2.046 € 3.300 €	16.05. - 23.05.2026 NOT AVAILABLE
23.05. - 30.05.2026 3.780 € 4.200 €	30.05. - 06.06.2026 3.780 € 4.200 €	06.06. - 13.06.2026 3.780 € 4.200 €	13.06. - 20.06.2026 3.780 € 4.200 €
20.06. - 27.06.2026 3.780 € 4.200 €	27.06. - 04.07.2026 3.780 € 4.200 €	04.07. - 11.07.2026 3.619 € 4.700 €	11.07. - 18.07.2026 3.619 € 4.700 €
18.07. - 25.07.2026 3.619 € 4.700 €	25.07. - 01.08.2026 3.619 € 4.700 €	01.08. - 08.08.2026 4.158 € 5.400 €	08.08. - 15.08.2026 4.158 € 5.400 €
15.08. - 22.08.2026 4.158 € 5.400 €	22.08. - 29.08.2026 3.619 € 4.700 €	29.08. - 05.09.2026 4.230 € 4.700 €	05.09. - 12.09.2026 NOT AVAILABLE
12.09. - 26.09.2026 NOT AVAILABLE	26.09. - 03.10.2026 4.230 € 4.700 €	03.10. - 10.10.2026 NOT AVAILABLE	10.10. - 17.10.2026 3.285 € 3.650 €
17.10. - 24.10.2026 2.520 € 2.800 €	24.10. - 31.10.2026 NOT AVAILABLE	31.10. - 07.11.2026 2.520 € 2.800 €	07.11. - 14.11.2026 2.520 € 2.800 €
15.11. - 31.12.2026 NOT AVAILABLE			



WEBSITE  
[www.plujeme.cz](http://www.plujeme.cz)



E-MAIL  
[info@plujeme.cz](mailto:info@plujeme.cz)



PHONE  
+420 720 755 085



PLUJEME RÁDI S.R.O.  
Dlouhá 730/35, 11000 Praha 1 – Staré Město, Czech Republic



MOBILE  
+420 777 170 276