

# FOUNTAIN PAJOT LUCIA 40

El Camino (2019)

Catamaran Fountaine Pajot Lucia 40 El Camino, built in 2019 is anchored in the **Fethiye, Yacht Classic Hotel Marina, Aegean, Turkey**. It has **4 cabins**, can accommodate **8 people** and has **4 toilets**. Bed linen and kitchen equipment are included in the price.

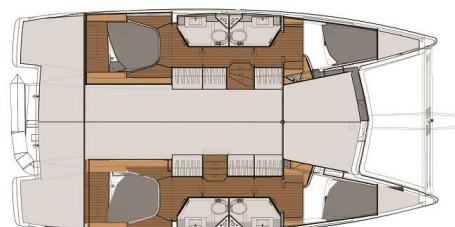

## YACHT SPECIFICATIONS

Yacht Base

**Fethiye, Yacht Classic Hotel Marina,  
Turkey**

Yacht ID

**1472**

Brands

**Fountaine Pajot**

Yacht name

**El Camino**

Production year

**2019**

Length

**38 ft**

Cabins

**4**

Berths

**8**

WC

**4**

Engine

**2 x 30 HP**

Fuel tank

**300 l**



**WEBSITE**

[www.plujeme.cz](http://www.plujeme.cz)



**PHONE**

+420 720 755 085



**MOBILE**

+420 777 170 276



**E-MAIL**

[info@plujeme.cz](mailto:info@plujeme.cz)



**PLUJEME RÁDI S.R.O.**

Dlouhá 730/35, 11000 Praha 1 – Staré Město, Czech Republic

## STANDARD YACHT EQUIPMENT

Comfort	<b>Cockpit cushions</b>
Deck	<b>Anchor swivel, Bathing platform, Bimini top, Cockpit/stern, outside shower, Dinghy, Electric anchor windlass, Gangway, Main anchor, Outboard engine</b>
Entertainment	<b>Indoor speakers</b>
Galley	<b>Hot water, Refrigerator</b>
Interior	<b>Barometer, Thermometer</b>
Navigation	<b>Autopilot, Electronic sea charts, GPS chart plotter - cockpit, Log, Speed, Depth- echo sounder, Nautical charts, Pilot book</b>
Safety	<b>Automatic Inflatable Life Jacket, Life jacket (children), Liferaft</b>
Yacht electrics	<b>Battery charger, Heating, Inverter, Solar panels</b>



#### WEBSITE

[www.plujeme.cz](http://www.plujeme.cz)



#### E-MAIL

[info@plujeme.cz](mailto:info@plujeme.cz)



#### PHONE

+420 720 755 085



#### MOBILE

+420 777 170 276



#### PLUJEME RÁDI S.R.O.

Dlouhá 730/35, 11000 Praha 1 – Staré Město, Czech Republic

## SERVICES

SELECTED SERVICES	OBLIGATORY	PAYMENT TYPE	PRICE
<b>Charter package</b> (Payable at the base) <b>Season: 2026.</b> Includes: Transit log, Cleaning, LPG Gas Bottle, Inverter, Bed linen, Blanket, Towels, Salt, Black Paper, Thyme, Chili Paper, Liquid Hand Soap, Dish soap, WC Paper;	Yes	per booking	<b>450,00 €</b>
<b>Early Check in</b> (Payable at the base) <b>Season: 2026.</b>	No	per booking	<b>150,00 €</b>
<b>Extra cleaning</b> (Payable at the base) <b>Season: 2026.</b>	No	per booking	<b>70,00 €</b>
<b>Hostess/Cook</b> (Payable at the base) <b>Season: 2026.</b> + cabin	No	per day + food	<b>150,00 €</b>
<b>Provisioning</b> (Payable at the base) <b>Season: 2026.</b> On Request	No	per booking	<b>0,00 €</b>
<b>Refuel service</b> (Payable at the base) <b>Season: 2026.</b> + cost of diesel	No	per service	<b>50,00 €</b>
<b>Skipper</b> (Payable at the base) <b>Season: 2026.</b> + cabin	No	per day + food	<b>185,00 €</b>
<b>Smaller safety deposit</b> (Payable at the base) <b>Season: 2026.</b> Security deposit can be reduced to 20% (of it's original value) with a non-refundable payment of 10% of deposit. Does not cover: dinghy, outboard, anchor, chain and sails.	No	per booking	<b>0,00 €</b>
<b>Transfer</b> (Payable at the base) <b>Season: 2026.</b> DALAMAN-GÖÇEK (1-6 pax)	No	one-way	<b>70,00 €</b>
<b>Transfer</b> (Payable at the base) <b>Season: 2026.</b> DALAMAN-FETHİYE (1-6 pax)	No	one-way	<b>75,00 €</b>
<b>Transfer</b> (Payable at the base) <b>Season: 2026.</b> DALAMAN-ÖLÜDENİZ (1-6 pax)	No	one-way	<b>85,00 €</b>
<b>Transfer</b> (Payable at the base) <b>Season: 2026.</b> DALAMAN-MARMARİS (1-6 pax)	No	one-way	<b>95,00 €</b>

<b>Transfer</b> (Payable at the base) <b>Season: 2026.</b> DALAMAN-GÖÇEK (7-13 pax)	No	one-way	<b>100,00 €</b>
<b>Transfer</b> (Payable at the base) <b>Season: 2026.</b> DALAMAN-FETHİYE (7-13 pax)	No	one-way	<b>120,00 €</b>
<b>Transfer</b> (Payable at the base) <b>Season: 2026.</b> DALAMAN-ÖLÜDENİZ (7-13 pax)	No	one-way	<b>120,00 €</b>
<b>Transfer</b> (Payable at the base) <b>Season: 2026.</b> DALAMAN-MARMARİS (7-13 pax)	No	one-way	<b>150,00 €</b>
<b>Transfer</b> (Payable at the base) <b>Season: 2026.</b> FETHİYE - MARMARİS (1-6 pax)	No	one-way	<b>180,00 €</b>
<b>Transfer</b> (Payable at the base) <b>Season: 2026.</b> DALAMAN - KAŞ (1-6 pax)	No	one-way	<b>180,00 €</b>
<b>Transfer</b> (Payable at the base) <b>Season: 2026.</b> DALAMAN - D MARİS (1-6 pax)	No	one-way	<b>200,00 €</b>
<b>Transfer</b> (Payable at the base) <b>Season: 2026.</b> ANTALYA-FETHİYE (1-6 pax)	No	one-way	<b>230,00 €</b>
<b>Transfer</b> (Payable at the base) <b>Season: 2026.</b> DALAMAN - KEKOVA (1-6 pax)	No	one-way	<b>230,00 €</b>
<b>Transfer</b> (Payable at the base) <b>Season: 2026.</b> FETHİYE - MARMARİS (7-13 pax)	No	one-way	<b>230,00 €</b>
<b>Transfer</b> (Payable at the base) <b>Season: 2026.</b> DALAMAN - BOZBURUN (1-6 pax)	No	one-way	<b>240,00 €</b>
<b>Transfer</b> (Payable at the base) <b>Season: 2026.</b> BODRUM Airport - FETHİYE (1-6 pax)	No	one-way	<b>240,00 €</b>
<b>Transfer</b> (Payable at the base) <b>Season: 2026.</b> DALAMAN - KAŞ (7-13 pax)	No	one-way	<b>270,00 €</b>
<b>Transfer</b> (Payable at the base) <b>Season: 2026.</b> DALAMAN - D MARİS (7-13 pax)	No	one-way	<b>280,00 €</b>
<b>Transfer</b> (Payable at the base) <b>Season: 2026.</b> BODRUM Center - FETHİYE (1-6 pax)	No	one-way	<b>290,00 €</b>

<b>Transfer</b> (Payable at the base) <b>Season: 2026.</b> DALAMAN - KEKOVA (7-13 pax)	No	one-way	<b>300,00 €</b>
<b>Transfer</b> (Payable at the base) <b>Season: 2026.</b> FETHİYE - SİDE/KEMER (1-6 pax)	No	one-way	<b>300,00 €</b>
<b>Transfer</b> (Payable at the base) <b>Season: 2026.</b> FETHİYE - PAMUKKALE (1-6 pax)	No	one-way	<b>300,00 €</b>
<b>Transfer</b> (Payable at the base) <b>Season: 2026.</b> DALAMAN - BOZBURUN (7-13 pax)	No	one-way	<b>300,00 €</b>
<b>Transfer</b> (Payable at the base) <b>Season: 2026.</b> İZMİR Airport - FETHİYE (1-6 pax)	No	one-way	<b>350,00 €</b>
<b>Transfer</b> (Payable at the base) <b>Season: 2026.</b> ANTALYA-FETHİYE (7-13 pax)	No	one-way	<b>350,00 €</b>
<b>Transfer</b> (Payable at the base) <b>Season: 2026.</b> BODRUM Airport - FETHİYE (7-13 pax)	No	one-way	<b>350,00 €</b>
<b>Transfer</b> (Payable at the base) <b>Season: 2026.</b> FETHİYE - PAMUKKALE (7-13 pax)	No	one-way	<b>390,00 €</b>
<b>Transfer</b> (Payable at the base) <b>Season: 2026.</b> İZMİR Airport - FETHİYE (7-13 pax)	No	one-way	<b>400,00 €</b>
<b>Transfer</b> (Payable at the base) <b>Season: 2026.</b> FETHİYE - SİDE/KEMER (7-13 pax)	No	one-way	<b>400,00 €</b>
<b>Transfer</b> (Payable at the base) <b>Season: 2026.</b> BODRUM Center - FETHİYE (7-13 pax)	No	one-way	<b>400,00 €</b>
<b>Transitlog to Greece</b> (Payable at the base) <b>Season: 2026.</b>	No	per booking	<b>300,00 €</b>
<b>WI-FI Internet connection on boat</b> (Payable at the base) <b>Season: 2026.</b> 50Gb	No	per service	<b>50,00 €</b>
<b>WI-FI Internet connection on boat</b> (Payable at the base) <b>Season: 2026.</b> unlimited	No	per week	<b>100,00 €</b>



**WEBSITE**  
www.plujeme.cz



**PHONE**  
+420 720 755 085



**MOBILE**  
+420 777 170 276



**E-MAIL**  
info@plujeme.cz



**PLUJEME RÁDI S.R.O.**  
Dlouhá 730/35, 11000 Praha 1 - Staré Město, Czech Republic

## ADDITIONAL EXTRAS

EXTRA	OBLIGATORY	PAYMENT TYPE	PRICE
<b>Additional gas bottle</b> (Payable at the base) <b>Season: 2026.</b> Payable at the base	No	per bottle	<b>10,00 €</b>
<b>Coffee capsules</b> (Payable at the base) <b>Season: 2026.</b> Ask for yacht compatibility. - Payable at the base	No	per booking	<b>60,00 €</b>
<b>Electrical filter coffee maker</b> (Payable at the base) <b>Season: 2026.</b> Ask for yacht compatibility. - Payable at the base	No	per booking	<b>30,00 €</b>
<b>Extra bedlinen</b> (Payable at the base) <b>Season: 2026.</b> Payable at the base	No	per set	<b>10,00 €</b>
<b>Extra towels</b> (Payable at the base) <b>Season: 2026.</b> Payable at the base	No	per set	<b>5,00 €</b>
<b>Ice maker</b> (Payable at the base) <b>Season: 2026.</b> Payable at the base	No	per week	<b>60,00 €</b>
<b>Railing net (Safety net)</b> (Payable at the base) <b>Season: 2026.</b> Payable at the base	No	per booking	<b>100,00 €</b>
<b>Sea Scooter</b> (Payable at the base) <b>Season: 2026.</b> Payable at the base	No	per week	<b>150,00 €</b>
<b>Stand up paddle (SUP)</b> (Payable at the base) <b>Season: 2026.</b> Payable at the base	No	per week	<b>100,00 €</b>



**WEBSITE**

[www.plujeme.cz](http://www.plujeme.cz)



**E-MAIL**

[info@plujeme.cz](mailto:info@plujeme.cz)



**PHONE**

+420 720 755 085



**MOBILE**

+420 777 170 276



**PLUJEME RÁDI S.R.O.**

Dlouhá 730/35, 11000 Praha 1 – Staré Město, Czech Republic

## PRICE AND AVAILABILITY

25.04. - 30.04.2026 NOT AVAILABLE	02.05. - 09.05.2026 4.290 €	09.05. - 16.05.2026 NOT AVAILABLE	16.05. - 23.05.2026 4.290 €
23.05. - 30.05.2026 NOT AVAILABLE	30.05. - 06.06.2026 NOT AVAILABLE	06.06. - 13.06.2026 NOT AVAILABLE	13.06. - 20.06.2026 4.990 €
20.06. - 27.06.2026 4.990 €	27.06. - 04.07.2026 4.990 €	04.07. - 11.07.2026 4.990 €	11.07. - 18.07.2026 4.990 €
18.07. - 25.07.2026 4.990 €	25.07. - 01.08.2026 4.990 €	01.08. - 08.08.2026 4.990 €	08.08. - 22.08.2026 NOT AVAILABLE
22.08. - 29.08.2026 5.190 €	29.08. - 05.09.2026 5.190 €	05.09. - 12.09.2026 NOT AVAILABLE	12.09. - 19.09.2026 NOT AVAILABLE
19.09. - 26.09.2026 NOT AVAILABLE	26.09. - 03.10.2026 5.190 €	03.10. - 10.10.2026 5.190 €	10.10. - 17.10.2026 5.190 €
17.10. - 24.10.2026 5.190 €	24.10. - 31.10.2026 5.190 €	31.10. - 07.11.2026 NOT AVAILABLE	07.11. - 14.11.2026 3.190 €
14.11. - 21.11.2026 3.190 €	21.11. - 28.11.2026 3.190 €	28.11. - 05.12.2026 3.190 €	



WEBSITE

[www.plujeme.cz](http://www.plujeme.cz)



E-MAIL

[info@plujeme.cz](mailto:info@plujeme.cz)



PHONE

+420 720 755 085



MOBILE

+420 777 170 276



PLUJEME RÁDI S.R.O.

Dlouhá 730/35, 11000 Praha 1 – Staré Město, Czech Republic

## PRICE AND AVAILABILITY

05.12. - 12.12.2026

3.190 €

12.12. - 19.12.2026

3.190 €

19.12. - 26.12.2026

3.190 €



### WEBSITE

[www.plujeme.cz](http://www.plujeme.cz)



### E-MAIL

[info@plujeme.cz](mailto:info@plujeme.cz)



### PHONE

+420 720 755 085



### MOBILE

+420 777 170 276



### PLUJEME RÁDI S.R.O.

Dlouhá 730/35, 11000 Praha 1 – Staré Město, Czech Republic