

OCEANIS 45

STRAUSS (2017)

Sailing yacht Oceanis 45 STRAUSS, built in 2017 is anchored in the **Guadeloupe, La Marina Bas du Fort, Guadeloupe, Caribbean**. It has **4 cabins**, can accommodate **8 + 2 people** and has **2 toilets**. Bed linen and kitchen equipment are included in the price.

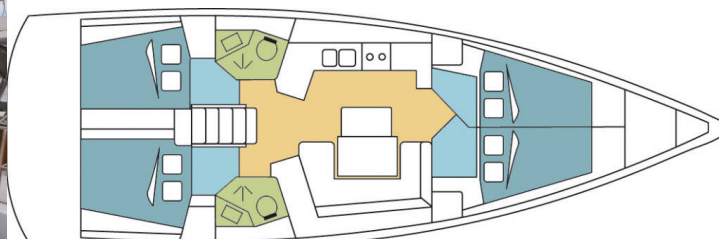

YACHT SPECIFICATIONS

Yacht Base

**Guadeloupe, La Marina Bas du Fort,
Caribbean**

Yacht ID

14345

Brands

Beneteau

Yacht name

STRAUSS

Production year

2017

Length

45 ft

Cabins

4

Berths

8 + 2

Max Persons

10

WC

2

Engine

1 x 57 HP

Fuel tank

200 l



WEBSITE

www.plujeme.cz



PHONE

+420 720 755 085



MOBILE

+420 777 170 276



E-MAIL

info@plujeme.cz



PLUJEME RÁDI S.R.O.

Dlouhá 730/35, 11000 Praha 1 - Staré Město, Czech Republic

STANDARD YACHT EQUIPMENT

Comfort	Cockpit cushions
Deck	Bimini top, Cockpit table, Cockpit/stern, outside shower, Dinghy, Electric anchor windlass, Outboard engine, Sprayhood, Swimming ladder
Entertainment	Fusion radio, Outdoor speakers
Galley	Hot water, Kitchen utensils (Galley equipment, cutlery), Oven, Refrigerator, Stove
Interior	Convertible table, Convertible table in salon, Electric fans in cabins, Electric toilet
Navigation	Autopilot, Depthsounder, GPS chart plotter, Wind instrument/Anemometer
Safety	VHF radio
Sails	Electric winch, Lazy bag, Lazy jacks, Self tailing (manual) winch
Yacht electrics	Battery charger, Inverter, Plug 220V, 12 V, Shore connection 220 V



WEBSITE

www.plujeme.cz



E-MAIL

info@plujeme.cz



PHONE

+420 720 755 085



MOBILE

+420 777 170 276



PLUJEME RÁDI S.R.O.

Dlouhá 730/35, 11000 Praha 1 – Staré Město, Czech Republic

SERVICES

SELECTED SERVICES	OBLIGATORY	PAYMENT TYPE	PRICE
Essentials pack (Payable now) Season: 2026 Exotic. INCLUDED: Damage waiver (covering damages) with reduced security deposit addressed specifically to blocked toilets, unpaid fuel, lost equipment, unpaid fees & fines, and returning the boat in an extremely dirty state. // starter pack – (1 gallon water or 4 bottles of 1.5L, 1 bottle of disinfectant, 1 small bottle of washing up liquid, 1 dish cloth, 1 sponge, garbage bags, 1 roll of paper towels, 1 box of matches, 1 roll of toilet paper in each head) // final cleaning // 1 set of bed sheets & towels, dinghy, outboard engine & initial supply of fuel, gas and water tanks // DYC assistance guarantee // 1st & last night in the marina /// NOT INCLUDED: refuelling, gas & water consumption at end of charter, taxes if any, handling fees & additional equipment deposit.	Yes	per booking	645,00 €
Handling fees (Payable now) Season: 2026 Exotic.	Yes	per booking	35,00 €
Preparation fee (Payable now) Season: 2026 Exotic. INCLUDED: starter pack – (1 gallon water or 4 bottles of 1.5L, 1 bottle of disinfectant, 1 small bottle of washing up liquid, 1 dish cloth, 1 sponge, garbage bags, 1 roll of paper towels, 1 box of matches, 1 roll of toilet paper in each head) // final cleaning // 1 set of bed sheets / cabin & 1 set of towels / pax, dinghy, outboard engine & initial supply of fuel, gas and water tanks // DYC assistance guarantee // 1st & last night in the marina // NOT INCLUDED: refuelling, gas & water consumption at end of charter, taxes if any, handling fees & additional equipment deposit.	Yes	per booking	340,00 €
Crew change (Payable now) Season: 2026 Exotic. Any crew change during the charter is subject to € 250.- additional cost. The charge includes administration cost, change of bed linen and towels and one night at DYC ponton (marina fee included only if the same base than start base). It doesn't include cleaning, nor new transit log where applicable.	No	per booking	250,00 €
Damage waiver (Payable now) Season: 2026 Exotic. Damage waiver limits your liability to the reduced Security Deposit . Mandatory when skipper is added. Price is per night of the charter (minimum value of 7 nights & a maximum value of 21 nights) Not applicable for 4+ weeks charters , nor Regattas/Races.	No	per night	55,00 €

Diving (Payable now)	No	per booking	0,00 €
Season: 2026 Exotic. For bareboat charters only Upon request			
Early boarding/check-in (Payable now)	No	per booking	360,00 €
Season: 2026 Exotic. EB (boat only) - 14:00 h / 2 PM starting time of boat's delivery // limited number of early boardings on same departure day			
Early boarding/check-in (Payable now)	No	per booking	580,00 €
Season: 2026 Exotic. EB boat + extra fee skipper - 14:00 h / 2 PM starting time of boat's delivery // limited number of early boardings on same departure day			
Early boarding/check-in (Payable now)	No	per booking	765,00 €
Season: 2026 Exotic. EB + extra fee Skipper & Hostes - 14:00 h / 2 PM starting time of boat's delivery // limited number of early boardings on same departure day			
Electric & Water consumption in the Marinas (Payable at the base)	No	per booking	22,00 €
Season: 2026 Exotic. Electric & Water consumption based on 2 nights on our dock (base will confirm the amount to pay locally depending on nights spent on dock)			
Extra set of linen (choose how many) (Payable now)	No	per booking	15,00 €
Season: 2026 Exotic. Extra set of linen : 15 € 1 set of linen (2 sheets & 2 pillow case) - to be updated manually			
Extra set of towels (choose how many) (Payable now)	No	per booking	10,00 €
Season: 2026 Exotic. Extra set of towels: 10 € 1 set of towels (1 face & 1 bath towel) - to be updated manually			
Final cleaning (Payable now)	No	per booking	220,00 €
Season: 2026 Exotic. included in Essentials pack			
Final cleaning (Payable now)	No	per booking	220,00 €
Season: 2026 Exotic. included in Essentials pack			
Full board 1-3 pax (number of guests to update manually) (Payable now)	No	per guest/day	80,00 €
Season: 2026 Exotic. only available if cook is booked on board as the cook will do the provisioning based on client's preference. Includes breakfast, lunch & dinner + the crew's food. Does not included alcoholic drinks			
Full board 4-6 pax (number of guests to update manually) (Payable now)	No	per guest/day	65,00 €
Season: 2026 Exotic. only available if cook is booked on board as the cook will do the provisioning based on client's preference. Includes breakfast, lunch & dinner + the crew's food. Does not included alcoholic drinks			

<p>Full board 7-12 pax (number of guests to update manually) (Payable now)</p> <p>Season: 2026 Exotic. only available if cook is booked on board as the cook will do the provisioning based on client's preference. Includes breakfast, lunch & dinner + the crew's food. Does not included alcoholic drinks</p>	No	per guest/day	60,00 €
<p>Half board 1-3 pax (number of guests to update manually) (Payable now)</p> <p>Season: 2026 Exotic. only available if cook is booked on board as the cook will do the provisioning based on client's preference. Includes breakfast & lunch OR dinner + the crew's food. Does not included alcoholic drinks</p>	No	per guest/day	65,00 €
<p>Half board 4-6 pax (number of guests to update manually) (Payable now)</p> <p>Season: 2026 Exotic. only available if cook is booked on board as the cook will do the provisioning based on client's preference. Includes breakfast & lunch OR dinner + the crew's food. Does not included alcoholic drinks</p>	No	per guest/day	55,00 €
<p>Half board 7-12 pax (number of guests to update manually) (Payable now)</p> <p>Season: 2026 Exotic. only available if cook is booked on board as the cook will do the provisioning based on client's preference. Includes breakfast & lunch OR dinner + the crew's food. Does not included alcoholic drinks</p>	No	per guest/day	50,00 €
<p>Hostess/Cook (Payable now)</p> <p>Season: 2026 Exotic. + provisioning, Crew on board must have their own toilets/ showers. If either a skipper or a hostess/cook is on board, 1 double cabin will be required for him/her. If both askipper and a hostess/cook are on board, 1 double cabin and 1 forepeak cabin will be required for them. Exceptions exists for specific layouts, Sales Agents will provide more details about the different boat models</p>	No	per night	200,00 €
<p>Hostess/Cook (Payable now)</p> <p>Season: 2026 Exotic. + provisioning, Crew on board must have their own toilets/ showers. If either a skipper or a hostess/cook is on board, 1 double cabin will be required for him/her. If both a skipper and a hostess/cook are on board, 1 double cabin and 1 forepeak cabin will be required for them. Exceptions exists for specific layouts, Sales Agents will provide more details about the different boat models</p>	No	per night	200,00 €
<p>Hostess/Cook (Payable now)</p> <p>Season: 2026 Exotic. + provisioning, Crew on board must have their own toilets/ showers. If either a skipper or a hostess/cook is on board, 1 double cabin will be required for him/her. If both a skipper and a hostess/cook are on board, 1 double cabin and 1 forepeak cabin will be required for them. Exceptions exists for specific layouts, Sales Agents will provide more details about the different boat models</p>	No	per night	220,00 €

Race pack (Payable now)	No	per booking	1.320,00 €
<p>Season: 2026 Exotic. BVI Spring Regatta, Briefing before the race, preparation and gauging of sails, registration of the yacht (not of the passengers), technical assistance during the race *** technical assistance during the race not valid for RORC Caribbean 600 // A special race deposit need to be doubled manually once the race fee is added.</p>			
Race pack (Payable now)	No	per booking	1.650,00 €
<p>Season: 2026 Exotic. Antigua, Briefing before the race, preparation and gauging of sails, registration of the yacht (not of the passengers), technical assistance during the race *** technical assistance during the race not valid for RORC Caribbean 600 // A special race deposit need to be doubled manually once the race fee is added.</p>			
Race pack (Payable now)	No	per booking	1.650,00 €
<p>Season: 2026 Exotic. RORC caribbean 600, Briefing before the race, preparation and gauging of sails, registration of the yacht (not of the passengers), technical assistance during the race *** technical assistance during the race not valid for RORC Caribbean 600 // A special race deposit need to be doubled manually once the race fee is added.</p>			
Regatta surcharge (Payable now)	No	per booking	1.950,00 €
<p>Season: 2026 Exotic. valid for ASW regatta only // A special race deposit need to be doubled manually once the regatta surcharge is added.</p>			
Regatta surcharge (Payable now)	No	per booking	0,00 €
<p>Season: 2026 Exotic. all the regattas apart of ASW (different regatta surcharge for ASW) // A special race deposit need to be doubled manually once the regatta surcharge is added.</p>			
Same day briefing (Payable now)	No	per booking	120,00 €
<p>Season: 2026 Exotic. Same day briefing starting between 5 & 5.30pm (departure following morning)</p>			
Skipper (Payable now)	No	per night	260,00 €
<p>Season: 2026 Exotic. + provisioning, Crew on board must have their own toilets/ showers. If either a skipper or a hostess/cook is on board, 1 double cabin will be required for him/her. If both a skipper and a hostess/cook are on board, 1 double cabin and 1 forepeak cabin will be required for them. Exceptions exists for specific layouts, Sales Agents will provide more details about the different boat models</p>			

Skipper (Payable now)	No	per night	260,00 €
Season: 2026 Exotic. + provisioning, Crew on board must have their own toilets/ showers. If either a skipper or a hostess/cook is on board, 1 double cabin will be required for him/her. If both a skipper and a hostess/cook are on board, 1 double cabin and 1 forepeak cabin will be required for them. Exceptions exists for specific layouts, Sales Agents will provide more details about the different boat models			
Skipper (Payable now)	No	per night	285,00 €
Season: 2026 Exotic. + provisioning, Crew on board must have their own toilets/ showers. If either a skipper or a hostess/cook is on board, 1 double cabin will be required for him/her. If both a skipper and a hostess/cook are on board, 1 double cabin and 1 forepeak cabin will be required for them. Exceptions exists for specific layouts, Sales Agents will provide more details about the different boat models			
Starter pack (Payable now)	No	per booking	50,00 €
Season: 2026 Exotic. included in Essentials pack (The pack includes: 1 gallon water (or 4 bottles of 1.5L), 1 bottle of disinfectant, 1 small bottle of washing up liquid, 1 dish cloth, 1 sponge, garbage bags, 1 roll of paper towels, 1 box of matches, 1 roll of toilet paper in each head			
Transfer (Payable now)	No	one-way	49,50 €
Season: 2026 Exotic. OW - Airport/Base (1-4 pax)			
Transfer (Payable now)	No	one-way	65,00 €
Season: 2026 Exotic. OW - Airport/Base (5-8 pax)			
Transfer (Payable now)	No	round trip	99,00 €
Season: 2026 Exotic. RT - Guadeloupe airport/base/airport (1-4 pax)			
Transfer (Payable now)	No	one-way	130,00 €
Season: 2026 Exotic. OW - Airport/Base (9-12 pax)			
Transfer (Payable now)	No	round trip	130,00 €
Season: 2026 Exotic. RT - Guadeloupe - Airport/Base/Airport (5-8 pax)			
Transfer (Payable now)	No	round trip	260,00 €
Season: 2026 Exotic. RT - Airport/Base/Airport (9-12 pax)			



WEBSITE
www.plujeme.cz



PHONE
+420 720 755 085



MOBILE
+420 777 170 276



E-MAIL
info@plujeme.cz



PLUJEME RÁDI S.R.O.
Dlouhá 730/35, 11000 Praha 1 – Staré Město, Czech Republic

ADDITIONAL EXTRAS

EXTRA	OBLIGATORY	PAYMENT TYPE	PRICE
Fishing equipment (Payable now) Season: 2026 Exotic. Additional deposit 100 EUR (subject to availability) - Payable now	No	per day	15,00 €
Kayak single (Payable now) Season: 2026 Exotic. price per day - Payable now	No	per night	15,00 €
Kayak tandem (Payable now) Season: 2026 Exotic. price per day - Payable now	No	per night	15,00 €
Railing net (Safety net) (Payable now) Season: 2026 Exotic. net is supplied but not installed - Payable now	No	per booking	230,00 €
Stand up paddle (SUP) (Payable now) Season: 2026 Exotic. Price per day - Payable now	No	per night	15,00 €



WEBSITE

www.plujeme.cz



E-MAIL

info@plujeme.cz



PHONE

+420 720 755 085



MOBILE

+420 777 170 276



PLUJEME RÁDI S.R.O.

Dlouhá 730/35, 11000 Praha 1 – Staré Město, Czech Republic

PRICE AND AVAILABILITY

11.07. - 18.07.2026 2.185 €	18.07. - 25.07.2026 2.185 €	25.07. - 01.08.2026 2.185 €	02.08. - 14.10.2026 NOT AVAILABLE
15.10. - 18.10.2026 NOT AVAILABLE	24.10. - 31.10.2026 1.500 € 1.765 €	31.10. - 07.11.2026 1.607 € 1.890 €	07.11. - 14.11.2026 1.798 € 2.115 €
14.11. - 21.11.2026 2.163 € 2.545 €	21.11. - 28.11.2026 2.542 € 2.990 €	28.11. - 05.12.2026 2.542 € 2.990 €	05.12. - 12.12.2026 2.431 € 2.860 €
12.12. - 19.12.2026 2.431 € 2.860 €	19.12. - 26.12.2026 4.560 €	02.01. - 09.01.2027 4.325 € 4.805 €	09.01. - 16.01.2027 4.325 € 4.805 €
16.01. - 23.01.2027 4.541 € 5.045 €	23.01. - 30.01.2027 4.541 € 5.045 €	30.01. - 06.02.2027 4.541 € 5.045 €	06.02. - 13.02.2027 5.027 € 5.585 €
13.02. - 20.02.2027 5.045 € 5.605 €	20.02. - 27.02.2027 5.549 € 6.165 €	27.02. - 06.03.2027 5.549 € 6.165 €	



WEBSITE

www.plujeme.cz



E-MAIL

info@plujeme.cz



PHONE

+420 720 755 085



MOBILE

+420 777 170 276



PLUJEME RÁDI S.R.O.

Dlouhá 730/35, 11000 Praha 1 – Staré Město, Czech Republic

PRICE AND AVAILABILITY

06.03. - 13.03.2027 4.928 € 5.475 €	13.03. - 20.03.2027 4.316 € 4.795 €	20.03. - 27.03.2027 4.316 € 4.795 €	27.03. - 03.04.2027 4.316 € 4.795 €
03.04. - 10.04.2027 4.307 € 4.785 €	10.04. - 17.04.2027 4.028 € 4.475 €	17.04. - 24.04.2027 3.645 € 4.050 €	24.04. - 01.05.2027 3.456 € 3.840 €
01.05. - 08.05.2027 2.835 € 3.150 €	08.05. - 15.05.2027 2.574 € 2.860 €	15.05. - 22.05.2027 2.264 € 2.515 €	22.05. - 29.05.2027 2.070 € 2.300 €
29.05. - 05.06.2027 1.940 € 2.155 €	05.06. - 12.06.2027 1.742 € 1.935 €	12.06. - 19.06.2027 1.742 € 1.935 €	19.06. - 26.06.2027 1.742 € 1.935 €
26.06. - 03.07.2027 1.742 € 1.935 €	03.07. - 10.07.2027 1.868 € 2.075 €	10.07. - 17.07.2027 1.998 € 2.220 €	17.07. - 24.07.2027 1.998 € 2.220 €
24.07. - 31.07.2027 1.998 € 2.220 €	31.07. - 07.08.2027 1.998 € 2.220 €	07.08. - 14.08.2027 1.683 € 1.870 €	14.08. - 21.08.2027 1.368 € 1.520 €
21.08. - 28.08.2027 1.368 € 1.520 €	28.08. - 04.09.2027 1.368 € 1.520 €	04.09. - 11.09.2027 1.368 € 1.520 €	11.09. - 18.09.2027 1.368 € 1.520 €
18.09. - 25.09.2027 1.368 € 1.520 €	25.09. - 02.10.2027 1.372 € 1.524 €	02.10. - 09.10.2027 1.395 € 1.550 €	09.10. - 16.10.2027 1.395 € 1.550 €
16.10. - 23.10.2027 1.512 € 1.680 €	23.10. - 30.10.2027 1.620 € 1.800 €	30.10. - 06.11.2027 1.737 € 1.930 €	



WEBSITE
www.plujeme.cz



E-MAIL
info@plujeme.cz



PHONE
+420 720 755 085



MOBILE
+420 777 170 276



PLUJEME RÁDI S.R.O.
Dlouhá 730/35, 11000 Praha 1 – Staré Město, Czech Republic

PRICE AND AVAILABILITY

06.11. - 13.11.2027

1.940 € 2.155 €

13.11. - 20.11.2027

2.336 € 2.595 €

20.11. - 27.11.2027

2.745 € 3.050 €

27.11. - 04.12.2027

2.745 € 3.050 €

04.12. - 11.12.2027

2.624 € 2.915 €

11.12. - 18.12.2027

2.624 € 2.915 €

18.12. - 25.12.2027

4.185 € 4.650 €



WEBSITE

www.plujeme.cz



PHONE

+420 720 755 085



MOBILE

+420 777 170 276



E-MAIL

info@plujeme.cz



PLUJEME RÁDI S.R.O.

Dlouhá 730/35, 11000 Praha 1 – Staré Město, Czech Republic