

# LAGOON 42

WHITE MOON (2024)

Catamaran Lagoon 42 WHITE MOON, built in 2024 is anchored in the **Naples, Pozzuoli, Campania, Italy**. It has **4 + 2 cabins**, can accommodate **8 + 2 + 2 people** and has **4 toilets**. Bed linen and kitchen equipment are included in the price.

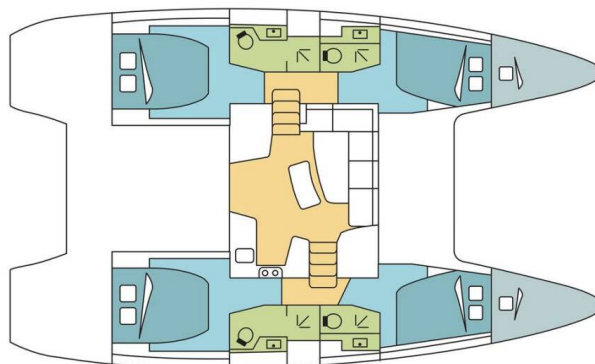

## YACHT SPECIFICATIONS

Yacht Base

**Naples, Pozzuoli, Italy**

Yacht ID

**14274**

Brands

**Lagoon**

Yacht name

**WHITE MOON**

Production year

**2024**

Length

**42 ft**

Cabins

**4 + 2**

Berths

**8 + 2 + 2**

Max Persons

**12**

WC

**4**

Engine

**2 x 57 HP**

Fuel tank

**600 l**



**WEBSITE**

[www.plujeme.cz](http://www.plujeme.cz)



**PHONE**

+420 720 755 085



**MOBILE**

+420 777 170 276



**E-MAIL**

[info@plujeme.cz](mailto:info@plujeme.cz)



**PLUJEME RÁDI S.R.O.**

Dlouhá 730/35, 11000 Praha 1 - Staré Město, Czech Republic

## STANDARD YACHT EQUIPMENT

Comfort	<b>Cockpit cushions</b>
Deck	<b>Bimini top, Cockpit fridge, Pulpit seat</b>
Entertainment	<b>Fusion radio</b>
Galley	<b>Refrigerator</b>
Interior	<b>Convertible table in salon, Curtains, Electric fans in cabins, Electric toilet, Indirect lighting in cabins and salon, Upholstery</b>
Navigation	<b>Autopilot, Depthsounder, GPS chart plotter, Helm station, Speedometer (Speed log), Wind instrument/Anemometer</b>
Sails	<b>Electric winch, Lazy bag</b>
Yacht electrics	<b>Air Conditioning, Battery charger, Generator, Inverter, Service batteries, USB sockets, Watermaker - desalinator</b>



**WEBSITE**

[www.plujeme.cz](http://www.plujeme.cz)



**E-MAIL**

[info@plujeme.cz](mailto:info@plujeme.cz)



**PHONE**

+420 720 755 085



**MOBILE**

+420 777 170 276



**PLUJEME RÁDI S.R.O.**

Dlouhá 730/35, 11000 Praha 1 – Staré Město, Czech Republic

## SERVICES

SELECTED SERVICES	OBLIGATORY	PAYMENT TYPE	PRICE
<b>Handling fees</b> (Payable now) <b>Season: 2026.</b>	Yes	per booking	<b>25,00 €</b>
<b>Preparation fee</b> (Payable now) <b>Season: 2026.</b> INCLUDED: starter pack – (1 gallon water or 4 bottles of 1.5L, 1 bottle of disinfectant, 1 small bottle of washing up liquid, 1 dish cloth, 1 sponge, garbage bags, 1 roll of paper towels, 1 box of matches, 1 roll of toilet paper in each head) // final cleaning // 1 set of bed sheets / cabin & 1 set of towels / pax, dinghy, outboard engine & initial supply of fuel, gas and water tanks // DYC assistance guarantee // 1st & last night in the marina // NOT INCLUDED: refuelling, gas & water consumption at end of charter, taxes if any, handling fees & additional equipment deposit.	Yes	per booking	<b>380,00 €</b>
<b>Additional fee for Skipper in forepeak &amp; shared bathroom</b> (Payable at the base) <b>Season: 2026.</b> To be added with Skipper only ; Can be added for new bookings only confirmed after 21/05/2026 ; replaces skipper requirement to have their own toilet/shower. Guests must be aware that they'll need to give access to toilet/shower.	No	per night	<b>50,00 €</b>
<b>Crew change</b> (Payable now) <b>Season: 2026.</b> Any crew change during the charter is subject to € 250.- additional cost. The charge includes administration cost, change of bed linen and towels and one night at DYC ponton (marina fee included only if the same base than start base). It doesn't include cleaning, nor new transit log where applicable.	No	per booking	<b>250,00 €</b>
<b>Damage waiver</b> (Payable now) <b>Season: 2026.</b> Damage waiver limits your liability to the reduced Security Deposit . Mandatory when skipper is added. Price is per night of the charter ( minimum value of 7 nights & a maximum value of 21 nights). Not applicable for 4+ weeks charters , nor Regattas/Races.	No	per night	<b>55,00 €</b>
<b>Early boarding/check-in</b> (Payable now) <b>Season: 2026.</b> Early boarding – 13:00h, starting time of boat's delivery // limited number of early boardings on same departure day	No	per booking	<b>300,00 €</b>

<b>Electric &amp; Water consumption in the Marinas</b> (Payable at the base)	No	per booking	<b>28,00 €</b>
<b>Season: 2026.</b> Electric & Water consumption based on 2 nights on our dock (base will confirm the amount to pay locally depending on nights spent on dock)			
<b>Extra cleaning</b> (Payable now)	No	per booking	<b>310,00 €</b>
<b>Season: 2026.</b> Optional Additional cleaning			
<b>Extra set of linen (choose how many)</b> (Payable now)	No	per booking	<b>15,00 €</b>
<b>Season: 2026.</b> Extra set of linen : 15 € 1 extra set of linen (2 sheets & 2 pillow case) - to be updated manually			
<b>Extra set of towels (choose how many)</b> (Payable now)	No	per booking	<b>10,00 €</b>
<b>Season: 2026.</b> Extra set of towels: 10 € 1 extra set of towels (1 face & 1 bath towel) - to be updated manually			
<b>Full board 1-3 pax (number of guests to update manually)</b> (Payable now)	No	per guest/day	<b>75,00 €</b>
<b>Season: 2026.</b> only available if cook is booked on board as the cook will do the provisioning based on client's preference. Includes breakfast, lunch & dinner + the crew's food. Does not included alcoholic drinks			
<b>Full board 4-6 pax (number of guests to update manually)</b> (Payable now)	No	per guest/day	<b>60,00 €</b>
<b>Season: 2026.</b> only available if cook is booked on board as the cook will do the provisioning based on client's preference. Includes breakfast, lunch & dinner + the crew's food. Does not included alcoholic drinks			
<b>Full board 7-12 pax (number of guests to update manually)</b> (Payable now)	No	per guest/day	<b>55,00 €</b>
<b>Season: 2026.</b> only available if cook is booked on board as the cook will do the provisioning based on client's preference. Includes breakfast, lunch & dinner + the crew's food. Does not included alcoholic drinks			
<b>Half board 1-3 pax (number of guests to update manually)</b> (Payable now)	No	per guest/day	<b>60,00 €</b>
<b>Season: 2026.</b> only available if cook is booked on board as the cook will do the provisioning based on client's preference. Includes breakfast & lunch OR dinner + the crew's food. Does not included alcoholic drinks			
<b>Half board 4-6 pax (number of guests to update manually)</b> (Payable now)	No	per guest/day	<b>50,00 €</b>
<b>Season: 2026.</b> only available if cook is booked on board as the cook will do the provisioning based on client's preference. Includes breakfast & lunch OR dinner + the crew's food. Does not included alcoholic drinks			
<b>Half board 7-12 pax (number of guests to update manually)</b> (Payable now)	No	per guest/day	<b>45,00 €</b>
<b>Season: 2026.</b> only available if cook is booked on board as the cook will do the provisioning based on client's preference. Includes breakfast & lunch OR dinner + the crew's food. Does not included alcoholic drinks			

<p><b>Hostess/Cook</b> (Payable at the base)</p> <p><b>Season: 2026.</b> + provisioning, Crew on board must have their own toilets/showers. If either a skipper or a hostess/cook is on board, 1 double cabin will be required for him/her. If both a skipper and a hostess/cook are on board, 1 double cabin and 1 forepeak cabin will be required for them. Exceptions exists for specific layouts, Sales Agents will provide more details about the different boat models // In Italy, law requires clients to pay hostess directly with a contract established between both parties</p>	No	per night	<b>170,00 €</b>
<p><b>Hostess/Cook</b> (Payable at the base)</p> <p><b>Season: 2026.</b> + provisioning, Crew on board must have their own toilets/showers. If either a skipper or a hostess/cook is on board, 1 double cabin will be required for him/her. If both a skipper and a hostess/cook are on board, 1 double cabin and 1 forepeak cabin will be required for them. Exceptions exists for specific layouts, Sales Agents will provide more details about the different boat models // In Italy, law requires clients to pay hostess directly with a contract established between both parties</p>	No	per night	<b>170,00 €</b>
<p><b>Hostess/Cook</b> (Payable at the base)</p> <p><b>Season: 2026.</b> + provisioning, Crew on board must have their own toilets/showers. If either a skipper or a hostess/cook is on board, 1 double cabin will be required for him/her. If both a skipper and a hostess/cook are on board, 1 double cabin and 1 forepeak cabin will be required for them. Exceptions exists for specific layouts, Sales Agents will provide more details about the different boat models // In Italy, law requires clients to pay hostess directly with a contract established between both parties</p>	No	per night	<b>185,00 €</b>
<p><b>Regatta surcharge</b> (Payable now)</p> <p><b>Season: 2026.</b> A special race deposit need to be doubled manually once the regatta surcharge is added.</p>	No	per booking	<b>0,00 €</b>
<p><b>Skipper</b> (Payable at the base)</p> <p><b>Season: 2026.</b> + provisioning, Crew on board must have their own toilets/showers. If either a skipper or a hostess/cook is on board, 1 double cabin will be required for him/her. If both a skipper and a hostess/cook are on board, 1 double cabin and 1 forepeak cabin will be required for them. Exceptions exists for specific layouts, Sales Agents will provide more details about the different boat models // In Italy, law requires clients to pay skipper directly with a contract established between both parties</p>	No	per night	<b>185,00 €</b>

**Skipper (Payable at the base)** No per night **185,00 €**

**Season: 2026.** + provisioning, Crew on board must have their own toilets/showers. If either a skipper or a hostess/cook is on board, 1 double cabin will be required for him/her. If both a skipper and a hostess/cook are on board, 1 double cabin and 1 forepeak cabin will be required for them. Exceptions exists for specific layouts, Sales Agents will provide more details about the different boat models // In Italy, law requires clients to pay skipper directly with a contract established between both parties

**Skipper (Payable at the base)** No per night **205,00 €**

**Season: 2026.** + provisioning, Crew on board must have their own toilets/showers. If either a skipper or a hostess/cook is on board, 1 double cabin will be required for him/her. If both a skipper and a hostess/cook are on board, 1 double cabin and 1 forepeak cabin will be required for them. Exceptions exists for specific layouts, Sales Agents will provide more details about the different boat models // In Italy, law requires clients to pay skipper directly with a contract established between both parties

**Transfer (Payable now)** No round trip **156,00 €**

**Season: 2026.** RT - Napoli Airport / Base / Airport 1-4 pax. For transfers during hours 00:00h-06:00h, price should be raised by 25€ one-way, or 50€ round trip.

**Transfer (Payable now)** No round trip **182,00 €**

**Season: 2026.** RT - Napoli Airport / Base / Airport 5-7 pax. For transfers during hours 00:00h-06:00h, price should be raised by 25€ one-way, or 50€ round trip.

**Transfer (Payable now)** No round trip **208,00 €**

**Season: 2026.** RT - Napoli Airport / Base / Airport 8 pax. For transfers during hours 00:00h-06:00h, price should be raised by 25€ one-way, or 50€ round trip.



**WEBSITE**

[www.plujeme.cz](http://www.plujeme.cz)



**PHONE**

+420 720 755 085



**MOBILE**

+420 777 170 276



**E-MAIL**

[info@plujeme.cz](mailto:info@plujeme.cz)



**PLUJEME RÁDI S.R.O.**

Dlouhá 730/35, 11000 Praha 1 – Staré Město, Czech Republic

## ADDITIONAL EXTRAS

EXTRA	OBLIGATORY	PAYMENT TYPE	PRICE
<b>Kayak single</b> (Payable now) <b>Season: 2026.</b> Price per day - Payable now	No	per night	<b>15,00 €</b>
<b>Outboard engine 8 &amp; 9,8 HP</b> (Payable now) <b>Season: 2026.</b> Subject to Availability ; 8 & 9.8hp. Dinghy not suitable in any case for waterski or wakeboard. - Payable now	No	per day	<b>35,00 €</b>
<b>Railing net (Safety net)</b> (Payable now) <b>Season: 2026.</b> net is supplied but not installed - Payable now	No	per booking	<b>250,00 €</b>
<b>Stand up paddle (SUP)</b> (Payable now) <b>Season: 2026.</b> Price per day - Payable now	No	per night	<b>15,00 €</b>

**WEBSITE**[www.plujeme.cz](http://www.plujeme.cz)**E-MAIL**[info@plujeme.cz](mailto:info@plujeme.cz)**PHONE**

+420 720 755 085

**MOBILE**

+420 777 170 276

**PLUJEME RÁDI S.R.O.**

Dlouhá 730/35, 11000 Praha 1 – Staré Město, Czech Republic

## PRICE AND AVAILABILITY

11.07. - 18.07.2026 NOT AVAILABLE	18.07. - 25.07.2026 NOT AVAILABLE	25.07. - 01.08.2026 8.347 € 9.820 €	01.08. - 08.08.2026 NOT AVAILABLE
08.08. - 15.08.2026 10.183 € 11.980 €	15.08. - 22.08.2026 NOT AVAILABLE	22.08. - 29.08.2026 NOT AVAILABLE	29.08. - 05.09.2026 5.316 € 6.645 €
05.09. - 12.09.2026 7.055 € 8.370 €	12.09. - 19.09.2026 NOT AVAILABLE	19.09. - 26.09.2026 NOT AVAILABLE	26.09. - 03.10.2026 4.478 € 4.975 €
03.10. - 10.10.2026 3.600 € 4.000 €	10.10. - 17.10.2026 3.456 € 3.840 €	17.10. - 24.10.2026 3.258 € 3.620 €	24.10. - 31.10.2026 3.092 € 3.435 €
31.10. - 07.11.2026 3.092 € 3.435 €	07.11. - 14.11.2026 3.092 € 3.435 €	20.11. - 12.03.2027 NOT AVAILABLE	



### WEBSITE

[www.plujeme.cz](http://www.plujeme.cz)



### E-MAIL

[info@plujeme.cz](mailto:info@plujeme.cz)



### PHONE

+420 720 755 085



### MOBILE

+420 777 170 276



### PLUJEME RÁDI S.R.O.

Dlouhá 730/35, 11000 Praha 1 – Staré Město, Czech Republic

## PRICE AND AVAILABILITY

13.03. - 20.03.2027 2.945 € 3.100 €	20.03. - 27.03.2027 3.387 € 3.565 €	27.03. - 03.04.2027 3.387 € 3.565 €	03.04. - 10.04.2027 2.945 € 3.100 €
10.04. - 17.04.2027 3.615 € 3.805 €	17.04. - 24.04.2027 3.819 € 4.020 €	24.04. - 01.05.2027 4.023 € 4.235 €	01.05. - 08.05.2027 4.608 € 4.850 €
08.05. - 15.05.2027 5.111 € 5.380 €	15.05. - 22.05.2027 5.496 € 5.785 €	22.05. - 29.05.2027 6.726 € 7.080 €	29.05. - 05.06.2027 6.907 € 7.270 €
05.06. - 12.06.2027 7.548 € 7.945 €	12.06. - 19.06.2027 8.037 € 8.460 €	19.06. - 26.06.2027 9.144 € 9.625 €	26.06. - 03.07.2027 9.890 € 10.410 €
03.07. - 10.07.2027 10.764 € 11.330 €	10.07. - 17.07.2027 11.305 € 11.900 €	17.07. - 24.07.2027 12.003 € 12.635 €	24.07. - 31.07.2027 12.740 € 13.410 €
31.07. - 07.08.2027 14.150 € 14.895 €	07.08. - 14.08.2027 14.150 € 14.895 €	14.08. - 21.08.2027 12.697 € 13.365 €	21.08. - 28.08.2027 9.847 € 10.365 €
28.08. - 04.09.2027 8.659 € 9.115 €	04.09. - 11.09.2027 8.574 € 9.025 €	11.09. - 18.09.2027 7.714 € 8.120 €	18.09. - 25.09.2027 7.125 € 7.500 €
25.09. - 02.10.2027 6.489 € 6.830 €	02.10. - 09.10.2027 4.850 € 5.105 €	09.10. - 16.10.2027 3.857 € 4.060 €	16.10. - 23.10.2027 3.700 € 3.895 €
23.10. - 30.10.2027 3.263 € 3.435 €	30.10. - 06.11.2027 3.263 € 3.435 €		



WEBSITE  
[www.plujeme.cz](http://www.plujeme.cz)



E-MAIL  
[info@plujeme.cz](mailto:info@plujeme.cz)



PHONE  
+420 720 755 085



MOBILE  
+420 777 170 276



PLUJEME RÁDI S.R.O.  
Dlouhá 730/35, 11000 Praha 1 – Staré Město, Czech Republic

## PRICE AND AVAILABILITY

06.11. - 13.11.2027

**3.263 €** 3.435 €

13.11. - 20.11.2027

**3.263 €** 3.435 €

20.11. - 27.11.2027

**3.263 €** 3.435 €

27.11. - 04.12.2027

**3.263 €** 3.435 €

04.12. - 11.12.2027

**3.263 €** 3.435 €

11.12. - 18.12.2027

**3.263 €** 3.435 €

18.12. - 25.12.2027

**3.263 €** 3.435 €



### WEBSITE

[www.plujeme.cz](http://www.plujeme.cz)



### E-MAIL

[info@plujeme.cz](mailto:info@plujeme.cz)



### PHONE

+420 720 755 085



### MOBILE

+420 777 170 276



### PLUJEME RÁDI S.R.O.

Dlouhá 730/35, 11000 Praha 1 – Staré Město, Czech Republic