

LAGOON 42

ELENA (2025)

Catamaran Lagoon 42 ELENA, built in 2025 is anchored in the Sicily, Portorosa, Sicily, Italy. It has 4 + 2 cabins, can accommodate 8 + 2 + 2 people and has 4 toilets. Bed linen and kitchen equipment are included in the price.

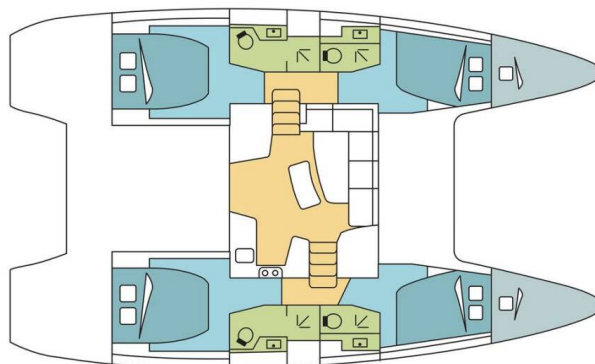

YACHT SPECIFICATIONS

Yacht Base

Sicily, Portorosa, Italy

Yacht ID

14270

Brands

Lagoon

Yacht name

ELENA

Production year

2025

Length

42 ft

Cabins

4 + 2

Berths

8 + 2 + 2

Max Persons

12

WC

4

Engine

2 x 57 HP

Fuel tank

600 l



WEBSITE

www.plujeme.cz



PHONE

+420 720 755 085



MOBILE

+420 777 170 276



E-MAIL

info@plujeme.cz



PLUJEME RÁDI S.R.O.

Dlouhá 730/35, 11000 Praha 1 – Staré Město, Czech Republic

STANDARD YACHT EQUIPMENT

Deck	Anchor with chain, Bimini top, Dinghy, Outboard engine, Pulpit seat, Seats for aft bench
Entertainment	Fusion radio
Galley	Additional fridge, Kitchen utensils (Galley equipment, cutlery), Oven, Refrigerator, Stove, Water pump
Interior	Convertible table in salon, Curtains, Electric fans in cabins, Electric toilet, Indirect lighting in cabins and salon, Upholstery, Water Purifier
Navigation	AIS, Autopilot, GPS chart plotter, Wind/speed/depth instruments
Safety	VHF radio
Sails	Lazy bag, Lazy jacks, Self tailing (manual) winch
Yacht electrics	Air Conditioning, Battery charger, Inverter, Service batteries, Solar panels, USB sockets, Watermaker - desalinator



WEBSITE

www.plujeme.cz



E-MAIL

info@plujeme.cz



PHONE

+420 720 755 085



MOBILE

+420 777 170 276



PLUJEME RÁDI S.R.O.

Dlouhá 730/35, 11000 Praha 1 – Staré Město, Czech Republic

SERVICES

SELECTED SERVICES	OBLIGATORY	PAYMENT TYPE	PRICE
Handling fees (Payable now) Season: 2026.	Yes	per booking	25,00 €
Preparation fee (Payable now) Season: 2026. INCLUDED: starter pack – (1 gallon water or 4 bottles of 1.5L, 1 bottle of disinfectant, 1 small bottle of washing up liquid, 1 dish cloth, 1 sponge, garbage bags, 1 roll of paper towels, 1 box of matches, 1 roll of toilet paper in each head) // final cleaning // 1 set of bed sheets / cabin & 1 set of towels / pax, dinghy, outboard engine & initial supply of fuel, gas and water tanks // DYC assistance guarantee // 1st & last night in the marina // NOT INCLUDED: refuelling, gas & water consumption at end of charter, taxes if any, handling fees & additional equipment deposit.	Yes	per booking	380,00 €
Additional fee for Skipper in forepeak & shared bathroom (Payable at the base) Season: 2026. To be added with Skipper only ; Can be added for new bookings only confirmed after 21/05/2026 ; replaces skipper requirement to have their own toilet/shower. Guests must be aware that they'll need to give access to toilet/shower.	No	per night	50,00 €
Crew change (Payable now) Season: 2026. Any crew change during the charter is subject to € 250.- additional cost. The charge includes administration cost, change of bed linen and towels and one night at DYC ponton (marina fee included only if the same base than start base). It doesn't include cleaning, nor new transit log where applicable.	No	per booking	250,00 €
Damage waiver (Payable now) Season: 2026. Damage waiver limits your liability to the reduced Security Deposit . Mandatory when skipper is added. Price is per night of the charter (minimum value of 7 nights & a maximum value of 21 nights). Not applicable for 4+ weeks charters , nor Regattas/Races.	No	per night	55,00 €
Early boarding/check-in (Payable now) Season: 2026. Early boarding – 13:00h, starting time of boat's delivery // limited number of early boardings on same departure day	No	per booking	300,00 €

Electric & Water consumption in the Marinas (Payable at the base)	No	per booking	28,00 €
Season: 2026. Electric & Water consumption based on 2 nights on our dock (base will confirm the amount to pay locally depending on nights spent on dock)			
Extra cleaning (Payable now)	No	per booking	310,00 €
Season: 2026. Optional Additional cleaning			
Extra set of linen (choose how many) (Payable now)	No	per booking	15,00 €
Season: 2026. Extra set of linen : 15 € 1 extra set of linen (2 sheets & 2 pillow case) - to be updated manually			
Extra set of towels (choose how many) (Payable now)	No	per booking	10,00 €
Season: 2026. Extra set of towels: 10 € 1 extra set of towels (1 face & 1 bath towel) - to be updated manually			
Full board 1-3 pax (number of guests to update manually) (Payable now)	No	per guest/day	75,00 €
Season: 2026. only available if cook is booked on board as the cook will do the provisioning based on client's preference. Includes breakfast, lunch & dinner + the crew's food. Does not included alcoholic drinks			
Full board 4-6 pax (number of guests to update manually) (Payable now)	No	per guest/day	60,00 €
Season: 2026. only available if cook is booked on board as the cook will do the provisioning based on client's preference. Includes breakfast, lunch & dinner + the crew's food. Does not included alcoholic drinks			
Full board 7-12 pax (number of guests to update manually) (Payable now)	No	per guest/day	55,00 €
Season: 2026. only available if cook is booked on board as the cook will do the provisioning based on client's preference. Includes breakfast, lunch & dinner + the crew's food. Does not included alcoholic drinks			
Half board 1-3 pax (number of guests to update manually) (Payable now)	No	per guest/day	60,00 €
Season: 2026. only available if cook is booked on board as the cook will do the provisioning based on client's preference. Includes breakfast & lunch OR dinner + the crew's food. Does not included alcoholic drinks			
Half board 4-6 pax (number of guests to update manually) (Payable now)	No	per guest/day	50,00 €
Season: 2026. only available if cook is booked on board as the cook will do the provisioning based on client's preference. Includes breakfast & lunch OR dinner + the crew's food. Does not included alcoholic drinks			
Half board 7-12 pax (number of guests to update manually) (Payable now)	No	per guest/day	45,00 €
Season: 2026. only available if cook is booked on board as the cook will do the provisioning based on client's preference. Includes breakfast & lunch OR dinner + the crew's food. Does not included alcoholic drinks			

<p>Hostess/Cook (Payable at the base)</p> <p>Season: 2026. + provisioning, Crew on board must have their own toilets/showers. If either a skipper or a hostess/cook is on board, 1 double cabin will be required for him/her. If both a skipper and a hostess/cook are on board, 1 double cabin and 1 forepeak cabin will be required for them. Exceptions exists for specific layouts, Sales Agents will provide more details about the different boat models // In Italy, law requires clients to pay hostess directly with a contract established between both parties</p>	No	per night	170,00 €
<p>Hostess/Cook (Payable at the base)</p> <p>Season: 2026. + provisioning, Crew on board must have their own toilets/showers. If either a skipper or a hostess/cook is on board, 1 double cabin will be required for him/her. If both a skipper and a hostess/cook are on board, 1 double cabin and 1 forepeak cabin will be required for them. Exceptions exists for specific layouts, Sales Agents will provide more details about the different boat models // In Italy, law requires clients to pay hostess directly with a contract established between both parties</p>	No	per night	170,00 €
<p>Hostess/Cook (Payable at the base)</p> <p>Season: 2026. + provisioning, Crew on board must have their own toilets/showers. If either a skipper or a hostess/cook is on board, 1 double cabin will be required for him/her. If both a skipper and a hostess/cook are on board, 1 double cabin and 1 forepeak cabin will be required for them. Exceptions exists for specific layouts, Sales Agents will provide more details about the different boat models // In Italy, law requires clients to pay hostess directly with a contract established between both parties</p>	No	per night	185,00 €
<p>Regatta surcharge (Payable now)</p> <p>Season: 2026. A special race deposit need to be doubled manually once the regatta surcharge is added.</p>	No	per booking	0,00 €
<p>Skipper (Payable at the base)</p> <p>Season: 2026. + provisioning, Crew on board must have their own toilets/showers. If either a skipper or a hostess/cook is on board, 1 double cabin will be required for him/her. If both a skipper and a hostess/cook are on board, 1 double cabin and 1 forepeak cabin will be required for them. Exceptions exists for specific layouts, Sales Agents will provide more details about the different boat models // In Italy, law requires clients to pay skipper directly with a contract established between both parties</p>	No	per night	185,00 €

Skipper (Payable at the base)	No	per night	185,00 €
Season: 2026. + provisioning, Crew on board must have their own toilets/showers. If either a skipper or a hostess/cook is on board, 1 double cabin will be required for him/her. If both a skipper and a hostess/cook are on board, 1 double cabin and 1 forepeak cabin will be required for them. Exceptions exists for specific layouts, Sales Agents will provide more details about the different boat models // In Italy, law requires clients to pay skipper directly with a contract established between both parties			
Skipper (Payable at the base)	No	per night	205,00 €
Season: 2026. + provisioning, Crew on board must have their own toilets/showers. If either a skipper or a hostess/cook is on board, 1 double cabin will be required for him/her. If both a skipper and a hostess/cook are on board, 1 double cabin and 1 forepeak cabin will be required for them. Exceptions exists for specific layouts, Sales Agents will provide more details about the different boat models // In Italy, law requires clients to pay skipper directly with a contract established between both parties			
Transfer (Payable now)	No	one-way	270,00 €
Season: 2026. OW - Catania Airport / Base / Airport 1 - 3 pax			
Transfer (Payable now)	No	one-way	310,00 €
Season: 2026. OW - Palermo Airport / Base Airport 1 - 3 pax			
Transfer (Payable now)	No	one-way	310,00 €
Season: 2026. OW -Catania Airport / Base / Airport 4 - 8 pax			
Transfer (Payable now)	No	one-way	340,00 €
Season: 2026. OW -Palermo Airport / Base / Airport 4 - 8 pax			
Transfer (Payable now)	No	round trip	490,00 €
Season: 2026. RT- Catania Airport / Base / Airport 1 - 3 pax			
Transfer (Payable now)	No	round trip	570,00 €
Season: 2026. RT- Palermo Airport / Base Airport 1 - 3 pax			
Transfer (Payable now)	No	round trip	570,00 €
Season: 2026. RT-Catania Airport / Base / Airport 4 - 8 pax			
Transfer (Payable now)	No	round trip	630,00 €
Season: 2026. RT-Palermo Airport / Base / Airport 4 - 8 pax			



 **WEBSITE**
www.plujeme.cz

 **E-MAIL**
info@plujeme.cz

 **PHONE**
+420 720 755 085

 **PLUJEME RÁDI S.R.O.**
Dlouhá 730/35, 11000 Praha 1 – Staré Město, Czech Republic

 **MOBILE**
+420 777 170 276

ADDITIONAL EXTRAS

EXTRA	OBLIGATORY	PAYMENT TYPE	PRICE
Kayak single (Payable now) Season: 2026. Price per day - Payable now	No	per night	15,00 €
Outboard engine 8 & 9,8 HP (Payable now) Season: 2026. Subject to Availability ; 8 & 9.8hp. Dinghy not suitable in any case for waterski or wakeboard. - Payable now	No	per day	35,00 €
Railing net (Safety net) (Payable now) Season: 2026. net is supplied but not installed - Payable now	No	per booking	250,00 €
Stand up paddle (SUP) (Payable now) Season: 2026. Price per day - Payable now	No	per night	15,00 €

**WEBSITE**www.plujeme.cz**E-MAIL**info@plujeme.cz**PHONE**

+420 720 755 085

**MOBILE**

+420 777 170 276

**PLUJEME RÁDI S.R.O.**

Dlouhá 730/35, 11000 Praha 1 – Staré Město, Czech Republic

PRICE AND AVAILABILITY

11.07. - 18.07.2026 NOT AVAILABLE	18.07. - 25.07.2026 4.991 € 6.655 €	25.07. - 01.08.2026 7.865 €	01.08. - 15.08.2026 NOT AVAILABLE
15.08. - 22.08.2026 NOT AVAILABLE	22.08. - 29.08.2026 NOT AVAILABLE	29.08. - 05.09.2026 5.240 € 6.550 €	05.09. - 12.09.2026 NOT AVAILABLE
12.09. - 19.09.2026 5.932 € 7.415 €	19.09. - 26.09.2026 NOT AVAILABLE	26.09. - 03.10.2026 5.769 € 6.410 €	03.10. - 10.10.2026 4.156 € 5.195 €
10.10. - 17.10.2026 3.220 € 4.025 €	17.10. - 24.10.2026 2.884 € 3.605 €	24.10. - 31.10.2026 2.656 € 3.320 €	31.10. - 07.11.2026 2.416 € 3.020 €
07.11. - 14.11.2026 2.416 € 3.020 €	20.11. - 12.03.2027 NOT AVAILABLE		



WEBSITE

www.plujeme.cz



E-MAIL

info@plujeme.cz



PHONE

+420 720 755 085



MOBILE

+420 777 170 276



PLUJEME RÁDI S.R.O.

Dlouhá 730/35, 11000 Praha 1 – Staré Město, Czech Republic

PRICE AND AVAILABILITY

13.03. - 20.03.2027 2.817 € 2.965 €	20.03. - 27.03.2027 3.235 € 3.405 €	27.03. - 03.04.2027 3.235 € 3.405 €	03.04. - 10.04.2027 3.292 € 3.465 €
10.04. - 17.04.2027 3.339 € 3.515 €	17.04. - 24.04.2027 3.430 € 3.610 €	24.04. - 01.05.2027 4.285 € 4.510 €	01.05. - 08.05.2027 4.584 € 4.825 €
08.05. - 15.05.2027 5.121 € 5.390 €	15.05. - 22.05.2027 5.881 € 6.190 €	22.05. - 29.05.2027 7.405 € 7.795 €	29.05. - 05.06.2027 7.405 € 7.795 €
05.06. - 12.06.2027 NOT AVAILABLE	12.06. - 19.06.2027 8.365 € 8.805 €	19.06. - 26.06.2027 8.365 € 8.805 €	26.06. - 03.07.2027 9.714 € 10.225 €
03.07. - 10.07.2027 10.222 € 10.760 €	10.07. - 17.07.2027 10.854 € 11.425 €	17.07. - 24.07.2027 12.056 € 12.690 €	24.07. - 31.07.2027 12.094 € 12.730 €
31.07. - 07.08.2027 13.433 € 14.140 €	07.08. - 14.08.2027 13.433 € 14.140 €	14.08. - 21.08.2027 12.094 € 12.730 €	21.08. - 28.08.2027 8.944 € 9.415 €
28.08. - 04.09.2027 7.515 € 7.910 €	04.09. - 11.09.2027 7.828 € 8.240 €	11.09. - 18.09.2027 7.320 € 7.705 €	18.09. - 25.09.2027 6.061 € 6.380 €
25.09. - 02.10.2027 5.315 € 5.595 €	02.10. - 09.10.2027 4.850 € 5.105 €	09.10. - 16.10.2027 4.185 € 4.405 €	16.10. - 23.10.2027 3.857 € 4.060 €
23.10. - 30.10.2027 3.506 € 3.690 €	30.10. - 06.11.2027 3.187 € 3.355 €		



WEBSITE
www.plujeme.cz



E-MAIL
info@plujeme.cz



PHONE
+420 720 755 085



MOBILE
+420 777 170 276



PLUJEME RÁDI S.R.O.
Dlouhá 730/35, 11000 Praha 1 – Staré Město, Czech Republic

PRICE AND AVAILABILITY

06.11. - 13.11.2027

3.187 € 3.355 €

13.11. - 20.11.2027

3.187 € 3.355 €

20.11. - 27.11.2027

3.187 € 3.355 €

27.11. - 04.12.2027

3.187 € 3.355 €

04.12. - 11.12.2027

3.187 € 3.355 €

11.12. - 18.12.2027

3.187 € 3.355 €

18.12. - 25.12.2027

3.187 € 3.355 €



WEBSITE

www.plujeme.cz



E-MAIL

info@plujeme.cz



PHONE

+420 720 755 085



MOBILE

+420 777 170 276



PLUJEME RÁDI S.R.O.

Dlouhá 730/35, 11000 Praha 1 – Staré Město, Czech Republic