

HANSE 400

Flyer Of Lorne (2006)

Sailing yacht Hanse 400 Flyer Of Lorne, built in 2006 is anchored in the **Kos, Kos Marina, Dodecanese, Greece**. It has **3 cabins**, can accommodate **6 + 2 people** and has **2 toilets**. Bed linen and kitchen equipment are included in the price.

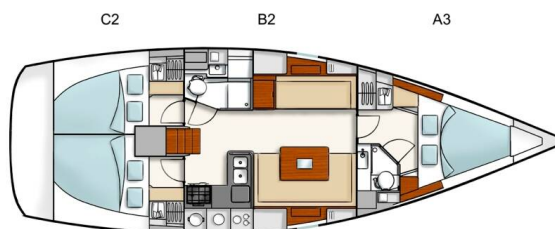

YACHT SPECIFICATIONS

Yacht Base

Kos, Kos Marina, Greece

Yacht ID

142

Brands

Hanse Yachts

Yacht name

Flyer Of Lorne

Production year

2006

Length

40 ft

Cabins

3

Berths

6 + 2

WC

2

Engine

1 x 40 HP

Fuel tank

140 l



WEBSITE

www.plujeme.cz



PHONE

+420 720 755 085



MOBILE

+420 777 170 276



E-MAIL

info@plujeme.cz



PLUJEME RÁDI S.R.O.

Dlouhá 730/35, 11000 Praha 1 – Staré Město, Czech Republic

STANDARD YACHT EQUIPMENT

Comfort	Cockpit cushions, Outside cushions
Deck	Anchor with chain, Bathing platform, Bimini top, Black ball, Boat hook, Cockpit table, Dinghy, Dinghy with outboard engine, Fenders, Outboard engine, Spare anchor (Reserve, Auxiliary anchor), Sprayhood, Swimming ladder, Water hose, Winch handles
Entertainment	Radio CD player, USB, AUX input, Radio CD player, USB, Bluetooth, Snorkeling equipment, USB
Galley	Gas cookers, Hot water, Kitchen utensils (Galley equipment, cutlery), Refrigerator, Stove
Interior	Barometer, Electric fans in cabins, Electric toilet
Navigation	Autopilot, Binoculars, Echosounder/Depthsonder, Electronic sea charts, Flexofold propeller, GPS, GPS chart plotter, GPS chart plotter - cockpit, Hand bearing compass, Log, Speed, Depth-echo sounder, Log/speed instrument, Nautical charts, Pilot book, Wind instrument/Anemometer
Safety	Distress flare box, Emergency tiller, EPIRB-Distress radio beacons, Fire extinguisher, First aid kit, Flags QNC, Fog horn, Life belts (Safety harness), Life buoy + Flashing light, Life jackets, Liferaft, Torch, VHF radio, Wire (shroud) cutter
Sails	Lazy bag, Lazy jacks
Yacht electrics	220V socket, Battery charger, Shore connection 220 V, Solar panels, USB charger for mobile phone and laptop, USB sockets



WEBSITE

www.plujeme.cz



PHONE

+420 720 755 085



MOBILE

+420 777 170 276



E-MAIL

info@plujeme.cz



PLUJEME RÁDI S.R.O.

Dlouhá 730/35, 11000 Praha 1 – Staré Město, Czech Republic

SERVICES

SELECTED SERVICES	OBLIGATORY	PAYMENT TYPE	PRICE
Security Deposit Waiver (Payable at the base) Season: 2026. 150 EUR credit voucher for the next charter in case of no damage/loss upon redelivery. No cash refund.	Yes	per booking	350,00 €
Standard Charter Pack (Payable at the base) Season: 2026. Welcome kit	Yes	per booking	170,00 €
Beach towel (Payable at the base) Season: 2026.	No	per booking	10,00 €
Berth cost (Payable at the base) Season: 2026. Berthing fees for first & last night at the marina/port	No	per booking	0,00 €
Cabin conversion (Payable at the base) Season: 2026. If possible on yacht. Contact fleet operator for more information.	No	per booking	150,00 €
Cook (Payable at the base) Season: 2026. Crew provisioning to be provided by Charterer in arrangement with crew. If monetary compensation shall be agreed, then it shall be of no less than €30 per crew member per day. Charterer shall provide crew with sleeping cabin/berth and shower/toilet use to be designated to them onboard.	No	per day + food	215,00 €
Hostess (Payable at the base) Season: 2026. Crew provisioning to be provided by Charterer in arrangement with crew. If monetary compensation shall be agreed, then it shall be of no less than €30 per crew member per day. Charterer shall provide crew with sleeping cabin/berth and shower/toilet use to be designated to them onboard.	No	per day + food	180,00 €
One way fee (Payable at the base) Season: 2026. Athens-Lavrion	No	per booking	500,00 €
One way fee (Payable at the base) Season: 2026. Athens-Cyclades/Sporades	No	per booking	1.000,00 €
One way fee (Payable at the base) Season: 2026. Athens-Dodecanese	No	per booking	1.200,00 €

Stand up paddle (SUP) (Payable at the base)

No

per week

100,00 €

Season: 2026.

VIP Pack (Payable at the base)

No

per booking

300,00 €

Season: 2026. Airport/Local Base welcome & pickup, transfer to the yacht, welcome pack with sparkling wine & fruits, departure transfer to the local airport



WEBSITE

www.plujeme.cz



E-MAIL

info@plujeme.cz



PHONE

+420 720 755 085



MOBILE

+420 777 170 276



PLUJEME RÁDI S.R.O.

Dlouhá 730/35, 11000 Praha 1 – Staré Město, Czech Republic

ADDITIONAL EXTRAS

EXTRA	OBLIGATORY	PAYMENT TYPE	PRICE
Beach towel (Payable at the base) Season: 2026. Payable at the base	No	per piece	10,00 €
Blister (Payable at the base) Season: 2026. + extra security deposit 500 EUR (refundable) - Payable at the base	No	per week	200,00 €
Extra bedlinen (Payable at the base) Season: 2026. Payable at the base	No	per set	10,00 €
Kayak (Payable at the base) Season: 2026. Payable at the base	No	per week	100,00 €
Railing net (Safety net) (Payable at the base) Season: 2026. installed - Payable at the base	No	per booking	200,00 €
Stand up paddle (SUP) (Payable at the base) Season: 2026. Payable at the base	No	per week	100,00 €

**WEBSITE**www.plujeme.cz**E-MAIL**info@plujeme.cz**PHONE**

+420 720 755 085

**MOBILE**

+420 777 170 276

**PLUJEME RÁDI S.R.O.**

Dlouhá 730/35, 11000 Praha 1 – Staré Město, Czech Republic

PRICE AND AVAILABILITY

13.06. - 27.06.2026 NOT AVAILABLE	27.06. - 11.07.2026 NOT AVAILABLE	11.07. - 18.07.2026 2.295 € 2.700 €	18.07. - 25.07.2026 2.295 € 2.700 €
25.07. - 01.08.2026 2.295 € 2.700 €	01.08. - 08.08.2026 2.890 € 3.400 €	08.08. - 15.08.2026 2.890 € 3.400 €	15.08. - 29.08.2026 NOT AVAILABLE
29.08. - 12.09.2026 NOT AVAILABLE	12.09. - 19.09.2026 NOT AVAILABLE	19.09. - 10.10.2026 NOT AVAILABLE	10.10. - 17.10.2026 1.800 € 2.000 €
17.10. - 31.12.2026 NOT AVAILABLE			



WEBSITE

www.plujeme.cz



E-MAIL

info@plujeme.cz



PHONE

+420 720 755 085



MOBILE

+420 777 170 276



PLUJEME RÁDI S.R.O.

Dlouhá 730/35, 11000 Praha 1 – Staré Město, Czech Republic

PRICE AND AVAILABILITY

02.01. - 09.01.2027 1.395 € 1.550 €	09.01. - 16.01.2027 1.395 € 1.550 €	16.01. - 23.01.2027 1.395 € 1.550 €	23.01. - 30.01.2027 1.395 € 1.550 €
30.01. - 06.02.2027 1.395 € 1.550 €	06.02. - 13.02.2027 1.395 € 1.550 €	13.02. - 20.02.2027 1.395 € 1.550 €	20.02. - 27.02.2027 1.395 € 1.550 €
27.02. - 06.03.2027 1.395 € 1.550 €	06.03. - 13.03.2027 1.395 € 1.550 €	13.03. - 20.03.2027 1.395 € 1.550 €	20.03. - 27.03.2027 1.395 € 1.550 €
27.03. - 03.04.2027 1.395 € 1.550 €	03.04. - 10.04.2027 1.395 € 1.550 €	10.04. - 17.04.2027 1.395 € 1.550 €	17.04. - 24.04.2027 1.395 € 1.550 €
24.04. - 01.05.2027 1.395 € 1.550 €	01.05. - 08.05.2027 1.620 € 1.800 €	08.05. - 15.05.2027 1.620 € 1.800 €	15.05. - 22.05.2027 1.620 € 1.800 €
22.05. - 29.05.2027 2.250 € 2.500 €	29.05. - 05.06.2027 2.250 € 2.500 €	05.06. - 12.06.2027 2.250 € 2.500 €	12.06. - 19.06.2027 2.250 € 2.500 €
19.06. - 26.06.2027 2.430 € 2.700 €	26.06. - 03.07.2027 2.430 € 2.700 €	03.07. - 10.07.2027 2.430 € 2.700 €	10.07. - 17.07.2027 2.430 € 2.700 €
17.07. - 24.07.2027 2.430 € 2.700 €	24.07. - 31.07.2027 2.430 € 2.700 €	31.07. - 07.08.2027 3.060 € 3.400 €	07.08. - 14.08.2027 3.060 € 3.400 €
14.08. - 21.08.2027 3.060 € 3.400 €	21.08. - 28.08.2027 2.430 € 2.700 €	28.08. - 04.09.2027 2.430 € 2.700 €	



WEBSITE

www.plujeme.cz



E-MAIL

info@plujeme.cz



PHONE

+420 720 755 085



MOBILE

+420 777 170 276



PLUJEME RÁDI S.R.O.

Dlouhá 730/35, 11000 Praha 1 – Staré Město, Czech Republic

PRICE AND AVAILABILITY

04.09. - 11.09.2027 2.430 € 2.700 €	11.09. - 18.09.2027 2.340 € 2.600 €	18.09. - 25.09.2027 2.340 € 2.600 €	25.09. - 02.10.2027 1.800 € 2.000 €
02.10. - 09.10.2027 1.800 € 2.000 €	09.10. - 16.10.2027 1.800 € 2.000 €	16.10. - 23.10.2027 1.485 € 1.650 €	23.10. - 30.10.2027 1.485 € 1.650 €
30.10. - 06.11.2027 1.485 € 1.650 €	06.11. - 13.11.2027 1.485 € 1.650 €	13.11. - 20.11.2027 1.485 € 1.650 €	20.11. - 27.11.2027 1.485 € 1.650 €
27.11. - 04.12.2027 1.485 € 1.650 €	04.12. - 11.12.2027 1.485 € 1.650 €	11.12. - 18.12.2027 1.485 € 1.650 €	18.12. - 25.12.2027 1.485 € 1.650 €



WEBSITE

www.plujeme.cz



E-MAIL

info@plujeme.cz



PHONE

+420 720 755 085



MOBILE

+420 777 170 276



PLUJEME RÁDI S.R.O.

Dlouhá 730/35, 11000 Praha 1 – Staré Město, Czech Republic