

BALI CATSPACE

LUTH (2023)

Catamaran Bali Catspace LUTH, built in 2023 is anchored in the La Paz, Costa Baja Marina, Baja California Sur, Mexico. It has 4 cabins, can accommodate 8 + 2 people and has 4 toilets. Bed linen and kitchen equipment are included in the price.

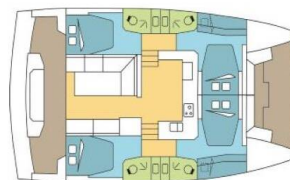

YACHT SPECIFICATIONS

Yacht Base

La Paz, Costa Baja Marina, Mexico

Yacht ID

14178

Brands

Catana

Yacht name

LUTH

Production year

2023

Length

40 ft

Cabins

4

Berths

8 + 2

Max Persons

12

WC

4

Engine

2 x 40 HP

Fuel tank

400 l



WEBSITE

www.plujeme.cz



PHONE

+420 720 755 085



MOBILE

+420 777 170 276



E-MAIL

info@plujeme.cz



PLUJEME RÁDI S.R.O.

Dlouhá 730/35, 11000 Praha 1 – Staré Město, Czech Republic

STANDARD YACHT EQUIPMENT

Comfort	Cockpit cushions, Deck cushions, Mosquito nets
Deck	Bimini top, Cockpit table, Cockpit/stern, outside shower, Davit, Dinghy, Electric anchor windlass, Flybridge, Outboard engine, Remote control for anchor winch with chain counter at helm, Spring cleats, Swimming ladder
Entertainment	Fusion radio
Galley	Freezer, Oven, Water pump
Interior	Convertible table in salon, Electric fans in cabins, Electric toilet
Navigation	AIS, Autopilot, Depthsounder, GPS chart plotter, Helm station, Wind instrument/Anemometer
Safety	VHF radio
Sails	Electric main sail winch, Lazy bag, Lazy jacks
Yacht electrics	Battery charger, Inverter, Service batteries, Solar panels, Watermaker - desalinator



WEBSITE

www.plujeme.cz



PHONE

+420 720 755 085



MOBILE

+420 777 170 276



E-MAIL

info@plujeme.cz



PLUJEME RÁDI S.R.O.

Dlouhá 730/35, 11000 Praha 1 – Staré Město, Czech Republic

SERVICES

SELECTED SERVICES	OBLIGATORY	PAYMENT TYPE	PRICE
Environmental Sanitation Fee (Payable at the base) Season: 2026 Exotic. Municipal fee since January 1, 2026, created to finance environmental protection actions, waste managements & conservation of the municipality's natural environment. It applies to recreational or sports boat rental services operating within the municipality of La Paz	Yes	per day	3,04 €
Essentials pack (Payable now) Season: 2026 Exotic. INCLUDED: Damage waiver (covering damages) with reduced security deposit addressed specifically to blocked toilets, unpaid fuel, lost equipment, unpaid fees & fines, and returning the boat in an extremely dirty state. // starter pack – (1 gallon water or 4 bottles of 1.5L, 1 bottle of disinfectant, 1 small bottle of washing up liquid, 1 dish cloth, 1 sponge, garbage bags, 1 roll of paper towels, 1 box of matches, 1 roll of toilet paper in each head)// final cleaning // 1 set of bed sheets & towels, dinghy, outboard engine & initial supply of fuel, gas and water tanks // DYC assistance guarantee // 1st & last night in the marina /// NOT INCLUDED: refuelling, gas & water consumption at end of charter, taxes if any, handling fees & additional equipment deposit.	Yes	per booking	810,00 €
Handling fees (Payable now) Season: 2026 Exotic.	Yes	per booking	35,00 €
National parks permit (Payable at the base) Season: 2026 Exotic. Required for access to Balandra Bay and Espiritu Santo Island, as mandated by CONANP. Each guest must wear a wristband daily to comply with regulations.	Yes	per guest/night	8,00 €
Preparation fee (Payable now) Season: 2026 Exotic. INCLUDED: starter pack – (1 gallon water or 4 bottles of 1.5L, 1 bottle of disinfectant, 1 small bottle of washing up liquid, 1 dish cloth, 1 sponge, garbage bags, 1 roll of paper towels, 1 box of matches, 1 roll of toilet paper in each head)// final cleaning // 1 set of bed sheets / cabin & 1 set of towels / pax, dinghy, outboard engine & initial supply of fuel, gas and water tanks // DYC assistance guarantee // 1st & last night in the marina // NOT INCLUDED: refuelling, gas & water consumption at end of charter, taxes if any, handling fees & additional equipment deposit.	Yes	per booking	415,00 €

Crew change (Payable now) Season: 2026 Exotic. Any crew change during the charter is subject to € 250.- additional cost. The charge includes administration cost, change of bed linen and towels and one night at DYC ponton (marina fee included only if the same base than start base). It doesn't include cleaning, nor new transit log where applicable.	No	per booking	250,00 €
Damage waiver (Payable now) Season: 2026 Exotic. Damage waiver limits your liability to the reduced Security Deposit . Mandatory when skipper is added. Price is per night of the charter (minimum value of 7 nights & a maximum value of 21 nights) Not applicable for 4+ weeks charters , nor Regattas/Races.	No	per night	70,00 €
Early boarding/check-in (Payable now) Season: 2026 Exotic. EB (boat only) -14:00 h / 2 PM starting time of boat's delivery // limited number of early boardings on same departure day	No	per booking	450,00 €
Early boarding/check-in (Payable now) Season: 2026 Exotic. EB boat + extra fee skipper -14:00 h / 2 PM starting time of boat's delivery // limited number of early boardings on same departure day	No	per booking	620,00 €
Early boarding/check-in (Payable now) Season: 2026 Exotic. EB + extra fee Skipper & Hostes - 14:00 h / 2 PM starting time of boat's delivery // limited number of early boardings on same departure day	No	per booking	755,00 €
Electric & Water consumption in the Marinas (Payable at the base) Season: 2026 Exotic. Electric & Water consumption based on 2 nights on our dock (base will confirm the amount to pay locally depending on nights spent on dock)	No	per booking	28,00 €
Extra cleaning (Payable now) Season: 2026 Exotic. Optional Additional cleaning	No	per booking	285,00 €
Extra set of linen (choose how many) (Payable now) Season: 2026 Exotic. Extra set of linen : 15 € 1 set of linen (2 sheets & 2 pillow case) - to be updated manually	No	per booking	15,00 €
Extra set of towels (choose how many) (Payable now) Season: 2026 Exotic. Extra set of towels: 10 € 1 set of towels (1 face & 1 bath towel) - to be updated manually	No	per booking	10,00 €
Final cleaning (Payable now) Season: 2026 Exotic. included in Essentials pack	No	per booking	285,00 €

Final cleaning (Payable now)	No	per booking	285,00 €
Season: 2026 Exotic. included in Essentials pack			
Full board 1-3 pax (number of guests to update manually) (Payable now)	No	per guest/day	75,00 €
Season: 2026 Exotic. only available if cook is booked on board as the cook will do the provisioning based on client's preference. Includes breakfast, lunch & dinner + the crew's food. Does not included alcoholic drinks			
Full board 4-6 pax (number of guests to update manually) (Payable now)	No	per guest/day	60,00 €
Season: 2026 Exotic. only available if cook is booked on board as the cook will do the provisioning based on client's preference. Includes breakfast, lunch & dinner + the crew's food. Does not included alcoholic drinks			
Full board 7-12 pax (number of guests to update manually) (Payable now)	No	per guest/day	55,00 €
Season: 2026 Exotic. only available if cook is booked on board as the cook will do the provisioning based on client's preference. Includes breakfast, lunch & dinner + the crew's food. Does not included alcoholic drinks			
Hostess/Cook (Payable now)	No	per night	135,00 €
Season: 2026 Exotic. + provisioning, Crew on board must have their own toilets/ showers. If either a skipper or a hostess/cook is on board, 1 double cabin will be required for him/her. If both a skipper and a hostess/cook are on board, 1 double cabin and 1 forepeak cabin will be required for them. Exceptions exists for specific layouts, Sales Agents will provide more details about the different boat models			
Hostess/Cook (Payable now)	No	per night	135,00 €
Season: 2026 Exotic. + provisioning, Crew on board must have their own toilets/ showers. If either a skipper or a hostess/cook is on board, 1 double cabin will be required for him/her. If both a skipper and a hostess/cook are on board, 1 double cabin and 1 forepeak cabin will be required for them. Exceptions exists for specific layouts, Sales Agents will provide more details about the different boat models			
Hostess/Cook (Payable now)	No	per night	150,00 €
Season: 2026 Exotic. + provisioning, Crew on board must have their own toilets/ showers. If either a skipper or a hostess/cook is on board, 1 double cabin will be required for him/her. If both a skipper and a hostess/cook are on board, 1 double cabin and 1 forepeak cabin will be required for them. Exceptions exists for specific layouts, Sales Agents will provide more details about the different boat models			
Regatta surcharge (Payable now)	No	per booking	0,00 €
Season: 2026 Exotic. all the regattas apart of ASW (different regatta surcharge for ASW) // A special race deposit need to be doubled manually once the regatta surcharge is added.			

Same day briefing (Payable now)	No	per booking	150,00 €
Season: 2026 Exotic. Same day briefing starting between 5 & 5.30pm (departure following morning)			
Skipper (Payable now)	No	per night	170,00 €
Season: 2026 Exotic. + provisioning, Crew on board must have their own toilets/ showers. If either a skipper or a hostess/cook is on board, 1 double cabin will be required for him/her. If both a skipper and a hostess/cook are on board, 1 double cabin and 1 forepeak cabin will be required for them. Exceptions exists for specific layouts, Sales Agents will provide more details about the different boat models			
Skipper (Payable now)	No	per night	170,00 €
Season: 2026 Exotic. + provisioning, Crew on board must have their own toilets/ showers. If either a skipper or a hostess/cook is on board, 1 double cabin will be required for him/her. If both a skipper and a hostess/cook are on board, 1 double cabin and 1 forepeak cabin will be required for them. Exceptions exists for specific layouts, Sales Agents will provide more details about the different boat models			
Skipper (Payable now)	No	per night	185,00 €
Season: 2026 Exotic. + provisioning, Crew on board must have their own toilets/ showers. If either a skipper or a hostess/cook is on board, 1 double cabin will be required for him/her. If both a skipper and a hostess/cook are on board, 1 double cabin and 1 forepeak cabin will be required for them. Exceptions exists for specific layouts, Sales Agents will provide more details about the different boat models			
Starter pack (Payable now)	No	per booking	50,00 €
Season: 2026 Exotic. included in Essentials pack (The pack includes: 1 gallon water (or 4 bottles of 1.5L), 1 bottle of disinfectant, 1 small bottle of washing up liquid, 1 dish cloth, 1 sponge, garbage bags, 1 roll of paper towels, 1 box of matches, 1 roll of toilet paper in each head			
Transfer (Payable now)	No	one-way	40,00 €
Season: 2026 Exotic. OW La Paz airport /base TAXI 1-4 pax			
Transfer (Payable now)	No	round trip	80,00 €
Season: 2026 Exotic. RT- La Paz airport /base TAXI 1-4 pax			
Transfer (Payable now)	No	one-way	118,00 €
Season: 2026 Exotic. OW La Paz airport /base VAN 1-10 pax			
Transfer (Payable now)	No	round trip	236,00 €
Season: 2026 Exotic. RT - La Paz airport /base VAN 1-10 pax			

Transfer (Payable now)

No

round trip

796,00 €

Season: 2026 Exotic. RT Los cabos airport / base VAN 1-10 pax



WEBSITE

www.plujeme.cz



E-MAIL

info@plujeme.cz



PHONE

+420 720 755 085



MOBILE

+420 777 170 276



PLUJEME RÁDI S.R.O.

Dlouhá 730/35, 11000 Praha 1 – Staré Město, Czech Republic

ADDITIONAL EXTRAS

EXTRA	OBLIGATORY	PAYMENT TYPE	PRICE
Kayak single (Payable now) Season: 2026 Exotic. price per day - Payable now	No	per night	15,00 €
Kayak tandem (Payable now) Season: 2026 Exotic. price per day - Payable now	No	per night	15,00 €
Outboard engine 8 & 9,8 HP (Payable now) Season: 2026 Exotic. Dinghy not suitable in any case for waterski or wakeboard. Additional security deposit of 500 € on outboard engines. - Payable now	No	per day	35,00 €
Railing net (Safety net) (Payable now) Season: 2026 Exotic. net is supplied but not installed - Payable now	No	per booking	250,00 €
Stand up paddle (SUP) (Payable now) Season: 2026 Exotic. price per day - Payable now	No	per night	15,00 €

**WEBSITE**www.plujeme.cz**E-MAIL**info@plujeme.cz**PHONE**

+420 720 755 085

**MOBILE**

+420 777 170 276

**PLUJEME RÁDI S.R.O.**

Dlouhá 730/35, 11000 Praha 1 – Staré Město, Czech Republic

PRICE AND AVAILABILITY

11.07. - 18.08.2026 NOT AVAILABLE	22.08. - 29.08.2026 3.154 € 3.710 €	29.08. - 05.09.2026 3.154 € 3.710 €	05.09. - 12.09.2026 3.154 € 3.710 €
12.09. - 19.09.2026 3.154 € 3.710 €	19.09. - 26.09.2026 3.154 € 3.710 €	26.09. - 03.10.2026 3.254 € 3.829 €	03.10. - 10.10.2026 3.995 € 4.700 €
10.10. - 17.10.2026 4.488 € 5.280 €	17.10. - 24.10.2026 5.104 € 6.005 €	24.10. - 31.10.2026 5.483 € 6.450 €	31.10. - 07.11.2026 5.593 € 6.580 €
07.11. - 14.11.2026 5.721 € 6.730 €	14.11. - 21.11.2026 7.855 €	21.11. - 28.11.2026 7.855 €	28.11. - 05.12.2026 6.750 €
05.12. - 12.12.2026 5.750 €	12.12. - 19.12.2026 4.888 € 5.750 €	19.12. - 26.12.2026 5.970 €	02.01. - 09.01.2027 4.427 € 4.660 €
09.01. - 16.01.2027 4.427 € 4.660 €	16.01. - 23.01.2027 4.218 € 4.440 €	23.01. - 30.01.2027 4.427 € 4.660 €	30.01. - 06.02.2027 4.992 € 5.255 €
06.02. - 13.02.2027 5.866 € 6.175 €	13.02. - 20.02.2027 6.303 € 6.635 €	20.02. - 27.02.2027 6.626 € 6.975 €	27.02. - 06.03.2027 7.087 € 7.460 €



WEBSITE

www.plujeme.cz



E-MAIL

info@plujeme.cz



PHONE

+420 720 755 085



MOBILE

+420 777 170 276



PLUJEME RÁDI S.R.O.

Dlouhá 730/35, 11000 Praha 1 – Staré Město, Czech Republic

PRICE AND AVAILABILITY

06.03. - 13.03.2027 8.080 € 8.505 €	13.03. - 20.03.2027 8.526 € 8.975 €	20.03. - 27.03.2027 8.526 € 8.975 €	27.03. - 03.04.2027 8.526 € 8.975 €
03.04. - 10.04.2027 8.137 € 8.565 €	10.04. - 17.04.2027 7.933 € 8.350 €	20.04. - 27.04.2027 NOT AVAILABLE	01.05. - 08.05.2027 5.667 € 5.965 €
08.05. - 15.05.2027 5.458 € 5.745 €	15.05. - 22.05.2027 5.458 € 5.745 €	22.05. - 29.05.2027 5.097 € 5.365 €	29.05. - 05.06.2027 4.736 € 4.985 €
05.06. - 12.06.2027 4.498 € 4.735 €	12.06. - 19.06.2027 4.251 € 4.475 €	19.06. - 26.06.2027 4.080 € 4.295 €	26.06. - 03.07.2027 3.919 € 4.125 €
03.07. - 10.07.2027 3.919 € 4.125 €	10.07. - 17.07.2027 3.919 € 4.125 €	17.07. - 24.07.2027 3.919 € 4.125 €	24.07. - 31.07.2027 3.919 € 4.125 €
31.07. - 07.08.2027 3.919 € 4.125 €	07.08. - 14.08.2027 3.919 € 4.125 €	14.08. - 21.08.2027 3.919 € 4.125 €	21.08. - 28.08.2027 3.919 € 4.125 €
28.08. - 04.09.2027 3.919 € 4.125 €	04.09. - 11.09.2027 3.919 € 4.125 €	11.09. - 18.09.2027 3.919 € 4.125 €	18.09. - 25.09.2027 3.919 € 4.125 €
25.09. - 02.10.2027 3.930 € 4.136 €	02.10. - 09.10.2027 4.560 € 4.800 €	09.10. - 16.10.2027 5.116 € 5.385 €	16.10. - 23.10.2027 5.819 € 6.125 €
23.10. - 30.10.2027 6.512 € 6.855 €	30.10. - 06.11.2027 6.854 € 7.215 €		



WEBSITE

www.plujeme.cz



E-MAIL

info@plujeme.cz



PHONE

+420 720 755 085



MOBILE

+420 777 170 276



PLUJEME RÁDI S.R.O.

Dlouhá 730/35, 11000 Praha 1 – Staré Město, Czech Republic

PRICE AND AVAILABILITY

06.11. - 13.11.2027

6.869 € 7.230 €

13.11. - 20.11.2027

7.614 € 8.015 €

20.11. - 27.11.2027

7.614 € 8.015 €

27.11. - 04.12.2027

6.541 € 6.885 €

04.12. - 11.12.2027

5.572 € 5.865 €

11.12. - 18.12.2027

5.572 € 5.865 €

18.12. - 25.12.2027

5.790 € 6.095 €



WEBSITE

www.plujeme.cz



E-MAIL

info@plujeme.cz



PHONE

+420 720 755 085



MOBILE

+420 777 170 276



PLUJEME RÁDI S.R.O.

Dlouhá 730/35, 11000 Praha 1 – Staré Město, Czech Republic