

BALI CATSPACE

AILA (2023)

Catamaran Bali Catspace AILA, built in 2023 is anchored in the Fethiye, Yacht Classic Hotel Marina, Aegean, Turkey. It has 4 cabins, can accommodate 8 + 2 people and has 4 toilets. Bed linen and kitchen equipment are included in the price.

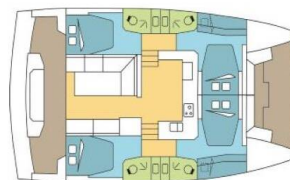

YACHT SPECIFICATIONS

Yacht Base

**Fethiye, Yacht Classic Hotel Marina,
Turkey**

Yacht ID

14150

Brands

Catana

Yacht name

AILA

Production year

2023

Length

40 ft

Cabins

4

Berths

8 + 2

Max Persons

10

WC

4

Engine

2 x 40 HP

Fuel tank

400 l



WEBSITE

www.plujeme.cz



PHONE

+420 720 755 085



MOBILE

+420 777 170 276



E-MAIL

info@plujeme.cz



PLUJEME RÁDI S.R.O.

Dlouhá 730/35, 11000 Praha 1 – Staré Město, Czech Republic

STANDARD YACHT EQUIPMENT

Comfort	Cockpit cushions, Mosquito nets
Deck	Bimini top, Cockpit table, Cockpit/stern, outside shower, Courtesy LED lights all over deck including stern immersed courtesy LED, Davit, Dinghy, Electric anchor windlass, Fly sunbathing area, Flybridge, Foredeck sunbathing area, Outboard engine, Remote control for anchor winch with chain counter at helm, Spring cleats, Swimming ladder
Entertainment	Fusion radio
Galley	Freezer, Oven
Interior	Convertible table in salon, Curtains, Electric fans in cabins, Electric toilet
Navigation	Autopilot, Depthsounder, GPS chart plotter, Speedometer (Speed log), Wind instrument/Anemometer
Safety	Extra water tank, VHF radio
Sails	Electric winch, Lazy bag, Lazy jacks
Yacht electrics	Battery charger, Inverter, Service batteries, Solar panels, Watermaker - desalinator



WEBSITE

www.plujeme.cz



PHONE

+420 720 755 085



MOBILE

+420 777 170 276



E-MAIL

info@plujeme.cz



PLUJEME RÁDI S.R.O.

Dlouhá 730/35, 11000 Praha 1 – Staré Město, Czech Republic

SERVICES

SELECTED SERVICES	OBLIGATORY	PAYMENT TYPE	PRICE
Handling fees (Payable now) Season: 2026.	Yes	per booking	20,00 €
Preparation fee (Payable now) Season: 2026. INCLUDED: starter pack – (1 gallon water or 4 bottles of 1.5L, 1 bottle of disinfectant, 1 small bottle of washing up liquid, 1 dish cloth, 1 sponge, garbage bags, 1 roll of paper towels, 1 box of matches, 1 roll of toilet paper in each head) // final cleaning // 1 set of bed sheets / cabin & 1 set of towels / pax, dinghy, outboard engine & initial supply of fuel, gas and water tanks // DYC assistance guarantee // 1st & last night in the marina // NOT INCLUDED: refuelling, gas & water consumption at end of charter, taxes if any, handling fees & additional equipment deposit.	Yes	per booking	355,00 €
Transit log (Payable at the base) Season: 2026. Payable at base, in cash only, subject to change. Includes: harbor formalities, harbor fees for the first and last day of charter	Yes	per booking	150,00 €
Additional fee for Skipper in forepeak & shared bathroom (Payable now) Season: 2026. To be added with Skipper only ; Can be added for new bookings only confirmed after 21/05/2026 ; replaces skipper requirement to have their own toilet/shower. Guests must be aware that they'll need to give access to toilet/shower.	No	per night	50,00 €
Crew change (Payable now) Season: 2026. Any crew change during the charter is subject to € 250.- additional cost. The charge includes administration cost, change of bed linen and towels and one night at DYC ponton (marina fee included only if the same base than start base). It doesn't include cleaning, nor new transit log where applicable.	No	per booking	250,00 €
Damage waiver (Payable now) Season: 2026. Damage waiver limits your liability to the reduced Security Deposit . Mandatory when skipper is added. Price is per night of the charter (minimum value of 7 nights & a maximum value of 21 nights) Not applicable for 4+ weeks charters , nor Regattas/Races.	No	per night	45,00 €
Early boarding/ check-in (Payable now) Season: 2026. EB (boat only) - 13:00h, starting time of boat's delivery // limited number of early boardings on same departure day	No	per booking	340,00 €

Early boarding/check-in (Payable now)	No	per booking	440,00 €
<i>Season: 2026. EB + extra fee skipper - 13:00h, starting time of boat's delivery // limited number of early boardings on same departure day</i>			
Early boarding/check-in (Payable now)	No	per booking	520,00 €
<i>Season: 2026. EB + extra fee Skipper & Hostess - 13:00h, starting time of boat's delivery // limited number of early boardings on same departure day</i>			
Electric & Water consumption in the Marinas (Payable at the base)	No	per booking	28,00 €
<i>Season: 2026. Electric & Water consumption based on 2 nights on our dock (base will confirm the amount to pay locally depending on nights spent on dock)</i>			
Extra cleaning (Payable now)	No	per booking	285,00 €
<i>Season: 2026. Optional Additional cleaning</i>			
Extra set of linen (choose how many) (Payable now)	No	per booking	15,00 €
<i>Season: 2026. Extra set of linen : 15 € 1 extra set of linen (2 sheets & 2 pillow case) - to be updated manually</i>			
Extra set of towels (choose how many) (Payable now)	No	per booking	10,00 €
<i>Season: 2026. Extra set of towels: 10 € 1 extra set of towels (1 face & 1 bath towel) - to be updated manually</i>			
Full board 1-3 pax (number of guests to update manually) (Payable now)	No	per guest/day	75,00 €
<i>Season: 2026. only available if cook is booked on board as the cook will do the provisioning based on client's preference. Includes breakfast, lunch & dinner + the crew's food. Does not included alcoholic drinks</i>			
Full board 4-6 pax (number of guests to update manually) (Payable now)	No	per guest/day	60,00 €
<i>Season: 2026. only available if cook is booked on board as the cook will do the provisioning based on client's preference. Includes breakfast, lunch & dinner + the crew's food. Does not included alcoholic drinks</i>			
Full board 7-12 pax (number of guests to update manually) (Payable now)	No	per guest/day	55,00 €
<i>Season: 2026. only available if cook is booked on board as the cook will do the provisioning based on client's preference. Includes breakfast, lunch & dinner + the crew's food. Does not included alcoholic drinks</i>			
Half board 1-3 pax (number of guests to update manually) (Payable now)	No	per guest/day	60,00 €
<i>Season: 2026. only available if cook is booked on board as the cook will do the provisioning based on client's preference. Includes breakfast & lunch OR dinner + the crew's food. Does not included alcoholic drinks</i>			

<p>Half board 4-6 pax (number of guests to update manually) (Payable now)</p> <p>Season: 2026. only available if cook is booked on board as the cook will do the provisioning based on client's preference. Includes breakfast & lunch OR dinner + the crew's food. Does not included alcoholic drinks</p>	No	per guest/day	50,00 €
<p>Half board 7-12 pax (number of guests to update manually) (Payable now)</p> <p>Season: 2026. only available if cook is booked on board as the cook will do the provisioning based on client's preference. Includes breakfast & lunch OR dinner + the crew's food. Does not included alcoholic drinks</p>	No	per guest/day	45,00 €
<p>Hostess/Cook (Payable now)</p> <p>Season: 2026. + provisioning, Crew on board must have their own toilets/showers. If either a skipper or a hostess/cook is on board, 1 double cabin will be required for him/her. If both a skipper and a hostess/cook are on board, 1 double cabin and 1 forepeak cabin will be required for them. Exceptions exists for specific layouts, Sales Agents will provide more details about the different boat models</p>	No	per night	140,00 €
<p>Hostess/Cook (Payable now)</p> <p>Season: 2026. + provisioning, Crew on board must have their own toilets/showers. If either a skipper or a hostess/cook is on board, 1 double cabin will be required for him/her. If both a skipper and a hostess/cook are on board, 1 double cabin and 1 forepeak cabin will be required for them. Exceptions exists for specific layouts, Sales Agents will provide more details about the different boat models</p>	No	per night	140,00 €
<p>Hostess/Cook (Payable now)</p> <p>Season: 2026. + provisioning, Crew on board must have their own toilets/showers. If either a skipper or a hostess/cook is on board, 1 double cabin will be required for him/her. If both a skipper and a hostess/cook are on board, 1 double cabin and 1 forepeak cabin will be required for them. Exceptions exists for specific layouts, Sales Agents will provide more details about the different boat models</p>	No	per night	155,00 €
<p>Regatta surcharge (Payable now)</p> <p>Season: 2026. A special race deposit need to be doubled manually once the regatta surcharge is added.</p>	No	per booking	0,00 €
<p>Skipper (Payable now)</p> <p>Season: 2026. + provisioning, Crew on board must have their own toilets/showers. If either a skipper or a hostess/cook is on board, 1 double cabin will be required for him/her. If both a skipper and a hostess/cook are on board, 1 double cabin and 1 forepeak cabin will be required for them. Exceptions exists for specific layouts, Sales Agents will provide more details about the different boat models</p>	No	per night	170,00 €

Skipper (Payable now) Season: 2026. + provisioning, Crew on board must have their own toilets/showers. If either a skipper or a hostess/cook is on board, 1 double cabin will be required for him/her. If both a skipper and a hostess/cook are on board, 1 double cabin and 1 forepeak cabin will be required for them. Exceptions exists for specific layouts, Sales Agents will provide more details about the different boat models	No	per night	170,00 €
Skipper (Payable now) Season: 2026. + provisioning, Crew on board must have their own toilets/showers. If either a skipper or a hostess/cook is on board, 1 double cabin will be required for him/her. If both a skipper and a hostess/cook are on board, 1 double cabin and 1 forepeak cabin will be required for them. Exceptions exists for specific layouts, Sales Agents will provide more details about the different boat models	No	per night	185,00 €
Transfer (Payable now) Season: 2026. RT - Dalaman Airport / Base 1-3 PAX	No	round trip	158,00 €
Transfer (Payable now) Season: 2026. RT - Dalaman Airport / Base 4-6 PAX	No	round trip	186,00 €
Transfer (Payable now) Season: 2026. RT - Dalaman Airport / Base 7-14 PAX	No	round trip	286,00 €
Transfer (Payable now) Season: 2026. RT - Antalya/Bodrum Airport / Base 1-3 PAX	No	round trip	472,00 €
Transfer (Payable now) Season: 2026. RT - Antalya/Bodrum Airport / Base 4-6 PAX	No	round trip	516,00 €
Transfer (Payable now) Season: 2026. RT - Antalya/Bodrum Airport / Base 7-14 PAX	No	round trip	620,00 €
WI-FI Internet connection on boat (Payable now) Season: 2026. unlimited	No	per week	60,00 €



WEBSITE
www.plujeme.cz



PHONE
+420 720 755 085



MOBILE
+420 777 170 276



E-MAIL
info@plujeme.cz



PLUJEME RÁDI S.R.O.
Dlouhá 730/35, 11000 Praha 1 – Staré Město, Czech Republic

ADDITIONAL EXTRAS

EXTRA	OBLIGATORY	PAYMENT TYPE	PRICE
Kayak single (Payable now) <i>Season: 2026. Price per day - Payable now</i>	No	per night	15,00 €
Railing net (Safety net) (Payable now) <i>Season: 2026. net is supplied but not installed - Payable now</i>	No	per booking	250,00 €
Stand up paddle (SUP) (Payable now) <i>Season: 2026. Price per day - Payable now</i>	No	per night	15,00 €



WEBSITE

www.plujeme.cz



E-MAIL

info@plujeme.cz



PHONE

+420 720 755 085



MOBILE

+420 777 170 276



PLUJEME RÁDI S.R.O.

Dlouhá 730/35, 11000 Praha 1 – Staré Město, Czech Republic

PRICE AND AVAILABILITY

11.07. - 25.07.2026 NOT AVAILABLE	25.07. - 01.08.2026 3.821 € 5.095 €	01.08. - 08.08.2026 NOT AVAILABLE	08.08. - 15.08.2026 NOT AVAILABLE
15.08. - 22.08.2026 4.820 € 5.670 €	22.08. - 29.08.2026 5.355 € 6.300 €	29.08. - 05.09.2026 4.344 € 5.110 €	05.09. - 19.09.2026 NOT AVAILABLE
19.09. - 26.09.2026 NOT AVAILABLE	26.09. - 03.10.2026 NOT AVAILABLE	03.10. - 10.10.2026 NOT AVAILABLE	10.10. - 17.10.2026 NOT AVAILABLE
17.10. - 24.10.2026 4.709 € 5.540 €	24.10. - 31.10.2026 NOT AVAILABLE	31.10. - 07.11.2026 NOT AVAILABLE	07.11. - 14.11.2026 2.967 € 3.490 €
20.11. - 12.03.2027 NOT AVAILABLE			



WEBSITE

www.plujeme.cz



E-MAIL

info@plujeme.cz



PHONE

+420 720 755 085



MOBILE

+420 777 170 276



PLUJEME RÁDI S.R.O.

Dlouhá 730/35, 11000 Praha 1 – Staré Město, Czech Republic

PRICE AND AVAILABILITY

13.03. - 20.03.2027 3.012 € 3.170 €	20.03. - 27.03.2027 3.653 € 3.845 €	27.03. - 03.04.2027 3.653 € 3.845 €	03.04. - 10.04.2027 3.653 € 3.845 €
10.04. - 17.04.2027 4.342 € 4.570 €	17.04. - 24.04.2027 5.249 € 5.525 €	24.04. - 01.05.2027 5.510 € 5.800 €	01.05. - 08.05.2027 5.510 € 5.800 €
08.05. - 15.05.2027 5.510 € 5.800 €	15.05. - 22.05.2027 5.904 € 6.215 €	22.05. - 29.05.2027 6.208 € 6.535 €	29.05. - 05.06.2027 7.030 € 7.400 €
05.06. - 12.06.2027 7.030 € 7.400 €	12.06. - 19.06.2027 7.030 € 7.400 €	19.06. - 26.06.2027 7.030 € 7.400 €	26.06. - 03.07.2027 7.391 € 7.780 €
03.07. - 10.07.2027 7.391 € 7.780 €	10.07. - 17.07.2027 7.391 € 7.780 €	17.07. - 24.07.2027 7.391 € 7.780 €	24.07. - 31.07.2027 7.391 € 7.780 €
31.07. - 07.08.2027 7.391 € 7.780 €	07.08. - 14.08.2027 7.391 € 7.780 €	14.08. - 21.08.2027 7.391 € 7.780 €	21.08. - 28.08.2027 8.208 € 8.640 €
28.08. - 04.09.2027 9.163 € 9.645 €	04.09. - 11.09.2027 9.163 € 9.645 €	11.09. - 18.09.2027 8.621 € 9.075 €	18.09. - 25.09.2027 7.876 € 8.290 €
25.09. - 02.10.2027 NOT AVAILABLE	02.10. - 09.10.2027 NOT AVAILABLE	09.10. - 16.10.2027 6.479 € 6.820 €	16.10. - 23.10.2027 5.539 € 5.830 €
23.10. - 30.10.2027 4.460 € 4.695 €	30.10. - 06.11.2027 3.753 € 3.950 €		



WEBSITE

www.plujeme.cz



E-MAIL

info@plujeme.cz



PHONE

+420 720 755 085



MOBILE

+420 777 170 276



PLUJEME RÁDI S.R.O.

Dlouhá 730/35, 11000 Praha 1 – Staré Město, Czech Republic

PRICE AND AVAILABILITY

06.11. - 13.11.2027

3.316 € 3.490 €

13.11. - 20.11.2027

3.012 € 3.170 €

20.11. - 27.11.2027

3.012 € 3.170 €

27.11. - 04.12.2027

3.012 € 3.170 €

04.12. - 11.12.2027

3.012 € 3.170 €

11.12. - 18.12.2027

3.012 € 3.170 €

18.12. - 25.12.2027

3.012 € 3.170 €



WEBSITE

www.plujeme.cz



PHONE

+420 720 755 085



MOBILE

+420 777 170 276



E-MAIL

info@plujeme.cz



PLUJEME RÁDI S.R.O.

Dlouhá 730/35, 11000 Praha 1 – Staré Město, Czech Republic