

LAGOON 52 F

ANACAPA (2018)

Catamaran Lagoon 52 F ANACAPA, built in 2018 is anchored in the **Olbia, Sardinia, Italy**. It has **6 + 2 cabins**, can accommodate **12 + 2 people** and has **6 toilets**. Bed linen and kitchen equipment are included in the price.

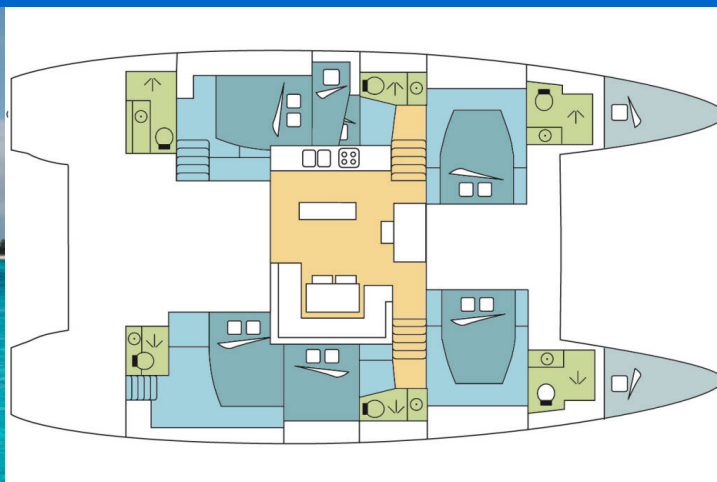

YACHT SPECIFICATIONS

Yacht Base
Olbia, Italy

Yacht ID
13923

Brands
Lagoon

Yacht name
ANACAPA

Production year
2018

Length
52 ft

Cabins
6 + 2

Berths
12 + 2

Max Persons
12

WC
6

Engine
2 x 80 HP

Fuel tank
992 l



WEBSITE
www.plujeme.cz



PHONE
+420 720 755 085



MOBILE
+420 777 170 276



E-MAIL
info@plujeme.cz



PLUJEME RÁDI S.R.O.
Dlouhá 730/35, 11000 Praha 1 – Staré Město, Czech Republic

STANDARD YACHT EQUIPMENT

Comfort	Cockpit cushions
Deck	Bimini top, Cockpit fridge, Cockpit table, Cockpit/stern, outside shower, Davit, Dinghy, Electric anchor windlass, Flybridge, Swimming ladder
Entertainment	MP3 Jack-Ipod, Outdoor speakers, Radio with USB
Galley	Blender, Coffee pot, Freezer, Microwave, Oven, Refrigerator, Stove, Toaster
Interior	Electric fans in cabins, Electric toilet
Navigation	Autopilot, Depthsounder, GPS chart plotter, Speedometer (Speed log), Wind instrument/Anemometer
Safety	VHF radio
Sails	Electric winch, Lazy bag, Lazy jacks, Self tailing (manual) winch
Yacht electrics	220V socket, Air Conditioning, Battery charger, Generator, Inverter, Solar panels, USB sockets, Watermaker - desalinator



WEBSITE

www.plujeme.cz



E-MAIL

info@plujeme.cz



PHONE

+420 720 755 085



MOBILE

+420 777 170 276



PLUJEME RÁDI S.R.O.

Dlouhá 730/35, 11000 Praha 1 – Staré Město, Czech Republic

SERVICES

SELECTED SERVICES	OBLIGATORY	PAYMENT TYPE	PRICE
Handling fees (Payable now) Season: 2026.	Yes	per booking	25,00 €
Preparation fee (Payable now) Season: 2026. INCLUDED: starter pack – (1 gallon water or 4 bottles of 1.5L, 1 bottle of disinfectant, 1 small bottle of washing up liquid, 1 dish cloth, 1 sponge, garbage bags, 1 roll of paper towels, 1 box of matches, 1 roll of toilet paper in each head) // final cleaning // 1 set of bed sheets / cabin & 1 set of towels / pax, dinghy, outboard engine & initial supply of fuel, gas and water tanks // DYC assistance guarantee // 1st & last night in the marina // NOT INCLUDED: refuelling, gas & water consumption at end of charter, taxes if any, handling fees & additional equipment deposit.	Yes	per booking	450,00 €
Additional fee for Skipper in forepeak & shared bathroom (Payable at the base) Season: 2026. To be added with Skipper only ; Can be added for new bookings only confirmed after 21/05/2026 ; replaces skipper requirement to have their own toilet/shower. Guests must be aware that they'll need to give access to toilet/shower.	No	per night	50,00 €
Crew change (Payable now) Season: 2026. Any crew change during the charter is subject to € 250.- additional cost. The charge includes administration cost, change of bed linen and towels and one night at DYC ponton (marina fee included only if the same base than start base). It doesn't include cleaning, nor new transit log where applicable.	No	per booking	250,00 €
Damage waiver (Payable now) Season: 2026. Damage waiver limits your liability to the reduced Security Deposit . Mandatory when skipper is added. Price is per night of the charter (minimum value of 7 nights & a maximum value of 21 nights). Not applicable for 4+ weeks charters , nor Regattas/Races.	No	per night	70,00 €
Early boarding/check-in (Payable now) Season: 2026. Early boarding – 13:00h, starting time of boat's delivery // limited number of early boardings on same departure day	No	per booking	480,00 €

Electric & Water consumption in the Marinas (Payable at the base)	No	per booking	52,00 €
Season: 2026. Electric & Water consumption based on 2 nights on our dock (base will confirm the amount to pay locally depending on nights spent on dock)			
Extra cleaning (Payable now)	No	per booking	375,00 €
Season: 2026. Optional Additional cleaning			
Extra set of linen (choose how many) (Payable now)	No	per booking	15,00 €
Season: 2026. Extra set of linen : 15 € 1 extra set of linen (2 sheets & 2 pillow case) - to be updated manually			
Extra set of towels (choose how many) (Payable now)	No	per booking	10,00 €
Season: 2026. Extra set of towels: 10 € 1 extra set of towels (1 face & 1 bath towel) - to be updated manually			
Full board 1-3 pax (number of guests to update manually) (Payable now)	No	per guest/day	75,00 €
Season: 2026. only available if cook is booked on board as the cook will do the provisioning based on client's preference. Includes breakfast, lunch & dinner + the crew's food. Does not included alcoholic drinks			
Full board 4-6 pax (number of guests to update manually) (Payable now)	No	per guest/day	60,00 €
Season: 2026. only available if cook is booked on board as the cook will do the provisioning based on client's preference. Includes breakfast, lunch & dinner + the crew's food. Does not included alcoholic drinks			
Full board 7-12 pax (number of guests to update manually) (Payable now)	No	per guest/day	55,00 €
Season: 2026. only available if cook is booked on board as the cook will do the provisioning based on client's preference. Includes breakfast, lunch & dinner + the crew's food. Does not included alcoholic drinks			
Half board 1-3 pax (number of guests to update manually) (Payable now)	No	per guest/day	60,00 €
Season: 2026. only available if cook is booked on board as the cook will do the provisioning based on client's preference. Includes breakfast & lunch OR dinner + the crew's food. Does not included alcoholic drinks			
Half board 4-6 pax (number of guests to update manually) (Payable now)	No	per guest/day	50,00 €
Season: 2026. only available if cook is booked on board as the cook will do the provisioning based on client's preference. Includes breakfast & lunch OR dinner + the crew's food. Does not included alcoholic drinks			
Half board 7-12 pax (number of guests to update manually) (Payable now)	No	per guest/day	45,00 €
Season: 2026. only available if cook is booked on board as the cook will do the provisioning based on client's preference. Includes breakfast & lunch OR dinner + the crew's food. Does not included alcoholic drinks			

<p>Hostess/Cook (Payable at the base)</p> <p>Season: 2026. + provisioning, Crew on board must have their own toilets/showers. If either a skipper or a hostess/cook is on board, 1 double cabin will be required for him/her. If both a skipper and a hostess/cook are on board, 1 double cabin and 1 forepeak cabin will be required for them. Exceptions exists for specific layouts, Sales Agents will provide more details about the different boat models // In Italy, law requires clients to pay hostess directly with a contract established between both parties</p>	No	per night	210,00 €
<p>Hostess/Cook (Payable at the base)</p> <p>Season: 2026. + provisioning, Crew on board must have their own toilets/showers. If either a skipper or a hostess/cook is on board, 1 double cabin will be required for him/her. If both a skipper and a hostess/cook are on board, 1 double cabin and 1 forepeak cabin will be required for them. Exceptions exists for specific layouts, Sales Agents will provide more details about the different boat models // In Italy, law requires clients to pay hostess directly with a contract established between both parties</p>	No	per night	210,00 €
<p>Hostess/Cook (Payable at the base)</p> <p>Season: 2026. + provisioning, Crew on board must have their own toilets/showers. If either a skipper or a hostess/cook is on board, 1 double cabin will be required for him/her. If both a skipper and a hostess/cook are on board, 1 double cabin and 1 forepeak cabin will be required for them. Exceptions exists for specific layouts, Sales Agents will provide more details about the different boat models // In Italy, law requires clients to pay hostess directly with a contract established between both parties</p>	No	per night	230,00 €
<p>Regatta surcharge (Payable now)</p> <p>Season: 2026. A special race deposit need to be doubled manually once the regatta surcharge is added.</p>	No	per booking	0,00 €
<p>Skipper (Payable at the base)</p> <p>Season: 2026. + provisioning, Crew on board must have their own toilets/showers. If either a skipper or a hostess/cook is on board, 1 double cabin will be required for him/her. If both a skipper and a hostess/cook are on board, 1 double cabin and 1 forepeak cabin will be required for them. Exceptions exists for specific layouts, Sales Agents will provide more details about the different boat models // In Italy, law requires clients to pay skipper directly with a contract established between both parties</p>	No	per night	240,00 €

<p>Skipper (Payable at the base)</p> <p>Season: 2026. + provisioning, Crew on board must have their own toilets/showers. If either a skipper or a hostess/cook is on board, 1 double cabin will be required for him/her. If both a skipper and a hostess/cook are on board, 1 double cabin and 1 forepeak cabin will be required for them. Exceptions exists for specific layouts, Sales Agents will provide more details about the different boat models // In Italy, law requires clients to pay skipper directly with a contract established between both parties</p>	No	per night	240,00 €
<p>Skipper (Payable at the base)</p> <p>Season: 2026. + provisioning, Crew on board must have their own toilets/showers. If either a skipper or a hostess/cook is on board, 1 double cabin will be required for him/her. If both a skipper and a hostess/cook are on board, 1 double cabin and 1 forepeak cabin will be required for them. Exceptions exists for specific layouts, Sales Agents will provide more details about the different boat models // In Italy, law requires clients to pay skipper directly with a contract established between both parties</p>	No	per night	265,00 €
<p>Transfer (Payable now)</p> <p>Season: 2026. OW - Olbia Airport/Base 1-3 pax daytime (from 06:00 - 22:00) - In case of night transfers, prices from Olbia airport to base, should be raised by 15 € one-way, or 30 € round trip</p>	No	one-way	45,00 €
<p>Transfer (Payable now)</p> <p>Season: 2026. OW - Olbia Airport / Base 4-8 pax daytime (from 06:00 - 22:00) - In case of night transfers, prices from Olbia airport to base, should be raised by 15 € one-way, or 30 € round trip</p>	No	one-way	74,00 €
<p>Transfer (Payable now)</p> <p>Season: 2026. RT - Olbia Airport/Base 1-3 pax daytime (from 06:00 - 22:00) - In case of night transfers, prices from Olbia airport to base, should be raised by 15 € one-way, or 30 € round trip</p>	No	round trip	90,00 €
<p>Transfer (Payable now)</p> <p>Season: 2026. OW - Olbia Airport/Base 9-12 pax daytime (from 06:00 - 22:00) - In case of night transfers, prices from Olbia airport to base, should be raised by 15 € one-way, or 30 € round trip</p>	No	one-way	136,00 €
<p>Transfer (Payable now)</p> <p>Season: 2026. RT - Olbia Airport / Base 4-8 pax daytime (from 06:00 - 22:00) - In case of night transfers, prices from Olbia airport to base, should be raised by 15 € one-way, or 30 € round trip</p>	No	round trip	148,00 €

Transfer (Payable now)

No

round trip

272,00 €

Season: 2026. RT - Olbia Airport/Base 9-12 pax daytime (from 06:00 - 22:00) - In case of night transfers, prices from Olbia airport to base, should be raised by 15 € one-way, or 30 € round trip



WEBSITE

www.plujeme.cz



E-MAIL

info@plujeme.cz



PHONE

+420 720 755 085



MOBILE

+420 777 170 276



PLUJEME RÁDI S.R.O.

Dlouhá 730/35, 11000 Praha 1 – Staré Město, Czech Republic

ADDITIONAL EXTRAS

EXTRA	OBLIGATORY	PAYMENT TYPE	PRICE
Kayak single (Payable now) <i>Season: 2026. Price per day - Payable now</i>	No	per night	15,00 €
Kayak tandem (Payable now) <i>Season: 2026. Price per day - Payable now</i>	No	per night	15,00 €
Outboard engine 15 HP (Payable now) <i>Season: 2026. Subject to Availability ; 15hp. Dinghy not suitable in any case for waterski or wakeboard. - Payable now</i>	No	per day	50,00 €
Outboard engine 8 & 9,8 HP (Payable now) <i>Season: 2026. Subject to Availability ; 8 & 9.8hp. Dinghy not suitable in any case for waterski or wakeboard. - Payable now</i>	No	per day	35,00 €
Railing net (Safety net) (Payable now) <i>Season: 2026. net is supplied but not installed - Payable now</i>	No	per booking	300,00 €
Stand up paddle (SUP) (Payable now) <i>Season: 2026. Price per day - Payable now</i>	No	per night	15,00 €



WEBSITE

www.plujeme.cz



E-MAIL

info@plujeme.cz



PHONE

+420 720 755 085



MOBILE

+420 777 170 276



PLUJEME RÁDI S.R.O.

Dlouhá 730/35, 11000 Praha 1 – Staré Město, Czech Republic

PRICE AND AVAILABILITY

18.07. - 25.07.2026 NOT AVAILABLE	25.07. - 01.08.2026 NOT AVAILABLE	01.08. - 08.08.2026 ON OPTION	08.08. - 15.08.2026 NOT AVAILABLE
15.08. - 22.08.2026 NOT AVAILABLE	22.08. - 29.08.2026 NOT AVAILABLE	29.08. - 05.09.2026 NOT AVAILABLE	05.09. - 12.09.2026 NOT AVAILABLE
12.09. - 19.09.2026 NOT AVAILABLE	19.09. - 26.09.2026 NOT AVAILABLE	26.09. - 03.10.2026 NOT AVAILABLE	03.10. - 17.10.2026 NOT AVAILABLE
17.10. - 24.10.2026 NOT AVAILABLE	24.10. - 31.10.2026 NOT AVAILABLE	31.10. - 07.11.2026 3.485 € 4.100 €	07.11. - 14.11.2026 3.485 € 4.100 €
20.11. - 12.03.2027 NOT AVAILABLE			



WEBSITE
www.plujeme.cz



E-MAIL
info@plujeme.cz



PHONE
+420 720 755 085



PLUJEME RÁDI S.R.O.
Dlouhá 730/35, 11000 Praha 1 – Staré Město, Czech Republic



MOBILE
+420 777 170 276

PRICE AND AVAILABILITY

13.03. - 20.03.2027 3.690 € 4.100 €	20.03. - 27.03.2027 3.690 € 4.100 €	27.03. - 03.04.2027 3.690 € 4.100 €	03.04. - 10.04.2027 3.690 € 4.100 €
10.04. - 17.04.2027 3.690 € 4.100 €	17.04. - 24.04.2027 3.690 € 4.100 €	24.04. - 01.05.2027 4.986 € 5.540 €	01.05. - 08.05.2027 4.986 € 5.540 €
08.05. - 15.05.2027 5.315 € 5.905 €	15.05. - 22.05.2027 6.719 € 7.465 €	22.05. - 29.05.2027 7.299 € 8.110 €	29.05. - 05.06.2027 9.351 € 10.390 €
05.06. - 12.06.2027 9.432 € 10.480 €	12.06. - 19.06.2027 10.845 € 12.050 €	19.06. - 26.06.2027 ON OPTION	26.06. - 03.07.2027 12.177 € 13.530 €
03.07. - 10.07.2027 14.157 € 15.730 €	10.07. - 17.07.2027 15.210 € 16.900 €	17.07. - 24.07.2027 16.358 € 18.175 €	24.07. - 31.07.2027 16.754 € 18.615 €
31.07. - 07.08.2027 19.125 € 21.250 €	07.08. - 14.08.2027 19.125 € 21.250 €	14.08. - 21.08.2027 16.754 € 18.615 €	21.08. - 28.08.2027 11.880 € 13.200 €
28.08. - 04.09.2027 11.619 € 12.910 €	04.09. - 11.09.2027 11.583 € 12.870 €	11.09. - 18.09.2027 11.246 € 12.495 €	18.09. - 25.09.2027 8.694 € 9.660 €
25.09. - 02.10.2027 7.601 € 8.445 €	02.10. - 09.10.2027 5.477 € 6.085 €	09.10. - 16.10.2027 4.208 € 4.675 €	16.10. - 23.10.2027 3.690 € 4.100 €
23.10. - 30.10.2027 3.690 € 4.100 €	30.10. - 06.11.2027 3.690 € 4.100 €		



WEBSITE
www.plujeme.cz



E-MAIL
info@plujeme.cz



PHONE
+420 720 755 085



MOBILE
+420 777 170 276



PLUJEME RÁDI S.R.O.
Dlouhá 730/35, 11000 Praha 1 – Staré Město, Czech Republic

PRICE AND AVAILABILITY

06.11. - 13.11.2027

3.690 € 4.100 €

13.11. - 20.11.2027

3.690 € 4.100 €

20.11. - 27.11.2027

3.690 € 4.100 €

27.11. - 04.12.2027

3.690 € 4.100 €

04.12. - 11.12.2027

3.690 € 4.100 €

11.12. - 18.12.2027

3.690 € 4.100 €

18.12. - 25.12.2027

3.690 € 4.100 €



WEBSITE

www.plujeme.cz



E-MAIL

info@plujeme.cz



PHONE

+420 720 755 085



MOBILE

+420 777 170 276



PLUJEME RÁDI S.R.O.

Dlouhá 730/35, 11000 Praha 1 – Staré Město, Czech Republic