

LAGOON 52 F

GULL (2019)

Catamaran Lagoon 52 F GULL, built in 2019 is anchored in the Phuket, Yacht Haven Marina, Phuket, Thailand . It has 6 + 2 cabins, can accommodate 12 + 2 people and has 6 toilets. Bed linen and kitchen equipment are included in the price.

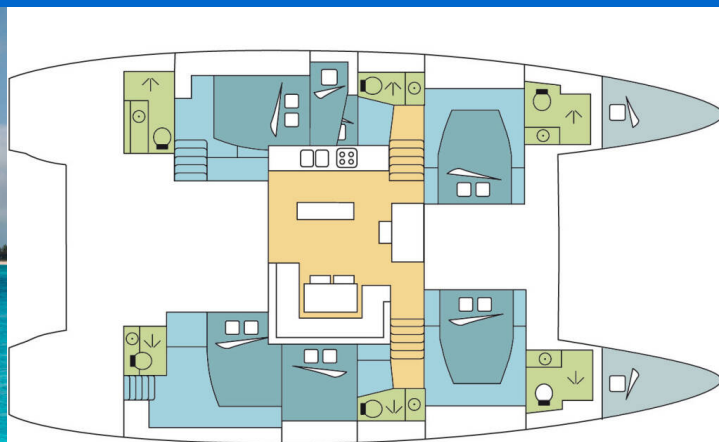

YACHT SPECIFICATIONS

Yacht Base

Phuket, Yacht Haven Marina, Thailand

Yacht ID

13862

Brands

Lagoon

Yacht name

GULL

Production year

2019

Length

52 ft

Cabins

6 + 2

Berths

12 + 2

Max Persons

14

WC

6

Engine

2 x 80 HP

Fuel tank

992 l



WEBSITE

www.plujeme.cz



PHONE

+420 720 755 085



MOBILE

+420 777 170 276



E-MAIL

info@plujeme.cz



PLUJEME RÁDI S.R.O.

Dlouhá 730/35, 11000 Praha 1 - Staré Město, Czech Republic

STANDARD YACHT EQUIPMENT

| | |
|-----------------|--|
| Comfort | Cockpit cushions |
| Deck | Bimini top, Cockpit fridge, Cockpit table, Cockpit/stern, outside shower, Davit, Dinghy, Electric anchor windlass, Flybridge, Swimming ladder |
| Entertainment | Outdoor speakers, Radio |
| Galley | Freezer, Hot water, Oven, Refrigerator, Stove |
| Interior | Electric fans in cabins, Electric toilet |
| Navigation | Autopilot, Depthsounder, GPS chart plotter, Speedometer (Speed log), Wind instrument/Anemometer |
| Safety | VHF radio |
| Sails | Electric winch, Lazy bag, Lazy jacks, Self tailing (manual) winch |
| Yacht electrics | 220V socket, Air Conditioning, Battery charger, Generator, Inverter, USB sockets, Watermaker - desalinator |



WEBSITE

www.plujeme.cz



PHONE

+420 720 755 085



MOBILE

+420 777 170 276



E-MAIL

info@plujeme.cz



PLUJEME RÁDI S.R.O.

Dlouhá 730/35, 11000 Praha 1 – Staré Město, Czech Republic

SERVICES

| SELECTED SERVICES | OBLIGATORY | PAYMENT TYPE | PRICE |
|---|------------|--------------|-----------------|
| Essentials pack (Payable now) Season: 2026 Exotic. INCLUDED: Damage waiver (covering damages) with reduced security deposit addressed specifically to blocked toilets, unpaid fuel, lost equipment, unpaid fees & fines, and returning the boat in an extremely dirty state. // starter pack – (1 gallon water or 4 bottles of 1.5L, 1 bottle of disinfectant, 1 small bottle of washing up liquid, 1 dish cloth, 1 sponge, garbage bags, 1 roll of paper towels, 1 box of matches, 1 roll of toilet paper in each head) // final cleaning // 1 set of bed sheets & towels, dinghy, outboard engine & initial supply of fuel, gas and water tanks // DYC assistance guarantee // 1st & last night in the marina /// NOT INCLUDED: refuelling, gas & water consumption at end of charter, taxes if any, handling fees & additional equipment deposit. | Yes | per booking | 930,00 € |
| Handling fees (Payable now) Season: 2026 Exotic. | Yes | per booking | 35,00 € |
| Preparation fee (Payable now) Season: 2026 Exotic. INCLUDED: starter pack – (1 gallon water or 4 bottles of 1.5L, 1 bottle of disinfectant, 1 small bottle of washing up liquid, 1 dish cloth, 1 sponge, garbage bags, 1 roll of paper towels, 1 box of matches, 1 roll of toilet paper in each head) // final cleaning // 1 set of bed sheets / cabin & 1 set of towels / pax, dinghy, outboard engine & initial supply of fuel, gas and water tanks // DYC assistance guarantee // 1st & last night in the marina // NOT INCLUDED: refuelling, gas & water consumption at end of charter, taxes if any, handling fees & additional equipment deposit. | Yes | per booking | 470,00 € |
| Crew change (Payable now) Season: 2026 Exotic. Any crew change during the charter is subject to € 250.- additional cost. The charge includes administration cost, change of bed linen and towels and one night at DYC ponton (marina fee included only if the same base than start base). It doesn't include cleaning, nor new transit log where applicable. | No | per booking | 250,00 € |
| Damage waiver (Payable now) Season: 2026 Exotic. Damage waiver limits your liability to the reduced Security Deposit . Mandatory when skipper is added. Price is per night of the charter (minimum value of 7 nights & a maximum value of 21 nights) Not applicable for 4+ weeks charters , nor Regattas/Races. | No | per night | 80,00 € |

| | | | |
|---|----|---------------|-----------------|
| Early boarding/check-in (Payable now) | No | per booking | 540,00 € |
| Season: 2026 Exotic. EB (boat only) - 14:00 h / 2 PM starting time of boat's delivery // limited number of early boardings on same departure day | | | |
| Early boarding/check-in (Payable now) | No | per booking | 745,00 € |
| Season: 2026 Exotic. EB boat + extra fee skipper - 14:00 h / 2 PM starting time of boat's delivery // limited number of early boardings on same departure day | | | |
| Early boarding/check-in (Payable now) | No | per booking | 915,00 € |
| Season: 2026 Exotic. EB + extra fee Skipper & Hostes - 14:00 h / 2 PM starting time of boat's delivery // limited number of early boardings on same departure day | | | |
| Electric & Water consumption in the Marinas (Payable at the base) | No | per booking | 52,00 € |
| Season: 2026 Exotic. Electric & Water consumption based on 2 nights on our dock (base will confirm the amount to pay locally depending on nights spent on dock) | | | |
| Extra cleaning (Payable now) | No | per booking | 375,00 € |
| Season: 2026 Exotic. Optional Additional cleaning | | | |
| Extra set of linen (choose how many) (Payable now) | No | per booking | 15,00 € |
| Season: 2026 Exotic. Extra set of linen : 15 € 1 set of linen (2 sheets & 2 pillow case) - to be updated manually | | | |
| Extra set of towels (choose how many) (Payable now) | No | per booking | 10,00 € |
| Season: 2026 Exotic. Extra set of towels: 10 € 1 set of towels (1 face & 1 bath towel) - to be updated manually | | | |
| Final cleaning (Payable now) | No | per booking | 375,00 € |
| Season: 2026 Exotic. included in Essentials pack | | | |
| Final cleaning (Payable now) | No | per booking | 375,00 € |
| Season: 2026 Exotic. included in Essentials pack | | | |
| Full board 1-3 pax (number of guests to update manually) (Payable now) | No | per guest/day | 75,00 € |
| Season: 2026 Exotic. only available if cook is booked on board as the cook will do the provisioning based on client's preference. Includes breakfast, lunch & dinner + the crew's food. Does not included alcoholic drinks | | | |
| Full board 4-6 pax (number of guests to update manually) (Payable now) | No | per guest/day | 60,00 € |
| Season: 2026 Exotic. only available if cook is booked on board as the cook will do the provisioning based on client's preference. Includes breakfast, lunch & dinner + the crew's food. Does not included alcoholic drinks | | | |

| | | | |
|--|----|---------------|-----------------|
| <p>Full board 7-12 pax (number of guests to update manually) (Payable now)</p> <p>Season: 2026 Exotic. only available if cook is booked on board as the cook will do the provisioning based on client's preference. Includes breakfast, lunch & dinner + the crew's food. Does not included alcoholic drinks</p> | No | per guest/day | 55,00 € |
| <p>Half board 1-3 pax (number of guests to update manually) (Payable now)</p> <p>Season: 2026 Exotic. only available if cook is booked on board as the cook will do the provisioning based on client's preference. Includes breakfast & lunch OR dinner + the crew's food. Does not included alcoholic drinks</p> | No | per guest/day | 60,00 € |
| <p>Half board 4-6 pax (number of guests to update manually) (Payable now)</p> <p>Season: 2026 Exotic. only available if cook is booked on board as the cook will do the provisioning based on client's preference. Includes breakfast & lunch OR dinner + the crew's food. Does not included alcoholic drinks</p> | No | per guest/day | 50,00 € |
| <p>Half board 7-12 pax (number of guests to update manually) (Payable now)</p> <p>Season: 2026 Exotic. only available if cook is booked on board as the cook will do the provisioning based on client's preference. Includes breakfast & lunch OR dinner + the crew's food. Does not included alcoholic drinks</p> | No | per guest/day | 45,00 € |
| <p>Hostess/Cook (Payable now)</p> <p>Season: 2026 Exotic. + provisioning, Crew on board must have their own toilets/ showers. If either a skipper or a hostess/cook is on board, 1 double cabin will be required for him/her. If both a skipper and a hostess/cook are on board, 1 double cabin and 1 forepeak cabin will be required for them. Exceptions exists for specific layouts, Sales Agents will provide more details about the different boat models</p> | No | per night | 170,00 € |
| <p>Hostess/Cook (Payable now)</p> <p>Season: 2026 Exotic. + provisioning, Crew on board must have their own toilets/ showers. If either a skipper or a hostess/cook is on board, 1 double cabin will be required for him/her. If both a skipper and a hostess/cook are on board, 1 double cabin and 1 forepeak cabin will be required for them. Exceptions exists for specific layouts, Sales Agents will provide more details about the different boat models</p> | No | per night | 170,00 € |
| <p>Hostess/Cook (Payable now)</p> <p>Season: 2026 Exotic. + provisioning, Crew on board must have their own toilets/ showers. If either a skipper or a hostess/cook is on board, 1 double cabin will be required for him/her. If both a skipper and a hostess/cook are on board, 1 double cabin and 1 forepeak cabin will be required for them. Exceptions exists for specific layouts, Sales Agents will provide more details about the different boat models</p> | No | per night | 185,00 € |

| | | | |
|--|----|-------------|-------------------|
| <p>Race pack (Payable now)</p> <p>Season: 2026 Exotic. Multihull Solutions Regatta / The Regatta Package includes - Briefing before the race, preparation and gauging of sails, technical assistance during the race, registration of the boat (not of the passengers). // A special race deposit need to be doubled manually once the race fee is added.</p> | No | per booking | 800,00 € |
| <p>Race pack (Payable now)</p> <p>Season: 2026 Exotic. Phuket Race Week / The Regatta Package includes - Briefing before the race, preparation and gauging of sails, technical assistance during the race, registration of the boat (not of the passengers) // A special race deposit need to be doubled manually once the race fee is added.</p> | No | per booking | 800,00 € |
| <p>Race pack (Payable now)</p> <p>Season: 2026 Exotic. Royal Langkawi International Regatta / The Regatta Package includes - Briefing before the race, preparation and gauging of sails, technical assistance during the race, registration of the boat (not of the passengers). // A special race deposit need to be doubled manually once the race fee is added.</p> | No | per booking | 1.000,00 € |
| <p>Race pack (Payable now)</p> <p>Season: 2026 Exotic. Raja Muda Selangor International Regatta / The Regatta Package includes - Briefing before the race, preparation and gauging of sails, technical assistance during the race, registration of the boat (not of the passengers)// A special race deposit need to be doubled manually once the race fee is added.</p> | No | per booking | 1.200,00 € |
| <p>Race pack (Payable now)</p> <p>Season: 2026 Exotic. Kings Cup / The Regatta Package includes - Briefing before the race, preparation and gauging of sails, technical assistance during the race, registration of the boat (not of the passengers). // A special race deposit need to be doubled manually once the race fee is added.</p> | No | per booking | 1.200,00 € |
| <p>Race pack (Payable now)</p> <p>Season: 2026 Exotic. Bay Regatta / The Regatta Package includes - Briefing before the race, preparation and gauging of sails, technical assistance during the race, registration of the boat (not of the passengers). // A special race deposit need to be doubled manually once the race fee is added.</p> | No | per booking | 1.200,00 € |
| <p>Regatta surcharge (Payable now)</p> <p>Season: 2026 Exotic. all the regattas apart of ASW (different regatta surcharge for ASW) // A special race deposit need to be doubled manually once the regatta surcharge is added.</p> | No | per booking | 0,00 € |

| | | | |
|---|----|-------------|-----------------|
| Same day briefing (Payable now) Season: 2026 Exotic. Same day briefing starting between 5 & 5.30pm (departure following morning) | No | per booking | 180,00 € |
| Skipper (Payable now) Season: 2026 Exotic. + provisioning, Crew on board must have their own toilets/ showers. If either a skipper or a hostess/cook is on board, 1 double cabin will be required for him/her. If both a skipper and a hostess/cook are on board, 1 double cabin and 1 forepeak cabin will be required for them. Exceptions exists for specific layouts, Sales Agents will provide more details about the different boat models | No | per night | 205,00 € |
| Skipper (Payable now) Season: 2026 Exotic. + provisioning, Crew on board must have their own toilets/ showers. If either a skipper or a hostess/cook is on board, 1 double cabin will be required for him/her. If both a skipper and a hostess/cook are on board, 1 double cabin and 1 forepeak cabin will be required for them. Exceptions exists for specific layouts, Sales Agents will provide more details about the different boat models | No | per night | 205,00 € |
| Skipper (Payable now) Season: 2026 Exotic. + provisioning, Crew on board must have their own toilets/ showers. If either a skipper or a hostess/cook is on board, 1 double cabin will be required for him/her. If both a skipper and a hostess/cook are on board, 1 double cabin and 1 forepeak cabin will be required for them. Exceptions exists for specific layouts, Sales Agents will provide more details about the different boat models | No | per night | 225,00 € |
| Starter pack (Payable now) Season: 2026 Exotic. included in Essentials pack (The pack includes: 1 gallon water (or 4 bottles of 1.5L), 1 bottle of disinfectant, 1 small bottle of washing up liquid, 1 dish cloth, 1 sponge, garbage bags, 1 roll of paper towels, 1 box of matches, 1 roll of toilet paper in each head | No | per booking | 50,00 € |
| Transfer (Payable now) Season: 2026 Exotic. RT - PHU airport/base/airport from 1 to 3 pax | No | round trip | 56,00 € |
| Transfer (Payable now) Season: 2026 Exotic. RT - PHU airport/base/airport from 4 to 8 pax | No | round trip | 75,00 € |
| Transfer (Payable now) Season: 2026 Exotic. RT - PHU airport/base/airport from 9 to 12 pax | No | round trip | 135,00 € |
| Wi-Fi/Internet connection on boat (Payable now) Season: 2026 Exotic. Sim card + key 5 Go is provided (reload upon calling the base) | No | per week | 50,00 € |



WEBSITE

www.plujeme.cz



PHONE

+420 720 755 085



MOBILE

+420 777 170 276



E-MAIL

info@plujeme.cz



PLUJEME RÁDI S.R.O.

Obuhá 730/35, 11000 Praha 1 – Staré Město, Czech Republic

ADDITIONAL EXTRAS

| EXTRA | OBLIGATORY | PAYMENT TYPE | PRICE |
|--|------------|--------------|-----------------|
| Fishing equipment (Payable now) Season: 2026 Exotic. Additional deposit 100 EUR (subject to availability) - Payable now | No | per day | 15,00 € |
| Kayak single (Payable now) Season: 2026 Exotic. price per day - Payable now | No | per night | 15,00 € |
| Kayak tandem (Payable now) Season: 2026 Exotic. price per day - Payable now | No | per night | 15,00 € |
| Outboard engine 15 HP (Payable now) Season: 2026 Exotic. Dinghy not suitable in any case for waterski or wakeboard. Additional security deposit of 500 € on outboard engines. - Payable now | No | per day | 50,00 € |
| Outboard engine 8 & 9,8 HP (Payable now) Season: 2026 Exotic. Dinghy not suitable in any case for waterski or wakeboard. Additional security deposit of 500 € - Payable now | No | per day | 35,00 € |
| Railing net (Safety net) (Payable now) Season: 2026 Exotic. net is supplied but not installed - Payable now | No | per booking | 300,00 € |
| Stand up paddle (SUP) (Payable now) Season: 2026 Exotic. Price per day - Payable now | No | per night | 15,00 € |



WEBSITE
www.plujeme.cz



PHONE
+420 720 755 085



MOBILE
+420 777 170 276



E-MAIL
info@plujeme.cz



PLUJEME RÁDI S.R.O.
Dlouhá 730/35, 11000 Praha 1 – Staré Město, Czech Republic

PRICE AND AVAILABILITY

| | | | |
|---|---|---|---|
| 11.07. - 18.07.2026 5.136 € 6.420 € | 20.07. - 03.08.2026 NOT AVAILABLE | 08.08. - 15.08.2026 5.696 € 7.120 € | 15.08. - 22.08.2026 5.136 € 6.420 € |
| 22.08. - 29.08.2026 5.136 € 6.420 € | 29.08. - 05.09.2026 5.136 € 6.420 € | 05.09. - 12.09.2026 5.136 € 6.420 € | 12.09. - 19.09.2026 5.136 € 6.420 € |
| 19.09. - 26.09.2026 5.136 € 6.420 € | 26.09. - 03.10.2026 5.271 € 6.589 € | 03.10. - 10.10.2026 6.860 € 8.070 € | 10.10. - 17.10.2026 6.894 € 8.110 € |
| 17.10. - 24.10.2026 8.368 € 9.845 € | 29.10. - 08.11.2026 NOT AVAILABLE | 14.11. - 21.11.2026 11.071 € 13.025 € | 24.11. - 28.11.2026 NOT AVAILABLE |
| 28.11. - 05.12.2026 13.485 € | 05.12. - 12.12.2026 10.923 € 12.850 € | 12.12. - 19.12.2026 10.026 € 11.795 € | 22.12. - 29.12.2026 NOT AVAILABLE |
| 02.01. - 09.01.2027 20.138 € 22.375 € | 09.01. - 16.01.2027 19.008 € 21.120 € | 16.01. - 23.01.2027 17.208 € 19.120 € | 23.01. - 30.01.2027 NOT AVAILABLE |
| 30.01. - 06.02.2027 17.730 € 19.700 € | 06.02. - 13.02.2027 18.572 € 20.635 € | 13.02. - 20.02.2027 19.031 € 21.145 € | 20.02. - 25.02.2027 NOT AVAILABLE |
| 27.02. - 06.03.2027 17.870 € 19.855 € | | | |



WEBSITE

www.plujeme.cz



E-MAIL

info@plujeme.cz



PHONE

+420 720 755 085



MOBILE

+420 777 170 276



PLUJEME RÁDI S.R.O.

Dlouhá 730/35, 11000 Praha 1 – Staré Město, Czech Republic

PRICE AND AVAILABILITY

| | | | |
|---|---|---|---|
| 06.03. - 13.03.2027 NOT AVAILABLE | 13.03. - 20.03.2027 14.657 € 16.285 € | 20.03. - 03.04.2027 NOT AVAILABLE | 03.04. - 10.04.2027 11.394 € 12.660 € |
| 11.04. - 18.04.2027 NOT AVAILABLE | 24.04. - 01.05.2027 8.969 € 9.965 € | 01.05. - 08.05.2027 7.227 € 8.030 € | 08.05. - 15.05.2027 5.994 € 6.660 € |
| 15.05. - 22.05.2027 5.364 € 5.960 € | 22.05. - 29.05.2027 5.364 € 5.960 € | 29.05. - 05.06.2027 5.364 € 5.960 € | 05.06. - 12.06.2027 5.364 € 5.960 € |
| 12.06. - 19.06.2027 5.364 € 5.960 € | 19.06. - 26.06.2027 5.364 € 5.960 € | 26.06. - 03.07.2027 5.364 € 5.960 € | 03.07. - 10.07.2027 5.364 € 5.960 € |
| 10.07. - 17.07.2027 5.364 € 5.960 € | 17.07. - 24.07.2027 6.102 € 6.780 € | 24.07. - 31.07.2027 6.102 € 6.780 € | 31.07. - 07.08.2027 6.102 € 6.780 € |
| 07.08. - 14.08.2027 5.832 € 6.480 € | 14.08. - 21.08.2027 5.364 € 5.960 € | 21.08. - 28.08.2027 5.364 € 5.960 € | 28.08. - 04.09.2027 5.364 € 5.960 € |
| 04.09. - 11.09.2027 5.364 € 5.960 € | 11.09. - 18.09.2027 5.364 € 5.960 € | 18.09. - 25.09.2027 5.364 € 5.960 € | 25.09. - 02.10.2027 5.379 € 5.977 € |
| 02.10. - 09.10.2027 6.296 € 6.995 € | 09.10. - 16.10.2027 6.327 € 7.030 € | 16.10. - 23.10.2027 7.682 € 8.535 € | 23.10. - 30.10.2027 9.018 € 10.020 € |
| 30.10. - 06.11.2027 11.048 € 12.275 € | | | |



WEBSITE
www.plujeme.cz



E-MAIL
info@plujeme.cz



PHONE
+420 720 755 085



MOBILE
+420 777 170 276



PLUJEME RÁDI S.R.O.
Dlouhá 730/35, 11000 Praha 1 – Staré Město, Czech Republic

PRICE AND AVAILABILITY

06.11. - 13.11.2027

12.767 € 14.185 €

13.11. - 20.11.2027

13.437 € 14.930 €

20.11. - 27.11.2027

13.757 € 15.285 €

27.11. - 04.12.2027

13.757 € 15.285 €

04.12. - 11.12.2027

13.104 € 14.560 €

11.12. - 18.12.2027

12.447 € 13.830 €

18.12. - 25.12.2027

16.466 € 18.295 €



WEBSITE

www.plujeme.cz



PHONE

+420 720 755 085



MOBILE

+420 777 170 276



E-MAIL

info@plujeme.cz



PLUJEME RÁDI S.R.O.

Dlouhá 730/35, 11000 Praha 1 – Staré Město, Czech Republic