

LAGOON 40

STENELLA (2020)

Catamaran Lagoon 40 STENELLA, built in 2020 is anchored in the Dubrovnik, Komolac, ACI Marina Dubrovnik, Dubrovnik region, Croatia. It has 4 + 2 cabins, can accommodate 8 + 2 + 2 people and has 4 toilets. Bed linen and kitchen equipment are included in the price.

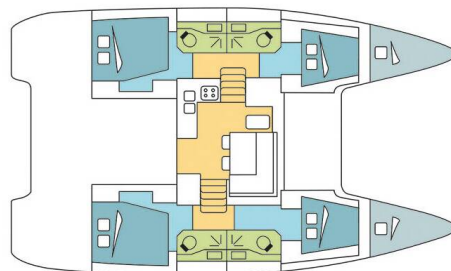

YACHT SPECIFICATIONS

Yacht Base

**Dubrovnik, Komolac, ACI Marina
Dubrovnik, Croatia**

Yacht ID

13842

Brands

Lagoon

Yacht name

STENELLA

Production year

2020

Length

39 ft

Cabins

4 + 2

Berths

8 + 2 + 2

Max Persons

12

WC

4

Engine

2 x 45 HP

Fuel tank

400 l



WEBSITE

www.plujeme.cz



PHONE

+420 720 755 085



MOBILE

+420 777 170 276



E-MAIL

info@plujeme.cz



PLUJEME RÁDI S.R.O.

Dlouhá 730/35, 11000 Praha 1 - Staré Město, Czech Republic

STANDARD YACHT EQUIPMENT

Comfort	Cockpit cushions
Deck	Bimini top, Cockpit table, Cockpit/stern, outside shower, Dinghy, Electric anchor windlass, Swimming ladder
Entertainment	Outdoor speakers, Radio
Galley	Oven, Refrigerator, Stove
Interior	Convertible table, Convertible table in salon, Electric fans in cabins, Electric toilet
Navigation	Autopilot, Depthsounder, GPS chart plotter, Speedometer (Speed log), Wind instrument/Anemometer
Safety	VHF radio
Sails	Electric winch, Lazy bag, Lazy jacks
Yacht electrics	Inverter, Solar panels, USB sockets



WEBSITE

www.plujeme.cz



E-MAIL

info@plujeme.cz



PHONE

+420 720 755 085



MOBILE

+420 777 170 276



PLUJEME RÁDI S.R.O.

Dlouhá 730/35, 11000 Praha 1 – Staré Město, Czech Republic

SERVICES

SELECTED SERVICES	OBLIGATORY	PAYMENT TYPE	PRICE
Handling fees (Payable now) Season: 2026.	Yes	per booking	20,00 €
Preparation fee (Payable now) Season: 2026. INCLUDED: starter pack – (1 gallon water or 4 bottles of 1.5L, 1 bottle of disinfectant, 1 small bottle of washing up liquid, 1 dish cloth, 1 sponge, garbage bags, 1 roll of paper towels, 1 box of matches, 1 roll of toilet paper in each head) // final cleaning // 1 set of bed sheets / cabin & 1 set of towels / pax, dinghy, outboard engine & initial supply of fuel, gas and water tanks // DYC assistance guarantee // 1st & last night in the marina // NOT INCLUDED: refuelling, gas & water consumption at end of charter, taxes if any, handling fees & additional equipment deposit.	Yes	per booking	355,00 €
Tourist tax (Payable at the base) Season: 2026. Payment by credit card only, no cash	Yes	per guest/day	1,33 €
Additional fee for Skipper in forepeak & shared bathroom (Payable now) Season: 2026. To be added with Skipper only ; Can be added for new bookings only confirmed after 21/05/2026 ; replaces skipper requirement to have their own toilet/shower. Guests must be aware that they'll need to give access to toilet/shower.	No	per night	50,00 €
Crew change (Payable now) Season: 2026. Any crew change during the charter is subject to € 250.- additional cost. The charge includes administration cost, change of bed linen and towels and one night at DYC ponton (marina fee included only if the same base than start base). It doesn't include cleaning, nor new transit log where applicable.	No	per booking	250,00 €
Damage waiver (Payable now) Season: 2026. Damage waiver limits your liability to the reduced Security Deposit . Mandatory when skipper is added. Price is per night of the charter (minimum value of 7 nights & a maximum value of 21 nights) Not applicable for 4+ weeks charters , nor Regattas/Races.	No	per night	45,00 €
Early boarding/ check-in (Payable now) Season: 2026. EB (boat only) - 13:00h, starting time of boat's delivery // limited number of early boardings on same departure day	No	per booking	340,00 €

Early boarding/check-in (Payable now)	No	per booking	460,00 €
<i>Season: 2026. EB + extra fee skipper - 13:00h, starting time of boat's delivery // limited number of early boardings on same departure day</i>			
Early boarding/check-in (Payable now)	No	per booking	560,00 €
<i>Season: 2026. EB + extra fee Skipper & Hostess - 13:00h, starting time of boat's delivery // limited number of early boardings on same departure day</i>			
Electric & Water consumption in the Marinas (Payable at the base)	No	per booking	28,00 €
<i>Season: 2026. Electric & Water consumption based on 2 nights on our dock (base will confirm the amount to pay locally depending on nights spent on dock)</i>			
Extra cleaning (Payable now)	No	per booking	285,00 €
<i>Season: 2026. Optional Additional cleaning</i>			
Extra set of linen (choose how many) (Payable now)	No	per booking	15,00 €
<i>Season: 2026. Extra set of linen : 15 € 1 extra set of linen (2 sheets & 2 pillow case) - to be updated manually</i>			
Extra set of towels (choose how many) (Payable now)	No	per booking	10,00 €
<i>Season: 2026. Extra set of towels: 10 € 1 extra set of towels (1 face & 1 bath towel) - to be updated manually</i>			
Full board 1-3 pax (number of guests to update manually) (Payable now)	No	per guest/day	75,00 €
<i>Season: 2026. only available if cook is booked on board as the cook will do the provisioning based on client's preference. Includes breakfast, lunch & dinner + the crew's food. Does not included alcoholic drinks</i>			
Full board 4-6 pax (number of guests to update manually) (Payable now)	No	per guest/day	60,00 €
<i>Season: 2026. only available if cook is booked on board as the cook will do the provisioning based on client's preference. Includes breakfast, lunch & dinner + the crew's food. Does not included alcoholic drinks</i>			
Full board 7-12 pax (number of guests to update manually) (Payable now)	No	per guest/day	55,00 €
<i>Season: 2026. only available if cook is booked on board as the cook will do the provisioning based on client's preference. Includes breakfast, lunch & dinner + the crew's food. Does not included alcoholic drinks</i>			
Half board 1-3 pax (number of guests to update manually) (Payable now)	No	per guest/day	60,00 €
<i>Season: 2026. only available if cook is booked on board as the cook will do the provisioning based on client's preference. Includes breakfast & lunch OR dinner + the crew's food. Does not included alcoholic drinks</i>			

<p>Half board 4-6 pax (number of guests to update manually) (Payable now)</p> <p>Season: 2026. only available if cook is booked on board as the cook will do the provisioning based on client's preference. Includes breakfast & lunch OR dinner + the crew's food. Does not included alcoholic drinks</p>	No	per guest/day	50,00 €
<p>Half board 7-12 pax (number of guests to update manually) (Payable now)</p> <p>Season: 2026. only available if cook is booked on board as the cook will do the provisioning based on client's preference. Includes breakfast & lunch OR dinner + the crew's food. Does not included alcoholic drinks</p>	No	per guest/day	45,00 €
<p>Hostess/Cook (Payable now)</p> <p>Season: 2026. + provisioning, Crew on board must have their own toilets/showers. If either a skipper or a hostess/cook is on board, 1 double cabin will be required for him/her. If both a skipper and a hostess/cook are on board, 1 double cabin and 1 forepeak cabin will be required for them. Exceptions exists for specific layouts, Sales Agents will provide more details about the different boat models</p>	No	per night	180,00 €
<p>Hostess/Cook (Payable now)</p> <p>Season: 2026. + provisioning, Crew on board must have their own toilets/showers. If either a skipper or a hostess/cook is on board, 1 double cabin will be required for him/her. If both a skipper and a hostess/cook are on board, 1 double cabin and 1 forepeak cabin will be required for them. Exceptions exists for specific layouts, Sales Agents will provide more details about the different boat models</p>	No	per night	180,00 €
<p>Hostess/Cook (Payable now)</p> <p>Season: 2026. + provisioning, Crew on board must have their own toilets/showers. If either a skipper or a hostess/cook is on board, 1 double cabin will be required for him/her. If both a skipper and a hostess/cook are on board, 1 double cabin and 1 forepeak cabin will be required for them. Exceptions exists for specific layouts, Sales Agents will provide more details about the different boat models</p>	No	per night	200,00 €
<p>Regatta surcharge (Payable now)</p> <p>Season: 2026. A special race deposit need to be doubled manually once the regatta surcharge is added.</p>	No	per booking	0,00 €
<p>Sailing to Montenegro (Payable at the base)</p> <p>Season: 2026. Mandatory for MonteNegro authorities that 2 people onboard possess a sailing licence of category B or C. It is DY/NY admin & insurance fee to sail to MonteNegro, independent to the vignette payable to customs exit and entry points in each country, per the obligatory official/customs process.</p>	No	per booking	300,00 €

<p>Skipper (Payable now)</p> <p>Season: 2026. + provisioning, Crew on board must have their own toilets/showers. If either a skipper or a hostess/cook is on board, 1 double cabin will be required for him/her. If both a skipper and a hostess/cook are on board, 1 double cabin and 1 forepeak cabin will be required for them. Exceptions exists for specific layouts, Sales Agents will provide more details about the different boat models</p>	No	per night	200,00 €
<p>Skipper (Payable now)</p> <p>Season: 2026. + provisioning, Crew on board must have their own toilets/showers. If either a skipper or a hostess/cook is on board, 1 double cabin will be required for him/her. If both a skipper and a hostess/cook are on board, 1 double cabin and 1 forepeak cabin will be required for them. Exceptions exists for specific layouts, Sales Agents will provide more details about the different boat models</p>	No	per night	200,00 €
<p>Skipper (Payable now)</p> <p>Season: 2026. + provisioning, Crew on board must have their own toilets/showers. If either a skipper or a hostess/cook is on board, 1 double cabin will be required for him/her. If both a skipper and a hostess/cook are on board, 1 double cabin and 1 forepeak cabin will be required for them. Exceptions exists for specific layouts, Sales Agents will provide more details about the different boat models</p>	No	per night	220,00 €
<p>Transfer (Payable now)</p> <p>Season: 2026. RT - Dubrovnik Airport / Base 1-8 PAX</p>	No	round trip	128,00 €
<p>WI-FI Internet connection on boat (Payable now)</p> <p>Season: 2026. Unlimited - included in price</p>	No	per week	32,00 €



WEBSITE
www.plujeme.cz



PHONE
+420 720 755 085



MOBILE
+420 777 170 276



E-MAIL
info@plujeme.cz



PLUJEME RÁDI S.R.O.
Dlouhá 730/35, 11000 Praha 1 – Staré Město, Czech Republic

ADDITIONAL EXTRAS

EXTRA	OBLIGATORY	PAYMENT TYPE	PRICE
Kayak single (Payable now) Season: 2026. Price per day - Payable now	No	per night	15,00 €
Kayak single (Payable now) Season: 2026. Price per day - Payable now	No	per night	15,00 €
Outboard engine 8 & 9,8 HP (Payable now) Season: 2026. Subject to Availability ; 8 & 9.8hp. Dinghy not suitable in any case for waterski or wakeboard. - Payable now	No	per day	35,00 €
Railing net (Safety net) (Payable now) Season: 2026. net is supplied but not installed - Payable now	No	per booking	250,00 €
Stand up paddle (SUP) (Payable now) Season: 2026. Price per day - Payable now	No	per night	15,00 €

**WEBSITE**www.plujeme.cz**E-MAIL**info@plujeme.cz**PHONE**

+420 720 755 085

**MOBILE**

+420 777 170 276

**PLUJEME RÁDI S.R.O.**

Dlouhá 730/35, 11000 Praha 1 – Staré Město, Czech Republic

PRICE AND AVAILABILITY

11.07. - 18.07.2026 4.718 € 5.550 €	18.07. - 25.07.2026 4.560 € 5.365 €	25.07. - 01.08.2026 NOT AVAILABLE	01.08. - 08.08.2026 NOT AVAILABLE
08.08. - 15.08.2026 NOT AVAILABLE	15.08. - 22.08.2026 NOT AVAILABLE	22.08. - 29.08.2026 NOT AVAILABLE	29.08. - 05.09.2026 NOT AVAILABLE
05.09. - 12.09.2026 NOT AVAILABLE	12.09. - 19.09.2026 NOT AVAILABLE	19.09. - 26.09.2026 NOT AVAILABLE	26.09. - 03.10.2026 NOT AVAILABLE
03.10. - 10.10.2026 1.942 € 2.285 €	10.10. - 17.10.2026 1.488 € 1.750 €	21.10. - 26.10.2026 NOT AVAILABLE	31.10. - 07.11.2026 1.488 € 1.750 €
07.11. - 14.11.2026 1.488 € 1.750 €	20.11. - 12.03.2027 NOT AVAILABLE		



WEBSITE

www.plujeme.cz



E-MAIL

info@plujeme.cz



PHONE

+420 720 755 085



MOBILE

+420 777 170 276



PLUJEME RÁDI S.R.O.

Dlouhá 730/35, 11000 Praha 1 – Staré Město, Czech Republic

PRICE AND AVAILABILITY

13.03. - 20.03.2027 1.575 € 1.750 €	20.03. - 27.03.2027 1.575 € 1.750 €	27.03. - 03.04.2027 1.575 € 1.750 €	03.04. - 10.04.2027 1.575 € 1.750 €
10.04. - 17.04.2027 1.575 € 1.750 €	17.04. - 24.04.2027 1.575 € 1.750 €	24.04. - 01.05.2027 1.665 € 1.850 €	01.05. - 08.05.2027 1.769 € 1.965 €
08.05. - 15.05.2027 2.129 € 2.365 €	15.05. - 22.05.2027 2.358 € 2.620 €	22.05. - 29.05.2027 2.790 € 3.100 €	29.05. - 05.06.2027 3.056 € 3.395 €
05.06. - 12.06.2027 3.974 € 4.415 €	12.06. - 19.06.2027 4.275 € 4.750 €	19.06. - 26.06.2027 4.581 € 5.090 €	26.06. - 03.07.2027 4.892 € 5.435 €
03.07. - 10.07.2027 5.265 € 5.850 €	10.07. - 17.07.2027 5.657 € 6.285 €	17.07. - 24.07.2027 5.909 € 6.565 €	24.07. - 31.07.2027 6.089 € 6.765 €
31.07. - 07.08.2027 6.426 € 7.140 €	07.08. - 14.08.2027 6.426 € 7.140 €	14.08. - 21.08.2027 6.120 € 6.800 €	21.08. - 28.08.2027 5.009 € 5.565 €
28.08. - 04.09.2027 4.793 € 5.325 €	04.09. - 11.09.2027 4.599 € 5.110 €	11.09. - 18.09.2027 4.365 € 4.850 €	18.09. - 25.09.2027 3.803 € 4.225 €
25.09. - 02.10.2027 2.952 € 3.280 €	02.10. - 09.10.2027 1.958 € 2.175 €	09.10. - 16.10.2027 1.575 € 1.750 €	16.10. - 23.10.2027 1.575 € 1.750 €
23.10. - 30.10.2027 1.575 € 1.750 €			



WEBSITE

www.plujeme.cz



E-MAIL

info@plujeme.cz



PHONE

+420 720 755 085



MOBILE

+420 777 170 276



PLUJEME RÁDI S.R.O.

Dlouhá 730/35, 11000 Praha 1 – Staré Město, Czech Republic