

DUFOUR 520 GL

CORMORANT (2019)

Sailing yacht Dufour 520 GL CORMORANT, built in 2019 is anchored in the **Olbia, Sardinia, Italy**. It has **5 cabins**, can accommodate **10 + 2 people** and has **3 toilets**. Bed linen and kitchen equipment are included in the price.

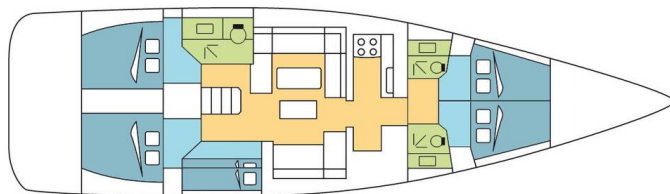

YACHT SPECIFICATIONS

Yacht Base

Olbia, Italy

Yacht ID

13826

Brands

Dufour

Yacht name

CORMORANT

Production year

2019

Length

50 ft

Cabins

5

Berths

10 + 2

Max Persons

12

WC

3

Engine

1 x 110 HP

Fuel tank

450 l



WEBSITE

www.plujeme.cz



PHONE

+420 720 755 085



MOBILE

+420 777 170 276



E-MAIL

info@plujeme.cz



PLUJEME RÁDI S.R.O.

Dlouhá 730/35, 11000 Praha 1 – Staré Město, Czech Republic

STANDARD YACHT EQUIPMENT

Comfort	Cockpit cushions
Deck	Bimini top, Cockpit table, Cockpit/stern, outside shower, Dinghy, Electric anchor windlass, Outboard engine, Swimming ladder
Entertainment	Outdoor speakers, Radio CD mp3 player
Galley	Microwave, Refrigerator
Interior	Convertible table, Convertible table in salon, Electric toilet
Navigation	Autopilot, GPS chart plotter, Wind instrument/Anemometer
Safety	VHF radio
Sails	Lazy bag, Lazy jacks
Yacht electrics	Air Conditioning, Generator, Inverter, Watermaker - desalinator



WEBSITE

www.plujeme.cz



E-MAIL

info@plujeme.cz



PHONE

+420 720 755 085



MOBILE

+420 777 170 276



PLUJEME RÁDI S.R.O.

Dlouhá 730/35, 11000 Praha 1 – Staré Město, Czech Republic

SERVICES

SELECTED SERVICES	OBLIGATORY	PAYMENT TYPE	PRICE
<p>Handling fees (Payable now)</p> <p>Season: 2026.</p>	Yes	per booking	25,00 €
<p>Preparation fee (Payable now)</p> <p>Season: 2026. INCLUDED: starter pack – (1 gallon water or 4 bottles of 1.5L, 1 bottle of disinfectant, 1 small bottle of washing up liquid, 1 dish cloth, 1 sponge, garbage bags, 1 roll of paper towels, 1 box of matches, 1 roll of toilet paper in each head) // final cleaning // 1 set of bed sheets / cabin & 1 set of towels / pax, dinghy, outboard engine & initial supply of fuel, gas and water tanks // DYC assistance guarantee // 1st & last night in the marina // NOT INCLUDED: refuelling, gas & water consumption at end of charter, taxes if any, handling fees & additional equipment deposit.</p>	Yes	per booking	360,00 €
<p>Crew change (Payable now)</p> <p>Season: 2026. Any crew change during the charter is subject to € 250.- additional cost. The charge includes administration cost, change of bed linen and towels and one night at DYC ponton (marina fee included only if the same base than start base). It doesn't include cleaning, nor new transit log where applicable.</p>	No	per booking	250,00 €
<p>Damage waiver (Payable now)</p> <p>Season: 2026. Damage waiver limits your liability to the reduced Security Deposit . Mandatory when skipper is added. Price is per night of the charter (minimum value of 7 nights & a maximum value of 21 nights). Not applicable for 4+ weeks charters , nor Regattas/Races.</p>	No	per night	50,00 €
<p>Early boarding/check-in (Payable now)</p> <p>Season: 2026. Early boarding - 13:00h, starting time of boat's delivery // limited number of early boardings on same departure day</p>	No	per booking	300,00 €
<p>Electric & Water consumption in the Marinas (Payable at the base)</p> <p>Season: 2026. Electric & Water consumption based on 2 nights on our dock (base will confirm the amount to pay locally depending on nights spent on dock)</p>	No	per booking	28,00 €
<p>Extra set of linen (choose how many) (Payable now)</p> <p>Season: 2026. Extra set of linen : 15 € 1 extra set of linen (2 sheets & 2 pillow case) - to be updated manually</p>	No	per booking	15,00 €

Extra set of towels (choose how many) (Payable now)	No	per booking	10,00 €
<i>Season: 2026. Extra set of towels: 10 € 1 extra set of towels (1 face & 1 bath towel) - to be updated manually</i>			
Full board 1-3 pax (number of guests to update manually) (Payable now)	No	per guest/day	75,00 €
<i>Season: 2026. only available if cook is booked on board as the cook will do the provisioning based on client's preference. Includes breakfast, lunch & dinner + the crew's food. Does not included alcoholic drinks</i>			
Full board 4-6 pax (number of guests to update manually) (Payable now)	No	per guest/day	60,00 €
<i>Season: 2026. only available if cook is booked on board as the cook will do the provisioning based on client's preference. Includes breakfast, lunch & dinner + the crew's food. Does not included alcoholic drinks</i>			
Full board 7-12 pax (number of guests to update manually) (Payable now)	No	per guest/day	55,00 €
<i>Season: 2026. only available if cook is booked on board as the cook will do the provisioning based on client's preference. Includes breakfast, lunch & dinner + the crew's food. Does not included alcoholic drinks</i>			
Half board 1-3 pax (number of guests to update manually) (Payable now)	No	per guest/day	60,00 €
<i>Season: 2026. only available if cook is booked on board as the cook will do the provisioning based on client's preference. Includes breakfast & lunch OR dinner + the crew's food. Does not included alcoholic drinks</i>			
Half board 4-6 pax (number of guests to update manually) (Payable now)	No	per guest/day	50,00 €
<i>Season: 2026. only available if cook is booked on board as the cook will do the provisioning based on client's preference. Includes breakfast & lunch OR dinner + the crew's food. Does not included alcoholic drinks</i>			
Half board 7-12 pax (number of guests to update manually) (Payable now)	No	per guest/day	45,00 €
<i>Season: 2026. only available if cook is booked on board as the cook will do the provisioning based on client's preference. Includes breakfast & lunch OR dinner + the crew's food. Does not included alcoholic drinks</i>			
Hostess/Cook (Payable at the base)	No	per night	170,00 €
<i>Season: 2026. + provisioning, Crew on board must have their own toilets/showers. If either a skipper or a hostess/cook is on board, 1 double cabin will be required for him/her. If both a skipper and a hostess/cook are on board, 1 double cabin and 1 forepeak cabin will be required for them. Exceptions exists for specific layouts, Sales Agents will provide more details about the different boat models // In Italy, law requires clients to pay hostess directly with a contract established between both parties</i>			

<p>Hostess/Cook (Payable at the base)</p> <p>Season: 2026. + provisioning, Crew on board must have their own toilets/showers. If either a skipper or a hostess/cook is on board, 1 double cabin will be required for him/her. If both a skipper and a hostess/cook are on board, 1 double cabin and 1 forepeak cabin will be required for them. Exceptions exists for specific layouts, Sales Agents will provide more details about the different boat models // In Italy, law requires clients to pay hostess directly with a contract established between both parties</p>	No	per night	170,00 €
<p>Hostess/Cook (Payable at the base)</p> <p>Season: 2026. + provisioning, Crew on board must have their own toilets/showers. If either a skipper or a hostess/cook is on board, 1 double cabin will be required for him/her. If both a skipper and a hostess/cook are on board, 1 double cabin and 1 forepeak cabin will be required for them. Exceptions exists for specific layouts, Sales Agents will provide more details about the different boat models // In Italy, law requires clients to pay hostess directly with a contract established between both parties</p>	No	per night	185,00 €
<p>Regatta surcharge (Payable now)</p> <p>Season: 2026. A special race deposit need to be doubled manually once the regatta surcharge is added.</p>	No	per booking	0,00 €
<p>Skipper (Payable at the base)</p> <p>Season: 2026. + provisioning, Crew on board must have their own toilets/showers. If either a skipper or a hostess/cook is on board, 1 double cabin will be required for him/her. If both a skipper and a hostess/cook are on board, 1 double cabin and 1 forepeak cabin will be required for them. Exceptions exists for specific layouts, Sales Agents will provide more details about the different boat models // In Italy, law requires clients to pay skipper directly with a contract established between both parties</p>	No	per night	200,00 €
<p>Skipper (Payable at the base)</p> <p>Season: 2026. + provisioning, Crew on board must have their own toilets/showers. If either a skipper or a hostess/cook is on board, 1 double cabin will be required for him/her. If both a skipper and a hostess/cook are on board, 1 double cabin and 1 forepeak cabin will be required for them. Exceptions exists for specific layouts, Sales Agents will provide more details about the different boat models // In Italy, law requires clients to pay skipper directly with a contract established between both parties</p>	No	per night	200,00 €

Skipper (Payable at the base) Season: 2026. + provisioning, Crew on board must have their own toilets/showers. If either a skipper or a hostess/cook is on board, 1 double cabin will be required for him/her. If both a skipper and a hostess/cook are on board, 1 double cabin and 1 forepeak cabin will be required for them. Exceptions exists for specific layouts, Sales Agents will provide more details about the different boat models // In Italy, law requires clients to pay skipper directly with a contract established between both parties	No	per night	220,00 €
Transfer (Payable now) Season: 2026. OW - Olbia Airport/Base 1-3 pax daytime (from 06:00 - 22:00) - In case of night transfers, prices from Olbia airport to base, should be raised by 15 € one-way, or 30 € round trip	No	one-way	45,00 €
Transfer (Payable now) Season: 2026. OW - Olbia Airport / Base 4-8 pax daytime (from 06:00 - 22:00) - In case of night transfers, prices from Olbia airport to base, should be raised by 15 € one-way, or 30 € round trip	No	one-way	74,00 €
Transfer (Payable now) Season: 2026. RT - Olbia Airport/Base 1-3 pax daytime (from 06:00 - 22:00) - In case of night transfers, prices from Olbia airport to base, should be raised by 15 € one-way, or 30 € round trip	No	round trip	90,00 €
Transfer (Payable now) Season: 2026. OW - Olbia Airport/Base 9-12 pax daytime (from 06:00 - 22:00) - In case of night transfers, prices from Olbia airport to base, should be raised by 15 € one-way, or 30 € round trip	No	one-way	136,00 €
Transfer (Payable now) Season: 2026. RT - Olbia Airport / Base 4-8 pax daytime (from 06:00 - 22:00) - In case of night transfers, prices from Olbia airport to base, should be raised by 15 € one-way, or 30 € round trip	No	round trip	148,00 €
Transfer (Payable now) Season: 2026. RT - Olbia Airport/Base 9-12 pax daytime (from 06:00 - 22:00) - In case of night transfers, prices from Olbia airport to base, should be raised by 15 € one-way, or 30 € round trip	No	round trip	272,00 €



WEBSITE
www.plujeme.cz



PHONE
+420 720 755 085



MOBILE
+420 777 170 276



E-MAIL
info@plujeme.cz



PLUJEME RÁDI S.R.O.
Dlouhá 730/35, 11000 Praha 1 - Staré Město, Czech Republic

ADDITIONAL EXTRAS

EXTRA	OBLIGATORY	PAYMENT TYPE	PRICE
Kayak single (Payable now) Season: 2026. Price per day - Payable now	No	per night	15,00 €
Kayak tandem (Payable now) Season: 2026. Price per day - Payable now	No	per night	15,00 €
Railing net (Safety net) (Payable now) Season: 2026. net is supplied but not installed - Payable now	No	per booking	230,00 €
Stand up paddle (SUP) (Payable now) Season: 2026. Price per day - Payable now	No	per night	15,00 €



WEBSITE

www.plujeme.cz



E-MAIL

info@plujeme.cz



PHONE

+420 720 755 085



MOBILE

+420 777 170 276



PLUJEME RÁDI S.R.O.

Dlouhá 730/35, 11000 Praha 1 – Staré Město, Czech Republic

PRICE AND AVAILABILITY

11.07. - 18.07.2026 3.556 € 4.445 €	18.07. - 25.07.2026 NOT AVAILABLE	25.07. - 01.08.2026 3.756 € 4.695 €	01.08. - 15.08.2026 NOT AVAILABLE
15.08. - 22.08.2026 5.376 € 6.325 €	22.08. - 29.08.2026 NOT AVAILABLE	29.08. - 05.09.2026 NOT AVAILABLE	05.09. - 12.09.2026 NOT AVAILABLE
12.09. - 19.09.2026 NOT AVAILABLE	19.09. - 26.09.2026 NOT AVAILABLE	26.09. - 03.10.2026 4.021 € 4.730 €	03.10. - 10.10.2026 NOT AVAILABLE
10.10. - 17.10.2026 NOT AVAILABLE	17.10. - 24.10.2026 NOT AVAILABLE	24.10. - 31.10.2026 1.908 € 2.245 €	31.10. - 07.11.2026 1.908 € 2.245 €
07.11. - 14.11.2026 1.908 € 2.245 €	20.11. - 12.03.2027 NOT AVAILABLE		



WEBSITE

www.plujeme.cz



E-MAIL

info@plujeme.cz



PHONE

+420 720 755 085



MOBILE

+420 777 170 276



PLUJEME RÁDI S.R.O.

Dlouhá 730/35, 11000 Praha 1 – Staré Město, Czech Republic

PRICE AND AVAILABILITY

13.03. - 20.03.2027 1.818 € 2.020 €	20.03. - 27.03.2027 1.818 € 2.020 €	27.03. - 03.04.2027 1.818 € 2.020 €	03.04. - 10.04.2027 1.818 € 2.020 €
10.04. - 17.04.2027 1.818 € 2.020 €	17.04. - 24.04.2027 1.818 € 2.020 €	24.04. - 01.05.2027 2.723 € 3.025 €	01.05. - 08.05.2027 2.723 € 3.025 €
08.05. - 15.05.2027 2.858 € 3.175 €	15.05. - 22.05.2027 3.281 € 3.645 €	22.05. - 29.05.2027 3.699 € 4.110 €	29.05. - 05.06.2027 4.010 € 4.455 €
05.06. - 12.06.2027 4.320 € 4.800 €	12.06. - 19.06.2027 4.914 € 5.460 €	19.06. - 26.06.2027 4.914 € 5.460 €	26.06. - 03.07.2027 4.914 € 5.460 €
03.07. - 10.07.2027 5.310 € 5.900 €	10.07. - 17.07.2027 6.008 € 6.675 €	17.07. - 24.07.2027 6.309 € 7.010 €	24.07. - 31.07.2027 6.714 € 7.460 €
31.07. - 07.08.2027 7.164 € 7.960 €	07.08. - 14.08.2027 7.164 € 7.960 €	14.08. - 21.08.2027 7.052 € 7.835 €	21.08. - 28.08.2027 5.720 € 6.355 €
28.08. - 04.09.2027 5.445 € 6.050 €	04.09. - 11.09.2027 5.967 € 6.630 €	11.09. - 18.09.2027 5.792 € 6.435 €	18.09. - 25.09.2027 5.144 € 5.715 €
25.09. - 02.10.2027 4.541 € 5.045 €	02.10. - 09.10.2027 3.321 € 3.690 €	09.10. - 16.10.2027 2.453 € 2.725 €	16.10. - 23.10.2027 2.021 € 2.245 €
23.10. - 30.10.2027 2.021 € 2.245 €	30.10. - 06.11.2027 2.021 € 2.245 €		



WEBSITE
www.plujeme.cz



E-MAIL
info@plujeme.cz



PHONE
+420 720 755 085



MOBILE
+420 777 170 276



PLUJEME RÁDI S.R.O.
Dlouhá 730/35, 11000 Praha 1 – Staré Město, Czech Republic

PRICE AND AVAILABILITY

06.11. - 13.11.2027

2.021 € 2.245 €

13.11. - 20.11.2027

2.021 € 2.245 €

20.11. - 27.11.2027

2.021 € 2.245 €

27.11. - 04.12.2027

2.021 € 2.245 €

04.12. - 11.12.2027

2.021 € 2.245 €

11.12. - 18.12.2027

2.021 € 2.245 €

18.12. - 25.12.2027

2.021 € 2.245 €



WEBSITE

www.plujeme.cz



E-MAIL

info@plujeme.cz



PHONE

+420 720 755 085



MOBILE

+420 777 170 276



PLUJEME RÁDI S.R.O.

Dlouhá 730/35, 11000 Praha 1 – Staré Město, Czech Republic