

# SUNREEF 70

Midori (2025)

Catamaran Sunreef 70 Midori, built in 2025 is anchored in the Marina Kastela, Split region, Croatia. It has **3 + 4 cabins**, can accommodate **6 + 4 people** and has **3 + 1 toilets**. Bed linen and kitchen equipment are included in the price.

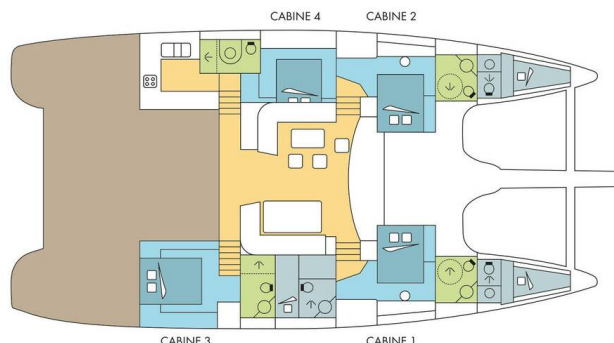

## YACHT SPECIFICATIONS

Yacht Base

**Marina Kastela, Croatia**

Yacht ID

**13773**

Brands

**Sunreef Yachts**

Yacht name

**Midori**

Production year

**2025**

Length

**70 ft**

Cabins

**3 + 4**

Berths

**6 + 4**

WC

**3 + 1**

Engine

**2 x 120 HP**

Fuel tank

**2000 l**



**WEBSITE**

[www.plujeme.cz](http://www.plujeme.cz)



**PHONE**

+420 720 755 085



**MOBILE**

+420 777 170 276



**E-MAIL**

[info@plujeme.cz](mailto:info@plujeme.cz)



**PLUJEME RÁDI S.R.O.**

Dlouhá 730/35, 11000 Praha 1 - Staré Město, Czech Republic

## STANDARD YACHT EQUIPMENT

Entertainment	<b>Board games, Floating mats, Jet Ski, Kayak tandem, Ringo, Seabob, Snorkeling equipment, Stand up paddle (SUP), Water toys, Water tube</b>
Navigation	<b>Bow thruster</b>
Safety	<b>Black Water Tank</b>
Sails	<b>Gennaker</b>
Yacht electrics	<b>12V Socket, 220V socket, Batteries, Generator, Plug 220V, 24 V, Service batteries</b>



#### WEBSITE

[www.plujeme.cz](http://www.plujeme.cz)



#### E-MAIL

[info@plujeme.cz](mailto:info@plujeme.cz)



#### PHONE

+420 720 755 085



#### MOBILE

+420 777 170 276



#### PLUJEME RÁDI S.R.O.

Dlouhá 730/35, 11000 Praha 1 – Staré Město, Czech Republic

## SERVICES

SELECTED SERVICES	OBLIGATORY	PAYMENT TYPE	PRICE
<b>APA (Advance Provisioning Allowance)</b> (Payable at the base) <b>Season: 2026.</b> Advance payment allowance serving to cover the costs of requested supplies, port, mooring charges, diesel and fuel, communications, extras dependent on guest particular request for services, itinerary, food, beverages etc. The Crew will keep an accurate record of spending and at the end of charter guest will be refunded or asked to pay the difference if additional operating costs have incurred.	Yes	per booking	<b>0,00 €</b>
<b>Crew</b> (Payable at the base) <b>Season: 2026.</b> 4 crew members included in price: Captain, Chef, Stewardess & Deck hand	Yes	per booking	<b>0,00 €</b>
<b>Steward/Cook</b> (Payable at the base) <b>Season: 2026.</b> Onboard Wellness & Culinary Experience - Ena Čulić	No	per service	<b>2.500,00 €</b>
<b>Transfer</b> (Payable at the base) <b>Season: 2026.</b> Split Airport - Marina Kaštela, 1-7 pax, PRICES TO BE CONFIRMED UPON REQUEST	No	one-way	<b>75,00 €</b>
<b>Transfer</b> (Payable at the base) <b>Season: 2026.</b> Zadar Airport - Marina Kaštela, 7 pax max, PRICES TO BE CONFIRMED UPON REQUEST	No	one-way	<b>500,00 €</b>
<b>Transfer</b> (Payable at the base) <b>Season: 2026.</b> Marina Kaštela - Dubrovnik, 7 pax max, PRICES TO BE CONFIRMED UPON REQUEST	No	one-way	<b>600,00 €</b>



**WEBSITE**

[www.plujeme.cz](http://www.plujeme.cz)



**PHONE**

+420 720 755 085



**MOBILE**

+420 777 170 276



**E-MAIL**

[info@plujeme.cz](mailto:info@plujeme.cz)



**PLUJEME RÁDI S.R.O.**

Dlouhá 730/35, 11000 Praha 1 – Staré Město, Czech Republic

## ADDITIONAL EXTRAS

EXTRA	OBLIGATORY	PAYMENT TYPE	PRICE
<b>Baby cot</b> (Payable at the base) <b>Season: 2026.</b> Aeromoov travel cot - Payable at the base	No	per week	<b>100,00 €</b>
<b>eFoil</b> (Payable at the base) <b>Season: 2026.</b> eFoil 5'0" Sport - Brushed White - Payable at the base	No	per week	<b>2.500,00 €</b>
<b>Kayak</b> (Payable at the base) <b>Season: 2026.</b> Payable at the base	No	per week	<b>100,00 €</b>
<b>Railing net (Safety net)</b> (Payable at the base) <b>Season: 2026.</b> Payable at the base	No	per booking	<b>150,00 €</b>
<b>Stand up paddle (SUP)</b> (Payable at the base) <b>Season: 2026.</b> Payable at the base	No	per week	<b>100,00 €</b>
<b>Wi-Fi Internet</b> (Payable at the base) <b>Season: 2026.</b> up to 75 GB of data traffic @4G - Payable at the base	No	per week	<b>50,00 €</b>

**WEBSITE**[www.plujeme.cz](http://www.plujeme.cz)**E-MAIL**[info@plujeme.cz](mailto:info@plujeme.cz)**PHONE**

+420 720 755 085

**MOBILE**

+420 777 170 276

**PLUJEME RÁDI S.R.O.**

Dlouhá 730/35, 11000 Praha 1 – Staré Město, Czech Republic

## PRICE AND AVAILABILITY

22.06. - 23.06.2026 NOT AVAILABLE	27.06. - 04.07.2026 84.750 €	04.07. - 18.07.2026 NOT AVAILABLE	18.07. - 25.07.2026 84.750 €
25.07. - 01.08.2026 84.750 €	01.08. - 08.08.2026 84.750 €	08.08. - 15.08.2026 84.750 €	15.08. - 27.08.2026 NOT AVAILABLE
29.08. - 05.09.2026 84.750 €	05.09. - 12.09.2026 84.750 €	12.09. - 19.09.2026 76.840 €	19.09. - 26.09.2026 76.840 €
26.09. - 03.10.2026 76.840 €	03.10. - 10.10.2026 76.840 €	10.10. - 17.10.2026 76.840 €	17.10. - 24.10.2026 76.840 €
24.10. - 31.10.2026 76.840 €	31.10. - 07.11.2026 76.840 €	07.11. - 14.11.2026 76.840 €	14.11. - 21.11.2026 76.840 €
21.11. - 28.11.2026 76.840 €	28.11. - 05.12.2026 76.840 €	05.12. - 12.12.2026 76.840 €	12.12. - 19.12.2026 76.840 €
19.12. - 26.12.2026 76.840 €			



**WEBSITE**  
www.plujeme.cz



**E-MAIL**  
info@plujeme.cz



**PHONE**  
+420 720 755 085



**MOBILE**  
+420 777 170 276



**PLUJEME RÁDI S.R.O.**  
Dlouhá 730/35, 11000 Praha 1 – Staré Město, Czech Republic