

DUFOUR 460 GL

ERASMUS (2017)

Sailing yacht Dufour 460 GL ERASMUS, built in 2017 is anchored in the **Trogir, Yachtclub Seget (Marina Baotic), Split region, Croatia**. It has **4 cabins**, can accommodate **10 + 2 people** and has **4 toilets**. Bed linen and kitchen equipment are included in the price.

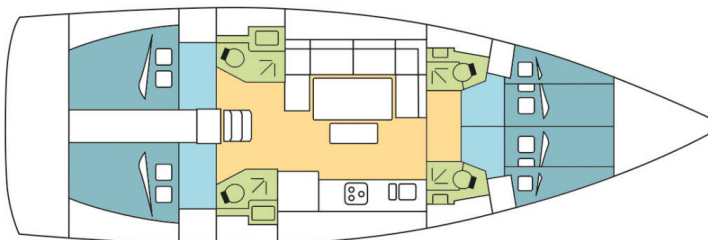

YACHT SPECIFICATIONS

Yacht Base

Trogir, Yachtclub Seget (Marina Baotic), Croatia

Yacht ID

13718

Brands

Dufour

Yacht name

ERASMUS

Production year

2017

Length

46 ft

Cabins

4

Berths

10 + 2

Max Persons

10

WC

4

Engine

1 x 55 HP

Fuel tank

250 l



WEBSITE

www.plujeme.cz



PHONE

+420 720 755 085



MOBILE

+420 777 170 276



E-MAIL

info@plujeme.cz



PLUJEME RÁDI S.R.O.

Dlouhá 730/35, 11000 Praha 1 – Staré Město, Czech Republic

STANDARD YACHT EQUIPMENT

Comfort	Cockpit cushions
Deck	Bimini top, Cockpit table, Cockpit/stern, outside shower, Dinghy, Electric anchor windlass, Outboard engine, Swimming ladder
Entertainment	Outdoor speakers, Radio CD mp3 player
Galley	Oven, Refrigerator, Stove
Interior	Convertible table, Convertible table in salon, Electric fans in cabins
Navigation	Autopilot, Depthsounder, GPS chart plotter, Speedometer (Speed log), Wind instrument/Anemometer
Safety	VHF radio
Sails	Self tailing (manual) winch
Yacht electrics	Inverter



WEBSITE

www.plujeme.cz



E-MAIL

info@plujeme.cz



PHONE

+420 720 755 085



MOBILE

+420 777 170 276



PLUJEME RÁDI S.R.O.

Dlouhá 730/35, 11000 Praha 1 – Staré Město, Czech Republic

SERVICES

SELECTED SERVICES	OBLIGATORY	PAYMENT TYPE	PRICE
Handling fees (Payable now) Season: 2026.	Yes	per booking	20,00 €
Preparation fee (Payable now) Season: 2026. INCLUDED: starter pack – (1 gallon water or 4 bottles of 1.5L, 1 bottle of disinfectant, 1 small bottle of washing up liquid, 1 dish cloth, 1 sponge, garbage bags, 1 roll of paper towels, 1 box of matches, 1 roll of toilet paper in each head) // final cleaning // 1 set of bed sheets / cabin & 1 set of towels / pax, dinghy, outboard engine & initial supply of fuel, gas and water tanks // DYC assistance guarantee // 1st & last night in the marina // NOT INCLUDED: refuelling, gas & water consumption at end of charter, taxes if any, handling fees & additional equipment deposit.	Yes	per booking	305,00 €
Tourist tax (Payable at the base) Season: 2026. Payment by credit card only, no cash	Yes	per guest/day	1,33 €
Crew change (Payable now) Season: 2026. Any crew change during the charter is subject to € 250.- additional cost. The charge includes administration cost, change of bed linen and towels and one night at DYC ponton (marina fee included only if the same base than start base). It doesn't include cleaning, nor new transit log where applicable.	No	per booking	250,00 €
Damage waiver (Payable now) Season: 2026. Damage waiver limits your liability to the reduced Security Deposit . Mandatory when skipper is added. Price is per night of the charter (minimum value of 7 nights & a maximum value of 21 nights). Not applicable for 4+ weeks charters , nor Regattas/Races.	No	per night	45,00 €
Early boarding/check-in (Payable now) Season: 2026. EB (boat only) - 13:00h, starting time of boat's delivery // limited number of early boardings on same departure day	No	per booking	250,00 €
Early boarding/check-in (Payable now) Season: 2026. EB + extra fee skipper - 13:00h, starting time of boat's delivery // limited number of early boardings on same departure day	No	per booking	360,00 €
Early boarding/check-in (Payable now) Season: 2026. EB + extra fee Skipper & Hostess - 13:00h, starting time of boat's delivery // limited number of early boardings on same departure day	No	per booking	470,00 €

Electric & Water consumption in the Marinas (Payable at the base)	No	per booking	22,00 €
<i>Season: 2026. Electric & Water consumption based on 2 nights on our dock (base will confirm the amount to pay locally depending on nights spent on dock)</i>			
Extra cleaning (Payable now)	No	per booking	260,00 €
<i>Season: 2026. Optional Additional cleaning</i>			
Extra set of linen (choose how many) (Payable now)	No	per booking	15,00 €
<i>Season: 2026. Extra set of linen : 15 € 1 extra set of linen (2 sheets & 2 pillow case) - to be updated manually</i>			
Extra set of towels (choose how many) (Payable now)	No	per booking	10,00 €
<i>Season: 2026. Extra set of towels: 10 € 1 extra set of towels (1 face & 1 bath towel) - to be updated manually</i>			
Full board 1-3 pax (number of guests to update manually) (Payable now)	No	per guest/day	75,00 €
<i>Season: 2026. only available if cook is booked on board as the cook will do the provisioning based on client's preference. Includes breakfast, lunch & dinner + the crew's food. Does not included alcoholic drinks</i>			
Full board 4-6 pax (number of guests to update manually) (Payable now)	No	per guest/day	60,00 €
<i>Season: 2026. only available if cook is booked on board as the cook will do the provisioning based on client's preference. Includes breakfast, lunch & dinner + the crew's food. Does not included alcoholic drinks</i>			
Full board 7-12 pax (number of guests to update manually) (Payable now)	No	per guest/day	55,00 €
<i>Season: 2026. only available if cook is booked on board as the cook will do the provisioning based on client's preference. Includes breakfast, lunch & dinner + the crew's food. Does not included alcoholic drinks</i>			
Half board 1-3 pax (number of guests to update manually) (Payable now)	No	per guest/day	60,00 €
<i>Season: 2026. only available if cook is booked on board as the cook will do the provisioning based on client's preference. Includes breakfast & lunch OR dinner + the crew's food. Does not included alcoholic drinks</i>			
Half board 4-6 pax (number of guests to update manually) (Payable now)	No	per guest/day	50,00 €
<i>Season: 2026. only available if cook is booked on board as the cook will do the provisioning based on client's preference. Includes breakfast & lunch OR dinner + the crew's food. Does not included alcoholic drinks</i>			
Half board 7-12 pax (number of guests to update manually) (Payable now)	No	per guest/day	45,00 €
<i>Season: 2026. only available if cook is booked on board as the cook will do the provisioning based on client's preference. Includes breakfast & lunch OR dinner + the crew's food. Does not included alcoholic drinks</i>			

<p>Hostess/Cook (Payable now)</p> <p>Season: 2026. + provisioning, Crew on board must have their own toilets/showers. If either a skipper or a hostess/cook is on board, 1 double cabin will be required for him/her. If both a skipper and a hostess/cook are on board, 1 double cabin and 1 forepeak cabin will be required for them. Exceptions exists for specific layouts, Sales Agents will provide more details about the different boat models</p>	No	per night	180,00 €
<p>Hostess/Cook (Payable now)</p> <p>Season: 2026. + provisioning, Crew on board must have their own toilets/showers. If either a skipper or a hostess/cook is on board, 1 double cabin will be required for him/her. If both a skipper and a hostess/cook are on board, 1 double cabin and 1 forepeak cabin will be required for them. Exceptions exists for specific layouts, Sales Agents will provide more details about the different boat models</p>	No	per night	180,00 €
<p>Hostess/Cook (Payable now)</p> <p>Season: 2026. + provisioning, Crew on board must have their own toilets/showers. If either a skipper or a hostess/cook is on board, 1 double cabin will be required for him/her. If both a skipper and a hostess/cook are on board, 1 double cabin and 1 forepeak cabin will be required for them. Exceptions exists for specific layouts, Sales Agents will provide more details about the different boat models</p>	No	per night	200,00 €
<p>Regatta surcharge (Payable now)</p> <p>Season: 2026. A special race deposit need to be doubled manually once the regatta surcharge is added.</p>	No	per booking	0,00 €
<p>Skipper (Payable now)</p> <p>Season: 2026. + provisioning, Crew on board must have their own toilets/showers. If either a skipper or a hostess/cook is on board, 1 double cabin will be required for him/her. If both a skipper and a hostess/cook are on board, 1 double cabin and 1 forepeak cabin will be required for them. Exceptions exists for specific layouts, Sales Agents will provide more details about the different boat models</p>	No	per night	200,00 €
<p>Skipper (Payable now)</p> <p>Season: 2026. + provisioning, Crew on board must have their own toilets/showers. If either a skipper or a hostess/cook is on board, 1 double cabin will be required for him/her. If both a skipper and a hostess/cook are on board, 1 double cabin and 1 forepeak cabin will be required for them. Exceptions exists for specific layouts, Sales Agents will provide more details about the different boat models</p>	No	per night	200,00 €

Skipper (Payable now)	No	per night	220,00 €
Season: 2026. + provisioning, Crew on board must have their own toilets/showers. If either a skipper or a hostess/cook is on board, 1 double cabin will be required for him/her. If both a skipper and a hostess/cook are on board, 1 double cabin and 1 forepeak cabin will be required for them. Exceptions exists for specific layouts, Sales Agents will provide more details about the different boat models			
Transfer (Payable now)	No	round trip	82,00 €
Season: 2026. RT - Split Airport / Base 1 - 4 pax			
Transfer (Payable now)	No	round trip	96,00 €
Season: 2026. RT - Split Airport / Base 5 - 8 pax			
WI-FI Internet connection on boat (Payable now)	No	per week	32,00 €
Season: 2026. Unlimited - included in price			



WEBSITE

www.plujeme.cz



E-MAIL

info@plujeme.cz



PHONE

+420 720 755 085



MOBILE

+420 777 170 276



PLUJEME RÁDI S.R.O.

Dlouhá 730/35, 11000 Praha 1 – Staré Město, Czech Republic

ADDITIONAL EXTRAS

EXTRA	OBLIGATORY	PAYMENT TYPE	PRICE
Kayak single (Payable now) Season: 2026. Price per day - Payable now	No	per night	15,00 €
Kayak single (Payable now) Season: 2026. Price per day - Payable now	No	per night	15,00 €
Railing net (Safety net) (Payable now) Season: 2026. net is supplied but not installed - Payable now	No	per booking	230,00 €
Stand up paddle (SUP) (Payable now) Season: 2026. Price per day - Payable now	No	per night	15,00 €

**WEBSITE**www.plujeme.cz**E-MAIL**info@plujeme.cz**PHONE**

+420 720 755 085

**MOBILE**

+420 777 170 276

**PLUJEME RÁDI S.R.O.**

Dlouhá 730/35, 11000 Praha 1 – Staré Město, Czech Republic