

OCEANIS 51.1

Myrdia (2018)

Sailing yacht Oceanis 51.1 Myrdia, built in 2018 is anchored in the Athens, Alimos marina, Athens area/Saronic/Peloponese, Greece. It has 4 + 1 cabins, can accommodate 8 + 2 people and has 4 + 1 toilets. Bed linen and kitchen equipment are included in the price.

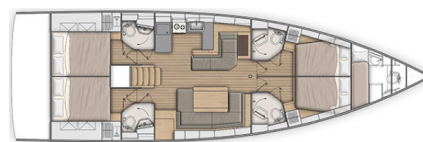

YACHT SPECIFICATIONS

Yacht Base

Athens, Alimos marina, Greece

Yacht ID

13707

Brands

Beneteau

Yacht name

Myrdia

Production year

2018

Length

52 ft

Cabins

4 + 1

Berths

8 + 2

WC

4 + 1

Engine

1 x 110 HP

Fuel tank

400 l



WEBSITE

www.plujeme.cz



PHONE

+420 720 755 085



MOBILE

+420 777 170 276



E-MAIL

info@plujeme.cz



PLUJEME RÁDI S.R.O.

Dlouhá 730/35, 11000 Praha 1 – Staré Město, Czech Republic

STANDARD YACHT EQUIPMENT

Comfort	Cockpit cushions
Deck	Bathing platform, Bimini top, Dinghy, Electric anchor windlass, Gangway, Outboard engine, Sprayhood, Swimming ladder, Teak cockpit
Entertainment	Outdoor speakers, Radio CD mp3 player + USB, Bluetooth, Snorkeling equipment, Stand up paddle (SUP) - FREE
Galley	NESPRESSO coffee machine, Oven, Refrigerator, Stove
Interior	Electric fans, Electric toilet
Navigation	Autopilot, Bow thruster, GPS chart plotter - cockpit
Yacht electrics	Air Conditioning, Generator, Solar panels, Watermaker - desalinator



WEBSITE

www.plujeme.cz



E-MAIL

info@plujeme.cz



PHONE

+420 720 755 085



MOBILE

+420 777 170 276



PLUJEME RÁDI S.R.O.

Dlouhá 730/35, 11000 Praha 1 – Staré Město, Czech Republic

SERVICES

SELECTED SERVICES	OBLIGATORY	PAYMENT TYPE	PRICE
Charter pack (Payable at the base) Season: 2026. includes end cleaning, gas bottle, fuel for the outboard, mooring fee for the first and last night	Yes	per booking	290,00 €
Welcome package (Payable at the base) Season: 2026. selection of Greek products and bath amenities, Mooring fees for first & last night at the marina / port, first fill for outboard engine, spare bottle of gas, autopilot , GPS/Plotter, Radio/Music Player & cockpit speakers, dinghy with outboard engine, 1 set of linen and towels per person per week, Snorkeling equipment (all adult sizes), espresso coffee maker (only for platinum fleet yachts), 1 SUP (for monohull charters 50 ft and larger and for catamaran charters up to 44ft), 2 SUP (for catamarans 44ft and larger)	Yes	per booking	0,00 €
Cook (Payable at the base) Season: 2026.	No	per day + food	190,00 €
Crew change (Payable at the base) Season: 2026. (skipper remains the same) - the cost covers expenses for port authorities formalities, bed linen/towels and marina fees. In case cleaning is needed the cost is as per the Price list.	No	per booking	200,00 €
Damage waiver (Payable at the base) Season: 2026. non-refundable + refundable deposit 800 EUR	No	per week	400,00 €
Fast Track pack (Payable at the base) Season: 2026. early embarkation at 14:00 (upon request and subject to no damages from previous charter)	No	per booking	180,00 €
Hostess (Payable at the base) Season: 2026.	No	per day + food	180,00 €
One way (Payable at the base) Season: 2026. Athens - Lavrion	No	one-way	400,00 €
One way (Payable at the base) Season: 2026. Athens - Paros	No	one-way	900,00 €
One way (Payable at the base) Season: 2026. Athens - Lefkas	No	one-way	1.400,00 €

Skipper (Payable at the base)	No	per day + food	200,00 €
Season: 2026.			
Transfer (Payable at the base)	No	one-way	60,00 €
Season: 2026. Athens Airport - Lavrion base; taxi 1 - 3 pax			
Transfer (Payable at the base)	No	one-way	60,00 €
Season: 2026. Airport - Athens base; taxi 1 - 3 pax			
Transfer (Payable at the base)	No	one-way	100,00 €
Season: 2026. Airport - Athens base; minivan up to 8 pax			
Transfer (Payable at the base)	No	one-way	120,00 €
Season: 2026. Athens Airport - Lavrion base; minivan up to 8 pax			
Transfer (Payable at the base)	No	one-way	180,00 €
Season: 2026. Athens Airport - Lavrion base; minivan up to 20 pax			
Transfer (Payable at the base)	No	one-way	180,00 €
Season: 2026. Airport - Athens base; minivan up to 16 pax			
Transfer (Payable at the base)	No	one-way	300,00 €
Season: 2026. Airport - Athens base; bus up to 50 pax			
WI-FI Internet connection on boat (Payable at the base)	No	per week	90,00 €
Season: 2026. unlimited data			



WEBSITE

www.plujeme.cz



E-MAIL

info@plujeme.cz



PHONE

+420 720 755 085



MOBILE

+420 777 170 276



PLUJEME RÁDI S.R.O.

Dlouhá 730/35, 11000 Praha 1 - Staré Město, Czech Republic

ADDITIONAL EXTRAS

EXTRA	OBLIGATORY	PAYMENT TYPE	PRICE
Beach towel (Payable at the base) Season: 2026. Payable at the base	No	per piece	10,00 €
Extra bedlinen (Payable at the base) Season: 2026. Payable at the base	No	per person	10,00 €
Grill/Barbecue/Plancha (Payable at the base) Season: 2026. Portable, single use - Payable at the base	No	per piece	15,00 €
Inflatable lifejacket (Payable at the base) Season: 2026. Payable at the base	No	per week/ person	30,00 €
Railing net (Safety net) (Payable at the base) Season: 2026. installed - Payable at the base	No	per booking	250,00 €
Stand up paddle (SUP) (Payable at the base) Season: 2026. Payable at the base	No	per week	120,00 €

**WEBSITE**www.plujeme.cz**E-MAIL**info@plujeme.cz**PHONE**

+420 720 755 085

**MOBILE**

+420 777 170 276

**PLUJEME RÁDI S.R.O.**

Dlouhá 730/35, 11000 Praha 1 – Staré Město, Czech Republic

PRICE AND AVAILABILITY

09.05. - 16.05.2026 4.050 € 4.500 €	16.05. - 23.05.2026 3.240 € 4.500 €	23.05. - 30.05.2026 4.020 € 6.000 €	30.05. - 06.06.2026 3.360 € 6.000 €
06.06. - 13.06.2026 4.422 € 6.600 €	13.06. - 20.06.2026 4.290 € 6.600 €	20.06. - 27.06.2026 4.620 € 7.000 €	27.06. - 04.07.2026 4.970 € 7.000 €
04.07. - 11.07.2026 4.830 € 7.000 €	11.07. - 18.07.2026 5.475 € 7.300 €	18.07. - 25.07.2026 5.475 € 7.300 €	25.07. - 01.08.2026 5.475 € 7.300 €
01.08. - 08.08.2026 6.120 € 8.500 €	08.08. - 15.08.2026 6.120 € 8.500 €	15.08. - 22.08.2026 6.460 € 8.500 €	22.08. - 29.08.2026 5.402 € 7.400 €
29.08. - 05.09.2026 4.958 € 7.400 €	05.09. - 12.09.2026 5.476 € 7.400 €	12.09. - 19.09.2026 6.120 € 6.800 €	19.09. - 26.09.2026 4.896 € 6.800 €
26.09. - 03.10.2026 NOT AVAILABLE	03.10. - 10.10.2026 ON OPTION	10.10. - 17.10.2026 3.871 € 4.900 €	17.10. - 24.10.2026 2.960 € 3.700 €
24.10. - 31.10.2026 2.960 € 3.700 €	31.10. - 07.11.2026 2.960 € 3.700 €	07.11. - 14.11.2026 3.330 € 3.700 €	14.11. - 21.11.2026 3.330 € 3.700 €
21.11. - 28.11.2026 3.330 € 3.700 €	28.11. - 05.12.2026 3.330 € 3.700 €	05.12. - 12.12.2026 3.330 € 3.700 €	12.12. - 19.12.2026 3.330 € 3.700 €
19.12. - 26.12.2026 3.330 € 3.700 €			



WEBSITE
www.plujeme.cz



E-MAIL
info@plujeme.cz



PHONE
+420 720 755 085



MOBILE
+420 777 170 276



PLUJEME RÁDI S.R.O.
Dlouhá 730/35, 11000 Praha 1 – Staré Město, Czech Republic