

ELAN 344 IMPRESSION

Argo (2006)

Sailing yacht **Elan 344 Impression Argo**, built in **2006** is anchored in the **Preveza Marina, Ionian Islands, Greece**. It has **3 cabins**, can accommodate **6 people** and has **1 toilets**. Bed linen and kitchen equipment are included in the price.

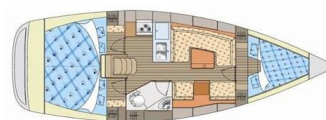

YACHT SPECIFICATIONS

Yacht Base

Preveza Marina, Greece

Yacht ID

13610

Brands

Elan Marine

Yacht name

Argo

Production year

2006

Length

34 ft

Cabins

3

Berths

6

Max Persons

6

WC

1

Engine

1 x 29 HP

Fuel tank

110 l



WEBSITE

www.plujeme.cz



PHONE

+420 720 755 085



MOBILE

+420 777 170 276



E-MAIL

info@plujeme.cz



PLUJEME RÁDI S.R.O.

Dlouhá 730/35, 11000 Praha 1 – Staré Město, Czech Republic

STANDARD YACHT EQUIPMENT

Comfort

Towels

Deck

Bimini top, Cockpit/stern, outside shower, Dinghy

Entertainment

Indoor speakers, Outdoor speakers, Sound System

Galley

Kitchen utensils (Galley equipment, cutlery), Oven, Refrigerator, Sink, Stove

Interior

Inside shower

Navigation

Autopilot, GPS chart plotter - cockpit



WEBSITE

www.plujeme.cz



E-MAIL

info@plujeme.cz



PHONE

+420 720 755 085



MOBILE

+420 777 170 276



PLUJEME RÁDI S.R.O.

Dlouhá 730/35, 11000 Praha 1 – Staré Město, Czech Republic

SERVICES

SELECTED SERVICES	OBLIGATORY	PAYMENT TYPE	PRICE
Final cleaning <i>(Payable at the base)</i> Season: 2026.	Yes	per booking	160,00 €
Early Check in <i>(Payable at the base)</i> Season: 2026.	No	per booking	100,00 €



WEBSITE

www.plujeme.cz



E-MAIL

info@plujeme.cz



PHONE

+420 720 755 085



MOBILE

+420 777 170 276



PLUJEME RÁDI S.R.O.

Dlouhá 730/35, 11000 Praha 1 – Staré Město, Czech Republic

ADDITIONAL EXTRAS

EXTRA	OBLIGATORY	PAYMENT TYPE	PRICE
Railing net (Safety net) <i>(Payable at the base)</i> Season: 2026. <i>Payable at the base</i>	No	per week	150,00 €
Stand up paddle (SUP) <i>(Payable at the base)</i> Season: 2026. <i>Payable at the base</i>	No	per week	100,00 €

**WEBSITE**

www.plujeme.cz

**E-MAIL**

info@plujeme.cz

**PHONE**

+420 720 755 085

**MOBILE**

+420 777 170 276

**PLUJEME RÁDI S.R.O.**

Dlouhá 730/35, 11000 Praha 1 – Staré Město, Czech Republic

PRICE AND AVAILABILITY

02.05. - 09.05.2026 1.350 €	09.05. - 16.05.2026 1.350 €	16.05. - 23.05.2026 1.350 €	23.05. - 30.05.2026 1.600 €
30.05. - 06.06.2026 1.600 €	06.06. - 13.06.2026 1.600 €	13.06. - 20.06.2026 1.750 €	20.06. - 27.06.2026 1.880 €
27.06. - 04.07.2026 1.880 €	04.07. - 11.07.2026 1.880 €	11.07. - 18.07.2026 2.100 €	18.07. - 25.07.2026 2.100 €
25.07. - 01.08.2026 2.300 €	01.08. - 08.08.2026 2.300 €	08.08. - 15.08.2026 2.300 €	15.08. - 22.08.2026 2.300 €
22.08. - 29.08.2026 2.100 €	29.08. - 05.09.2026 2.100 €	05.09. - 12.09.2026 2.100 €	12.09. - 19.09.2026 1.880 €
19.09. - 26.09.2026 1.750 €	26.09. - 03.10.2026 NOT AVAILABLE	03.10. - 10.10.2026 1.350 €	10.10. - 17.10.2026 1.350 €
17.10. - 24.10.2026 1.350 €	24.10. - 31.10.2026 1.350 €	31.10. - 07.11.2026 1.200 €	07.11. - 14.11.2026 1.200 €
14.11. - 21.11.2026 1.200 €	21.11. - 28.11.2026 1.200 €	28.11. - 05.12.2026 1.200 €	05.12. - 12.12.2026 1.200 €
12.12. - 19.12.2026 1.200 €	19.12. - 26.12.2026 1.200 €		



WEBSITE
www.plujeme.cz



E-MAIL
info@plujeme.cz



PHONE
+420 720 755 085



MOBILE
+420 777 170 276



PLUJEME RÁDI S.R.O.
Dlouhá 730/35, 11000 Praha 1 – Staré Město, Czech Republic