

# HANSE 388

Cassis (2019)

Sailing yacht **Hanse 388 Cassis**, built in **2019** is anchored in the **Trogir, Yachtclub Seget (Marina Baotic), Split region, Croatia**. It has **3 cabins**, can accommodate **6 + 1 people** and has **2 toilets**. Bed linen and kitchen equipment are included in the price.

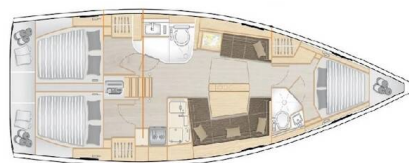

## YACHT SPECIFICATIONS

Yacht Base

**Trogir, Yachtclub Seget (Marina Baotic), Croatia**

Yacht ID

**1358**

Brands

**Hanse Yachts**

Yacht name

**Cassis**

Production year

**2019**

Length

**37 ft**

Cabins

**3**

Berths

**6 + 1**

Max Persons

**9**

WC

**2**

Engine

**1 x 39 HP**

Fuel tank

**160 l**



**WEBSITE**

[www.plujeme.cz](http://www.plujeme.cz)



**PHONE**

+420 720 755 085



**MOBILE**

+420 777 170 276



**E-MAIL**

[info@plujeme.cz](mailto:info@plujeme.cz)



**PLUJEME RÁDI S.R.O.**

Dlouhá 730/35, 11000 Praha 1 – Staré Město, Czech Republic

## STANDARD YACHT EQUIPMENT

Additional	<b>Flag</b>
Comfort	<b>Blankets, Pillows, Sheets</b>
Deck	<b>Anchor with chain, Anchor with rope, Bilge pump - Mechanic, Bimini top, Boat hook, Bosun's chair (Safe seat) (boatswain's chair), Canister for water, Cockpit table, Cockpit/stern, outside shower, Deck brush, Dinghy, Dinghy (byboat) pump, Electric anchor windlass, Fenders, Floating rope, Gangway, Impeller, Jerry cans for fuel, Mooring ropes, Round/globular fender, Sprayhood, Water hose, Winch handles</b>
Entertainment	<b>Outdoor speakers, Radio CD player</b>
Galley	<b>Broom and dustpan, Gas bottles, Gas cookers, Hot water, Kitchen utensils (Galley equipment, cutlery), Refrigerator</b>
Interior	<b>Clock, Clothes hangers, Toilet brush</b>
Navigation	<b>Autopilot, Binoculars, Complete navigation equipment, GPS chart plotter, Harbour guides, Logge/Lot/Speed/Wind, Nautical charts, Radar reflector</b>
Safety	<b>Emergency tiller, Fire extinguisher, First aid kit, Flashlight, Fog horn, Life belts (Safety harness), Life buoy + Flashing light, Life jackets, Oars (Paddles), Set of tools, Signal flags, VHF radio</b>
Yacht electrics	<b>Ac 230V cable, Battery charger, Bilge pump - Electric, Service batteries, Solar panels, Start battery</b>



**WEBSITE**

[www.plujeme.cz](http://www.plujeme.cz)



**PHONE**

+420 720 755 085



**MOBILE**

+420 777 170 276



**E-MAIL**

[info@plujeme.cz](mailto:info@plujeme.cz)



**PLUJEME RÁDI S.R.O.**

Dlouhá 730/35, 11000 Praha 1 – Staré Město, Czech Republic

## SERVICES

SELECTED SERVICES	OBLIGATORY	PAYMENT TYPE	PRICE
<b>Final cleaning and transitlog</b> (Payable at the base) <b>Season: 2026.</b> 1GB WiFi/per week, hand towels, cooking gas, final cleaning, bed linen, dinghy	Yes	per booking	<b>275,00 €</b>
<b>Harbour and marine fee</b> (Payable at the base) <b>Season: 2026.</b> (incl. Boat electricity, water & waste management)	Yes	per booking / crew	<b>35,00 €</b>
<b>Comfort Pack</b> (Payable at the base) <b>Season: 2026.</b> Replaces obligatory end cleaning & transit log; Excludes regular security deposit payment; <b>INCLUDES:</b> End cleaning & Transit log, Outboard engine, Deposit insurance, Bed linen, Hand towels, Dinghy & Cooking gas. 2 weeks: 625 EUR 3 or more weeks: 725 EUR	No	per week	<b>475,00 €</b>
<b>Deposit insurance</b> (Payable at the base) <b>Season: 2026.</b> 2 weeks: 400 EUR 3 or more weeks: 500 EUR	No	per week	<b>250,00 €</b>
<b>Early boarding/check-in</b> (Payable at the base) <b>Season: 2026.</b> SAT at 13:00h; *on request (limited availability)	No	per booking	<b>150,00 €</b>
<b>Extra cleaning - pets</b> (Payable at the base) <b>Season: 2026.</b>	No	per booking	<b>100,00 €</b>
<b>Hostess</b> (Payable at the base) <b>Season: 2026.</b> 160 EUR/day + food	No	per week + food	<b>1.120,00 €</b>
<b>Overnight on board</b> (Payable at the base) <b>Season: 2026.</b> + EARLY CHECK-in; on request	No	per booking	<b>250,00 €</b>
<b>Parking</b> (Payable at the base) <b>Season: 2026.</b> Freewave parking marina Baotic - 55,00€ per car/per week; 10,00€ per car/per day; On request only - limited place available	No	per week	<b>55,00 €</b>
<b>Rescheduling</b> (Payable at the base) <b>Season: 2026.</b> max 30 days before charter	No	per service	<b>350,00 €</b>
<b>Skipper</b> (Payable at the base) <b>Season: 2026.</b> 180 EUR/day + food	No	per week + food	<b>1.260,00 €</b>
<b>WI-FI internet connection on boat</b> (Payable at the base) <b>Season: 2026.</b> Flat rate	No	per week	<b>25,00 €</b>

 **WEBSITE**  
www.plujeme.cz

 **PHONE**  
+420 720 755 085

 **MOBILE**  
+420 777 170 276

 **E-MAIL**  
info@plujeme.cz

 **PLUJEME RÁDI S.R.O.**  
Dlouhá 730/35, 11000 Praha 1 – Staré Město, Czech Republic

## ADDITIONAL EXTRAS

EXTRA	OBLIGATORY	PAYMENT TYPE	PRICE
<b>Automatic Inflatable Life Jacket</b> (Payable at the base) <i>Season: 2026. Payable at the base</i>	No	per week/ person	<b>5,00 €</b>
<b>Dinghy with outboard engine</b> (Payable at the base) <i>Season: 2026. PREMIUM dinghy pack - 300cm ZARmini AIR 10 flat airdeck + 10hp outboard engine - Payable at the base</i>	No	per week	<b>250,00 €</b>
<b>Electric outboard engine</b> (Payable at the base) <i>Season: 2026. Electric 2HP *on request (limited availability) - Payable at the base</i>	No	per week	<b>125,00 €</b>
<b>Extra bedlinen</b> (Payable at the base) <i>Season: 2026. Payable at the base</i>	No	per person	<b>10,00 €</b>
<b>Outboard engine</b> (Payable at the base) <i>Season: 2026. Petrol 2 HP 15 EUR/day - Payable at the base</i>	No	per week	<b>75,00 €</b>
<b>Railing net (Safety net)</b> (Payable at the base) <i>Season: 2026. Safety net rental without mounting - Payable at the base</i>	No	per booking	<b>50,00 €</b>
<b>Shower towels</b> (Payable at the base) <i>Season: 2026. Payable at the base</i>	No	per person	<b>10,00 €</b>
<b>Stand up paddle (SUP)</b> (Payable at the base) <i>Season: 2026. 20 EUR/day - Payable at the base</i>	No	per week	<b>90,00 €</b>



**WEBSITE**

[www.plujeme.cz](http://www.plujeme.cz)



**E-MAIL**

[info@plujeme.cz](mailto:info@plujeme.cz)



**PHONE**

+420 720 755 085



**MOBILE**

+420 777 170 276



**PLUJEME RÁDI S.R.O.**

Dlouhá 730/35, 11000 Praha 1 – Staré Město, Czech Republic

## PRICE AND AVAILABILITY

<b>13.06. - 20.06.2026</b> NOT AVAILABLE	<b>20.06. - 27.06.2026</b> NOT AVAILABLE	<b>27.06. - 04.07.2026</b> <b>1.678 €</b> 3.050 €	<b>04.07. - 11.07.2026</b> <b>2.243 €</b> 3.450 €
<b>11.07. - 18.07.2026</b> NOT AVAILABLE	<b>18.07. - 25.07.2026</b> <b>2.520 €</b> 3.600 €	<b>25.07. - 01.08.2026</b> NOT AVAILABLE	<b>01.08. - 08.08.2026</b> NOT AVAILABLE
<b>08.08. - 15.08.2026</b> <b>2.387 €</b> 3.350 €	<b>15.08. - 22.08.2026</b> <b>2.094 €</b> 3.350 €	<b>22.08. - 29.08.2026</b> <b>2.205 €</b> 3.150 €	<b>29.08. - 05.09.2026</b> <b>2.205 €</b> 3.150 €
<b>05.09. - 12.09.2026</b> <b>2.465 €</b> 2.900 €	<b>12.09. - 19.09.2026</b> <b>2.320 €</b> 2.900 €	<b>19.09. - 26.09.2026</b> <b>1.935 €</b> 2.150 €	<b>26.09. - 03.10.2026</b> <b>1.613 €</b> 2.150 €
<b>03.10. - 10.10.2026</b> <b>1.280 €</b> 1.600 €	<b>10.10. - 17.10.2026</b> <b>1.280 €</b> 1.600 €	<b>17.10. - 24.10.2026</b> <b>1.080 €</b> 1.200 €	<b>24.10. - 31.10.2026</b> <b>1.080 €</b> 1.200 €
<b>01.11. - 26.03.2027</b> NOT AVAILABLE			



**WEBSITE**

[www.plujeme.cz](http://www.plujeme.cz)



**E-MAIL**

[info@plujeme.cz](mailto:info@plujeme.cz)



**PHONE**

+420 720 755 085



**MOBILE**

+420 777 170 276



**PLUJEME RÁDI S.R.O.**

Dlouhá 730/35, 11000 Praha 1 – Staré Město, Czech Republic

## PRICE AND AVAILABILITY

27.03. - 03.04.2027 1.080 € 1.200 €	03.04. - 10.04.2027 972 € 1.200 €	10.04. - 17.04.2027 972 € 1.200 €	17.04. - 24.04.2027 972 € 1.200 €
24.04. - 01.05.2027 1.134 € 1.400 €	01.05. - 08.05.2027 1.134 € 1.400 €	08.05. - 15.05.2027 1.134 € 1.400 €	15.05. - 22.05.2027 1.499 € 1.850 €
22.05. - 29.05.2027 1.985 € 2.450 €	29.05. - 05.06.2027 2.095 € 2.450 €	05.06. - 12.06.2027 2.394 € 2.800 €	12.06. - 19.06.2027 2.394 € 2.800 €
19.06. - 26.06.2027 2.608 € 3.050 €	26.06. - 03.07.2027 2.608 € 3.050 €	03.07. - 10.07.2027 2.950 € 3.450 €	10.07. - 17.07.2027 2.950 € 3.450 €
17.07. - 24.07.2027 3.078 € 3.600 €	24.07. - 31.07.2027 3.078 € 3.600 €	31.07. - 07.08.2027 3.078 € 3.600 €	07.08. - 14.08.2027 2.864 € 3.350 €
14.08. - 21.08.2027 2.864 € 3.350 €	21.08. - 28.08.2027 2.693 € 3.150 €	28.08. - 04.09.2027 2.835 € 3.150 €	04.09. - 11.09.2027 2.610 € 2.900 €
11.09. - 18.09.2027 2.610 € 2.900 €	18.09. - 25.09.2027 1.935 € 2.150 €	25.09. - 02.10.2027 1.935 € 2.150 €	



WEBSITE  
[www.plujeme.cz](http://www.plujeme.cz)



E-MAIL  
[info@plujeme.cz](mailto:info@plujeme.cz)



PHONE  
+420 720 755 085



MOBILE  
+420 777 170 276



PLUJEME RÁDI S.R.O.  
Dlouhá 730/35, 11000 Praha 1 – Staré Město, Czech Republic

## PRICE AND AVAILABILITY

02.10. - 09.10.2027

**1.440 €** 1.600 €

09.10. - 16.10.2027

**1.440 €** 1.600 €

16.10. - 23.10.2027

**1.080 €** 1.200 €

23.10. - 30.10.2027

**1.080 €** 1.200 €

30.10. - 06.11.2027

**1.080 €** 1.200 €

07.11. - 24.03.2028

NOT AVAILABLE



**WEBSITE**

[www.plujeme.cz](http://www.plujeme.cz)



**E-MAIL**

[info@plujeme.cz](mailto:info@plujeme.cz)



**PHONE**

+420 720 755 085



**MOBILE**

+420 777 170 276



**PLUJEME RÁDI S.R.O.**

Dlouhá 730/35, 11000 Praha 1 – Staré Město, Czech Republic