

# BENETEAU SENSE 50

Waypoint I (2014)

Sailing yacht Beneteau Sense 50 Waypoint I, built in 2014 is anchored in the **Murter, ACI Marina Jezera, Šibenik region, Croatia**. It has **3 + 1 cabins**, can accommodate **6 + 1 + 1 people** and has **2 toilets**. Bed linen and kitchen equipment are included in the price.

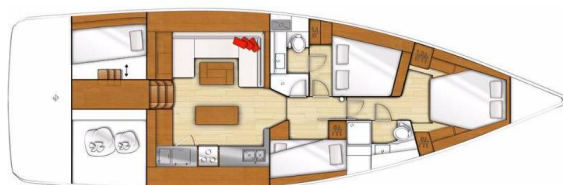

## YACHT SPECIFICATIONS

Yacht Base

**Murter, ACI Marina Jezera, Croatia**

Yacht ID

**13512**

Brands

**Beneteau**

Yacht name

**Waypoint I**

Production year

**2014**

Length

**50 ft**

Cabins

**3 + 1**

Berths

**6 + 1 + 1**

Max Persons

**8**

WC

**2**

Engine

**1 x 75 HP**

Fuel tank

**830 l**



**WEBSITE**

[www.plujeme.cz](http://www.plujeme.cz)



**PHONE**

+420 720 755 085



**MOBILE**

+420 777 170 276



**E-MAIL**

[info@plujeme.cz](mailto:info@plujeme.cz)



**PLUJEME RÁDI S.R.O.**

Dlouhá 730/35, 11000 Praha 1 – Staré Město, Czech Republic

## STANDARD YACHT EQUIPMENT

Comfort	Cockpit cushions, Sundeck cushions
Deck	Anchor line, Anchor swivel, Bimini top, Black ball, Black conus, Boat hook, Bosun's chair (Safe seat) (boatswain's chair), Canister for water, Cockpit table with light, Cockpit/stern, outside shower, Dinghy, Dinghy (byboat) pump, Electric anchor windlass, Fenders, Gangway, Impeller, V-belt, oilfilter, Jerry cans for diesel, Main anchor, Mooring ropes, Plastic bucket, Repair box for dinghy, Round/globular fender, Spare anchor (Reserve, Auxiliary anchor), Spotlight / Headlights, Sprayhood, Spring line, Teak cockpit, Water hose
Entertainment	Outdoor speakers, Radio
Galley	Coffee machine, Dishwasher, Gas bottles, Hot water, Kitchen utensils (Galley equipment, cutlery), Refrigerator
Interior	Barometer, Clock, Electric fans in cabins, Electric toilet, Lowerable salon table
Navigation	Autopilot, Bow thruster, GPS chart plotter - cockpit, Hand bearing compass, Harbour guides, Logge/Lot/Speed/Wind, Navigation (Nautical) charts and nautical guide, Navigation set, Parallel ruler, Radar reflector, Screen, Spyglass with bearing compass, Tridata, Windex
Safety	Distress signals, EPIRB-Distress radio beacons, Fire extinguisher, First aid kit, Flashlight, Fog horn, Life belts (Safety harness), Life buoy + Flashing light, Life jackets, Liferaft, Set of tools, VHF radio, Wire (shroud) cutter
Sails	Electric winch, Lazy bag, Lazy jacks
Yacht electrics	Air Conditioning, Battery charger, Generator, Heating, Inverter, Shore connection 220 V



**WEBSITE**

[www.plujeme.cz](http://www.plujeme.cz)



**PHONE**

+420 720 755 085



**MOBILE**

+420 777 170 276



**E-MAIL**

[info@plujeme.cz](mailto:info@plujeme.cz)



**PLUJEME RÁDI S.R.O.**

Dlouhá 730/35, 11000 Praha 1 – Staré Město, Czech Republic

## SERVICES

SELECTED SERVICES	OBLIGATORY	PAYMENT TYPE	PRICE
<b>Charter package</b> (Payable at the base) <b>Season: 2026.</b> incl. Permit, outboard engine, Wi-Fi Internet (5 GB), bed linen (1 set/ person)	Yes	per booking	<b>410,00 €</b>
<b>Early afternoon boarding/check-in</b> (Payable at the base) <b>Season: 2026.</b> -> 2.00 pm – 4.00 pm, max. 5 yachts	No	per booking	<b>75,00 €</b>
<b>Early boarding/check-in</b> (Payable at the base) <b>Season: 2026.</b> -> 12.30 pm – 2.00 pm, max 5 yachts	No	per booking	<b>200,00 €</b>
<b>Extra cleaning</b> (Payable at the base) <b>Season: 2026.</b>	No	per booking	<b>200,00 €</b>
<b>Hostess</b> (Payable at the base) <b>Season: 2026.</b> + own cabin; external service provider, direct billing	No	per day + food	<b>200,00 €</b>
<b>Pet on board</b> (Payable at the base) <b>Season: 2026.</b>	No	per pet	<b>200,00 €</b>
<b>Skipper</b> (Payable at the base) <b>Season: 2026.</b> + own cabin; external service provider	No	per day + food	<b>200,00 €</b>
<b>WI-FI Internet connection on boat</b> (Payable at the base) <b>Season: 2026.</b> unlimited / depending on the network reception (5 GB are included in the Charter package)	No	per week	<b>30,00 €</b>

**WEBSITE**[www.plujeme.cz](http://www.plujeme.cz)**E-MAIL**[info@plujeme.cz](mailto:info@plujeme.cz)**PHONE**

+420 720 755 085

**MOBILE**

+420 777 170 276

**PLUJEME RÁDI S.R.O.**

Dlouhá 730/35, 11000 Praha 1 – Staré Město, Czech Republic

## ADDITIONAL EXTRAS

EXTRA	OBLIGATORY	PAYMENT TYPE	PRICE
<b>Blister</b> (Payable at the base) <b>Season: 2026.</b> Payable at the base	No	per booking	<b>350,00 €</b>
<b>Extra bedlinen</b> (Payable at the base) <b>Season: 2026.</b> 1 set/ person is included in the charter package - Payable at the base	No	per set	<b>10,00 €</b>
<b>Grill/Barbecue/Plancha</b> (Payable at the base) <b>Season: 2026.</b> Payable at the base	No	per booking	<b>65,00 €</b>
<b>Ice box</b> (Payable at the base) <b>Season: 2026.</b> Mobile Cooler Box (no power connection): approx. 52L, filled with approx. 6kg ice cubes – limited availability, subject to on-site ice availability For drinks and ice only. Box must be returned clean and undamaged. Max. 1 yacht. - Payable at the base	No	per booking	<b>35,00 €</b>
<b>Ice maker</b> (Payable at the base) <b>Season: 2026.</b> operating with - shorepower or - Inverter min. 2.000 W or - Generator - Payable at the base	No	per booking	<b>45,00 €</b>
<b>Stand up paddle (SUP)</b> (Payable at the base) <b>Season: 2026.</b> Payable at the base	No	per week	<b>100,00 €</b>
<b>Towels</b> (Payable at the base) <b>Season: 2026.</b> Payable at the base	No	per set	<b>10,00 €</b>



**WEBSITE**  
www.plujeme.cz



**PHONE**  
+420 720 755 085



**MOBILE**  
+420 777 170 276



**E-MAIL**  
info@plujeme.cz



**PLUJEME RÁDI S.R.O.**  
Dlouhá 730/35, 11000 Praha 1 – Staré Město, Czech Republic

## PRICE AND AVAILABILITY

02.05. - 09.05.2026 1.540 € 2.200 €	09.05. - 16.05.2026 NOT AVAILABLE	16.05. - 23.05.2026 1.280 € 1.600 €	23.05. - 30.05.2026 2.080 € 2.600 €
30.05. - 06.06.2026 2.400 € 3.000 €	06.06. - 13.06.2026 2.384 € 2.980 €	13.06. - 20.06.2026 2.480 € 3.100 €	24.06. - 15.07.2026 NOT AVAILABLE
18.07. - 25.07.2026 ON OPTION	25.07. - 01.08.2026 ON OPTION	01.08. - 08.08.2026 4.600 € 5.750 €	08.08. - 15.08.2026 3.840 € 4.800 €
15.08. - 22.08.2026 3.120 € 3.900 €	22.08. - 29.08.2026 NOT AVAILABLE	29.08. - 05.09.2026 3.200 € 4.000 €	05.09. - 12.09.2026 3.040 € 3.800 €
12.09. - 19.09.2026 3.040 € 3.800 €	19.09. - 26.09.2026 NOT AVAILABLE	26.09. - 03.10.2026 2.480 € 3.100 €	03.10. - 10.10.2026 2.160 € 2.700 €
10.10. - 17.10.2026 2.000 € 2.500 €	17.10. - 24.10.2026 1.760 € 2.200 €	24.10. - 30.10.2026 NOT AVAILABLE	31.10. - 07.11.2026 1.368 € 1.710 €
07.11. - 14.11.2026 ON OPTION	14.11. - 21.11.2026 ON OPTION	24.11. - 31.12.2026 NOT AVAILABLE	



WEBSITE

[www.plujeme.cz](http://www.plujeme.cz)



E-MAIL

[info@plujeme.cz](mailto:info@plujeme.cz)



PHONE

+420 720 755 085



MOBILE

+420 777 170 276



PLUJEME RÁDI S.R.O.

Dlouhá 730/35, 11000 Praha 1 – Staré Město, Czech Republic