

# BAVARIA CRUISER 46

Simba (2024)

Sailing yacht **Bavaria Cruiser 46 Simba**, built in **2024** is anchored in the **Sukosan, D-Marin Dalmacija Marina, Zadar region, Croatia**. It has **4 cabins**, can accommodate **8 + 1 people** and has **3 toilets**. Bed linen and kitchen equipment are included in the price.

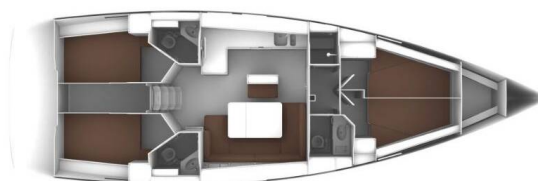

## YACHT SPECIFICATIONS

Yacht Base

**Sukosan, D-Marin Dalmacija Marina,  
Croatia**

Yacht ID

**13433**

Brands

**Bavaria**

Yacht name

**Simba**

Production year

**2024**

Length

**47 ft**

Cabins

**4**

Berths

**8 + 1**

Max Persons

**9**

WC

**3**

Engine

**1 x 50 HP**

Fuel tank

**210 l**



**WEBSITE**

[www.plujeme.cz](http://www.plujeme.cz)



**PHONE**

+420 720 755 085



**MOBILE**

+420 777 170 276



**E-MAIL**

[info@plujeme.cz](mailto:info@plujeme.cz)



**PLUJEME RÁDI S.R.O.**

Dlouhá 730/35, 11000 Praha 1 – Staré Město, Czech Republic

## STANDARD YACHT EQUIPMENT

Deck	<b>Anchor line, Anchor swivel, Bimini top, Boat hook, Bosun's chair (Safe seat) (boatswain's chair), Canister for water, Cockpit table, Cockpit/stern, outside shower, Dinghy, Dinghy (byboat) pump, Electric anchor windlass, Fenders, Gangway, Impeller, Jerry cans for diesel, Main anchor, Mooring ropes, Plastic bucket, Round/globular fender, Spare anchor (Reserve, Auxiliary anchor), Spotlight / Headlights, Sprayhood, Spring line, Water hose</b>
Entertainment	<b>Outdoor speakers, Radio</b>
Galley	<b>Gas bottles, Hot water, Kitchen utensils (Galley equipment, cutlery), Microwave, Oven, Refrigerator</b>
Interior	<b>Barometer, Clock</b>
Navigation	<b>Autopilot, Bow thruster, GPS, GPS chart plotter - cockpit, Hand bearing compass, Harbour guides, Logge/Lot/Speed/Wind, Navigation (Nautical) charts and nautical guide, Navigation set, Radar reflector, Tridata, Windex</b>
Safety	<b>Black Water Tank, Distress signals, Fire extinguisher, First aid kit, Flashlight, Fog horn, Life belts (Safety harness), Life buoy + Flashing light, Life jackets, Liferaft, Set of tools, VHF radio</b>
Yacht electrics	<b>Air Conditioning, Battery charger, Shore connection 220 V, Solar panels</b>



**WEBSITE**

[www.plujeme.cz](http://www.plujeme.cz)



**PHONE**

+420 720 755 085



**MOBILE**

+420 777 170 276



**E-MAIL**

[info@plujeme.cz](mailto:info@plujeme.cz)



**PLUJEME RÁDI S.R.O.**

Dlouhá 730/35, 11000 Praha 1 – Staré Město, Czech Republic

## SERVICES

SELECTED SERVICES	OBLIGATORY	PAYMENT TYPE	PRICE
<b>Transit log</b> (Payable at the base) <b>Season: 2026.</b> check in, check out, VAT, final cleaning, gas, dinghy, bedding, regular diver check Friday at 17:00 hours	Yes	per booking	<b>250,00 €</b>
<b>Comfort Pack</b> (Payable at the base) <b>Season: 2026.</b> the price includes: transit log, alternative deposit (refundable deposit obligatory), check in, check out, VAT, final cleaning, gas, dinghy, bedding, regular diver check Friday at 17:00 hours. (Alternative deposit - The refundable part is obligated - 200€ for SY up to 40ft, 300€ for SY 41-46ft, 300€ for SY from 47ft (in cash).	No	per booking	<b>450,00 €</b>
<b>Crew list - Fill/Update fee</b> (Payable at the base) <b>Season: 2026.</b>	No	per service	<b>50,00 €</b>
<b>Deposit for regatta</b> (Payable at the base) <b>Season: 2026.</b>	No	per booking	<b>4.000,00 €</b>
<b>Divers inspection</b> (Payable at the base) <b>Season: 2026.</b> Irregular diver time cost	No	per booking	<b>70,00 €</b>
<b>Early boarding/check-in</b> (Payable at the base) <b>Season: 2026.</b> Boarding 13:00-14:00 h (max 5 yachts/base) (In case of impossibility of service, Adventure charter reserves the right to unilaterally refund the money paid in respect of agreed services "EARLY CHECK IN", and in this case the customer is not entitled to claim any further pecuniary or non-pecuniary damage on the ground of impossibility of fulfillment agreed services. )	No	per booking	<b>150,00 €</b>
<b>Overnight on board</b> (Payable at the base) <b>Season: 2026.</b> under condition the boat is available day before	No	per night	<b>200,00 €</b>
<b>Permit</b> (Payable at the base) <b>Season: 2026.</b> Permit for int. Waters ON REQUEST (not available for all yachts, request per email min 2 months before charter)	No	per booking	<b>0,00 €</b>
<b>Pet on board</b> (Payable at the base) <b>Season: 2026.</b>	No	per booking	<b>150,00 €</b>

**Skipper** (Payable at the base)

No

per week + food

**1.400,00**  
€

**Season: 2026.** (The charterer hires skipper directly. AC only provides contact, AC cannot be considered a skipper service provider)

**WI-FI Internet connection on boat** (Payable at the base)

No

per week

**30,00 €**

**Season: 2026.** 20 GB



**WEBSITE**

[www.plujeme.cz](http://www.plujeme.cz)



**PHONE**

+420 720 755 085



**MOBILE**

+420 777 170 276



**E-MAIL**

[info@plujeme.cz](mailto:info@plujeme.cz)



**PLUJEME RÁDI S.R.O.**

Dlouhá 730/35, 11000 Praha 1 – Staré Město, Czech Republic

## ADDITIONAL EXTRAS

EXTRA	OBLIGATORY	PAYMENT TYPE	PRICE
<b>Extra bedlinen</b> (Payable at the base) <b>Season: 2026.</b> Payable at the base	No	per set	<b>7,00 €</b>
<b>Gennaker</b> (Payable at the base) <b>Season: 2026.</b> (obligatory security deposit 2.000 € ) - Payable at the base	No	per week	<b>300,00 €</b>
<b>Outboard engine</b> (Payable at the base) <b>Season: 2026.</b> Payable at the base	No	per week	<b>100,00 €</b>
<b>Railing net (Safety net)</b> (Payable at the base) <b>Season: 2026.</b> (not available for all yachts) - Payable at the base	No	per week	<b>100,00 €</b>
<b>Stand up paddle (SUP)</b> (Payable at the base) <b>Season: 2026.</b> Payable at the base	No	per week	<b>120,00 €</b>
<b>Towels</b> (Payable at the base) <b>Season: 2026.</b> Payable at the base	No	per set	<b>8,00 €</b>

**WEBSITE**[www.plujeme.cz](http://www.plujeme.cz)**E-MAIL**[info@plujeme.cz](mailto:info@plujeme.cz)**PHONE**

+420 720 755 085

**MOBILE**

+420 777 170 276

**PLUJEME RÁDI S.R.O.**

Dlouhá 730/35, 11000 Praha 1 – Staré Město, Czech Republic

## PRICE AND AVAILABILITY

25.04. - 02.05.2026 1.378 € 2.650 €	02.05. - 09.05.2026 1.378 € 2.650 €	09.05. - 16.05.2026 1.482 € 2.850 €	16.05. - 23.05.2026 1.768 € 3.400 €
23.05. - 30.05.2026 NOT AVAILABLE	30.05. - 06.06.2026 NOT AVAILABLE	06.06. - 13.06.2026 NOT AVAILABLE	13.06. - 27.06.2026 NOT AVAILABLE
27.06. - 04.07.2026 2.880 € 4.800 €	04.07. - 11.07.2026 NOT AVAILABLE	11.07. - 18.07.2026 NOT AVAILABLE	18.07. - 25.07.2026 NOT AVAILABLE
25.07. - 01.08.2026 NOT AVAILABLE	01.08. - 08.08.2026 NOT AVAILABLE	08.08. - 15.08.2026 3.000 € 5.000 €	15.08. - 22.08.2026 2.880 € 4.800 €
22.08. - 29.08.2026 NOT AVAILABLE	29.08. - 05.09.2026 NOT AVAILABLE	05.09. - 12.09.2026 NOT AVAILABLE	12.09. - 19.09.2026 NOT AVAILABLE
19.09. - 26.09.2026 2.280 € 2.850 €	26.09. - 03.10.2026 NOT AVAILABLE	03.10. - 10.10.2026 1.760 € 2.200 €	10.10. - 17.10.2026 NOT AVAILABLE
17.10. - 24.10.2026 1.600 € 2.000 €	24.10. - 31.10.2026 1.600 € 2.000 €	31.10. - 07.11.2026 2.000 €	07.11. - 14.11.2026 2.000 €
14.11. - 21.11.2026 2.000 €	21.11. - 28.11.2026 2.000 €	28.11. - 05.12.2026 2.000 €	



WEBSITE  
[www.plujeme.cz](http://www.plujeme.cz)



E-MAIL  
[info@plujeme.cz](mailto:info@plujeme.cz)



PHONE  
+420 720 755 085



MOBILE  
+420 777 170 276



PLUJEME RÁDI S.R.O.  
Dlouhá 730/35, 11000 Praha 1 – Staré Město, Czech Republic

## PRICE AND AVAILABILITY

05.12. - 12.12.2026

2.000 €

12.12. - 19.12.2026

2.000 €

19.12. - 26.12.2026

2.000 €



### WEBSITE

[www.plujeme.cz](http://www.plujeme.cz)



### E-MAIL

[info@plujeme.cz](mailto:info@plujeme.cz)



### PHONE

+420 720 755 085



### MOBILE

+420 777 170 276



### PLUJEME RÁDI S.R.O.

Dlouhá 730/35, 11000 Praha 1 – Staré Město, Czech Republic