

# OCEANIS 51.1

Salma (2018)

Sailing yacht Oceanis 51.1 Salma, built in 2018 is anchored in the Trogir, Yachtclub Seget (Marina Baotic), Split region, Croatia. It has 5 + 1 cabins, can accommodate 10 + 2 people and has 4 toilets. Bed linen and kitchen equipment are included in the price.

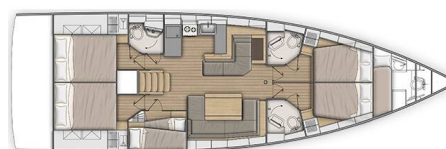

## YACHT SPECIFICATIONS

Yacht Base

**Trogir, Yachtclub Seget (Marina Baotic), Croatia**

Yacht ID

**13328**

Brands

**Beneteau**

Yacht name

**Salma**

Production year

**2018**

Length

**52 ft**

Cabins

**5 + 1**

Berths

**10 + 2**

WC

**4**

Engine

**1 x 110 HP**

Fuel tank

**400 l**



**WEBSITE**

[www.plujeme.cz](http://www.plujeme.cz)



**PHONE**

+420 720 755 085



**MOBILE**

+420 777 170 276



**E-MAIL**

[info@plujeme.cz](mailto:info@plujeme.cz)



**PLUJEME RÁDI S.R.O.**

Dlouhá 730/35, 11000 Praha 1 – Staré Město, Czech Republic

## STANDARD YACHT EQUIPMENT

Comfort	<b>Cockpit cushions, Towels</b>
Deck	<b>Anchor Delta, Cockpit/stern, outside shower, Dinghy with outboard engine, Electric anchor windlass, Swimming ladder, Teak seats in cockpit, Water hose</b>
Entertainment	<b>FUSION sound system, Hi-Fi system, Wi-Fi Internet</b>
Galley	<b>Kitchen utensils (Galley equipment, cutlery), Moka pot, Refrigerator, Water pump</b>
Interior	<b>Electric toilet</b>
Navigation	<b>Autopilot, Bow thruster, Compass, Complete navigation equipment, GPS chart plotter, Windex</b>
Safety	<b>Liferaft</b>
Yacht electrics	<b>Bilge pump - Electric, Heating, Service batteries, Shore connection 220 V, Shore power cable, USB sockets, Water heater</b>



#### WEBSITE

[www.plujeme.cz](http://www.plujeme.cz)



#### E-MAIL

[info@plujeme.cz](mailto:info@plujeme.cz)



#### PHONE

+420 720 755 085



#### MOBILE

+420 777 170 276



#### PLUJEME RÁDI S.R.O.

Dlouhá 730/35, 11000 Praha 1 – Staré Město, Czech Republic

## SERVICES

SELECTED SERVICES	OBLIGATORY	PAYMENT TYPE	PRICE
<b>Charter package</b> (Payable at the base) <b>Season: 2026.</b> includes: final cleaning, diver inspection, gas, bed linen per person, set of towels per person (1 bath + 1 small size ), rubbish bags, 1 sponge, 2 kitchen paper towels, dish soap, toilet paper (1 per head), internet	Yes	per booking	<b>500,00 €</b>
<b>Adventure package</b> (Payable at the base) <b>Season: 2026.</b> SUP + outboard + extra fuel	No	per booking	<b>150,00 €</b>
<b>Arrival pack</b> (Payable at the base) <b>Season: 2026.</b> early check in at 15h + internet + 1 parking	No	per booking	<b>190,00 €</b>
<b>Basic pack</b> (Payable at the base) <b>Season: 2026.</b> priority check in u 14h + 1 parking + SUP	No	per booking	<b>270,00 €</b>
<b>Best combination package</b> (Payable at the base) <b>Season: 2026.</b> Early Check IN at 13:00h + damage waiver	No	per booking	<b>510,00 €</b>
<b>Cancellation fee</b> (Payable now) <b>Season: 2026.</b> Client can purchase cancellation fee service and cancel booked yacht with full refund , no reason whatsoever. Cancellation fee must be paid together with first payment. Full refund will be done if booking is cancelled in written, no less than 25 days before embarkation.	No	per booking	<b>600,00 €</b>
<b>Chef</b> (Payable now) <b>Season: 2026.</b> price on request, cash payment only	No	per day + food	<b>0,00 €</b>
<b>Coffee Pack</b> (Payable at the base) <b>Season: 2026.</b> SUP + internet + coffee machine	No	per booking	<b>130,00 €</b>
<b>Crew change</b> (Payable at the base) <b>Season: 2026.</b>	No	per booking	<b>350,00 €</b>
<b>Damage waiver</b> (Payable at the base) <b>Season: 2026.</b> Damage waiver covers all damages except loss of things, clogged toilet, lack of fuel, damages on gennaker and negligence. During regattas, damage waiver is not applicable.	No	per booking	<b>550,00 €</b>
<b>Early boarding /Check in from 13:00</b> (Payable at the base) <b>Season: 2026.</b> at 13h, limited availability	No	per booking	<b>170,00 €</b>

<b>Early boarding/check-in</b> (Payable at the base) <i>Season: 2026. at 14h, limited availability</i>	No	per booking	<b>150,00 €</b>
<b>Early Check in</b> (Payable at the base) <i>Season: 2026. at 15 h, limited availability</i>	No	per booking	<b>120,00 €</b>
<b>Fuel charge</b> (Payable at the base) <i>Season: 2026. fuel penalty</i>	No	per booking	<b>80,00 €</b>
<b>Fun Pack</b> (Payable at the base) <i>Season: 2026. UNO CARDS, YAMB, SORRY game, CHESS - limited availability</i>	No	per week	<b>30,00 €</b>
<b>Internet pack</b> (Payable at the base) <i>Season: 2026.</i>	No	per week	<b>30,00 €</b>
<b>Late check out</b> (Payable at the base) <i>Season: 2026. 12:00, limited availability - needs approval from administration and base manager</i>	No	per booking	<b>0,00 €</b>
<b>Late check out</b> (Payable at the base) <i>Season: 2026. 12:00, limited availability - needs approval from administration and base manager</i>	No	per booking	<b>0,00 €</b>
<b>Late check out</b> (Payable at the base) <i>Season: 2026. 12:00, limited availability - needs approval from administration and base manager</i>	No	per booking	<b>200,00 €</b>
<b>Luggage storage</b> (Payable at the base) <i>Season: 2026. for safekeeping of reported loss of things, if you do not report that you have forgotten your personal belongings on the vessel, we are not responsible for their eventual loss.</i>	No	per booking	<b>20,00 €</b>
<b>Parking</b> (Payable at the base) <i>Season: 2026. Limited availability</i>	No	per week	<b>80,00 €</b>
<b>Pet on board</b> (Payable at the base) <i>Season: 2026.</i>	No	per booking	<b>170,00 €</b>
<b>Provisioning</b> (Payable at the base) <i>Season: 2026.</i>	No	per service	<b>70,00 €</b>
<b>Skipper</b> (Payable now) <i>Season: 2026. price includes VAT</i>	No	per day + food	<b>250,00 €</b>

<b>Starter pack</b> (Payable at the base) <b>Season: 2026.</b> early check in u 15h + SUP	No	per booking	<b>170,00 €</b>
<b>VIP Pack</b> (Payable at the base) <b>Season: 2026.</b> windsurf kit + VIP check in u 13h	No	per booking	<b>400,00 €</b>
<b>Wellness package</b> (Payable at the base) <b>Season: 2026.</b> Russian pedicure, eyebrow threading, permanent nail polish, massage - price upon request / the boat must be anchored. Arrival is possible at the Baotić marina or any island with the transfer costs borne by you.	No	per week	<b>0,00 €</b>



**WEBSITE**

[www.plujeme.cz](http://www.plujeme.cz)



**E-MAIL**

[info@plujeme.cz](mailto:info@plujeme.cz)



**PHONE**

+420 720 755 085



**MOBILE**

+420 777 170 276



**PLUJEME RÁDI S.R.O.**

Dlouhá 730/35, 11000 Praha 1 – Staré Město, Czech Republic

## ADDITIONAL EXTRAS

EXTRA	OBLIGATORY	PAYMENT TYPE	PRICE
<b>Baby cot</b> (Payable at the base) <b>Season: 2026.</b> Payable at the base	No	per week	<b>40,00 €</b>
<b>Beach towel</b> (Payable at the base) <b>Season: 2026.</b> Payable at the base	No	per piece	<b>9,00 €</b>
<b>Bed linen</b> (Payable at the base) <b>Season: 2026.</b> Payable at the base	No	per set	<b>25,00 €</b>
<b>Bed rail</b> (Payable at the base) <b>Season: 2026.</b> Payable at the base	No	per week	<b>40,00 €</b>
<b>Bedlinen and towels</b> (Payable at the base) <b>Season: 2026.</b> Payable at the base	No	per set	<b>25,00 €</b>
<b>Coffee machine</b> (Payable at the base) <b>Season: 2026.</b> Payable at the base	No	per week	<b>35,00 €</b>
<b>Fuel for an outboard engine - 5 lit.</b> (Payable at the base) <b>Season: 2026.</b> Payable at the base	No	per booking	<b>19,00 €</b>
<b>Gas bottles</b> (Payable at the base) <b>Season: 2026.</b> Payable at the base	No	per piece	<b>18,00 €</b>
<b>Gennaker</b> (Payable at the base) <b>Season: 2026.</b> + 350 EUR deposit - Payable at the base	No	per week	<b>350,00 €</b>
<b>Grill/Barbecue/Plancha</b> (Payable at the base) <b>Season: 2026.</b> Payable at the base	No	per week	<b>100,00 €</b>
<b>Outboard engine</b> (Payable at the base) <b>Season: 2026.</b> with 5L fuel for outboard engine - Payable at the base	No	per booking	<b>100,00 €</b>
<b>Railing net (Safety net)</b> (Payable at the base) <b>Season: 2026.</b> without installation, 140 EUR with installation - Payable at the base	No	per booking	<b>100,00 €</b>
<b>Snorkeling equipment</b> (Payable at the base) <b>Season: 2026.</b> Payable at the base	No	per week/ person	<b>30,00 €</b>

<b>Spinnaker</b> (Payable at the base)	No	per week	<b>0,00 €</b>
<b>Season: 2026.</b> price on request - Payable at the base			
<b>Stand up paddle (SUP)</b> (Payable at the base)	No	per week	<b>90,00 €</b>
<b>Season: 2026.</b> Payable at the base			
<b>Water toys</b> (Payable at the base)	No	per week	<b>0,00 €</b>
<b>Season: 2026.</b> Jet-ski, eFoil, Donut and Seabob - available on request - Payable at the base			



**WEBSITE**

[www.plujeme.cz](http://www.plujeme.cz)



**E-MAIL**

[info@plujeme.cz](mailto:info@plujeme.cz)



**PHONE**

+420 720 755 085



**MOBILE**

+420 777 170 276



**PLUJEME RÁDI S.R.O.**

Dlouhá 730/35, 11000 Praha 1 – Staré Město, Czech Republic

## PRICE AND AVAILABILITY

02.05. - 09.05.2026 2.405 € 3.700 €	09.05. - 16.05.2026 2.405 € 3.700 €	16.05. - 23.05.2026 2.405 € 3.700 €	23.05. - 30.05.2026 3.055 € 4.700 €
04.06. - 07.06.2026 NOT AVAILABLE	13.06. - 20.06.2026 ON OPTION	20.06. - 27.06.2026 4.350 € 5.800 €	27.06. - 04.07.2026 4.875 € 6.500 €
04.07. - 11.07.2026 4.875 € 6.500 €	11.07. - 18.07.2026 4.875 € 6.500 €	18.07. - 25.07.2026 5.325 € 7.100 €	25.07. - 01.08.2026 5.325 € 7.100 €
01.08. - 08.08.2026 5.325 € 7.100 €	08.08. - 15.08.2026 4.875 € 6.500 €	15.08. - 22.08.2026 4.875 € 6.500 €	22.08. - 29.08.2026 4.875 € 6.500 €
29.08. - 05.09.2026 4.350 € 5.800 €	05.09. - 12.09.2026 4.350 € 5.800 €	12.09. - 19.09.2026 4.350 € 5.800 €	19.09. - 26.09.2026 NOT AVAILABLE
26.09. - 03.10.2026 3.525 € 4.700 €	03.10. - 10.10.2026 2.775 € 3.700 €	10.10. - 17.10.2026 2.775 € 3.700 €	17.10. - 24.10.2026 2.775 € 3.700 €
24.10. - 31.10.2026 2.775 € 3.700 €	31.10. - 07.11.2026 2.775 € 3.700 €	07.11. - 14.11.2026 2.775 € 3.700 €	14.11. - 21.11.2026 2.775 € 3.700 €
21.11. - 28.11.2026 2.775 € 3.700 €	28.11. - 05.12.2026 2.775 € 3.700 €		



WEBSITE

[www.plujeme.cz](http://www.plujeme.cz)



E-MAIL

[info@plujeme.cz](mailto:info@plujeme.cz)



PHONE

+420 720 755 085



MOBILE

+420 777 170 276



PLUJEME RÁDI S.R.O.

Dlouhá 730/35, 11000 Praha 1 – Staré Město, Czech Republic

## PRICE AND AVAILABILITY

05.12. - 12.12.2026

**2.775 €** 3.700 €

12.12. - 19.12.2026

**2.775 €** 3.700 €

19.12. - 26.12.2026

**2.775 €** 3.700 €



### WEBSITE

[www.plujeme.cz](http://www.plujeme.cz)



### E-MAIL

[info@plujeme.cz](mailto:info@plujeme.cz)



### PHONE

+420 720 755 085



### MOBILE

+420 777 170 276



### PLUJEME RÁDI S.R.O.

Dlouhá 730/35, 11000 Praha 1 – Staré Město, Czech Republic