

# MORE 55

KSP (2026)

Sailing yacht **More 55 KSP**, built in **2026** is anchored in the **Trogir, Marina Trogir (ex.SCT), Split region, Croatia**. It has **5 + 1 cabins**, can accommodate **10 + 2 + 1 people** and has **3 + 1 toilets**. Bed linen and kitchen equipment are included in the price.

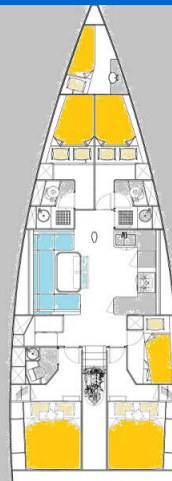

## YACHT SPECIFICATIONS

Yacht Base

**Trogir, Marina Trogir (ex.SCT),  
Croatia**

Yacht ID

**13322**

Brands

**More Boats**

Yacht name

**KSP**

Production year

**2026**

Length

**55 ft**

Cabins

**5 + 1**

Berths

**10 + 2 + 1**

Max Persons

**13**

WC

**3 + 1**

Engine

**1 x 110 HP**

Fuel tank

**550 l**



**WEBSITE**

[www.plujeme.cz](http://www.plujeme.cz)



**PHONE**

+420 720 755 085



**MOBILE**

+420 777 170 276



**E-MAIL**

[info@plujeme.cz](mailto:info@plujeme.cz)



**PLUJEME RÁDI S.R.O.**

Dlouhá 730/35, 11000 Praha 1 – Staré Město, Czech Republic

## STANDARD YACHT EQUIPMENT

Comfort	<b>Beach towel, Bed linen, Cockpit cushions, Sundeck beds, Towels</b>
Deck	<b>Bathing platform, Bimini top, Bosun's chair (Safe seat) (boatswain's chair), Cockpit fridge, Cockpit table, Cockpit/stern, outside shower, Dinghy, Dinghy garage, Electric anchor windlass, Gangway, Outboard engine, Remote control for anchor winch with chain counter at helm, Sea/Storm drogue anchor, Sprayhood, Swimming ladder, Teak cockpit</b>
Entertainment	<b>Indoor speakers, LED TV, Outdoor speakers, Radio, Radio, USB, Bluetooth, Stand up paddle (SUP), Underwater lights, Wi-Fi Internet</b>
Galley	<b>Freezer, Hot water, Kitchen utensils (Galley equipment, cutlery), NESPRESSO coffee machine, Oven, Refrigerator, Stove, Toaster</b>
Interior	<b>Ambiental lighting, Electric toilet, LED interior lights, Toiletries</b>
Navigation	<b>AIS, Autopilot, Bow thruster, GPS chart plotter - cockpit, Tridata, Wind/speed/depth instruments</b>
Safety	<b>Horseshoe lifebuoy, Life belts (Safety harness), Life jackets, Liferaft, Spreader lights, VHF radio</b>
Sails	<b>Bowsprit, Electric winch, Lazy bag, Lazy jacks</b>
Yacht electrics	<b>Air Conditioning, DSC station, Generator, Inverter</b>



**WEBSITE**

[www.plujeme.cz](http://www.plujeme.cz)



**PHONE**

+420 720 755 085



**MOBILE**

+420 777 170 276



**E-MAIL**

[info@plujeme.cz](mailto:info@plujeme.cz)



**PLUJEME RÁDI S.R.O.**

Dlouhá 730/35, 11000 Praha 1 – Staré Město, Czech Republic

## SERVICES

SELECTED SERVICES	OBLIGATORY	PAYMENT TYPE	PRICE
<b>Base fee</b> (Payable at the base) <b>Season: 2026.</b> payable in base in cash at check-in / includes: final cleaning (inside&outside), bed linen, 1 set (towel/crew memeber), dish cleaning set, unlimited WiFi, dinghy and OB engine -loaded, full water tank, full fuel tank, cooking gas, coffee machine + coffee pack, toilet paper, shampoo, welcome package. taxes and fees and 25% VAT.	Yes	per booking	<b>470,00 €</b>
<b>Cook</b> (Payable at the base) <b>Season: 2026.</b>	No	per day + food	<b>250,00 €</b>
<b>Hostess</b> (Payable at the base) <b>Season: 2026.</b>	No	per day + food	<b>180,00 €</b>
<b>One way</b> (Payable at the base) <b>Season: 2026.</b> ONE-WAY CHARTER to Dubrovnik + mooring fee(s) in Dubrovnik	No	one-way	<b>850,00 €</b>
<b>Permit</b> (Payable at the base) <b>Season: 2026.</b> Permit for international waters (Italy & Montenegro)	No	per booking	<b>270,00 €</b>
<b>Pet on board</b> (Payable at the base) <b>Season: 2026.</b>	No	per booking	<b>150,00 €</b>
<b>Regatta</b> (Payable at the base) <b>Season: 2026.</b> + double deposit	No	per booking	<b>0,00 €</b>
<b>Skipper</b> (Payable at the base) <b>Season: 2026.</b>	No	per day + food	<b>200,00 €</b>
<b>Transfer</b> (Payable at the base) <b>Season: 2026.</b> Airport Split - Base marina, max up to 8 person - price is for one way	No	one-way	<b>35,00 €</b>
<b>Transfer</b> (Payable at the base) <b>Season: 2026.</b> Split ferry - Base marina, max up to 8 person - price is for one way	No	one-way	<b>70,00 €</b>



**WEBSITE**  
www.plujeme.cz



**PHONE**  
+420 720 755 085



**MOBILE**  
+420 777 170 276



**E-MAIL**  
info@plujeme.cz



**PLUJEME RÁDI S.R.O.**  
Dlouhá 730/35, 11000 Praha 1 – Staré Město, Czech Republic

## ADDITIONAL EXTRAS

EXTRA	OBLIGATORY	PAYMENT TYPE	PRICE
<b>Gennaker</b> (Payable at the base) <b>Season: 2026.</b> (obligatory deposit 2000€) - Payable at the base	No	per week	<b>600,00 €</b>
<b>Ice maker</b> (Payable at the base) <b>Season: 2026.</b> (generator or shore power needed) - Payable at the base	No	per booking	<b>150,00 €</b>
<b>Inflatable tube</b> (Payable at the base) <b>Season: 2026.</b> Payable at the base	No	per week	<b>80,00 €</b>
<b>Railing net (Safety net)</b> (Payable at the base) <b>Season: 2026.</b> Payable at the base	No	per booking	<b>150,00 €</b>
<b>Seabob</b> (Payable at the base) <b>Season: 2026.</b> Payable at the base	No	per day	<b>200,00 €</b>
<b>Spinnaker</b> (Payable at the base) <b>Season: 2026.</b> Payable at the base	No	per week	<b>250,00 €</b>
<b>Stand up paddle - Inflatable (iSUP)</b> (Payable at the base) <b>Season: 2026.</b> Inflatable Stand-up paddle in a carry bag, with carry straps, high pressure pump, pressure gauge, a fiber travel vario paddle and instructions - Payable at the base	No	per week	<b>150,00 €</b>



**WEBSITE**

[www.plujeme.cz](http://www.plujeme.cz)



**E-MAIL**

[info@plujeme.cz](mailto:info@plujeme.cz)



**PHONE**

+420 720 755 085



**MOBILE**

+420 777 170 276



**PLUJEME RÁDI S.R.O.**

Dlouhá 730/35, 11000 Praha 1 – Staré Město, Czech Republic

## PRICE AND AVAILABILITY

27.06. - 04.07.2026 <b>6.880 €</b> 8.600 €	04.07. - 11.07.2026 <b>7.310 €</b> 8.600 €	11.07. - 18.07.2026 <b>8.730 €</b> 9.700 €	18.07. - 01.08.2026 NOT AVAILABLE
01.08. - 15.08.2026 NOT AVAILABLE	15.08. - 22.08.2026 NOT AVAILABLE	22.08. - 26.09.2026 NOT AVAILABLE	26.09. - 03.10.2026 <b>7.200 €</b>
07.10. - 19.12.2026 NOT AVAILABLE	19.12. - 26.12.2026 <b>4.600 €</b>		



### WEBSITE

[www.plujeme.cz](http://www.plujeme.cz)



### E-MAIL

[info@plujeme.cz](mailto:info@plujeme.cz)



### PHONE

+420 720 755 085



### MOBILE

+420 777 170 276



### PLUJEME RÁDI S.R.O.

Dlouhá 730/35, 11000 Praha 1 – Staré Město, Czech Republic