

FOUNTAIN PAJOT ASTREA 42

Kanaoa (2025)

Catamaran Fountaine Pajot Astrea 42 Kanaoa, built in 2025 is anchored in the **Port de Bandol, Provence-Alpes-Côte d'Azur, France**. It has **3 + 1 cabins**, can accommodate **6 + 1 people** and has **3 toilets**. Bed linen and kitchen equipment are included in the price.

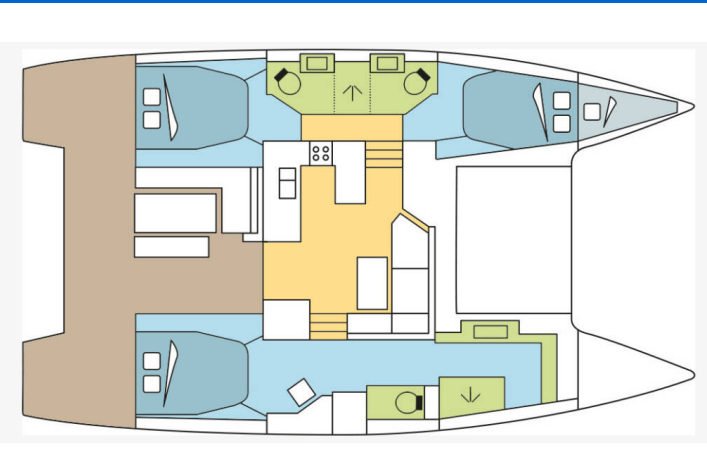

YACHT SPECIFICATIONS

Yacht Base

Port de Bandol, France

Yacht ID

13302

Brands

Fountaine Pajot

Yacht name

Kanaoa

Production year

2025

Length

41 ft

Cabins

3 + 1

Berths

6 + 1

Max Persons

7

WC

3

Engine

2 x 50 HP

Fuel tank

470 l



WEBSITE

www.plujeme.cz



PHONE

+420 720 755 085



MOBILE

+420 777 170 276



E-MAIL

info@plujeme.cz



PLUJEME RÁDI S.R.O.

Dlouhá 730/35, 11000 Praha 1 - Staré Město, Czech Republic

STANDARD YACHT EQUIPMENT

Comfort	Sunshades
Deck	Cockpit/stern, outside shower, Outboard engine
Entertainment	Outdoor speakers, Sound System
Galley	Hot water, Microwave, Oven, Pressurized water system, Refrigerator
Navigation	AIS, Autopilot, GPS, GPS chart plotter, Log/speed instrument, Wind instrument/Anemometer
Safety	Safety equipment, VHF radio
Sails	Electric winch, Lazy jacks, Winch
Yacht electrics	Heating, Plug 220V, 12 V, Solar panels, USB sockets, Watermaker - desalinator



WEBSITE

www.plujeme.cz



E-MAIL

info@plujeme.cz



PHONE

+420 720 755 085



MOBILE

+420 777 170 276



PLUJEME RÁDI S.R.O.

Dlouhá 730/35, 11000 Praha 1 – Staré Město, Czech Republic

SERVICES

SELECTED SERVICES	OBLIGATORY	PAYMENT TYPE	PRICE
Charter package (Payable at the base) Season: 2026. (cleaning, consumables & processing fees)	Yes	per booking	380,00 €
Hostess (Payable at the base) Season: 2026. (private cabin and expenses at the customer's charge)	No	per day + food	250,00 €
Skipper (Payable at the base) Season: 2026.	No	per day + food	350,00 €
Sleep over before check in (Payable at the base) Season: 2026. Boarding the day before, with overnight stay at dock: 100EUR + berth fees (subject to availability)	No	per booking	100,00 €

**WEBSITE**www.plujeme.cz**E-MAIL**info@plujeme.cz**PHONE**

+420 720 755 085

**MOBILE**

+420 777 170 276

**PLUJEME RÁDI S.R.O.**

Dlouhá 730/35, 11000 Praha 1 – Staré Město, Czech Republic

ADDITIONAL EXTRAS

EXTRA	OBLIGATORY	PAYMENT TYPE	PRICE
Bed linen (Payable at the base) Season: 2026. per set for single cabin - Payable at the base	No	per set	25,00 €
Bed linen (Payable at the base) Season: 2026. per set for double cabin - Payable at the base	No	per set	55,00 €
Gennaker (Payable at the base) Season: 2026. Gennaker / Code 0 - Payable at the base	No	per week	100,00 €
Paddle board (Payable at the base) Season: 2026. inflatable - Payable at the base	No	per week	100,00 €
Underwater scooter (Payable at the base) Season: 2026. Payable at the base	No	per week	280,00 €

**WEBSITE**www.plujeme.cz**E-MAIL**info@plujeme.cz**PHONE**

+420 720 755 085

**MOBILE**

+420 777 170 276

**PLUJEME RÁDI S.R.O.**

Dlouhá 730/35, 11000 Praha 1 – Staré Město, Czech Republic

PRICE AND AVAILABILITY

04.07. - 17.07.2026

NOT AVAILABLE

25.07. - 07.08.2026

NOT AVAILABLE

01.09. - 31.12.2026

NOT AVAILABLE



WEBSITE

www.plujeme.cz



E-MAIL

info@plujeme.cz



PHONE

+420 720 755 085



MOBILE

+420 777 170 276



PLUJEME RÁDI S.R.O.

Dlouhá 730/35, 11000 Praha 1 – Staré Město, Czech Republic