

FERRETTI YACHTS 500

Alabdulla (2024)

Motor yacht Ferretti Yachts 500 Alabdulla, built in 2024 is anchored in the **Sukosan, D-Marin Dalmacija Marina, Zadar region, Croatia**. It has **3 + 1 cabins**, can accommodate **6 + 1 people** and has **2 toilets**. Bed linen and kitchen equipment are included in the price.

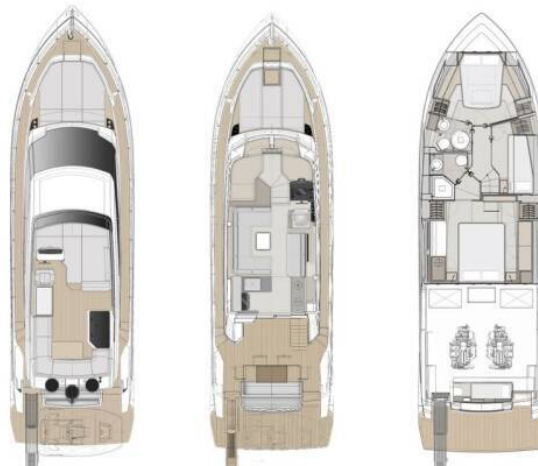

YACHT SPECIFICATIONS

Yacht Base

**Sukosan, D-Marin Dalmacija Marina,
Croatia**

Yacht ID

13224

Brands

Ferretti Yachts Group

Yacht name

Alabdulla

Production year

2024

Length

50 ft

Cabins

3 + 1

Berths

6 + 1

WC

2

Engine

2 x 550 HP

Fuel tank

01



WEBSITE

www.plujeme.cz



PHONE

+420 720 755 085



MOBILE

+420 777 170 276



E-MAIL

info@plujeme.cz



PLUJEME RÁDI S.R.O.

Dlouhá 730/35, 11000 Praha 1 – Staré Město, Czech Republic

STANDARD YACHT EQUIPMENT

Comfort	Cockpit cushions
Deck	Anchor with chain, Bilge pump - Mechanic, Cockpit table, Electric anchor windlass, Flybridge, Hydraulic gangway, Teak cockpit
Entertainment	Radio CD player, TV
Galley	Freezer, Microwave, Refrigerator, Stove
Navigation	Autopilot, Depthsounder, GPS chart plotter, Navigation/position Lights, Radar
Safety	Fire extinguisher, Life jackets, VHF radio
Yacht electrics	Air Conditioning, Battery charger, Generator, Shore power connection, Water heater



WEBSITE

www.plujeme.cz



E-MAIL

info@plujeme.cz



PHONE

+420 720 755 085



MOBILE

+420 777 170 276



PLUJEME RÁDI S.R.O.

Dlouhá 730/35, 11000 Praha 1 - Staré Město, Czech Republic

SERVICES

SELECTED SERVICES	OBLIGATORY	PAYMENT TYPE	PRICE
Charter pack (Payable at the base) Season: 2026. Includes: final cleaning, complete bed linen, towels, WIFI, dinghy with outboard engine	Yes	per booking	600,00 €
Tourist tax (Payable at the base) Season: 2026.	Yes	per person/day	1,35 €
Cook (Payable at the base) Season: 2026.	No	per day + food	500,00 €
Hostess (Payable at the base) Season: 2026.	No	per day + food	250,00 €
Skipper (Payable at the base) Season: 2026.	No	per day + food	250,00 €

**WEBSITE**www.plujeme.cz**E-MAIL**info@plujeme.cz**PHONE**

+420 720 755 085

**MOBILE**

+420 777 170 276

**PLUJEME RÁDI S.R.O.**

Dlouhá 730/35, 11000 Praha 1 – Staré Město, Czech Republic

ADDITIONAL EXTRAS

EXTRA	OBLIGATORY	PAYMENT TYPE	PRICE
Bike (Payable at the base) Season: 2026. kids - Payable at the base	No	per week	150,00 €
Bike (Payable at the base) Season: 2026. foldable - Payable at the base	No	per week	200,00 €
Bike (Payable at the base) Season: 2026. mountain bike - Payable at the base	No	per week	250,00 €
Donut (Payable at the base) Season: 2026. single - Payable at the base	No	per week	50,00 €
Donut (Payable at the base) Season: 2026. double - Payable at the base	No	per week	80,00 €
Donut (Payable at the base) Season: 2026. triple - Payable at the base	No	per week	150,00 €
eFoil (Payable at the base) Season: 2026. + 2000 EUR security deposit - Payable at the base	No	per week	1.500,00 €
Fishing cane/rod (Payable at the base) Season: 2026. Payable at the base	No	per week	20,00 €
Hoverboard (Payable at the base) Season: 2026. Payable at the base	No	per week	150,00 €
Jet Ski (Payable at the base) Season: 2026. Spark 60HP (2 seats) +1000 EUR security deposit - Payable at the base	No	per week	1.200,00 €
Kayak (Payable at the base) Season: 2026. 3 seats, with paddles - Payable at the base	No	per week	200,00 €
Kneeboard (Payable at the base) Season: 2026. Payable at the base	No	per week	200,00 €
Playstation 4 (Payable at the base) Season: 2026. Payable at the base	No	per week	100,00 €

Scooter (Payable at the base) Season: 2026. electric (foldable) - Payable at the base	No	per week	200,00 €
Seabob (Payable at the base) Season: 2026. New (F5) with normal charger + 1000 EUR security deposit - Payable at the base	No	per week	1.200,00 €
Seabob (Payable at the base) Season: 2026. New (F5 S) with fast charger + 2000 EUR security deposit - Payable at the base	No	per week	1.500,00 €
Snorkeling equipment (Payable at the base) Season: 2026. mask, snorkel & flippers - Payable at the base	No	per week	20,00 €
Stand up paddle (SUP) (Payable at the base) Season: 2026. Payable at the base	No	per week	100,00 €
Wakeboard (Payable at the base) Season: 2026. Payable at the base	No	per week	150,00 €
Water skis (Payable at the base) Season: 2026. with rope - Payable at the base	No	per week	150,00 €
Water skis for children (Payable at the base) Season: 2026. with rope - Payable at the base	No	per week	100,00 €
Windsurf (Payable at the base) Season: 2026. Beginner - Payable at the base	No	per week	300,00 €
Windsurf (Payable at the base) Season: 2026. Professional - Payable at the base	No	per week	400,00 €



WEBSITE

www.plujeme.cz



E-MAIL

info@plujeme.cz



PHONE

+420 720 755 085



MOBILE

+420 777 170 276



PLUJEME RÁDI S.R.O.

Dlouhá 730/35, 11000 Praha 1 – Staré Město, Czech Republic

PRICE AND AVAILABILITY

25.04. - 02.05.2026 14.060 € 14.800 €	02.05. - 09.05.2026 14.060 € 14.800 €	09.05. - 16.05.2026 14.060 € 14.800 €	16.05. - 23.05.2026 14.060 € 14.800 €
23.05. - 30.05.2026 14.060 € 14.800 €	30.05. - 06.06.2026 15.010 € 15.800 €	06.06. - 13.06.2026 15.010 € 15.800 €	13.06. - 27.06.2026 NOT AVAILABLE
27.06. - 04.07.2026 15.960 € 16.800 €	04.07. - 11.07.2026 15.960 € 16.800 €	11.07. - 18.07.2026 16.910 € 17.800 €	18.07. - 25.07.2026 16.910 € 17.800 €
25.07. - 01.08.2026 16.910 € 17.800 €	01.08. - 08.08.2026 16.910 € 17.800 €	08.08. - 15.08.2026 16.910 € 17.800 €	15.08. - 22.08.2026 15.960 € 16.800 €
22.08. - 29.08.2026 15.960 € 16.800 €	29.08. - 05.09.2026 15.010 € 15.800 €	05.09. - 12.09.2026 15.010 € 15.800 €	12.09. - 19.09.2026 15.010 € 15.800 €
19.09. - 26.09.2026 14.060 € 14.800 €	26.09. - 03.10.2026 14.060 € 14.800 €	03.10. - 10.10.2026 14.060 € 14.800 €	10.10. - 17.10.2026 14.060 € 14.800 €
17.10. - 24.10.2026 14.060 € 14.800 €	24.10. - 31.10.2026 14.060 € 14.800 €	31.10. - 07.11.2026 14.060 € 14.800 €	07.11. - 14.11.2026 14.060 € 14.800 €
14.11. - 21.11.2026 14.060 € 14.800 €	21.11. - 28.11.2026 14.060 € 14.800 €	28.11. - 05.12.2026 14.060 € 14.800 €	



WEBSITE

www.plujeme.cz



E-MAIL

info@plujeme.cz



PHONE

+420 720 755 085



MOBILE

+420 777 170 276



PLUJEME RÁDI S.R.O.

Dlouhá 730/35, 11000 Praha 1 – Staré Město, Czech Republic

PRICE AND AVAILABILITY

05.12. - 12.12.2026

14.060 € 14.800 €

12.12. - 19.12.2026

14.060 € 14.800 €

19.12. - 26.12.2026

14.060 € 14.800 €



WEBSITE

www.plujeme.cz



E-MAIL

info@plujeme.cz



PHONE

+420 720 755 085



MOBILE

+420 777 170 276



PLUJEME RÁDI S.R.O.

Dlouhá 730/35, 11000 Praha 1 – Staré Město, Czech Republic