

# FONTAINE PAJOT FP 44

## MAESTRO

Hi Iaka (2026)

Catamaran Fountaine Pajot FP 44 Maestro Hi Iaka, built in 2026 is anchored in the Palma de Mallorca, Marina Naviera Balear, Balearic Islands, Spain. It has 3 + 1 cabins, can accommodate 6 + 1 people and has 3 toilets. Bed linen and kitchen equipment are included in the price.

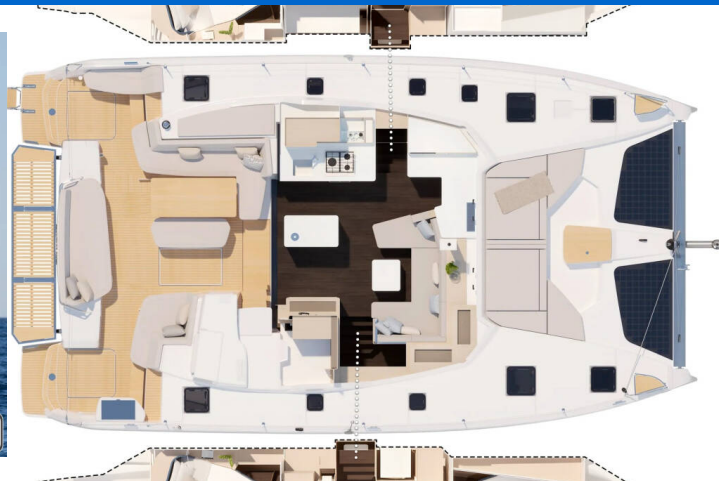

### YACHT SPECIFICATIONS

Yacht Base

**Palma de Mallorca, Marina Naviera  
Balear, Spain**

Yacht ID

**13222**

Brands

**Fountaine Pajot**

Yacht name

**Hi Iaka**

Production year

**2026**

Length

**44 ft**

Cabins

**3 + 1**

Berths

**6 + 1**

Max Persons

**8**

WC

**3**

Engine

**2 x 58 HP**

Fuel tank

**700 l**



**WEBSITE**

[www.plujeme.cz](http://www.plujeme.cz)



**PHONE**

+420 720 755 085



**MOBILE**

+420 777 170 276



**E-MAIL**

[info@plujeme.cz](mailto:info@plujeme.cz)



**PLUJEME RÁDI S.R.O.**

Dlouhá 730/35, 11000 Praha 1 - Staré Město, Czech Republic

## STANDARD YACHT EQUIPMENT

Additional	<b>Flag</b>
Comfort	<b>Cockpit cushions, Deck cushions</b>
Deck	<b>Anchor light, Anchor with chain, Bilge pump - Mechanic, Bimini top, Boat hook, Bow pulpit, Cockpit table, Cockpit/stern, outside shower, Davit, Dinghy, Electric anchor windlass, Fenders, Gangway, Hydraulic lifting swimming platform, Jerry cans for diesel, Mooring ropes, Plastic bucket, Spare anchor (Reserve, Auxiliary anchor), Spotlight / Headlights, Sprayhood, Swimming ladder, Teak cockpit</b>
Entertainment	<b>Outdoor speakers, Radio CD mp3 player</b>
Galley	<b>Coffee machine, Freezer, Freshwater treatment plant, Hot water, Kitchen utensils (Galley equipment, cutlery), Oven, Pressurized water system, Refrigerator, Sink, Stove</b>
Interior	<b>Clock, Safe, Salon table, Yacht keys</b>
Navigation	<b>AIS, Autopilot, Binoculars, Compass, GPS, GPS chart plotter - cockpit, Log, Speed, Depth- echo sounder, Navigation (Nautical) charts and nautical guide, Navigation/position Lights, Radar, Triangles, Wind instrument/Anemometer, Windex</b>
Safety	<b>Automatic Inflatable Life Jacket, Black Water Tank, Distress signals, EPIRB-Distress radio beacons, Fire extinguisher, First aid kit, Flashlight, Fog horn, Guard rail, Liferaft, Safety equipment, Set of tools, VHF radio</b>
Sails	<b>Electric winch, Halyard winches, Lazy bag, Lazy jacks, Self tacking jib</b>
Yacht electrics	<b>12V Socket, 220V socket, Adapter, Air Conditioning, Battery charger, Bilge pump - Electric, Converter 230V/12V, Generator, Shore power cable, USB sockets</b>



**WEBSITE**  
[www.plujeme.cz](http://www.plujeme.cz)



**PHONE**  
+420 720 755 085



**MOBILE**  
+420 777 170 276



**E-MAIL**  
[info@plujeme.cz](mailto:info@plujeme.cz)



**PLUJEME RÁDI S.R.O.**  
Dlouhá 730/35, 11000 Praha 1 - Staré Město, Czech Republic

## SERVICES

SELECTED SERVICES	OBLIGATORY	PAYMENT TYPE	PRICE
<b>Base package</b> (Payable at the base) <b>Season: 2026.</b> Cleaning, bed linen, towel set (1x small, 1x large), flushing set, WiFi, gas, dinghy & outboard engine	Yes	per booking	<b>500,00 €</b>
<b>Damage waiver</b> (Payable at the base) <b>Season: 2026.</b> The damage waiver costs 300,00 €. The customers still have to deposit 500,00 €. If there is no damage, they get the 500,00 € back. Can be finalized by the customer on the base. We do not need any information in advance.	No	per booking	<b>300,00 €</b>
<b>Early Check in</b> (Payable at the base) <b>Season: 2026.</b> at 12:00h (only on request); Payable in cash at the base	No	per booking	<b>150,00 €</b>
<b>Hostess</b> (Payable at the base) <b>Season: 2026.</b> Free food, own cabin	No	per week	<b>1.750,00 €</b>
<b>Pet on board</b> (Payable at the base) <b>Season: 2026.</b> on request only; Payable in cash at the base	No	per booking	<b>140,00 €</b>
<b>Skipper</b> (Payable at the base) <b>Season: 2026.</b> Free food, own skipper cabin	No	per week	<b>2.100,00 €</b>



### WEBSITE

[www.plujeme.cz](http://www.plujeme.cz)



### E-MAIL

[info@plujeme.cz](mailto:info@plujeme.cz)



### PHONE

+420 720 755 085



### MOBILE

+420 777 170 276



### PLUJEME RÁDI S.R.O.

Dlouhá 730/35, 11000 Praha 1 – Staré Město, Czech Republic

## ADDITIONAL EXTRAS

EXTRA	OBLIGATORY	PAYMENT TYPE	PRICE
<b>Beach towel</b> (Payable at the base) <b>Season: 2026.</b> Payable at the base	No	per person	<b>20,00 €</b>
<b>Grill/Barbecue/Plancha</b> (Payable at the base) <b>Season: 2026.</b> Danish Cobb Gas Grill (BBQ Grill), Payable in cash at base 50% second week] - Payable at the base	No	per week	<b>100,00 €</b>
<b>Snorkeling equipment</b> (Payable at the base) <b>Season: 2026.</b> diving mask and snorkel - Payable at the base	No	per set	<b>35,00 €</b>
<b>Stand up paddle (SUP)</b> (Payable at the base) <b>Season: 2026.</b> Payable in cash at the base 50% second week - Payable at the base	No	per week	<b>100,00 €</b>

**WEBSITE**[www.plujeme.cz](http://www.plujeme.cz)**E-MAIL**[info@plujeme.cz](mailto:info@plujeme.cz)**PHONE**

+420 720 755 085

**MOBILE**

+420 777 170 276

**PLUJEME RÁDI S.R.O.**

Dlouhá 730/35, 11000 Praha 1 – Staré Město, Czech Republic

## PRICE AND AVAILABILITY

11.07. - 18.07.2026 <b>10.583 €</b> 12.450 €	18.07. - 25.07.2026 ON OPTION	25.07. - 01.08.2026 NOT AVAILABLE	01.08. - 15.08.2026 NOT AVAILABLE
15.08. - 22.08.2026 <b>10.583 €</b> 12.450 €	22.08. - 29.08.2026 <b>10.583 €</b> 12.450 €	29.08. - 05.09.2026 <b>10.583 €</b> 12.450 €	05.09. - 12.09.2026 <b>9.095 €</b> 10.700 €
12.09. - 19.09.2026 <b>9.095 €</b> 10.700 €	19.09. - 26.09.2026 <b>8.245 €</b> 9.700 €	26.09. - 03.10.2026 <b>7.608 €</b> 8.950 €	03.10. - 10.10.2026 <b>6.758 €</b> 7.950 €
10.10. - 17.10.2026 <b>6.758 €</b> 7.950 €	17.10. - 24.10.2026 <b>4.888 €</b> 5.750 €	24.10. - 31.10.2026 <b>4.888 €</b> 5.750 €	31.10. - 07.11.2026 <b>4.888 €</b> 5.750 €
08.11. - 26.03.2027 NOT AVAILABLE			



**WEBSITE**  
[www.plujeme.cz](http://www.plujeme.cz)



**E-MAIL**  
[info@plujeme.cz](mailto:info@plujeme.cz)



**PHONE**  
+420 720 755 085



**PLUJEME RÁDI S.R.O.**  
Dlouhá 730/35, 11000 Praha 1 – Staré Město, Czech Republic



**MOBILE**  
+420 777 170 276

## PRICE AND AVAILABILITY

27.03. - 03.04.2027 4.888 € 5.750 €	03.04. - 10.04.2027 4.888 € 5.750 €	10.04. - 17.04.2027 4.888 € 5.750 €	17.04. - 24.04.2027 4.888 € 5.750 €
24.04. - 01.05.2027 4.888 € 5.750 €	01.05. - 08.05.2027 4.888 € 5.750 €	08.05. - 15.05.2027 6.758 € 7.950 €	15.05. - 22.05.2027 6.758 € 7.950 €
22.05. - 29.05.2027 7.608 € 8.950 €	29.05. - 05.06.2027 8.245 € 9.700 €	05.06. - 12.06.2027 8.245 € 9.700 €	12.06. - 19.06.2027 8.245 € 9.700 €
19.06. - 26.06.2027 8.245 € 9.700 €	26.06. - 03.07.2027 8.245 € 9.700 €	03.07. - 10.07.2027 10.583 € 12.450 €	10.07. - 17.07.2027 10.583 € 12.450 €
17.07. - 24.07.2027 10.583 € 12.450 €	24.07. - 31.07.2027 10.583 € 12.450 €	31.07. - 07.08.2027 10.583 € 12.450 €	



### WEBSITE

[www.plujeme.cz](http://www.plujeme.cz)



### E-MAIL

[info@plujeme.cz](mailto:info@plujeme.cz)



### PHONE

+420 720 755 085



### MOBILE

+420 777 170 276



### PLUJEME RÁDI S.R.O.

Dlouhá 730/35, 11000 Praha 1 – Staré Město, Czech Republic

## PRICE AND AVAILABILITY

07.08. - 14.08.2027 <b>10.583 €</b> 12.450 €	14.08. - 21.08.2027 <b>10.583 €</b> 12.450 €	21.08. - 28.08.2027 <b>10.583 €</b> 12.450 €	28.08. - 04.09.2027 <b>10.583 €</b> 12.450 €
04.09. - 11.09.2027 <b>9.095 €</b> 10.700 €	11.09. - 18.09.2027 <b>9.095 €</b> 10.700 €	18.09. - 25.09.2027 <b>8.245 €</b> 9.700 €	25.09. - 02.10.2027 <b>7.608 €</b> 8.950 €
02.10. - 09.10.2027 <b>6.758 €</b> 7.950 €	09.10. - 16.10.2027 <b>6.758 €</b> 7.950 €	16.10. - 23.10.2027 <b>4.888 €</b> 5.750 €	23.10. - 30.10.2027 <b>4.888 €</b> 5.750 €
30.10. - 06.11.2027 <b>4.888 €</b> 5.750 €	07.11. - 24.03.2028 NOT AVAILABLE		



### WEBSITE

[www.plujeme.cz](http://www.plujeme.cz)



### E-MAIL

[info@plujeme.cz](mailto:info@plujeme.cz)



### PHONE

+420 720 755 085



### MOBILE

+420 777 170 276



### PLUJEME RÁDI S.R.O.

Dlouhá 730/35, 11000 Praha 1 – Staré Město, Czech Republic