

DUFOUR 470

Rehoboam (2026)

Sailing yacht Dufour 470 Rehoboam, built in 2026 is anchored in the Marina D'Arechi, Campania, Italy. It has 4 + 1 cabins, can accommodate 8 + 2 + 1 people and has 4 toilets. Bed linen and kitchen equipment are included in the price.

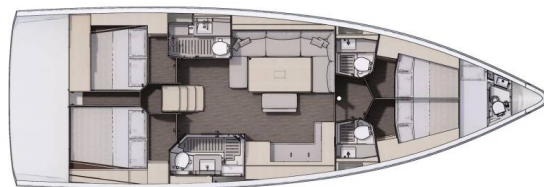

YACHT SPECIFICATIONS

Yacht Base

Marina D'Arechi, Italy

Yacht ID

13213

Brands

Dufour

Yacht name

Rehoboam

Production year

2026

Length

49 ft

Cabins

4 + 1

Berths

8 + 2 + 1

WC

4

Engine

1 x 75 HP

Fuel tank

250 l



WEBSITE

www.plujeme.cz



PHONE

+420 720 755 085



MOBILE

+420 777 170 276



E-MAIL

info@plujeme.cz



PLUJEME RÁDI S.R.O.

Dlouhá 730/35, 11000 Praha 1 – Staré Město, Czech Republic

STANDARD YACHT EQUIPMENT

Comfort	Cockpit cushions, Forward cockpit cushions
Deck	Anchor chain counter, Anchor with chain, Bimini top, Fenders, Mooring ropes, Sink in cockpit, Sprayhood, Teak cockpit, Teak deck
Galley	Additional fridge, Gas cookers, Water pump
Interior	Convertible table in salon, Electric toilet, Flexible bulkhead system, LED lights, Vacuum toilet
Navigation	Autopilot, Bow thruster, GPS chart plotter, Wind instrument/Anemometer
Safety	Safety equipment, VHF radio
Sails	Electric winch, Lazy bag
Yacht electrics	Air Conditioning, Battery charger, Generator, Inverter, Isotherm boiler



WEBSITE

www.plujeme.cz



E-MAIL

info@plujeme.cz



PHONE

+420 720 755 085



MOBILE

+420 777 170 276



PLUJEME RÁDI S.R.O.

Dlouhá 730/35, 11000 Praha 1 – Staré Město, Czech Republic

SERVICES

SELECTED SERVICES	OBLIGATORY	PAYMENT TYPE	PRICE
Charter pack (Payable at the base) Season: 2026. Internal / external cleaning, bedsheets+ covers, towel set-large/medium, fully equipped kitchen, cleaning products, coffee machine+ caps, gas bottle, tender with outboard engine	Yes	per week	700,00 €
Early Check in (Payable at the base) Season: 2026. 3 PM (to be approved by base manager)	No	per booking	300,00 €
Hostess/Cook (Payable at the base) Season: 2026.	No	per day + food	185,00 €
Late check out (Payable at the base) Season: 2026. at 19:00h or check-in on Sunday	No	per booking	150,00 €
Pet on board (Payable at the base) Season: 2026. Extra cleaning supplement for small dogs (10 kg); bigger dogs not allowed	No	per booking	250,00 €
Provisioning (Payable at the base) Season: 2026. 20% of the total supermarket receipt	No	per service	0,00 €
Skipper (Payable at the base) Season: 2026.	No	per week + food	1.650,00 €
Transfer (Payable at the base) Season: 2026. Transfers to and from Naples airport or other airports; Quotation on request per route and number of people	No	one-way	0,00 €
Transit log (Payable at the base) Season: 2026. Includes: parking for 1 car, free berth in the base port, water and electricity in the base port.	No	per week	90,00 €
WI-FI Internet connection on boat (Payable at the base) Season: 2026.	No	per week	50,00 €



WEBSITE
www.plujeme.cz



PHONE
+420 720 755 085



MOBILE
+420 777 170 276



E-MAIL
info@plujeme.cz



PLUJEME RÁDI S.R.O.
Dlouhá 730/35, 11000 Praha 1 – Staré Město, Czech Republic

ADDITIONAL EXTRAS

EXTRA	OBLIGATORY	PAYMENT TYPE	PRICE
Additional gas bottle (Payable at the base) Season: 2026. Payable at the base	No	per bottle	25,00 €
Beach towel (Payable at the base) Season: 2026. Payable at the base	No	per piece	10,00 €
Fishing Pack (Payable at the base) Season: 2026. (fishing rods, 2 rod holders, fishing kit - Payable at the base)	No	per week	500,00 €
Kayak (Payable at the base) Season: 2026. Payable at the base	No	per week	200,00 €
Railing net (Safety net) (Payable at the base) Season: 2026. Payable at the base	No	per week	150,00 €
Sea Scooter (Payable at the base) Season: 2026. Payable at the base	No	per week	300,00 €
Snorkeling equipment (Payable at the base) Season: 2026. Payable at the base	No	per person	25,00 €
Stand up paddle (SUP) (Payable at the base) Season: 2026. Payable at the base	No	per week	150,00 €



WEBSITE

www.plujeme.cz



E-MAIL

info@plujeme.cz



PHONE

+420 720 755 085



MOBILE

+420 777 170 276



PLUJEME RÁDI S.R.O.

Dlouhá 730/35, 11000 Praha 1 – Staré Město, Czech Republic

PRICE AND AVAILABILITY

23.05. - 30.05.2026 2.655 € 2.950 €	30.05. - 06.06.2026 ON OPTION	06.06. - 13.06.2026 3.375 € 3.750 €	13.06. - 20.06.2026 ON OPTION
20.06. - 27.06.2026 NOT AVAILABLE	27.06. - 04.07.2026 4.050 € 4.500 €	04.07. - 11.07.2026 4.680 € 5.200 €	11.07. - 18.07.2026 5.220 € 5.800 €
18.07. - 25.07.2026 5.220 € 5.800 €	25.07. - 01.08.2026 5.760 € 6.400 €	01.08. - 08.08.2026 5.760 € 6.400 €	08.08. - 15.08.2026 6.210 € 6.900 €
15.08. - 22.08.2026 6.210 € 6.900 €	22.08. - 29.08.2026 5.310 € 5.900 €	29.08. - 05.09.2026 5.310 € 5.900 €	05.09. - 12.09.2026 4.320 € 4.800 €
12.09. - 19.09.2026 4.320 € 4.800 €	19.09. - 03.10.2026 NOT AVAILABLE	03.10. - 10.10.2026 2.880 € 3.200 €	10.10. - 17.10.2026 2.880 € 3.200 €
17.10. - 24.10.2026 2.880 € 3.200 €	24.10. - 31.10.2026 2.880 € 3.200 €	31.10. - 07.11.2026 2.880 € 3.200 €	07.11. - 14.11.2026 2.880 € 3.200 €
14.11. - 21.11.2026 2.880 € 3.200 €	21.11. - 28.11.2026 2.880 € 3.200 €	28.11. - 05.12.2026 2.880 € 3.200 €	05.12. - 12.12.2026 2.880 € 3.200 €
12.12. - 19.12.2026 2.880 € 3.200 €	19.12. - 26.12.2026 2.880 € 3.200 €		



WEBSITE

www.plujeme.cz



E-MAIL

info@plujeme.cz



PHONE

+420 720 755 085



MOBILE

+420 777 170 276



PLUJEME RÁDI S.R.O.

Dlouhá 730/35, 11000 Praha 1 – Staré Město, Czech Republic