

# BAVARIA 46 CRUISER

2BiSi (2008)

Sailing yacht **Bavaria 46 Cruiser 2BiSi**, built in **2008** is anchored in the **Fethiye, Ece Saray Marina Resort, Aegean, Turkey**. It has **4 cabins**, can accommodate **8 people** and has **2 toilets**. Bed linen and kitchen equipment are included in the price.

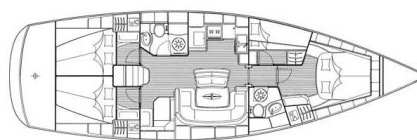

## YACHT SPECIFICATIONS

Yacht Base

**Fethiye, Ece Saray Marina Resort,  
Turkey**

Yacht ID

**13203**

Brands

**Bavaria**

Yacht name

**2BiSi**

Production year

**2008**

Length

**47 ft**

Cabins

**4**

Berths

**8**

Max Persons

**8**

WC

**2**

Engine

**1 x 55 HP**

Fuel tank

**210 l**



**WEBSITE**

[www.plujeme.cz](http://www.plujeme.cz)



**PHONE**

+420 720 755 085



**MOBILE**

+420 777 170 276



**E-MAIL**

[info@plujeme.cz](mailto:info@plujeme.cz)



**PLUJEME RÁDI S.R.O.**

Dlouhá 730/35, 11000 Praha 1 – Staré Město, Czech Republic

## STANDARD YACHT EQUIPMENT

Comfort	<b>Bed linen, Blankets, Cockpit cushions, Pillows</b>
Deck	<b>Anchor winch remote control, Anchor with chain, Bimini top, Cockpit table, Cockpit/stern, outside shower, Dinghy, Electric anchor windlass, Fenders, Gangway, Spare anchor (Reserve, Auxiliary anchor), Sprayhood, Teak cockpit</b>
Entertainment	<b>Outdoor speakers, Radio, USB, AUX Input</b>
Galley	<b>Gas bottles, Gas cookers, Hot water, Kitchen utensils (Galley equipment, cutlery), Oven, Refrigerator</b>
Interior	<b>Barometer, Clock, Electric toilet</b>
Navigation	<b>Autopilot, Compass, Echosounder/Depthsounder, GPS chart plotter, Log, Navigation (Nautical) charts and nautical guide, Wind instrument/Anemometer, Windex</b>
Safety	<b>Black Water Tank, Distress flare box, Emergency tiller, Fire blanket, Fire extinguisher, First aid kit, Life belts (Safety harness), Life buoy + Flashing light, Life jackets, Liferaft, Search light, Self inflating life vest, Torch, VHF radio</b>
Yacht electrics	<b>Batteries, Battery charger, Bilge pump - Electric, Shore connection 220 V</b>



#### WEBSITE

[www.plujeme.cz](http://www.plujeme.cz)



#### PHONE

+420 720 755 085



#### MOBILE

+420 777 170 276



#### E-MAIL

[info@plujeme.cz](mailto:info@plujeme.cz)



#### PLUJEME RÁDI S.R.O.

Dlouhá 730/35, 11000 Praha 1 – Staré Město, Czech Republic

## SERVICES

SELECTED SERVICES	OBLIGATORY	PAYMENT TYPE	PRICE
<b>Service Pack</b> (Payable at the base) <b>Season: 2026.</b> Includes Transitlog, Bed-linen, Towels, Gas Bottle	Yes	per booking	<b>400,00 €</b>
<b>Skipper</b> (Payable at the base) <b>Season: 2026.</b> (cash only)	No	per week + food	<b>180,00 €</b>
<b>WI-FI Internet connection on boat</b> (Payable at the base) <b>Season: 2026.</b>	No	per week	<b>80,00 €</b>



#### WEBSITE

[www.plujeme.cz](http://www.plujeme.cz)



#### E-MAIL

[info@plujeme.cz](mailto:info@plujeme.cz)



#### PHONE

+420 720 755 085



#### MOBILE

+420 777 170 276



#### PLUJEME RÁDI S.R.O.

Dlouhá 730/35, 11000 Praha 1 – Staré Město, Czech Republic

## ADDITIONAL EXTRAS

EXTRA	OBLIGATORY	PAYMENT TYPE	PRICE
<b>Outboard engine</b> <i>(Payable at the base)</i> <b>Season: 2026</b> <i>Payable at the base</i>	No	per week	<b>100,00 €</b>



#### WEBSITE

[www.plujeme.cz](http://www.plujeme.cz)



#### E-MAIL

[info@plujeme.cz](mailto:info@plujeme.cz)



#### PHONE

+420 720 755 085



#### MOBILE

+420 777 170 276



#### PLUJEME RÁDI S.R.O.

Dlouhá 730/35, 11000 Praha 1 – Staré Město, Czech Republic