

OCEANIS CLIPPER 411

Erika (2000)

Sailing yacht Oceanis Clipper 411 Erika, built in 2000 is anchored in the **Volos, Skiathos/Sporades, Volos, Greece**. It has **4 cabins**, can accommodate **8 + 2 people** and has **2 toilets**. Bed linen and kitchen equipment are included in the price.

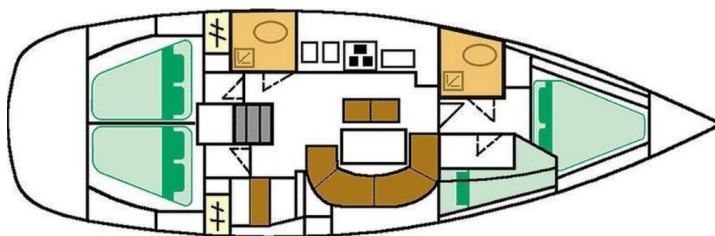

YACHT SPECIFICATIONS

Yacht Base

Volos, Greece

Yacht ID

13133

Brands

Beneteau

Yacht name

Erika

Production year

2000

Length

42 ft

Cabins

4

Berths

8 + 2

Max Persons

10

WC

2

Engine

1 x 54 HP

Fuel tank

150 l



WEBSITE

www.plujeme.cz



PHONE

+420 720 755 085



MOBILE

+420 777 170 276



E-MAIL

info@plujeme.cz



PLUJEME RÁDI S.R.O.

Dlouhá 730/35, 11000 Praha 1 – Staré Město, Czech Republic

STANDARD YACHT EQUIPMENT

Comfort	Cockpit cushions, Salon cushions
Deck	Bilge pump - Mechanic, Bimini top, Boat hook, Bosun's chair (Safe seat) (boatswain's chair), Cockpit table, Cockpit/stern, outside shower, Dinghy, Electric anchor windlass, Fenders, Gangway, Mooring ropes, Outboard engine, Spare anchor (Reserve, Auxiliary anchor), Sprayhood, Swimming ladder, Winch handles
Entertainment	CD player, Indoor speakers, Outdoor speakers, Radio
Galley	Coffee machine, Freezer, Hot water, Oven, Water pump
Interior	Barometer, Electric fans, Electric toilet
Navigation	Autopilot, Compass, Echosounder/Depthsounder, GPS, GPS chart plotter, Log/speed instrument, Navigation/position Lights, Radar reflector, Wind instrument/Anemometer
Safety	Distress flare box, Emergency tiller, EPIRB-Distress radio beacons, Fire extinguisher, First aid kit, Fog horn, Horseshoe lifebuoy, Life belts (Safety harness), Life jacket (children), Life jackets, Liferaft, Set of tools, VHF radio
Sails	Electric winch
Yacht electrics	Battery charger, Bilge pump - Electric, Shore connection 220 V, Shore power cable, Solar panels, Start battery



WEBSITE

www.plujeme.cz



PHONE

+420 720 755 085



MOBILE

+420 777 170 276



E-MAIL

info@plujeme.cz



PLUJEME RÁDI S.R.O.

Dlouhá 730/35, 11000 Praha 1 – Staré Město, Czech Republic

SERVICES

SELECTED SERVICES	OBLIGATORY	PAYMENT TYPE	PRICE
Charter package (Payable at the base) Season: 2026. (End cleaning, bed linen, towels, spare gas bottle, outboard with spare fuel tank, first & last night port fees)	Yes	per booking	180,00 €
Early Check in (Payable at the base) Season: 2026. by 14:00	No	per booking	120,00 €
Hostess (Payable at the base) Season: 2026.	No	per day + food	170,00 €
One way fee (Payable at the base) Season: 2026. Special Embarkation in Skiathos – Return to Volos (with our skipper). Available only upon request and only with our professional skipper on board. The yacht does not operate a base in Skiathos. Our skipper will deliver the yacht to Skiathos for embarkation, and the charter must end in Volos. Subject to availability and weather conditions.	No	one-way	250,00 €
Pet on board (Payable at the base) Season: 2026. (up to 15 kilos) end cleaning fee per booking/Subject to prior approval.	No	per booking	70,00 €
Provisioning (Payable at the base) Season: 2026. + receipts	No	per service	20,00 €
Skipper (Payable at the base) Season: 2026.	No	per day + food	200,00 €

**WEBSITE**www.plujeme.cz**E-MAIL**info@plujeme.cz**PHONE**

+420 720 755 085

**MOBILE**

+420 777 170 276

**PLUJEME RÁDI S.R.O.**

Dlouhá 730/35, 11000 Praha 1 – Staré Město, Czech Republic

ADDITIONAL EXTRAS

EXTRA	OBLIGATORY	PAYMENT TYPE	PRICE
Automatic Inflatable Life Jacket (Payable at the base) <i>Season: 2026. pp/per week - Payable at the base</i>	No	per guest/week	25,00 €
Beach towel (Payable at the base) <i>Season: 2026. pp/per week - Payable at the base</i>	No	per guest/week	5,00 €
Extra bedlinen and towels (Payable at the base) <i>Season: 2026. pp/per week(2 bed sheets,1 pillow case, 1 face towel, 1 body towel) - Payable at the base</i>	No	per guest/week	10,00 €
Kayak (Payable at the base) <i>Season: 2026. Upon request - Payable at the base</i>	No	per week	150,00 €
Railing net (Safety net) (Payable at the base) <i>Season: 2026. Payable at the base</i>	No	per booking	200,00 €
Snorkeling equipment (Payable at the base) <i>Season: 2026. pp/per week - Payable at the base</i>	No	per guest/week	30,00 €
Stand up paddle (SUP) (Payable at the base) <i>Season: 2026. For renting 2 Stand up paddles (SUP) the price is 200 EUR per week. - Payable at the base</i>	No	per week	120,00 €



WEBSITE
www.plujeme.cz



E-MAIL
info@plujeme.cz



PHONE
+420 720 755 085



PLUJEME RÁDI S.R.O.
Dlouhá 730/35, 11000 Praha 1 – Staré Město, Czech Republic



MOBILE
+420 777 170 276

PRICE AND AVAILABILITY

01.05. - 04.05.2026 NOT AVAILABLE	09.05. - 16.05.2026 2.100 €	16.05. - 23.05.2026 2.500 €	23.05. - 30.05.2026 2.500 €
30.05. - 04.06.2026 NOT AVAILABLE	06.06. - 20.06.2026 NOT AVAILABLE	20.06. - 27.06.2026 2.800 €	27.06. - 04.07.2026 2.800 €
04.07. - 11.07.2026 2.800 €	11.07. - 18.07.2026 NOT AVAILABLE	20.07. - 24.07.2026 NOT AVAILABLE	25.07. - 01.08.2026 3.200 €
03.08. - 12.08.2026 NOT AVAILABLE	15.08. - 22.08.2026 3.200 €	22.08. - 29.08.2026 2.800 €	29.08. - 05.09.2026 2.800 €
05.09. - 12.09.2026 2.800 €	12.09. - 19.09.2026 2.500 €	19.09. - 26.09.2026 2.500 €	30.09. - 10.10.2026 NOT AVAILABLE
10.10. - 17.10.2026 2.100 €	17.10. - 24.10.2026 2.000 €	24.10. - 31.10.2026 2.000 €	31.10. - 07.11.2026 2.000 €
07.11. - 14.11.2026 2.000 €	14.11. - 21.11.2026 2.000 €	21.11. - 28.11.2026 2.000 €	28.11. - 05.12.2026 2.000 €



WEBSITE
www.plujeme.cz



E-MAIL
info@plujeme.cz



PHONE
+420 720 755 085



MOBILE
+420 777 170 276



PLUJEME RÁDI S.R.O.
Dlouhá 730/35, 11000 Praha 1 – Staré Město, Czech Republic

PRICE AND AVAILABILITY

05.12. - 12.12.2026

2.000 €

12.12. - 19.12.2026

2.000 €

19.12. - 26.12.2026

2.000 €



WEBSITE

www.plujeme.cz



E-MAIL

info@plujeme.cz



PHONE

+420 720 755 085



MOBILE

+420 777 170 276



PLUJEME RÁDI S.R.O.

Dlouhá 730/35, 11000 Praha 1 – Staré Město, Czech Republic