

# BAVARIA C46

Azzurra (2026)

Sailing yacht **Bavaria C46 Azzurra**, built in **2026** is anchored in the **Marina Pirovac, Šibenik region, Croatia**. It has **4 cabins**, can accommodate **8 + 2 people** and has **2 toilets**. Bed linen and kitchen equipment are included in the price.

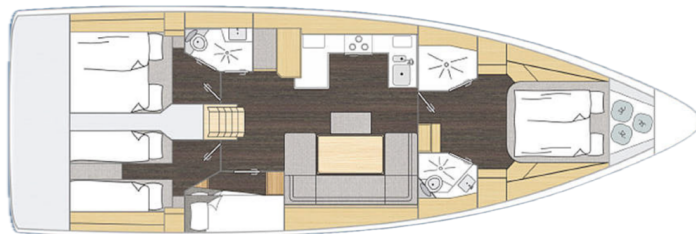

## YACHT SPECIFICATIONS

Yacht Base

**Marina Pirovac, Croatia**

Yacht ID

**13094**

Brands

**Bavaria**

Yacht name

**Azzurra**

Production year

**2026**

Length

**48 ft**

Cabins

**4**

Berths

**8 + 2**

Max Persons

**10**

WC

**2**

Engine

**1 x 80 HP**

Fuel tank

**250 l**



**WEBSITE**

[www.plujeme.cz](http://www.plujeme.cz)



**PHONE**

+420 720 755 085



**MOBILE**

+420 777 170 276



**E-MAIL**

[info@plujeme.cz](mailto:info@plujeme.cz)



**PLUJEME RÁDI S.R.O.**

Dlouhá 730/35, 11000 Praha 1 – Staré Město, Czech Republic

## STANDARD YACHT EQUIPMENT

Comfort	<b>Bed linen, Cockpit cushions</b>
Deck	<b>Anchor line, Anchor swivel, Bathing platform, Bimini top, Black ball, Black conus, Boat hook, Bosun's chair (Safe seat) (boatswain's chair), Canister for water, Cockpit fridge, Cockpit/stern, outside shower, Dinghy, Dinghy (byboat) pump, Electric anchor windlass, Fenders, Gangway, Grill/Barbecue/Plancha, Hawser, Impeller, V-belt, oilfilter, Jerry cans for diesel, Mooring ropes, Plastic bucket, Repair box for dinghy, Round/globular fender, Spare anchor (Reserve, Auxiliary anchor), Spotlight / Headlights, Sprayhood, Spring line, Teak cockpit, Water hose</b>
Entertainment	<b>Indoor speakers, Radio CD player, USB, Bluetooth</b>
Galley	<b>Extractor Hood, Gas bottles, Hot water, Kitchen utensils (Galley equipment, cutlery), Refrigerator</b>
Interior	<b>Barometer, Clock, Electric toilet</b>
Navigation	<b>AIS, Autopilot, Bow thruster, Bretonplotter, GPS chart plotter - cockpit, Harbour guides, Logge/Lot/Speed/Wind, Navigation (Nautical) charts and nautical guide, Navigation set, Parallel ruler, Radar reflector, Spyglass with bearing compass, Windex</b>
Safety	<b>Distress signals, Fire extinguisher, First aid kit, Flashlight, Fog horn, Life belts (Safety harness), Life buoy + Flashing light, Life jackets, Liferaft, Set of tools, VHF radio, Wire (shroud) cutter</b>
Sails	<b>Bowsprit, Electric winch</b>
Yacht electrics	<b>Air Conditioning, Battery charger, Heating, Inverter, Shore connection 220 V, Solar panels</b>



**WEBSITE**

[www.plujeme.cz](http://www.plujeme.cz)



**PHONE**

+420 720 755 085



**MOBILE**

+420 777 170 276



**E-MAIL**

[info@plujeme.cz](mailto:info@plujeme.cz)



**PLUJEME RÁDI S.R.O.**

Dlouhá 730/35, 11000 Praha 1 – Staré Město, Czech Republic

## SERVICES

SELECTED SERVICES	OBLIGATORY	PAYMENT TYPE	PRICE
<b>Permit</b> (Payable now) <b>Season: 2026.</b> final cleaning, check in/out, gas, bedlinen	Yes	per booking	<b>350,00 €</b>
<b>WI-FI Internet connection on boat</b> (Payable at the base) <b>Season: 2026.</b> unlimited, included in price	Yes	per booking	<b>0,00 €</b>
<b>Damage waiver</b> (Payable at the base) <b>Season: 2026.</b> no deposit needed	No	per booking	<b>337,12 €</b>
<b>Early boarding/check-in</b> (Payable at the base) <b>Season: 2026.</b> Check-in 12:00 -13:00, max 5 yachts	No	per booking	<b>160,00 €</b>
<b>Extra cleaning</b> (Payable at the base) <b>Season: 2026.</b>	No	per booking	<b>180,00 €</b>
<b>Hostess/Cook</b> (Payable at the base) <b>Season: 2026.</b> + own cabin; payable in cash	No	per day + food	<b>200,00 €</b>
<b>Late return to base</b> (Payable at the base) <b>Season: 2026.</b> Return to base on Saturday until 07:30 AM	No	per booking	<b>200,00 €</b>
<b>Pet on board</b> (Payable at the base) <b>Season: 2026.</b>	No	per pet	<b>100,00 €</b>
<b>Provisioning</b> (Payable at the base) <b>Season: 2026.</b> before Check-In, plus purchase price	No	per booking	<b>150,00 €</b>
<b>Regatta charge</b> (Payable at the base) <b>Season: 2026.</b> on request	No	per booking	<b>0,00 €</b>
<b>Sailing Instructor</b> (Payable at the base) <b>Season: 2026.</b> Training with RYA Instructor, price on daily base, German/English speaking	No	per day + food	<b>500,00 €</b>
<b>Skipper</b> (Payable at the base) <b>Season: 2026.</b> + own cabin; payable in cash, German/English speaking	No	per day + food	<b>400,00 €</b>
<b>Skipper training practice</b> (Payable at the base) <b>Season: 2026.</b> Sunday Maneuver Training 9 AM - 1 PM	No	per service	<b>250,00 €</b>

**Transfer** (Payable at the base)

No

per booking

**0,00 €**

**Season: 2026.** price on daily base



**WEBSITE**

[www.plujeme.cz](http://www.plujeme.cz)



**E-MAIL**

[info@plujeme.cz](mailto:info@plujeme.cz)



**PHONE**

+420 720 755 085



**MOBILE**

+420 777 170 276



**PLUJEME RÁDI S.R.O.**

Dlouhá 730/35, 11000 Praha 1 – Staré Město, Czech Republic

## ADDITIONAL EXTRAS

EXTRA	OBLIGATORY	PAYMENT TYPE	PRICE
<b>Coolbox</b> (Payable at the base) <b>Season: 2026.</b> 20L - Payable at the base	No	per booking	<b>90,00 €</b>
<b>Electric outboard engine</b> (Payable at the base) <b>Season: 2026.</b> Payable at the base	No	per week	<b>90,00 €</b>
<b>Extra bedlinen</b> (Payable at the base) <b>Season: 2026.</b> Payable at the base	No	per set	<b>7,00 €</b>
<b>Gennaker</b> (Payable at the base) <b>Season: 2026.</b> + € 600 deposit in cash - Payable at the base	No	per week	<b>400,00 €</b>
<b>Railing net (Safety net)</b> (Payable at the base) <b>Season: 2026.</b> Payable at the base	No	per booking	<b>90,00 €</b>
<b>Stand up paddle (SUP)</b> (Payable at the base) <b>Season: 2026.</b> Payable at the base	No	per week	<b>100,00 €</b>
<b>Towels</b> (Payable at the base) <b>Season: 2026.</b> Payable at the base	No	per set	<b>10,00 €</b>



**WEBSITE**  
www.plujeme.cz



**E-MAIL**  
info@plujeme.cz



**PHONE**  
+420 720 755 085



**PLUJEME RÁDI S.R.O.**  
Dlouhá 730/35, 11000 Praha 1 – Staré Město, Czech Republic



**MOBILE**  
+420 777 170 276

## PRICE AND AVAILABILITY

11.07. - 18.07.2026 NOT AVAILABLE	19.07. - 07.08.2026 NOT AVAILABLE	08.08. - 15.08.2026 NOT AVAILABLE	15.08. - 22.08.2026 <b>3.953 €</b> 5.490 €
22.08. - 29.08.2026 NOT AVAILABLE	29.08. - 12.09.2026 NOT AVAILABLE	12.09. - 19.09.2026 NOT AVAILABLE	19.09. - 26.09.2026 NOT AVAILABLE
26.09. - 03.10.2026 <b>2.333 €</b> 3.240 €	03.10. - 07.10.2026 NOT AVAILABLE	10.10. - 17.10.2026 <b>1.555 €</b> 2.160 €	17.10. - 24.10.2026 <b>1.555 €</b> 2.160 €
24.10. - 31.10.2026 NOT AVAILABLE	31.10. - 07.11.2026 <b>1.555 €</b> 2.160 €	07.11. - 14.11.2026 <b>1.944 €</b> 2.160 €	14.11. - 21.11.2026 <b>1.944 €</b> 2.160 €
21.11. - 28.11.2026 <b>1.944 €</b> 2.160 €	28.11. - 05.12.2026 <b>1.944 €</b> 2.160 €	05.12. - 12.12.2026 <b>2.160 €</b>	12.12. - 19.12.2026 <b>2.160 €</b>
19.12. - 26.12.2026 <b>2.160 €</b>			



**WEBSITE**  
[www.plujeme.cz](http://www.plujeme.cz)



**E-MAIL**  
[info@plujeme.cz](mailto:info@plujeme.cz)



**PHONE**  
+420 720 755 085



**MOBILE**  
+420 777 170 276



**PLUJEME RÁDI S.R.O.**  
Dlouhá 730/35, 11000 Praha 1 – Staré Město, Czech Republic