

BAVARIA C42

Blue Eyes (2024)

Sailing yacht **Bavaria C42 Blue Eyes**, built in **2024** is anchored in the **Palma de Mallorca, Marina Naviera Balear, Balearic Islands, Spain**. It has **3 cabins**, can accommodate **6 people** and has **2 toilets**. Bed linen and kitchen equipment are included in the price.

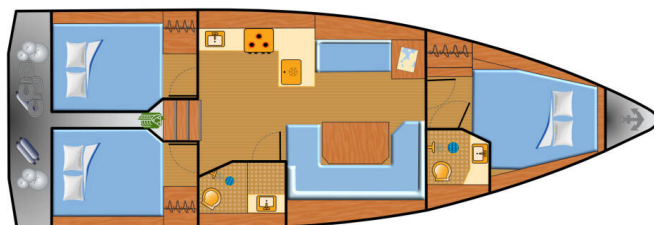

YACHT SPECIFICATIONS

Yacht Base

**Palma de Mallorca, Marina Naviera
Balear, Spain**

Yacht ID

13071

Brands

Bavaria

Yacht name

Blue Eyes

Production year

2024

Length

41 ft

Cabins

3

Berths

6

WC

2

Engine

1 x 29 HP

Fuel tank

210 l



WEBSITE

www.plujeme.cz



PHONE

+420 720 755 085



MOBILE

+420 777 170 276



E-MAIL

info@plujeme.cz



PLUJEME RÁDI S.R.O.

Dlouhá 730/35, 11000 Praha 1 – Staré Město, Czech Republic

STANDARD YACHT EQUIPMENT

Additional	Flag
Comfort	Cockpit cushions
Deck	Anchor light, Anchor with chain, Bathing platform, Bimini top, Boat hook, Bosun's chair (Safe seat) (boatswain's chair), Bow pulpit, Cockpit table, Cockpit/stern, outside shower, Deck brush, Dinghy, Electric anchor windlass, Fenders, Gangway, Jerry cans for diesel, Mooring ropes, Plastic bucket, Spare anchor (Reserve, Auxiliary anchor), Spotlight / Headlights, Sprayhood, Swimming ladder, Teak cockpit
Entertainment	Outdoor speakers, Radio CD mp3 player, Wi-Fi Internet
Galley	Hot water, Kitchen utensils (Galley equipment, cutlery), Oven, Pressurized water system, Refrigerator, Sink, Stove
Interior	Clock, Convertible table in salon, Heater / Blower, Safe, Yacht keys
Navigation	AIS, Autopilot, Binoculars, Bow thruster, Compass, Composite steering wheels, GPS, GPS chart plotter - cockpit, Log, Speed, Depth- echo sounder, Navigation (Nautical) charts and nautical guide, Navigation/position Lights, Triangles, Wind instrument/Anemometer, Windex
Safety	Black Water Tank, Distress signals, Emergency tiller, EPIRB-Distress radio beacons, Fire extinguisher, First aid kit, Flashlight, Fog horn, Guard rail, Life belts (Safety harness), Liferaft, Safety equipment, Set of tools, VHF radio, Wire (shroud) cutter
Sails	Halyard winches
Yacht electrics	12V Socket, 220V socket, Adapter, Battery charger, Bilge pump - Electric, Converter 230V/12V, Heating, Shore power cable



WEBSITE

www.plujeme.cz



PHONE

+420 720 755 085



MOBILE

+420 777 170 276



E-MAIL

info@plujeme.cz



PLUJEME RÁDI S.R.O.

Dlouhá 730/35, 11000 Praha 1 – Staré Město, Czech Republic

SERVICES

SELECTED SERVICES	OBLIGATORY	PAYMENT TYPE	PRICE
Base package (Payable at the base) Season: 2026. Cleaning, bed linen, towel set (1x small, 1x large), flushing set, WiFi, gas, dinghy & outboard engine	Yes	per booking	500,00 €
Damage waiver (Payable at the base) Season: 2026. The damage waiver costs 300,00 €. The customers still have to deposit 500,00 €. If there is no damage, they get the 500,00 € back. Can be finalized by the customer on the base. We do not need any information in advance.	No	per booking	300,00 €
Early Check in (Payable at the base) Season: 2026. at 12:00h (only on request); Payable in cash at the base	No	per booking	150,00 €
Hostess (Payable at the base) Season: 2026. Free food, own cabin	No	per week	1.750,00 €
Pet on board (Payable at the base) Season: 2026. on request only; Payable in cash at the base	No	per booking	140,00 €
Skipper (Payable at the base) Season: 2026. Free food, own skipper cabin	No	per week	2.100,00 €



WEBSITE

www.plujeme.cz



E-MAIL

info@plujeme.cz



PHONE

+420 720 755 085



MOBILE

+420 777 170 276



PLUJEME RÁDI S.R.O.

Dlouhá 730/35, 11000 Praha 1 – Staré Město, Czech Republic

ADDITIONAL EXTRAS

EXTRA	OBLIGATORY	PAYMENT TYPE	PRICE
Beach towel (Payable at the base) Season: 2026. Payable at the base	No	per person	20,00 €
Gennaker (Payable at the base) Season: 2026. For 1 week is 250,00€, for 2 weeks are 375,00€, for 3 weeks are 500,00€; (50% for the second and subsequent weeks) - Payable at the base	No	per week	250,00 €
Grill/Barbecue/Plancha (Payable at the base) Season: 2026. Danish Cobb Gas Grill (BBQ Grill), Payable in cash at base 50% second week] - Payable at the base	No	per week	100,00 €
Snorkeling equipment (Payable at the base) Season: 2026. diving mask and snorkel - Payable at the base	No	per set	35,00 €
Stand up paddle (SUP) (Payable at the base) Season: 2026. Payable in cash at the base 50% second week - Payable at the base	No	per week	100,00 €



WEBSITE

www.plujeme.cz



PHONE

+420 720 755 085



MOBILE

+420 777 170 276



E-MAIL

info@plujeme.cz



PLUJEME RÁDI S.R.O.

Dlouhá 730/35, 11000 Praha 1 – Staré Město, Czech Republic

PRICE AND AVAILABILITY

25.04. - 02.05.2026 2.025 € 2.700 €	02.05. - 09.05.2026 NOT AVAILABLE	09.05. - 16.05.2026 2.625 € 3.500 €	16.05. - 23.05.2026 2.625 € 3.500 €
23.05. - 06.06.2026 NOT AVAILABLE	06.06. - 13.06.2026 3.225 € 4.300 €	13.06. - 20.06.2026 3.225 € 4.300 €	20.06. - 27.06.2026 NOT AVAILABLE
27.06. - 04.07.2026 NOT AVAILABLE	04.07. - 11.07.2026 4.165 € 4.900 €	11.07. - 18.07.2026 NOT AVAILABLE	18.07. - 25.07.2026 4.165 € 4.900 €
25.07. - 01.08.2026 4.165 € 4.900 €	01.08. - 08.08.2026 4.165 € 4.900 €	08.08. - 15.08.2026 NOT AVAILABLE	15.08. - 22.08.2026 4.165 € 4.900 €
22.08. - 29.08.2026 4.165 € 4.900 €	29.08. - 05.09.2026 4.165 € 4.900 €	05.09. - 12.09.2026 3.910 € 4.600 €	12.09. - 19.09.2026 NOT AVAILABLE
19.09. - 26.09.2026 NOT AVAILABLE	26.09. - 03.10.2026 NOT AVAILABLE	03.10. - 24.10.2026 NOT AVAILABLE	24.10. - 31.10.2026 NOT AVAILABLE
31.10. - 07.11.2026 2.295 € 2.700 €	08.11. - 26.03.2027 NOT AVAILABLE		



WEBSITE

www.plujeme.cz



E-MAIL

info@plujeme.cz



PHONE

+420 720 755 085



MOBILE

+420 777 170 276



PLUJEME RÁDI S.R.O.

Dlouhá 730/35, 11000 Praha 1 – Staré Město, Czech Republic

PRICE AND AVAILABILITY

27.03. - 03.04.2027 2.295 € 2.700 €	03.04. - 10.04.2027 2.295 € 2.700 €	10.04. - 17.04.2027 2.295 € 2.700 €	17.04. - 24.04.2027 2.295 € 2.700 €
24.04. - 01.05.2027 2.295 € 2.700 €	01.05. - 08.05.2027 2.295 € 2.700 €	08.05. - 15.05.2027 2.975 € 3.500 €	15.05. - 22.05.2027 2.975 € 3.500 €
22.05. - 29.05.2027 3.145 € 3.700 €	29.05. - 05.06.2027 3.655 € 4.300 €	05.06. - 12.06.2027 3.655 € 4.300 €	12.06. - 19.06.2027 3.655 € 4.300 €
19.06. - 26.06.2027 3.655 € 4.300 €	26.06. - 03.07.2027 3.655 € 4.300 €	03.07. - 10.07.2027 4.165 € 4.900 €	10.07. - 17.07.2027 4.165 € 4.900 €
17.07. - 24.07.2027 4.165 € 4.900 €	24.07. - 31.07.2027 4.165 € 4.900 €	31.07. - 07.08.2027 4.165 € 4.900 €	



WEBSITE

www.plujeme.cz



E-MAIL

info@plujeme.cz



PHONE

+420 720 755 085



MOBILE

+420 777 170 276



PLUJEME RÁDI S.R.O.

Dlouhá 730/35, 11000 Praha 1 – Staré Město, Czech Republic

PRICE AND AVAILABILITY

07.08. - 14.08.2027 4.165 € 4.900 €	14.08. - 21.08.2027 4.165 € 4.900 €	21.08. - 28.08.2027 4.165 € 4.900 €	28.08. - 04.09.2027 4.165 € 4.900 €
04.09. - 11.09.2027 3.910 € 4.600 €	11.09. - 18.09.2027 3.910 € 4.600 €	18.09. - 25.09.2027 3.655 € 4.300 €	25.09. - 02.10.2027 3.145 € 3.700 €
02.10. - 09.10.2027 2.975 € 3.500 €	09.10. - 16.10.2027 2.975 € 3.500 €	16.10. - 23.10.2027 2.295 € 2.700 €	23.10. - 30.10.2027 2.295 € 2.700 €
30.10. - 06.11.2027 2.295 € 2.700 €	07.11. - 24.03.2028 NOT AVAILABLE		



WEBSITE
www.plujeme.cz



E-MAIL
info@plujeme.cz



PHONE
+420 720 755 085



PLUJEME RÁDI S.R.O.
Dlouhá 730/35, 11000 Praha 1 – Staré Město, Czech Republic



MOBILE
+420 777 170 276