

# BALI 5.4

Arcturus (2024)

Catamaran Bali 5.4 Arcturus, built in 2024 is anchored in the Seychelles, Eden Island Marina, Mahé, Seychelles. It has 5 + 2 cabins, can accommodate 10 + 2 people and has 5 + 2 toilets. Bed linen and kitchen equipment are included in the price.

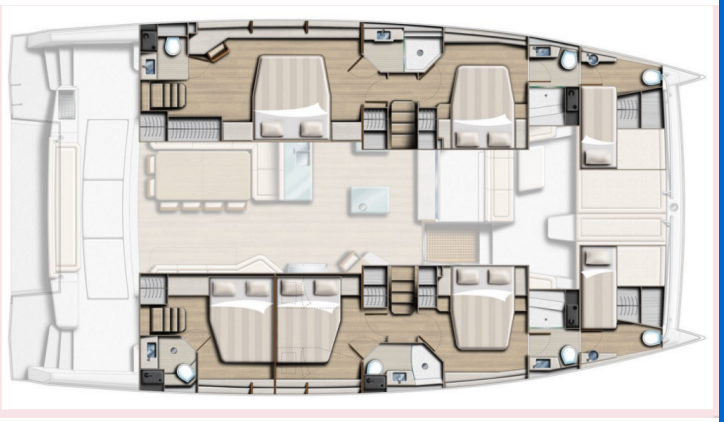

## YACHT SPECIFICATIONS

Yacht Base

**Seychelles, Eden Island Marina,  
Seychelles**

Yacht ID

**12996**

Brands

**Catana**

Yacht name

**Arcturus**

Production year

**2024**

Length

**55 ft**

Cabins

**5 + 2**

Berths

**10 + 2**

WC

**5 + 2**

Engine

**2 x 80 HP**

Fuel tank

**1260 l**



**WEBSITE**

[www.plujeme.cz](http://www.plujeme.cz)



**PHONE**

+420 720 755 085



**MOBILE**

+420 777 170 276



**E-MAIL**

[info@plujeme.cz](mailto:info@plujeme.cz)



**PLUJEME RÁDI S.R.O.**

Dlouhá 730/35, 11000 Praha 1 – Staré Město, Czech Republic

## STANDARD YACHT EQUIPMENT

Comfort	<b>Blankets, Pillows, Sun mattresses, Towels</b>
Deck	<b>Bimini top, Cockpit/stern, outside shower, Dinghy, Flybridge</b>
Entertainment	<b>Indoor speakers, LED TV, Outdoor speakers, Snorkeling equipment, Sound System, Stand up paddle (SUP)</b>
Galley	<b>Coffee machine, Dishwasher, Freezer, Gas cookers, Ice maker, Kitchen utensils (Galley equipment, cutlery), Microwave, Oven, Refrigerator, Sink</b>
Interior	<b>Electric toilet, Inside shower</b>
Navigation	<b>Autopilot, Bow thruster, GPS chart plotter - cockpit</b>
Yacht electrics	<b>Air Conditioning, Generator, Heating, Solar panels, Watermaker - desalinator</b>



#### WEBSITE

[www.plujeme.cz](http://www.plujeme.cz)



#### E-MAIL

[info@plujeme.cz](mailto:info@plujeme.cz)



#### PHONE

+420 720 755 085



#### MOBILE

+420 777 170 276



#### PLUJEME RÁDI S.R.O.

Dlouhá 730/35, 11000 Praha 1 – Staré Město, Czech Republic

## SERVICES

SELECTED SERVICES	OBLIGATORY	PAYMENT TYPE	PRICE
<b>Base costs</b> (Payable at the base) <b>Season: 2026.</b> Transit log, Departure cleaning and Final cleaning of the boat, after your stay + X1 Complimentary Cooler Box with Ice to start charter	Yes	per booking	<b>490,00 €</b>
<b>Skipper</b> (Payable at the base) <b>Season: 2026.</b>	Yes	per day + food	<b>165,00 €</b>
<b>Chef</b> (Payable at the base) <b>Season: 2026.</b>	No	per day + food	<b>130,00 €</b>
<b>Chef</b> (Payable at the base) <b>Season: 2026.</b> Chef Levy	No	per day	<b>30,00 €</b>
<b>Deckhand/ Marinero</b> (Payable at the base) <b>Season: 2026.</b>	No	per day + food	<b>100,00 €</b>
<b>Full board</b> (Payable at the base) <b>Season: 2026.</b>	No	per person/day	<b>60,00 €</b>
<b>Hostess</b> (Payable at the base) <b>Season: 2026.</b>	No	per day + food	<b>100,00 €</b>
<b>WI-FI Internet connection on boat</b> (Payable at the base) <b>Season: 2026.</b> 15 GB PER DAY	No	per week	<b>100,00 €</b>



**WEBSITE**  
www.plujeme.cz



**PHONE**  
+420 720 755 085



**MOBILE**  
+420 777 170 276



**E-MAIL**  
info@plujeme.cz



**PLUJEME RÁDI S.R.O.**  
Dlouhá 730/35, 11000 Praha 1 – Staré Město, Czech Republic

## ADDITIONAL EXTRAS

EXTRA	OBLIGATORY	PAYMENT TYPE	PRICE
<b>Extra bedlinen and towels</b> (Payable at the base) <i>Season: 2026. Payable at the base</i>	No	per set	<b>30,00 €</b>
<b>Fishing equipment</b> (Payable at the base) <i>Season: 2026. (1 rod + 1 lure)+100 euro deposit - Payable at the base</i>	No	per week	<b>100,00 €</b>
<b>Kayak</b> (Payable at the base) <i>Season: 2026. +100 Euro deposit - Payable at the base</i>	No	per week	<b>100,00 €</b>
<b>Railing net (Safety net)</b> (Payable at the base) <i>Season: 2026. Payable at the base</i>	No	per booking	<b>300,00 €</b>
<b>Stand up paddle (SUP)</b> (Payable at the base) <i>Season: 2026. ( 1 Board + 1 Paddle)+100 euro deposit - Payable at the base</i>	No	per week	<b>100,00 €</b>
<b>Starlink</b> (Payable at the base) <i>Season: 2026. 50gb - Payable at the base</i>	No	per booking	<b>300,00 €</b>



**WEBSITE**

[www.plujeme.cz](http://www.plujeme.cz)



**E-MAIL**

[info@plujeme.cz](mailto:info@plujeme.cz)



**PHONE**

+420 720 755 085



**MOBILE**

+420 777 170 276



**PLUJEME RÁDI S.R.O.**

Dlouhá 730/35, 11000 Praha 1 – Staré Město, Czech Republic

## PRICE AND AVAILABILITY

25.04. - 02.05.2026 NOT AVAILABLE	02.05. - 09.05.2026 NOT AVAILABLE	09.05. - 16.05.2026 13.000 €	16.05. - 23.05.2026 13.000 €
23.05. - 30.05.2026 13.000 €	30.05. - 06.06.2026 12.500 €	06.06. - 13.06.2026 11.000 €	13.06. - 20.06.2026 11.000 €
20.06. - 27.06.2026 11.000 €	27.06. - 04.07.2026 11.000 €	04.07. - 11.07.2026 NOT AVAILABLE	11.07. - 18.07.2026 ON OPTION
18.07. - 25.07.2026 NOT AVAILABLE	25.07. - 01.08.2026 11.000 €	01.08. - 08.08.2026 NOT AVAILABLE	08.08. - 15.08.2026 NOT AVAILABLE
15.08. - 22.08.2026 11.000 €	22.08. - 29.08.2026 NOT AVAILABLE	29.08. - 05.09.2026 NOT AVAILABLE	05.09. - 12.09.2026 11.000 €
12.09. - 19.09.2026 NOT AVAILABLE	19.09. - 26.09.2026 NOT AVAILABLE	26.09. - 03.10.2026 11.000 €	03.10. - 10.10.2026 NOT AVAILABLE
10.10. - 17.10.2026 NOT AVAILABLE	17.10. - 24.10.2026 NOT AVAILABLE	24.10. - 31.10.2026 NOT AVAILABLE	31.10. - 07.11.2026 NOT AVAILABLE
07.11. - 14.11.2026 NOT AVAILABLE	14.11. - 21.11.2026 NOT AVAILABLE	21.11. - 28.11.2026 NOT AVAILABLE	28.11. - 05.12.2026 NOT AVAILABLE



WEBSITE

[www.plujeme.cz](http://www.plujeme.cz)



E-MAIL

[info@plujeme.cz](mailto:info@plujeme.cz)



PHONE

+420 720 755 085



MOBILE

+420 777 170 276



PLUJEME RÁDI S.R.O.

Dlouhá 730/35, 11000 Praha 1 – Staré Město, Czech Republic

## PRICE AND AVAILABILITY

05.12. - 12.12.2026

NOT AVAILABLE

12.12. - 19.12.2026

**10.450 €** 11.000 €

19.12. - 26.12.2026

NOT AVAILABLE

26.12. - 01.01.2027

NOT AVAILABLE



### WEBSITE

[www.plujeme.cz](http://www.plujeme.cz)



### E-MAIL

[info@plujeme.cz](mailto:info@plujeme.cz)



### PHONE

+420 720 755 085



### MOBILE

+420 777 170 276



### PLUJEME RÁDI S.R.O.

Dlouhá 730/35, 11000 Praha 1 – Staré Město, Czech Republic