

LAGOON 50

Sophia (2020)

Catamaran Lagoon 50 Sophia, built in 2020 is anchored in the Athens, Alimos marina, Athens area/Saronic/Peloponese, Greece. It has 6 + 1 cabins, can accommodate 12 + 1 people and has 5 toilets. Bed linen and kitchen equipment are included in the price.

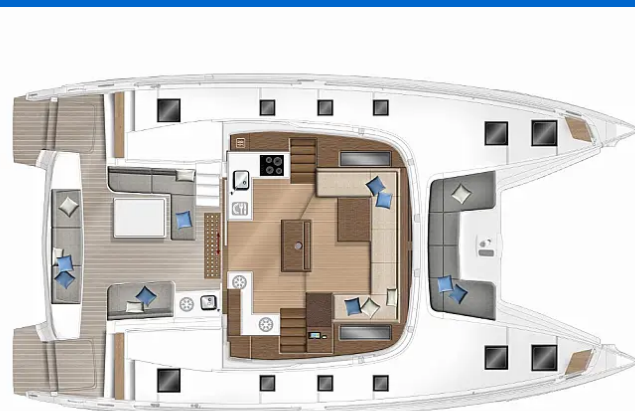

YACHT SPECIFICATIONS

Yacht Base

Athens, Alimos marina, Greece

Yacht ID

12970

Brands

Lagoon

Yacht name

Sophia

Production year

2020

Length

48 ft

Cabins

6 + 1

Berths

12 + 1

WC

5

Engine

2 x 2 HP

Fuel tank

1040 l



WEBSITE

www.plujeme.cz



PHONE

+420 720 755 085



MOBILE

+420 777 170 276



E-MAIL

info@plujeme.cz



PLUJEME RÁDI S.R.O.

Dlouhá 730/35, 11000 Praha 1 – Staré Město, Czech Republic

STANDARD YACHT EQUIPMENT

Deck	Bimini top, Teak deck
Galley	Coffee machine, Ice maker, Refrigerator
Navigation	Autopilot, Bow thruster
Sails	Electric winch
Yacht electrics	Air Conditioning, Generator, Inverter, Solar panels, Watermaker - desalinator



WEBSITE

www.plujeme.cz



E-MAIL

info@plujeme.cz



PHONE

+420 720 755 085



MOBILE

+420 777 170 276



PLUJEME RÁDI S.R.O.

Dlouhá 730/35, 11000 Praha 1 – Staré Město, Czech Republic

SERVICES

SELECTED SERVICES	OBLIGATORY	PAYMENT TYPE	PRICE
<p>Skipper (Payable at the base)</p> <p>Season: 2026. (Crew require their own cabin); Payable on the spot with cash Crew Cancellation Policy A Down payment of 25% is required upon confirmation, and the rest are payable on the spot with cash. Crew cancelled 4 weeks prior to embarkation will have 25% of total crew fee applicable. Crew cancelled less than 14 days prior to embarkation will have 100% of the total crew fee applicable. Damage waiver is obligatory for skippered charters.</p>	Yes	per day + food	210,00 €
<p>Starter pack (Payable at the base)</p> <p>Season: 2026. End cleaning, 1x Cooking gas, Water, Linen 1 set (2 sheets, 1 pillow case, 1 bath towel, 1 face towel) per person, Harbour fees for the first & last night. * If there is pet on board, then double cleaning will be applied.; Payable on the spot with cash 🎁 bag with Greek Local Products is offered to all of our charters as a welcome gift.</p>	Yes	per booking	500,00 €
<p>Cook (Payable at the base)</p> <p>Season: 2026. (Crew require their own cabin); Only responsible for daily cooking / provisioning and cleaning relevant to kitchen area; Payable on the spot with cash; Crew Cancellation Policy A Down payment of 25% is required upon confirmation, and the rest are payable on the spot with cash. Crew cancelled 4 weeks prior to embarkation will have 25% of total crew fee applicable. Crew cancelled less than 14 days prior to embarkation will have 100% of the total crew fee applicable.</p>	No	per day + food	200,00 €
<p>Crew change (Payable at the base)</p> <p>Season: 2026. Payable on the spot with cash Applicable only at one of our bases: Included : Formalities (contract, crew list, etc.) and one day of mooring fees. Not included: Yachts cleaning and laundry.</p>	No	per booking	150,00 €
<p>Early boarding/check-in (Payable at the base)</p> <p>Season: 2026. Access to the yacht by 14:00 In the event of delay beyond our control refunds will be made.; Payable on the spot with cash</p>	No	per booking	200,00 €

Hostess (Payable at the base)	No	per day + food	190,00 €
Season: 2026. *crew require their own cabin; Payable on the spot with cash Crew Cancellation Policy A Down payment of 25% is required upon confirmation, and the rest are payable on the spot with cash. Crew cancelled 4 weeks prior to embarkation will have 25% of total crew fee applicable. Crew cancelled less than 14 days prior to embarkation will have 100% of the total crew fee applicable.			
Internet pack (Payable at the base)	No	per booking	70,00 €
Season: 2026. +20 € per week after the 1st (WiFi hotspot for up to 5 devices and unlimited usage of internet); Payable on the spot with cash			
Linen Pack (Payable at the base)	No	per set	10,00 €
Season: 2026. 1 Extra set of linen (2 sheets, 1 pillow case, 1 bath towel, 1 face towel); Payable on the spot with cash			
Non refundable deposit/ insurance (Payable at the base)	No	per booking	400,00 €
Season: 2026. + refundable deposit 1000 EUR; non refundable payable on spot in cash and refundable payable by credit card on spot * Non-Refundable Deposit is mandatory on all skippered charters.			



WEBSITE
www.plujeme.cz



PHONE
+420 720 755 085



MOBILE
+420 777 170 276



E-MAIL
info@plujeme.cz



PLUJEME RÁDI S.R.O.
Dlouhá 730/35, 11000 Praha 1 – Staré Město, Czech Republic

ADDITIONAL EXTRAS

EXTRA	OBLIGATORY	PAYMENT TYPE	PRICE
Automatic Inflatable Life Jacket (Payable at the base) Season: 2026. Payable on the spot with cash - Payable at the base	No	per piece	30,00 €
Beach towel (Payable at the base) Season: 2026. Payable on the spot with cash - Payable at the base	No	per piece	5,00 €
Bed linen (Payable at the base) Season: 2026. Payable on the spot with cash - Payable at the base	No	per set	10,00 €
Blister (Payable at the base) Season: 2026. + additional security deposit 500EUR; Payable on the spot with cash - Payable at the base	No	per week	200,00 €
Grill/Barbecue/Plancha (Payable at the base) Season: 2026. Gas - Payable at the base	No	per week	100,00 €
Kayak (Payable at the base) Season: 2026. Payable on the spot with cash - Payable at the base	No	per week	130,00 €
Life jacket (children) (Payable at the base) Season: 2026. for children under 25 kg, one included in every yacht free of charge; Payable on the spot with cash - Payable at the base	No	per week/ person	20,00 €
Railing net (Safety net) (Payable at the base) Season: 2026. 200 € for yachts up to 46 ft., 300 € per week for yachts above 46ft & catamarans (Half price if the railing net is supplied uninstalled). Payable on the spot with cash - Payable at the base	No	per week	300,00 €
SEA-DOO underwater scooter (Payable at the base) Season: 2026. Payable on the spot with cash - Payable at the base	No	per week	150,00 €
Snorkeling equipment (Payable at the base) Season: 2026. The set contains mask, inhalator and flippers; Payable on the spot with cash - Payable at the base	No	per week/ person	10,00 €
Stand up paddle (SUP) (Payable at the base) Season: 2026. Payable on the spot with cash - Payable at the base	No	per week	130,00 €

Season: 2026. Payable on the spot with cash - Payable at the base



WEBSITE

www.plujeme.cz



PHONE

+420 720 755 085



MOBILE

+420 777 170 276



E-MAIL

info@plujeme.cz



PLUJEME RÁDI S.R.O.

Dlouhá 730/35, 11000 Praha 1 - Staré Město, Czech Republic

PRICE AND AVAILABILITY

25.04. - 09.05.2026 NOT AVAILABLE	09.05. - 23.05.2026 NOT AVAILABLE	23.05. - 30.05.2026 12.935 € 14.200 €	30.05. - 06.06.2026 NOT AVAILABLE
06.06. - 13.06.2026 12.935 € 14.200 €	13.06. - 20.06.2026 NOT AVAILABLE	20.06. - 04.07.2026 NOT AVAILABLE	04.07. - 11.07.2026 15.260 € 15.900 €
11.07. - 18.07.2026 NOT AVAILABLE	18.07. - 25.07.2026 NOT AVAILABLE	25.07. - 08.08.2026 NOT AVAILABLE	08.08. - 22.08.2026 NOT AVAILABLE
22.08. - 29.08.2026 15.400 € 15.900 €	29.08. - 05.09.2026 NOT AVAILABLE	05.09. - 26.09.2026 NOT AVAILABLE	26.09. - 03.10.2026 10.465 € 11.100 €
03.10. - 10.10.2026 9.500 €	10.10. - 17.10.2026 9.500 €	17.10. - 24.10.2026 9.500 €	24.10. - 31.10.2026 9.500 €
31.10. - 07.11.2026 9.500 €	07.11. - 14.11.2026 9.500 €	14.11. - 21.11.2026 9.500 €	21.11. - 28.11.2026 9.500 €
28.11. - 03.04.2027 NOT AVAILABLE			



WEBSITE
www.plujeme.cz



E-MAIL
info@plujeme.cz



PHONE
+420 720 755 085



MOBILE
+420 777 170 276



PLUJEME RÁDI S.R.O.
Dlouhá 730/35, 11000 Praha 1 – Staré Město, Czech Republic