

# LAGOON 46 OW

Lodire (2026)

Catamaran Lagoon 46 OW Lodire, built in 2026 is anchored in the Athens, Alimos marina, Athens area/Saronic/Peloponese, Greece. It has **3 + 2 cabins**, can accommodate **6 + 2 people** and has **3 toilets**. Bed linen and kitchen equipment are included in the price.

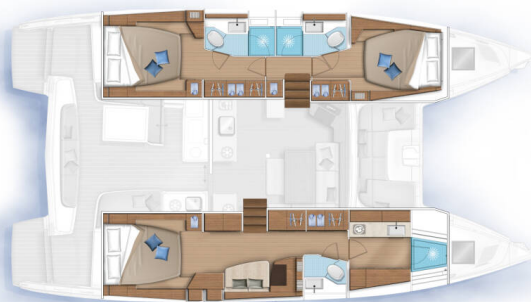

## YACHT SPECIFICATIONS

Yacht Base

**Athens, Alimos marina, Greece**

Yacht ID

**12945**

Brands

**Lagoon**

Yacht name

**Lodire**

Production year

**2026**

Length

**46 ft**

Cabins

**3 + 2**

Berths

**6 + 2**

WC

**3**

Engine

**2 x 57 HP**

Fuel tank

**01**



**WEBSITE**

[www.plujeme.cz](http://www.plujeme.cz)



**PHONE**

+420 720 755 085



**MOBILE**

+420 777 170 276



**E-MAIL**

[info@plujeme.cz](mailto:info@plujeme.cz)



**PLUJEME RÁDI S.R.O.**

Dlouhá 730/35, 11000 Praha 1 – Staré Město, Czech Republic

## STANDARD YACHT EQUIPMENT

|                 |  |
|-----------------|--|
| Comfort         | <b>Cockpit cushions, Sun loungers</b>  |
| Deck            | <b>Cockpit fridge, Cockpit table, Cockpit/stern, outside shower, Dinghy, Electric anchor windlass, Fenders, Hard Top Bimini, Mooring ropes, Outboard engine, Sink in cockpit</b> |
| Entertainment   | <b>Bose Sound System, Underwater lights</b>  |
| Galley          | <b>Freezer, Oven, Refrigerator, Stove</b>  |
| Interior        | <b>Electric fans, Electric toilet</b>  |
| Navigation      | <b>AIS, Autopilot, Compass, Depthsounder, GPS chart plotter, Log, Navigation/position Lights, Radar, Wind instrument/Anemometer</b>  |
| Safety          | <b>VHF radio</b>   |
| Yacht electrics | <b>Air Conditioning, Bilge pump - Electric, Generator, Inverter, Watermaker - desalinator</b>  |



#### WEBSITE

[www.plujeme.cz](http://www.plujeme.cz)



#### E-MAIL

[info@plujeme.cz](mailto:info@plujeme.cz)



#### PHONE

+420 720 755 085



#### MOBILE

+420 777 170 276



#### PLUJEME RÁDI S.R.O.

Dlouhá 730/35, 11000 Praha 1 – Staré Město, Czech Republic

## SERVICES

| SELECTED SERVICES   | OBLIGATORY | PAYMENT TYPE    | PRICE           |
|---|------------|-----------------|-----------------|
| <b>Comfort pack</b> (Payable at the base)<br><b>Season: 2026.</b> Includes: End cleaning + Bed linen/Bath & Beach towels + Beds made + Wi-Fi + First & final night at pier + Outboard + Petrol for outboard + Gas bottle & 1 spare            | Yes        | per booking     | <b>450,00 €</b> |
| <b>Damage waiver</b> (Payable now)<br><b>Season: 2026.</b>  | Yes        | per booking     | <b>550,00 €</b> |
| <b>Skipper</b> (Payable at the base)<br><b>Season: 2026.</b> Provisions must be onboard for the crew otherwise the amount for their meals is Euro 30/day/person   | Yes        | per day + food  | <b>210,00 €</b> |
| <b>Cook</b> (Payable at the base)<br><b>Season: 2026.</b> Provisions must be onboard for the crew otherwise the amount for their meals is Euro 30/day/person  | No         | per day + food  | <b>210,00 €</b> |
| <b>Crew change</b> (Payable at the base)<br><b>Season: 2026.</b> Price includes: administration cost, paperwork and legal formalities, change of linen / towels, 1 day marina fees in Puresailing bases. The price does NOT include cleaning. | No         | per crew change | <b>200,00 €</b> |
| <b>Early Check in</b> (Payable at the base)<br><b>Season: 2026.</b> Early Boarding at 14:00h (starting time of boat delivery/skipper check-in); Upon request & Subject to no damages from previous charter                                    | No         | per booking     | <b>230,00 €</b> |
| <b>Hostess</b> (Payable at the base)<br><b>Season: 2026.</b> Provisions must be onboard for the crew otherwise the amount for their meals is Euro 30/day/person   | No         | per day + food  | <b>190,00 €</b> |
| <b>Pet on board</b> (Payable at the base)<br><b>Season: 2026.</b>   | No         | per booking     | <b>200,00 €</b> |
| <b>Skipper</b> (Payable at the base)<br><b>Season: 2026.</b> Provisions must be onboard for the crew otherwise the amount for their meals is Euro 30/day/person   | No         | per day + food  | <b>210,00 €</b> |
| <b>Sport Package</b> (Payable at the base)<br><b>Season: 2026.</b> Includes Seas Scooters, 2x SUP and water toys  | No         | per booking     | <b>200,00 €</b> |

**Wireless Internet Router** (Payable at the base)

No

per week

**60,00 €**

**Season: 2026.** Min.10GB data allowance



**WEBSITE**

[www.plujeme.cz](http://www.plujeme.cz)



**E-MAIL**

[info@plujeme.cz](mailto:info@plujeme.cz)



**PHONE**

+420 720 755 085



**MOBILE**

+420 777 170 276



**PLUJEME RÁDI S.R.O.**

Dlouhá 730/35, 11000 Praha 1 – Staré Město, Czech Republic

## ADDITIONAL EXTRAS

| EXTRA   | OBLIGATORY | PAYMENT TYPE     | PRICE           |
|---|------------|------------------|-----------------|
| <b>Extra beach towels</b> (Payable at the base)<br><b>Season: 2026.</b> Payable at the base   | No         | per booking      | <b>10,00 €</b>  |
| <b>Extra bedlinen</b> (Payable at the base)<br><b>Season: 2026.</b> Payable at the base   | No         | per person       | <b>15,00 €</b>  |
| <b>Inflatable lifejacket</b> (Payable at the base)<br><b>Season: 2026.</b> Payable at the base  | No         | per week/ person | <b>30,00 €</b>  |
| <b>Kayak</b> (Payable at the base)<br><b>Season: 2026.</b> Inflatable kayak - security deposit of 200 euros is payable -<br>Payable at the base                   | No         | per week         | <b>200,00 €</b> |
| <b>Railing net (Safety net)</b> (Payable at the base)<br><b>Season: 2026.</b> Installed - Payable at the base   | No         | per booking      | <b>250,00 €</b> |
| <b>Sea Scooter</b> (Payable at the base)<br><b>Season: 2026.</b> Infinity Sea Scooter - security deposit of 200 euros is<br>payable - Payable at the base         | No         | per week         | <b>200,00 €</b> |
| <b>Stand up paddle (SUP)</b> (Payable at the base)<br><b>Season: 2026.</b> SUPs are subject to availability and bookable only in advance<br>- Payable at the base | No         | per week         | <b>120,00 €</b> |



**WEBSITE**  
www.plujeme.cz



**PHONE**  
+420 720 755 085



**MOBILE**  
+420 777 170 276



**E-MAIL**  
info@plujeme.cz



**PLUJEME RÁDI S.R.O.**  
Dlouhá 730/35, 11000 Praha 1 - Staré Město, Czech Republic

## PRICE AND AVAILABILITY

|  |  |   |  |
|--|--|---|--|
| 02.05. - 09.05.2026<br>5.250 € 7.000 €   | 09.05. - 16.05.2026<br>NOT AVAILABLE     | 16.05. - 23.05.2026<br>5.250 € 7.000 €  | 23.05. - 30.05.2026<br>NOT AVAILABLE     |
| 30.05. - 06.06.2026<br>7.520 € 9.400 €   | 06.06. - 13.06.2026<br>NOT AVAILABLE     | 13.06. - 20.06.2026<br>NOT AVAILABLE    | 20.06. - 27.06.2026<br>10.080 € 12.000 € |
| 27.06. - 04.07.2026<br>10.080 € 12.000 € | 04.07. - 18.07.2026<br>NOT AVAILABLE     | 18.07. - 01.08.2026<br>NOT AVAILABLE    | 01.08. - 08.08.2026<br>11.050 € 13.000 € |
| 08.08. - 15.08.2026<br>11.050 € 13.000 € | 15.08. - 22.08.2026<br>11.050 € 13.000 € | 22.08. - 29.08.2026<br>9.775 € 11.500 € | 29.08. - 05.09.2026<br>9.775 € 11.500 €  |
| 05.09. - 12.09.2026<br>9.775 € 11.500 €  | 12.09. - 19.09.2026<br>9.775 € 11.500 €  | 19.09. - 26.09.2026<br>8.075 € 9.500 €  | 26.09. - 03.10.2026<br>8.075 € 9.500 €   |
| 03.10. - 10.10.2026<br>6.300 € 7.000 €   | 10.10. - 17.10.2026<br>6.300 € 7.000 €   | 17.10. - 24.10.2026<br>3.870 € 4.300 €  | 24.10. - 31.10.2026<br>3.870 € 4.300 €   |
| 31.10. - 07.11.2026<br>3.870 € 4.300 €   | 07.11. - 14.11.2026<br>3.870 € 4.300 €   | 14.11. - 21.11.2026<br>3.870 € 4.300 €  | 21.11. - 28.11.2026<br>3.870 € 4.300 €   |
| 28.11. - 05.12.2026<br>3.870 € 4.300 €   |  |   |  |



WEBSITE

[www.plujeme.cz](http://www.plujeme.cz)



E-MAIL

[info@plujeme.cz](mailto:info@plujeme.cz)



PHONE

+420 720 755 085



MOBILE

+420 777 170 276



PLUJEME RÁDI S.R.O.

Dlouhá 730/35, 11000 Praha 1 – Staré Město, Czech Republic

## PRICE AND AVAILABILITY

05.12. - 12.12.2026

**3.870 €** 4.300 €

12.12. - 19.12.2026

**3.870 €** 4.300 €

19.12. - 26.12.2026

**3.870 €** 4.300 €



### WEBSITE

[www.plujeme.cz](http://www.plujeme.cz)



### E-MAIL

[info@plujeme.cz](mailto:info@plujeme.cz)



### PHONE

+420 720 755 085



### MOBILE

+420 777 170 276



### PLUJEME RÁDI S.R.O.

Dlouhá 730/35, 11000 Praha 1 – Staré Město, Czech Republic