

DUFOUR 41

Tamata (2026)

Sailing yacht Dufour 41 Tamata, built in 2026 is anchored in the Piombino - Marina Arcipelago Toscano, Tuscany, Italy. It has 3 cabins, can accommodate 6 + 2 people and has 3 toilets. Bed linen and kitchen equipment are included in the price.

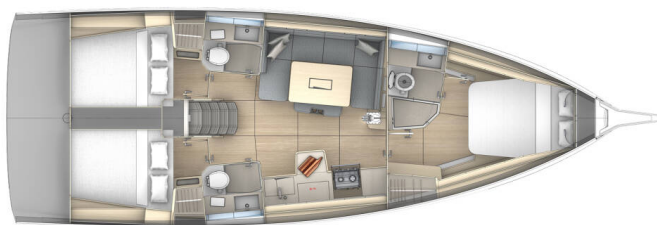

YACHT SPECIFICATIONS

Yacht Base

**Piombino - Marina Arcipelago
Toscana, Italy**

Yacht ID

12927

Brands

Dufour

Yacht name

Tamata

Production year

2026

Length

42 ft

Cabins

3

Berths

6 + 2

Max Persons

8

WC

3

Engine

1 x 0 HP

Fuel tank

0 l



WEBSITE

www.plujeme.cz



PHONE

+420 720 755 085



MOBILE

+420 777 170 276



E-MAIL

info@plujeme.cz



PLUJEME RÁDI S.R.O.

Dlouhá 730/35, 11000 Praha 1 - Staré Město, Czech Republic

STANDARD YACHT EQUIPMENT

Comfort	Cockpit cushions
Deck	Bathing platform, Bimini top, Cockpit grill, Cockpit/stern, outside shower, Electric anchor windlass, Sink in cockpit, Sprayhood, Tender
Entertainment	Radio
Galley	Hot water
Interior	Electric fans in cabins, Electric toilet
Navigation	Autopilot, Bow thruster, Echosounder/Depthsounder, GPS chart plotter, GPS chart plotter - cockpit, Log, Speedometer (Speed log), Wind instrument/Anemometer
Safety	VHF radio
Sails	Lazy bag, Lazy jacks
Yacht electrics	Battery charger, Inverter, Solar panels, Watermaker - desalinator



WEBSITE

www.plujeme.cz



PHONE

+420 720 755 085



MOBILE

+420 777 170 276



E-MAIL

info@plujeme.cz



PLUJEME RÁDI S.R.O.

Dlouhá 730/35, 11000 Praha 1 – Staré Město, Czech Republic

SERVICES

SELECTED SERVICES	OBLIGATORY	PAYMENT TYPE	PRICE
Service Pack (Payable now) Season: 2026. Final cleaning - Gas bottle - Bed-linen 1 set/person, 2 set snorkeling equipment: price as in the offer, mandatory, to be paid with the booking (30% at reservation and 70% 30 days before embarkation time)	Yes	per booking	260,00 €
Welcome package (Payable at the base) Season: 2026. Welcome pack with eco-friendly products - included in price	Yes	per booking	0,00 €
Deposit insurance (Payable now) Season: 2026. reduce deposit to 400 €	No	per booking	240,00 €
Extra cleaning - pets (Payable now) Season: 2026.	No	per booking	80,00 €
Made beds (Payable at the base) Season: 2026. to be requested two weeks in advance	No	per cabin	15,00 €
WI-FI Internet connection on boat (Payable now) Season: 2026.	No	per week	30,00 €

**WEBSITE**www.plujeme.cz**E-MAIL**info@plujeme.cz**PHONE**

+420 720 755 085

**MOBILE**

+420 777 170 276

**PLUJEME RÁDI S.R.O.**

Dlouhá 730/35, 11000 Praha 1 – Staré Město, Czech Republic

ADDITIONAL EXTRAS

EXTRA	OBLIGATORY	PAYMENT TYPE	PRICE
Outboard engine <i>(Payable now)</i> Season: 2026. 50€ additional week - Payable now	No	per week	100,00 €
Sea Scooter <i>(Payable now)</i> Season: 2026. Payable now	No	per week	180,00 €
Stand up paddle (SUP) <i>(Payable now)</i> Season: 2026. Payable now	No	per week	110,00 €
Towels <i>(Payable now)</i> Season: 2026. Payable now	No	per person	10,00 €



WEBSITE

www.plujeme.cz



E-MAIL

info@plujeme.cz



PHONE

+420 720 755 085



MOBILE

+420 777 170 276



PLUJEME RÁDI S.R.O.

Dlouhá 730/35, 11000 Praha 1 – Staré Město, Czech Republic

PRICE AND AVAILABILITY

13.06. - 20.06.2026 NOT AVAILABLE	20.06. - 04.07.2026 NOT AVAILABLE	04.07. - 11.07.2026 NOT AVAILABLE	11.07. - 18.07.2026 NOT AVAILABLE
18.07. - 25.07.2026 NOT AVAILABLE	25.07. - 01.08.2026 NOT AVAILABLE	01.08. - 08.08.2026 NOT AVAILABLE	08.08. - 29.08.2026 NOT AVAILABLE
29.08. - 05.09.2026 NOT AVAILABLE	05.09. - 19.09.2026 NOT AVAILABLE	19.09. - 26.09.2026 NOT AVAILABLE	26.09. - 03.10.2026 NOT AVAILABLE
03.10. - 10.10.2026 3.340 €	10.10. - 17.10.2026 NOT AVAILABLE	17.10. - 24.10.2026 3.070 €	24.10. - 31.10.2026 3.070 €
31.10. - 07.11.2026 3.070 €	07.11. - 14.11.2026 3.070 €	14.11. - 21.11.2026 3.070 €	21.11. - 28.11.2026 3.070 €
28.11. - 05.12.2026 3.070 €	05.12. - 12.12.2026 3.070 €	12.12. - 19.12.2026 3.070 €	19.12. - 26.12.2026 3.070 €



WEBSITE

www.plujeme.cz



E-MAIL

info@plujeme.cz



PHONE

+420 720 755 085



MOBILE

+420 777 170 276



PLUJEME RÁDI S.R.O.

Dlouhá 730/35, 11000 Praha 1 – Staré Město, Czech Republic