

# OCEANIS 51.1

Shine (2019)

Sailing yacht Oceanis 51.1 Shine, built in 2019 is anchored in the **Corfu, Gouvia Marina, Ionian Islands, Greece**. It has **6 cabins**, can accommodate **11 + 1 people** and has **4 toilets**. Bed linen and kitchen equipment are included in the price.

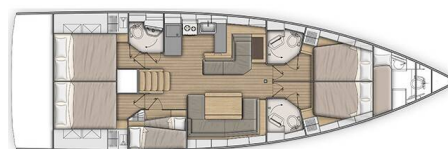

## YACHT SPECIFICATIONS

Yacht Base

**Corfu, Gouvia Marina, Greece**

Yacht ID

**1292**

Brands

**Beneteau**

Yacht name

**Shine**

Production year

**2019**

Length

**52 ft**

Cabins

**6**

Berths

**11 + 1**

Max Persons

**12**

WC

**4**

Engine

**1 x 110 HP**

Fuel tank

**200 l**



**WEBSITE**

[www.plujeme.cz](http://www.plujeme.cz)



**PHONE**

+420 720 755 085



**MOBILE**

+420 777 170 276



**E-MAIL**

[info@plujeme.cz](mailto:info@plujeme.cz)



**PLUJEME RÁDI S.R.O.**

Dlouhá 730/35, 11000 Praha 1 – Staré Město, Czech Republic

## STANDARD YACHT EQUIPMENT

Comfort	<b>Cockpit cushions, Cockpit seat cushions with backrest</b>
Deck	<b>Bathing platform, Bimini top, Black ball, Cockpit light, Cockpit table, Cockpit/stern, outside shower, Dinghy, Electric anchor windlass, Fenders, Gangway, Sprayhood</b>
Entertainment	<b>CD/MP3, USB, AUX input, Outdoor speakers, Radio CD player</b>
Galley	<b>Additional gas bottle, Hot water, Refrigerator</b>
Interior	<b>Clock, Electric fans in cabins, Electric toilet</b>
Navigation	<b>AIS, Autopilot, Binoculars, Bow thruster, Electronic sea charts, GPS chart plotter, GPS chart plotter - cockpit, LED Navigation lights, Wind instrument/Anemometer</b>
Safety	<b>Black Water Tank</b>
Sails	<b>Electric winch</b>
Yacht electrics	<b>220V socket, Ac 230V cable, Battery charger, Bilge pump - Electric, Shore power cable, Solar panels</b>



#### WEBSITE

[www.plujeme.cz](http://www.plujeme.cz)



#### E-MAIL

[info@plujeme.cz](mailto:info@plujeme.cz)



#### PHONE

+420 720 755 085



#### MOBILE

+420 777 170 276



#### PLUJEME RÁDI S.R.O.

Dlouhá 730/35, 11000 Praha 1 – Staré Město, Czech Republic

## SERVICES

SELECTED SERVICES	OBLIGATORY	PAYMENT TYPE	PRICE
<b>Charter pack</b> (Payable at the base) <b>Season: 2026.</b> includes End Cleaning, Bed Linen & Towels, 1 Gas Bottle, batteries, Water	Yes	per booking	<b>300,00 €</b>
<b>Crew list change</b> (Payable at the base) <b>Season: 2026.</b> Crew change includes administration fee and new crew list to the port authority	No	per crew change	<b>50,00 €</b>
<b>Damage waiver</b> (Payable at the base) <b>Season: 2026.</b> non refundable, + 700,00EUR refundable, Damage waiver is obligatory on Skippered charters. Payable on spot in cash. Minimum charge is 7 days.	No	per booking	<b>400,00 €</b>
<b>Early boarding/check-in</b> (Payable at the base) <b>Season: 2026.</b> Check in until 13:00 - (must be reconfirmed and depends on if yacht needs repair from charter before)	No	per booking	<b>170,00 €</b>
<b>Harbour and marine fee</b> (Payable at the base) <b>Season: 2026.</b> On our base in Marina Gouvia free of charge	No	per booking	<b>0,00 €</b>
<b>Hostess</b> (Payable at the base) <b>Season: 2026.</b> Paid on spot in cash. Food provided by clients or to be paid an extra 30€/day, Hostess must have his own cabin.	No	per day + food	<b>180,00 €</b>
<b>Late Check in</b> (Payable at the base) <b>Season: 2026.</b> On Sunday	No	per booking	<b>100,00 €</b>
<b>One way fee</b> (Payable at the base) <b>Season: 2026.</b> Corfu - Lefkas; Lefkas - Corfu	No	one-way	<b>500,00 €</b>
<b>Provisioning</b> (Payable at the base) <b>Season: 2026.</b> order form will be forwarded upon request. Please fill it in and email it back to us, at least 7 days before embarkation. Upon your arrival your food and drinks will be onboard	No	per service	<b>30,00 €</b>
<b>Skipper</b> (Payable at the base) <b>Season: 2026.</b> Paid on spot in cash. Food provided by clients or to be paid an extra 30€/day. Skipper must have his own cabin and access to one of the toilets. Damage waiver is obligatory on skippered charters.	No	per day + food	<b>190,00 €</b>

**Transfer** (Payable at the base)

No

per booking

**0,00 €**

**Season: 2026.** upon request 7 days before the starting day

**WI-FI Internet connection on boat** (Payable at the base)

No

per week

**50,00 €**

**Season: 2026.** 5GB, up to 10 connections (deposit €100)



**WEBSITE**

[www.plujeme.cz](http://www.plujeme.cz)



**E-MAIL**

[info@plujeme.cz](mailto:info@plujeme.cz)



**PHONE**

+420 720 755 085



**MOBILE**

+420 777 170 276



**PLUJEME RÁDI S.R.O.**

Dlouhá 730/35, 11000 Praha 1 – Staré Město, Czech Republic

## ADDITIONAL EXTRAS

EXTRA	OBLIGATORY	PAYMENT TYPE	PRICE
<b>Automatic Inflatable Life Jacket</b> (Payable at the base) <i>Season: 2026. Payable at the base</i>	No	per person	<b>0,00 €</b>
<b>Blister</b> (Payable at the base) <i>Season: 2026. + extra security deposit 500 EUR (refundable) - Payable at the base</i>	No	per week	<b>250,00 €</b>
<b>Extra bedlinen</b> (Payable at the base) <i>Season: 2026. Payable at the base</i>	No	per set	<b>15,00 €</b>
<b>Outboard engine</b> (Payable at the base) <i>Season: 2026. Included - Payable at the base</i>	No	per week	<b>0,00 €</b>
<b>Railing net (Safety net)</b> (Payable at the base) <i>Season: 2026. installed - Payable at the base</i>	No	per booking	<b>250,00 €</b>
<b>Stand up paddle (SUP)</b> (Payable at the base) <i>Season: 2026. Payable at the base</i>	No	per week	<b>130,00 €</b>

**WEBSITE**[www.plujeme.cz](http://www.plujeme.cz)**E-MAIL**[info@plujeme.cz](mailto:info@plujeme.cz)**PHONE**

+420 720 755 085

**MOBILE**

+420 777 170 276

**PLUJEME RÁDI S.R.O.**

Dlouhá 730/35, 11000 Praha 1 – Staré Město, Czech Republic

## PRICE AND AVAILABILITY

25.04. - 02.05.2026 <b>2.615 €</b> 4.470 €	02.05. - 09.05.2026 <b>2.615 €</b> 4.470 €	09.05. - 16.05.2026 NOT AVAILABLE	16.05. - 23.05.2026 <b>2.615 €</b> 4.470 €
23.05. - 30.05.2026 <b>4.443 €</b> 6.020 €	30.05. - 06.06.2026 <b>4.443 €</b> 6.020 €	06.06. - 13.06.2026 NOT AVAILABLE	13.06. - 20.06.2026 <b>4.443 €</b> 6.020 €
20.06. - 27.06.2026 NOT AVAILABLE	27.06. - 04.07.2026 NOT AVAILABLE	04.07. - 11.07.2026 <b>5.103 €</b> 6.670 €	11.07. - 18.07.2026 <b>5.103 €</b> 6.670 €
18.07. - 25.07.2026 <b>5.103 €</b> 6.670 €	25.07. - 01.08.2026 <b>5.103 €</b> 6.670 €	01.08. - 08.08.2026 <b>5.768 €</b> 7.540 €	08.08. - 15.08.2026 <b>5.768 €</b> 7.540 €
15.08. - 22.08.2026 <b>5.768 €</b> 7.540 €	22.08. - 29.08.2026 <b>5.103 €</b> 6.670 €	29.08. - 05.09.2026 NOT AVAILABLE	05.09. - 19.09.2026 NOT AVAILABLE
19.09. - 26.09.2026 NOT AVAILABLE	26.09. - 03.10.2026 NOT AVAILABLE	03.10. - 10.10.2026 <b>3.672 €</b> 4.320 €	10.10. - 17.10.2026 NOT AVAILABLE
17.10. - 24.10.2026 <b>3.069 €</b> 3.610 €	24.10. - 31.10.2026 <b>3.069 €</b> 3.610 €	31.10. - 07.11.2026 <b>3.069 €</b> 3.610 €	07.11. - 14.11.2026 <b>3.069 €</b> 3.610 €
14.11. - 21.11.2026 <b>3.069 €</b> 3.610 €	21.11. - 28.11.2026 <b>3.069 €</b> 3.610 €	28.11. - 05.12.2026 <b>3.069 €</b> 3.610 €	



WEBSITE

[www.plujeme.cz](http://www.plujeme.cz)



E-MAIL

[info@plujeme.cz](mailto:info@plujeme.cz)



PHONE

+420 720 755 085



MOBILE

+420 777 170 276



PLUJEME RÁDI S.R.O.

Dlouhá 730/35, 11000 Praha 1 – Staré Město, Czech Republic

## PRICE AND AVAILABILITY

05.12. - 12.12.2026

3.610 €

12.12. - 19.12.2026

3.610 €

19.12. - 26.12.2026

3.610 €



### WEBSITE

[www.plujeme.cz](http://www.plujeme.cz)



### E-MAIL

[info@plujeme.cz](mailto:info@plujeme.cz)



### PHONE

+420 720 755 085



### MOBILE

+420 777 170 276



### PLUJEME RÁDI S.R.O.

Dlouhá 730/35, 11000 Praha 1 – Staré Město, Czech Republic