

# BALI 5.2

Lumière (2026)

Catamaran Bali 5.2 Lumière, built in 2026 is anchored in the Sukosan, D-Marin Dalmacija Marina, Zadar region, Croatia. It has 5 + 2 cabins, can accommodate 11 + 2 people and has 5 + 2 toilets. Bed linen and kitchen equipment are included in the price.

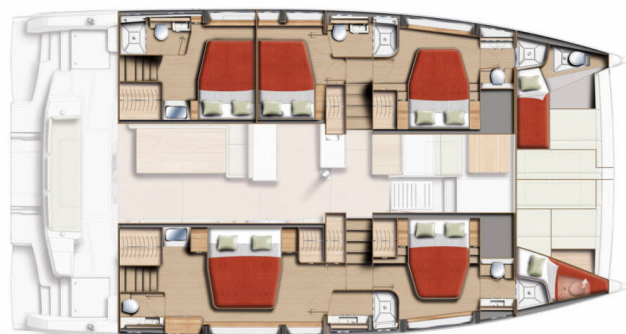

## YACHT SPECIFICATIONS

Yacht Base

**Sukosan, D-Marin Dalmacija Marina,  
Croatia**

Yacht ID

**12763**

Brands

**Catana**

Yacht name

**Lumière**

Production year

**2026**

Length

**52 ft**

Cabins

**5 + 2**

Berths

**11 + 2**

Max Persons

**12**

WC

**5 + 2**

Engine

**2 x 80 HP**

Fuel tank

**1200 l**



**WEBSITE**

[www.plujeme.cz](http://www.plujeme.cz)



**PHONE**

+420 720 755 085



**MOBILE**

+420 777 170 276



**E-MAIL**

[info@plujeme.cz](mailto:info@plujeme.cz)



**PLUJEME RÁDI S.R.O.**

Dlouhá 730/35, 11000 Praha 1 – Staré Město, Czech Republic

## STANDARD YACHT EQUIPMENT

Comfort	<b>Bed linen, Cockpit cushions, Sundeck cushions</b>
Deck	<b>Bimini top, Cockpit table, Cockpit/stern, outside shower, Flybridge, Forward cockpit, Fridge on flybridge, Grill/Barbecue/Plancha, Hard Top Bimini, Hydraulic lifting swimming platform, Sun awning (forward cockpit), Teak cockpit, Teak deck, Teak on flybridge</b>
Entertainment	<b>Outdoor speakers, Radio mp3 player, RIB, TV, Underwater lights</b>
Galley	<b>Coffee machine, Dishwasher, Freezer, Ice maker, Kitchen utensils (Galley equipment, cutlery), Microwave, Oven, Refrigerator, Stove, Wine cooler</b>
Interior	<b>Electric fans in cabins, Electric toilet, Safe</b>
Navigation	<b>Autopilot, Bow thruster, GPS chart plotter, Navigation (Nautical) charts and nautical guide, Pilot book, Tridata</b>
Safety	<b>VHF radio</b>
Sails	<b>Electric halyard winch, Self tacking jib</b>
Yacht electrics	<b>Air Conditioning, Battery charger, Generator, Heating, Inverter, Solar panels, Watermaker - desalinator</b>



**WEBSITE**

[www.plujeme.cz](http://www.plujeme.cz)



**PHONE**

+420 720 755 085



**MOBILE**

+420 777 170 276



**E-MAIL**

[info@plujeme.cz](mailto:info@plujeme.cz)



**PLUJEME RÁDI S.R.O.**

Dlouhá 730/35, 11000 Praha 1 – Staré Město, Czech Republic

## SERVICES

SELECTED SERVICES	OBLIGATORY	PAYMENT TYPE	PRICE
<b>Charter pack</b> (Payable at the base) <b>Season: 2026.</b> includes final cleaning, bedding, basic toiletries, bathroom towels, beach towels, RIB/dinghy + outboard engine, Wi-Fi 20GB, 2 x snorkeling	Yes	per booking	<b>680,00 €</b>
<b>Outboard engine</b> (Payable at the base) <b>Season: 2026.</b> Free of charge for bookings in May	Yes	per booking	<b>0,00 €</b>
<b>Comfort Pack</b> (Payable at the base) <b>Season: 2026.</b> includes outboard 2,5 HP, WiFi routers	No	per week	<b>105,00 €</b>
<b>Flexible booking</b> (Payable now) <b>Season: 2026.</b> allows you to cancel or rebook your charter up to 30 days before the embarkation for no specific reason. You can reschedule your holiday at no cost for unlimited number of times or use a credit note if you are uncertain of new charter dates. With our FLEX PLAN your rebooking costs are completely eliminated while cancellation costs with refund option are reduced to a minimum (15% of the charter fee, min 350 EUR). Extra bonus: free cancellation and FULL REFUND granted in case of closed state borders within 7 days before the embarkation. Notes: FLEX PLAN costs 7% of the final charter price, can be added to booking up to 72hr after booking confirmation and is not available for bookings confirmed within 30 days before the embarkation.	No	per booking	<b>0,00 €</b>
<b>Hostess</b> (Payable at the base) <b>Season: 2026.</b> + own cabin 50% cancellation fee in case of cancellation up to 15 days prior to embarkation 100% cancellation fee in case of cancellation within 14 days prior to embarkation	No	per day + food	<b>260,00 €</b>
<b>Late check out</b> (Payable at the base) <b>Season: 2026.</b> Saturdays till 10hr Late check-out can be confirmed only on Friday before the embarkation day.	No	per booking	<b>350,00 €</b>
<b>One way fee</b> (Payable at the base) <b>Season: 2026.</b> Suk - Ši / Ši - Suk On request only. One-way conditions: one way fee + skipper service obligatory for the whole booking period + mooring fee in port of disembarkation/embarkation	No	per booking	<b>250,00 €</b>

<b>One way fee</b> (Payable at the base)	No	per booking	<b>490,00 €</b>
<b>Season: 2026.</b> Suk - Kas / Kas - Suk On request only. One-way conditions: one way fee + skipper service obligatory for the whole booking period + mooring fee in port of disembarkation/embarkation; check-out on Friday until 12:00 in Kaštela			
<b>One way fee</b> (Payable at the base)	No	per booking	<b>490,00 €</b>
<b>Season: 2026.</b> Suk - Seg / Seg - Suk On request only. One-way conditions: one way fee + skipper service obligatory for the whole booking period + mooring fee in port of disembarkation/embarkation			
<b>Pet on board</b> (Payable at the base)	No	per booking	<b>150,00 €</b>
<b>Season: 2026.</b> Small or medium pet, up to 25 kg			
<b>Provisioning</b> (Payable now)	No	per booking	<b>0,00 €</b>
<b>Season: 2026.</b> upon request + price of groceries, to be done online			
<b>Skipper</b> (Payable now)	No	per day + food	<b>280,00 €</b>
<b>Season: 2026.</b> + own cabin 50% cancellation fee in case of cancellation up to 15 days prior to embarkation 100% cancellation fee in case of cancellation within 14 days prior to embarkation			



**WEBSITE**

[www.plujeme.cz](http://www.plujeme.cz)



**E-MAIL**

[info@plujeme.cz](mailto:info@plujeme.cz)



**PHONE**

+420 720 755 085



**MOBILE**

+420 777 170 276



**PLUJEME RÁDI S.R.O.**

Dlouhá 730/35, 11000 Praha 1 – Staré Město, Czech Republic

## ADDITIONAL EXTRAS

EXTRA	OBLIGATORY	PAYMENT TYPE	PRICE
<b>Beach towel</b> (Payable at the base) <b>Season: 2026.</b> Payable at the base	No	per piece	<b>8,00 €</b>
<b>eFoil</b> (Payable now) <b>Season: 2026.</b> Loft Foil / Awake Vinga Security deposit: 1000 EUR Cancellation policy: 50% cancellation fee in case of cancellation within 2 weeks prior to embarkation. Delivery fee – 310,00 EUR – Payable now	No	per week	<b>2.000,00 €</b>
<b>Extra bedlinen</b> (Payable at the base) <b>Season: 2026.</b> Payable at the base	No	per set	<b>15,00 €</b>
<b>Floating Water Hammock</b> (Payable at the base) <b>Season: 2026.</b> Partyzone – Payable at the base	No	per week	<b>220,00 €</b>
<b>JetBoard</b> (Payable now) <b>Season: 2026.</b> Awake Security deposit: 1000 EUR Cancellation policy: 50% cancellation fee in case of cancellation within 2 weeks prior to embarkation. Delivery fee – 310,00 EUR – Payable now	No	per week	<b>2.200,00 €</b>
<b>Railing net (Safety net)</b> (Payable at the base) <b>Season: 2026.</b> Rental without mounting – Payable at the base	No	per booking	<b>20,00 €</b>
<b>Seabob</b> (Payable now) <b>Season: 2026.</b> Seabob F5 Security deposit: 500 EUR Cancellation policy: 50% cancellation fee in case of cancellation within 2 weeks prior to embarkation. Delivery fee – 310,00 EUR – Payable now	No	per week	<b>1.000,00 €</b>
<b>Seabob</b> (Payable now) <b>Season: 2026.</b> Seabob F5S Security deposit: 500 EUR Cancellation policy: 50% cancellation fee in case of cancellation within 2 weeks prior to embarkation. Delivery fee – 310,00 EUR – Payable now	No	per week	<b>1.200,00 €</b>
<b>Seabob</b> (Payable now) <b>Season: 2026.</b> Seabob F9 Security deposit: 500 EUR Cancellation policy: 50% cancellation fee in case of cancellation within 2 weeks prior to embarkation. Delivery fee – 310,00 EUR – Payable now	No	per week	<b>1.300,00 €</b>

<b>Seabob</b> (Payable now)	No	per week	<b>1.500,00 €</b>
<b>Season: 2026.</b> Seabob F5SR Security deposit: 500 EUR Cancellation policy: 50% cancellation fee in case of cancellation within 2 weeks prior to embarkation. Delivery fee – 310,00 EUR – Payable now			
<b>Seabob</b> (Payable now)	No	per week	<b>1.500,00 €</b>
<b>Season: 2026.</b> Seabob F9S Security deposit: 500 EUR Cancellation policy: 50% cancellation fee in case of cancellation within 2 weeks prior to embarkation. Delivery fee – 310,00 EUR – Payable now			
<b>Snorkeling equipment</b> (Payable at the base)	No	per week	<b>10,00 €</b>
<b>Season: 2026.</b> Payable at the base			
<b>Stand up paddle (SUP)</b> (Payable at the base)	No	per week	<b>120,00 €</b>
<b>Season: 2026.</b> Payable at the base			
<b>Towels</b> (Payable at the base)	No	per set	<b>8,00 €</b>
<b>Season: 2026.</b> 2 psc/set (1 x 50x100cm + 1 x 70x140cm) – Payable at the base			
<b>Wi-Fi Internet</b> (Payable at the base)	No	per week	<b>25,00 €</b>
<b>Season: 2026.</b> Payable at the base			



**WEBSITE**

[www.plujeme.cz](http://www.plujeme.cz)



**PHONE**

+420 720 755 085



**MOBILE**

+420 777 170 276



**E-MAIL**

[info@plujeme.cz](mailto:info@plujeme.cz)



**PLUJEME RÁDI S.R.O.**

Dlouhá 730/35, 11000 Praha 1 – Staré Město, Czech Republic

## PRICE AND AVAILABILITY

16.05. - 23.05.2026 ON OPTION	23.05. - 30.05.2026 ON OPTION	30.05. - 06.06.2026 NOT AVAILABLE	06.06. - 13.06.2026 NOT AVAILABLE
13.06. - 20.06.2026 NOT AVAILABLE	20.06. - 04.07.2026 NOT AVAILABLE	04.07. - 11.07.2026 NOT AVAILABLE	11.07. - 25.07.2026 NOT AVAILABLE
25.07. - 01.08.2026 ON OPTION	01.08. - 08.08.2026 ON OPTION	08.08. - 15.08.2026 NOT AVAILABLE	15.08. - 22.08.2026 NOT AVAILABLE
22.08. - 29.08.2026 NOT AVAILABLE	29.08. - 05.09.2026 NOT AVAILABLE	05.09. - 12.09.2026 NOT AVAILABLE	12.09. - 19.09.2026 NOT AVAILABLE
19.09. - 26.09.2026 NOT AVAILABLE	26.09. - 03.10.2026 NOT AVAILABLE	03.10. - 10.10.2026 7.803 € 9.180 €	10.10. - 17.10.2026 7.803 € 9.180 €
17.10. - 24.10.2026 7.803 € 9.180 €	24.10. - 31.10.2026 7.803 € 9.180 €	31.10. - 07.11.2026 8.483 € 9.980 €	07.11. - 14.11.2026 8.483 € 9.980 €
14.11. - 21.11.2026 8.483 € 9.980 €	21.11. - 28.11.2026 8.483 € 9.980 €	28.11. - 05.12.2026 8.483 € 9.980 €	



WEBSITE

[www.plujeme.cz](http://www.plujeme.cz)



E-MAIL

[info@plujeme.cz](mailto:info@plujeme.cz)



PHONE

+420 720 755 085



MOBILE

+420 777 170 276



PLUJEME RÁDI S.R.O.

Dlouhá 730/35, 11000 Praha 1 – Staré Město, Czech Republic

## PRICE AND AVAILABILITY

05.12. - 12.12.2026

**8.483 €** 9.980 €

12.12. - 19.12.2026

**8.483 €** 9.980 €

19.12. - 26.12.2026

**8.483 €** 9.980 €



### WEBSITE

[www.plujeme.cz](http://www.plujeme.cz)



### E-MAIL

[info@plujeme.cz](mailto:info@plujeme.cz)



### PHONE

+420 720 755 085



### MOBILE

+420 777 170 276



### PLUJEME RÁDI S.R.O.

Dlouhá 730/35, 11000 Praha 1 – Staré Město, Czech Republic