

# BALI 4.1

Ginevra (2019)

**Catamaran Bali 4.1 Ginevra**, built in **2019** is anchored in the **Capo D'orlando Marina, Sicily, Italy**. It has **4 + 2 cabins**, can accommodate **8 + 2 people** and has **4 toilets**. Bed linen and kitchen equipment are included in the price.

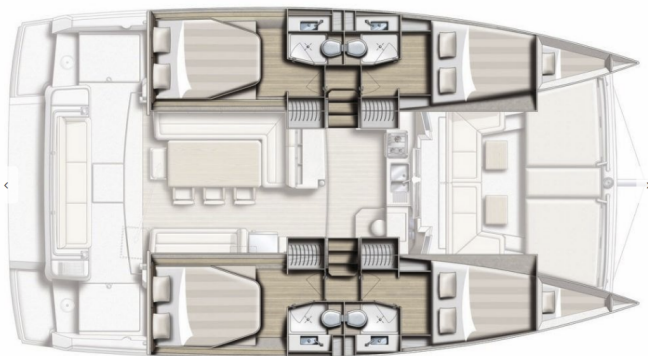

## YACHT SPECIFICATIONS

Yacht Base

**Capo D'orlando Marina, Italy**

Yacht ID

**12625**

Brands

**Catana**

Yacht name

**Ginevra**

Production year

**2019**

Length

**41 ft**

Cabins

**4 + 2**

Berths

**8 + 2**

WC

**4**

Engine

**2 x 57 HP**

Fuel tank

**400 l**



**WEBSITE**

[www.plujeme.cz](http://www.plujeme.cz)



**PHONE**

+420 720 755 085



**MOBILE**

+420 777 170 276



**E-MAIL**

[info@plujeme.cz](mailto:info@plujeme.cz)



**PLUJEME RÁDI S.R.O.**

Dlouhá 730/35, 11000 Praha 1 – Staré Město, Czech Republic

## STANDARD YACHT EQUIPMENT

Comfort	<b>Cockpit cushions</b>
Deck	<b>Bilge pump - Mechanic, Bimini top, Boat hook, Bosun's chair (Safe seat) (boatswain's chair), Cockpit table, Cockpit/stern, outside shower, Diesel filter, Dinghy, Electric anchor windlass, Fenders, Flybridge, Gangway, Impeller, Main Deck Compass, Oil filter, Spare anchor (Reserve, Auxiliary anchor), Sun awning (forward cockpit), Swimming ladder</b>
Entertainment	<b>Diving mask, Fins, Outdoor speakers, Radio mp3 player</b>
Galley	<b>Freezer, Gas cookers, Hot water, Ice box, Kitchen utensils (Galley equipment, cutlery), Oven, Refrigerator, Salt water in kitchen</b>
Interior	<b>Barometer, Bilge pump handle, Clock, Electric fans in cabins, Electric toilet</b>
Navigation	<b>Autopilot, Binoculars, GPS chart plotter, Hand bearing compass, Log, Navigation/position Lights, Pilot book, Radar reflector, Tridata, Wind instrument/Anemometer</b>
Safety	<b>Automatic Inflatable Life Jacket, Black Water Tank, Distress flare box, Emergency tiller, Fire blanket, Fire extinguisher, First aid kit, Fog horn, Horseshoe lifebuoy, Life belts (Safety harness), Life buoy + Flashing light, Life jacket (children), Lifelines, Liferaft, Set of tools, Torch, VHF radio</b>
Sails	<b>Electric winch</b>
Yacht electrics	<b>12V Socket, 220V socket, Battery charger, Bilge pump - Electric, Inverter, Shore power cable, Solar panels</b>



**WEBSITE**  
[www.plujeme.cz](http://www.plujeme.cz)



**PHONE**  
+420 720 755 085



**MOBILE**  
+420 777 170 276



**E-MAIL**  
[info@plujeme.cz](mailto:info@plujeme.cz)



**PLUJEME RÁDI S.R.O.**  
Dlouhá 730/35, 11000 Praha 1 - Staré Město, Czech Republic

## SERVICES

SELECTED SERVICES	OBLIGATORY	PAYMENT TYPE	PRICE
<b>Charter pack</b> (Payable at the base) <b>Season: 2026.</b> Includes end cleaning, outboard engine, bed linen & bath towels (1 shower towel + 1 face towel for each crew member), 1x cooking gas bottle, batteries for torch	Yes	per booking	<b>590,00 €</b>
<b>Damage waiver</b> (Payable at the base) <b>Season: 2026.</b> With a refundable Deposit of € 1000	No	per week	<b>600,00 €</b>
<b>Early Check in</b> (Payable at the base) <b>Season: 2026.</b> at 1:00 PM	No	per booking	<b>350,00 €</b>
<b>Hostess</b> (Payable at the base) <b>Season: 2026.</b>	No	per week + food	<b>1.300,00 €</b>
<b>Provisioning</b> (Payable at the base) <b>Season: 2026.</b> 10% for the service, calculated from the receipt of the supermarket	No	per service	<b>0,00 €</b>
<b>Skipper</b> (Payable at the base) <b>Season: 2026.</b>	No	per week + food	<b>1.600,00 €</b>
<b>Transfer</b> (Payable at the base) <b>Season: 2026.</b> from/to airports and/or hotels; price on request	No	per booking	<b>0,00 €</b>
<b>WI-FI Internet connection on boat</b> (Payable at the base) <b>Season: 2026.</b> Unlimited	No	per week	<b>60,00 €</b>



**WEBSITE**  
www.plujeme.cz



**PHONE**  
+420 720 755 085



**MOBILE**  
+420 777 170 276



**E-MAIL**  
info@plujeme.cz



**PLUJEME RÁDI S.R.O.**  
Dlouhá 730/35, 11000 Praha 1 – Staré Město, Czech Republic

## ADDITIONAL EXTRAS

EXTRA	OBLIGATORY	PAYMENT TYPE	PRICE
<b>Beach towel</b> (Payable at the base) <b>Season: 2026.</b> Payable at the base	No	per piece	<b>15,00 €</b>
<b>Extra bedlinen and towels</b> (Payable at the base) <b>Season: 2026.</b> Payable at the base	No	per person	<b>15,00 €</b>
<b>Gennaker</b> (Payable at the base) <b>Season: 2026.</b> Payable at the base	No	per week	<b>200,00 €</b>
<b>Grill/Barbecue/Plancha</b> (Payable at the base) <b>Season: 2026.</b> Including 1 gas cylinder; each additional € 15 - Payable at the base	No	per week	<b>120,00 €</b>
<b>Inflatable swimming platform</b> (Payable at the base) <b>Season: 2026.</b> With ladder - Payable at the base	No	per week	<b>100,00 €</b>
<b>Kayak</b> (Payable at the base) <b>Season: 2026.</b> 2 seats - Payable at the base	No	per week	<b>130,00 €</b>
<b>Railing net (Safety net)</b> (Payable at the base) <b>Season: 2026.</b> Payable at the base	No	per booking	<b>300,00 €</b>
<b>Snorkeling equipment</b> (Payable at the base) <b>Season: 2026.</b> Payable at the base	No	per week	<b>15,00 €</b>
<b>Stand up paddle (SUP)</b> (Payable at the base) <b>Season: 2026.</b> Payable at the base	No	per week	<b>130,00 €</b>



**WEBSITE**  
www.plujeme.cz



**PHONE**  
+420 720 755 085



**MOBILE**  
+420 777 170 276



**E-MAIL**  
info@plujeme.cz



**PLUJEME RÁDI S.R.O.**  
Dlouhá 730/35, 11000 Praha 1 – Staré Město, Czech Republic

## PRICE AND AVAILABILITY

25.04. - 02.05.2026 2.715 € 3.620 €	02.05. - 09.05.2026 2.715 € 3.620 €	09.05. - 16.05.2026 2.715 € 3.620 €	16.05. - 23.05.2026 2.715 € 3.620 €
23.05. - 30.05.2026 NOT AVAILABLE	30.05. - 06.06.2026 NOT AVAILABLE	06.06. - 13.06.2026 NOT AVAILABLE	13.06. - 20.06.2026 3.576 € 4.470 €
20.06. - 27.06.2026 NOT AVAILABLE	27.06. - 04.07.2026 NOT AVAILABLE	04.07. - 11.07.2026 NOT AVAILABLE	11.07. - 18.07.2026 4.656 € 5.820 €
18.07. - 25.07.2026 NOT AVAILABLE	25.07. - 01.08.2026 5.336 € 6.670 €	01.08. - 08.08.2026 NOT AVAILABLE	08.08. - 22.08.2026 NOT AVAILABLE
22.08. - 29.08.2026 NOT AVAILABLE	29.08. - 05.09.2026 NOT AVAILABLE	05.09. - 12.09.2026 NOT AVAILABLE	12.09. - 19.09.2026 NOT AVAILABLE
19.09. - 26.09.2026 NOT AVAILABLE	26.09. - 03.10.2026 NOT AVAILABLE	03.10. - 10.10.2026 NOT AVAILABLE	10.10. - 17.10.2026 2.715 € 3.620 €
17.10. - 24.10.2026 2.715 € 3.620 €	24.10. - 31.10.2026 2.715 € 3.620 €	31.10. - 07.11.2026 2.715 € 3.620 €	07.11. - 14.11.2026 2.715 € 3.620 €
14.11. - 21.11.2026 3.620 €	21.11. - 28.11.2026 3.620 €	28.11. - 05.12.2026 3.620 €	



WEBSITE  
[www.plujeme.cz](http://www.plujeme.cz)



E-MAIL  
[info@plujeme.cz](mailto:info@plujeme.cz)



PHONE  
+420 720 755 085



MOBILE  
+420 777 170 276



PLUJEME RÁDI S.R.O.  
Dlouhá 730/35, 11000 Praha 1 – Staré Město, Czech Republic

## PRICE AND AVAILABILITY

05.12. - 12.12.2026

3.620 €

12.12. - 19.12.2026

3.620 €

19.12. - 26.12.2026

3.620 €



### WEBSITE

[www.plujeme.cz](http://www.plujeme.cz)



### E-MAIL

[info@plujeme.cz](mailto:info@plujeme.cz)



### PHONE

+420 720 755 085



### MOBILE

+420 777 170 276



### PLUJEME RÁDI S.R.O.

Dlouhá 730/35, 11000 Praha 1 – Staré Město, Czech Republic