

LEOPARD 50

Sonea (2025)

Catamaran Leopard 50 Sonea, built in 2025 is anchored in the Sukosan, D-Marin Dalmacija Marina, Zadar region, Croatia. It has 5 + 1 cabins, can accommodate 10 + 2 + 1 people and has 5 + 1 toilets. Bed linen and kitchen equipment are included in the price.

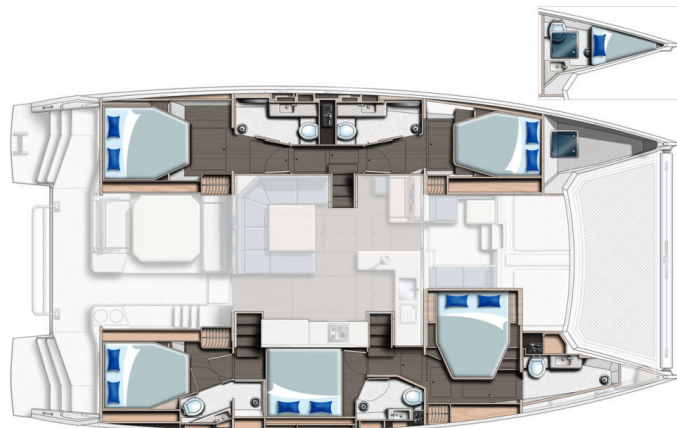

YACHT SPECIFICATIONS

Yacht Base

**Sukosan, D-Marin Dalmacija Marina,
Croatia**

Yacht ID

12597

Brands

Leopard

Yacht name

Sonea

Production year

2025

Length

51 ft

Cabins

5 + 1

Berths

10 + 2 + 1

Max Persons

13

WC

5 + 1

Engine

2 x 80 HP

Fuel tank

925 l



WEBSITE

www.plujeme.cz



PHONE

+420 720 755 085



MOBILE

+420 777 170 276



E-MAIL

info@plujeme.cz



PLUJEME RÁDI S.R.O.

Dlouhá 730/35, 11000 Praha 1 – Staré Město, Czech Republic

STANDARD YACHT EQUIPMENT

Comfort	Bed linen, Blankets, Cockpit cushions, Deck cushions, Mosquito nets, Sunshades, Towels
Deck	Anchor, Bathing platform, Bilge pump - Mechanic, Bimini top, Boat hook, Bosun's chair (Safe seat)(boatswain's chair), Cockpit fridge, Cockpit/stern, outside shower, Dinghy hydraulic lifting system, Dinghy with outboard engine, Electric anchor windlass, Fenders, Gangway, Grill/Barbecue/Plancha, Spare anchor (Reserve, Auxiliary anchor), Swimming ladder, Teak cockpit
Entertainment	Bose Sound System, Fusion radio, Snorkeling equipment, Stand up paddle (SUP), TV, Underwater lights, Wi-Fi Internet
Galley	Coffee machine, Dishwasher, Freezer, Ice maker, Kitchen utensils (Galley equipment, cutlery), Oven, Refrigerator, Stove, Water filter, Water pump
Interior	Convertible table in salon, Dryer, Electric fans in cabins, Electric toilet, Hair dryer, LED lights, Washing machine
Navigation	AIS, Autopilot, Binoculars, Compass, Depthsounder, GPS chart plotter, Hand bearing compass, Log, Nautical charts, Radar, Wind instrument/Anemometer
Safety	Automatic Inflatable Life Jacket, Black Water Tank, Distress signals, EPIRB-Distress radio beacons, Fire extinguisher, First aid kit, Fog horn, Life belts (Safety harness), Liferaft, Sos Dan Buoy, VHF radio
Sails	Electric winch, Lazy bag
Yacht electrics	12V Socket, Air Conditioning, Batteries, Battery charger, Bilge pump - Electric, Generator, Heating, Inverter, Shore power connection, Solar panels, USB sockets, Water heater, Watermaker - desalinator



WEBSITE

www.plujeme.cz



PHONE

+420 720 755 085



MOBILE

+420 777 170 276



E-MAIL

info@plujeme.cz









PLUJEME RÁDI S.R.O.

Dlouhá 730/35, 11000 Praha 1 – Staré Město, Czech Republic

SERVICES

SELECTED SERVICES	OBLIGATORY	PAYMENT TYPE	PRICE
Charter pack (Payable now) Season: 2026. Includes: 1 set of bed linen and towels/person/week, gas, kitchen utensils, WiFi, snorkeling set, diver's inspection, check in and check out service, final cleaning, dinghy with 25PS outboard engine	Yes	per booking	650,00 €
Skipper (Payable now) Season: 2026.	Yes	per week + food	1.900,00 €
Airport transfer (Payable now) Season: 2026. One way Zadar Airport - Marina Dalmacija: max 8 persons	No	one-way	60,00 €
Airport transfer (Payable now) Season: 2026. One way Split Airport - Marina Dalmacija: max 8 persons	No	one-way	245,00 €
APA (Advance Provisioning Allowance) (Payable now) Season: 2026. Advance Provisioning Allowance (APA): Fund board serving to cover the costs of requested supplies, port and mooring charges, diesel and fuel, communications, crew gratuities, extras and depending on your particular request for services, itinerary, food, beverages etc. The Skipper will keep an accurate record of spending and at the end of your charter you will be refunded or asked during the charter to pay more if necessary. APA is not an all-inclusive package. For demanding clients we suggest to upgrade APA to double. APA is obligatory if Hostess or Chef is hired.	No	per booking	3.000,00 €
Early Check in (Payable now) Season: 2026. After 14:00 (in case of unforeseen circumstances and repairs time shift as needed)	No	per booking	325,00 €
Hostess (Payable now) Season: 2026. Includes: preparation of breakfast and lunch snack, cleaning and washing the dishes. APA is obligatory if a Hostess is hired.	No	per week + food	1.700,00 €
Skipper training practice (Payable now) Season: 2026. On request, prior arrangements regarding the content of the training are necessary	No	per week + food	2.500,00 €

WI-FI Internet connection on board (Payable now) Season: 2026. Unlimited	 WEBSITE www.plujeme.cz	 PHONE +420 720 755 085	 MOBILE +420 777 170 276	No per booking 0,00 €
	 E-MAIL info@plujeme.cz	 PLUJEME RÁDI S.R.O. Dlouhá 730/35, 11000 Praha 1 - Staré Město, Czech Republic		

ADDITIONAL EXTRAS

EXTRA	OBLIGATORY	PAYMENT TYPE	PRICE
Electric scooter (Payable now) Season: 2026. Xiaomi - Payable now	No	per week	120,00 €
Extra bedlinen (Payable now) Season: 2026. Payable now	No	per set	15,00 €
Extra towels (Payable now) Season: 2026. 1 big and 1 small towel - Payable now	No	per set	15,00 €
Gennaker (Payable now) Season: 2026. +500EUR deposit - Payable now	No	per booking	500,00 €
Railing net (Safety net) (Payable now) Season: 2026. Payable now	No	per booking	195,00 €



WEBSITE

www.plujeme.cz



E-MAIL

info@plujeme.cz



PHONE

+420 720 755 085



MOBILE

+420 777 170 276



PLUJEME RÁDI S.R.O.

Dlouhá 730/35, 11000 Praha 1 – Staré Město, Czech Republic

PRICE AND AVAILABILITY

30.04. - 10.05.2026 NOT AVAILABLE	16.05. - 23.05.2026 5.625 € 12.500 €	23.05. - 30.05.2026 6.975 € 15.500 €	30.05. - 06.06.2026 9.300 € 15.500 €
06.06. - 13.06.2026 11.550 € 19.250 €	13.06. - 20.06.2026 12.150 € 20.250 €	20.06. - 27.06.2026 NOT AVAILABLE	27.06. - 04.07.2026 13.350 € 22.250 €
04.07. - 11.07.2026 13.350 € 22.250 €	11.07. - 18.07.2026 NOT AVAILABLE	18.07. - 25.07.2026 NOT AVAILABLE	25.07. - 08.08.2026 NOT AVAILABLE
08.08. - 15.08.2026 13.350 € 22.250 €	15.08. - 22.08.2026 13.350 € 22.250 €	22.08. - 29.08.2026 11.550 € 19.250 €	29.08. - 05.09.2026 11.550 € 19.250 €
05.09. - 12.09.2026 NOT AVAILABLE	12.09. - 19.09.2026 9.900 € 16.500 €	19.09. - 26.09.2026 7.650 € 12.750 €	26.09. - 03.10.2026 7.050 € 11.750 €
03.10. - 10.10.2026 7.050 € 11.750 €	10.10. - 17.10.2026 6.000 € 10.000 €	17.10. - 24.10.2026 6.000 € 10.000 €	24.10. - 31.10.2026 6.000 € 10.000 €
31.10. - 07.11.2026 10.000 €	07.11. - 14.11.2026 10.000 €	14.11. - 21.11.2026 10.000 €	21.11. - 28.11.2026 10.000 €
28.11. - 05.12.2026 10.000 €			



WEBSITE
www.plujeme.cz



E-MAIL
info@plujeme.cz



PHONE
+420 720 755 085



MOBILE
+420 777 170 276



PLUJEME RÁDI S.R.O.
Dlouhá 730/35, 11000 Praha 1 – Staré Město, Czech Republic

PRICE AND AVAILABILITY

05.12. - 12.12.2026

10.000 €

12.12. - 19.12.2026

10.000 €

19.12. - 26.12.2026

10.000 €



WEBSITE

www.plujeme.cz



E-MAIL

info@plujeme.cz



PHONE

+420 720 755 085



MOBILE

+420 777 170 276



PLUJEME RÁDI S.R.O.

Dlouhá 730/35, 11000 Praha 1 – Staré Město, Czech Republic